

Tennis Court Location  
1:500

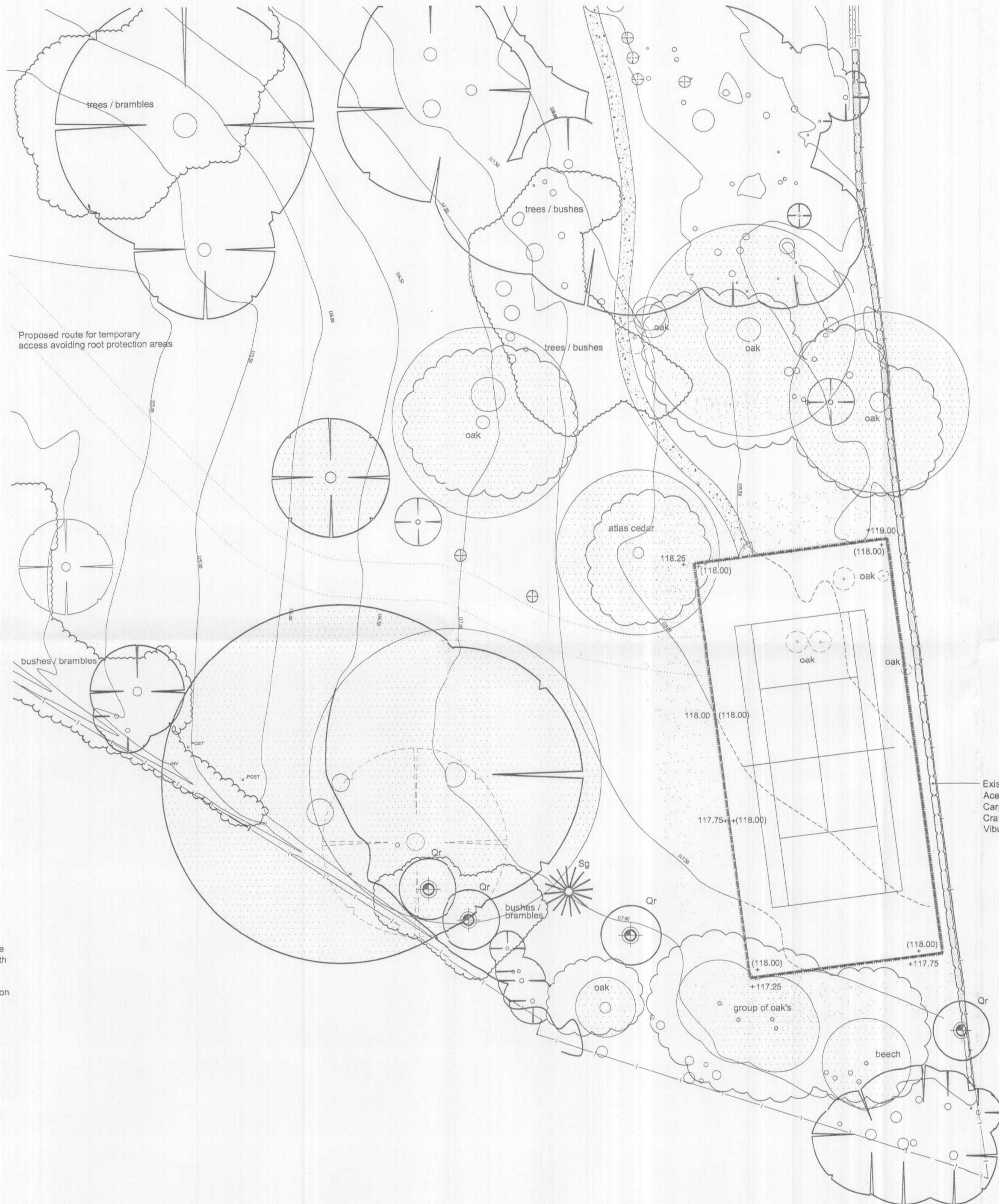

**Plant Schedule**

**Trees**  
 Extra Heavy Standard planted into 1200mm diameter x 750mm deep topsoil tree pit. Tree to be supported using double stake and cross bar. Position stakes either side of rootball and drive vertically at least 300mm into bottom of pit. Backfill tree pit with excavated topsoil.  
 Conifer planted into 900mm diameter x 600mm deep top soil tree pit. Tree to be supported using a single short stake. Position stake close to tree on windward side and drive vertically at least 300 mm into bottom of pit before planting. Secure using approved rubber tree tie and backfill tree pit with excavated topsoil. Cut stakes to approximately 600mm above ground level.

Key	Species	Size	Girth(cm)	Height(cm)	Root Condition	Total Quantity
Qr	Quercus robur	ExHvyStan	16-18	min 450	Root Ball	4
Sg	Sequoiadendron giganteum	-	-	125-150	15 Ltr Container	1

**Grass Seed**  
 British Seed Houses; A19 mixture sown at 25g/m<sup>2</sup> with BSH2 pre-seeding fertiliser at 70g/m<sup>2</sup>. Seeded into a minimum 100mm depth topsoil reduced to a fine tilth 10mm down particles

**OUTLINE SPECIFICATION**

**General**  
 All planting work shall be in accordance with approved horticultural standards and all relevant British Standards.  
 Plants shall be supplied in accordance with the HTA Trade Certification Scheme and handled in accordance with the CPSE Handling and Establishment of Landscape Plants Guidelines.  
 Herbicides, pesticides and other chemicals may only be used with approval of the contract administrator. Use of chemicals shall be in accordance with all relevant guidelines and the manufacturer's recommendations.  
 Imported topsoil shall be a minimum specification of BS 3882 1994 General Purpose Grade unless otherwise instructed. 1m<sup>2</sup>/20m approved compost/organic material/soil ameliorant shall be cultivated into topsoil before planting. Peat shall not be used.  
 Following planting all plant beds shall be treated with an approved granular fertiliser at rates as recommended by the manufacturer.

**Tree Protection**  
 Existing trees to be retained shall be protected in accordance with BS 5837:2005, Trees in Relation to Construction. Please refer to Ian Keen Ltd. Tree Constraints and Protection Plan, drawing number 6640/01, for full details.

**Maintenance**  
 The Defects liability period for planting shall be 12 months from completion of the works. During this period any plant which is found to be dead, dying or otherwise defective shall be replaced during the next planting season.  
 The contractor shall make maintenance visits as required to ensure the successful establishment of the plants and maintain all planted areas in a weed free condition.

**Notes**  
 Drawing based on Associated Surveying Consultants Topographical Survey drawing number ASC.05.728, Tusk Developments Site Plan drawing number 0703\_00\_101 and Ian Keen's Tree Constraints Plan drawing number 6640/01.

**KEY**

- Existing Tree as Arboriculturist Survey
- Root Protection Zone as Arboriculturist Survey
- Existing Tree Removed
- Existing Tree as Topographical Survey
- Proposed Extra Heavy Standard Tree
- Proposed Conifer
- Proposed Footpath Self-binding Gravel
- Grass Seed
- Proposed Timber Post & Board Retaining Structure
- Weldmesh Fencing 3 - 4m high PPC Black
- + (118.00) Proposed Levels (indicative only)

Rev	Date	Details	Drawn	Chkd
C	15.10.07	Amendments as Alsop Verif's email 11.10.07	KID	GB
B	13.09.07	Amendments as Alsop Verif's comments	KID	GB
A	10.09.07	Levels added to tennis court. Root Protection Zones added	KID	GB

PROJECT  
**Proposed Tennis Court**  
 4 Leggatts Park, Potters Bar

DRAWN	DATE	DWG. NO.	REV
JN	5.09.07	746.01C	
CHECKED	SCALE		
KID	1:200 @A1		

**BELL FISCHER BFLA**  
 160 Chiltern Drive, Surbiton Surrey KT5 8LS  
 ☎ 020 8390 6477 ☎ 020 8390 7903  
 ✉ landscape@bellfischer.co.uk  
 www.bellfischer.co.uk  
**LANDSCAPE ARCHITECTS**

WELWYN HATFIELD  
 PLANNING  
 OFFICE COPY  
 1 DEC 2007  
 No: 2007/1916

