

GLA Architecture and Design
Suite T, 25 Horseall Road, Highbury, London N5 1XL
T 020 7700 2916 F 020 7700 2933 E g@glad.co.uk

General Notes

1. Removal of existing roof tiles, battens, ridge tiles, felt, flashings, hoppers, rainwater pipes & gutters
2. New roof flashings to match existing, throughout new tiled roofs

Client THE TRUSTEES OF THE TWELVE APOSTLES CHURCH		
Main Contractor		
Project PROPOSED ROOF WORKS TO THE TWELVE APOSTLES CHURCH, KENTISH LANE, BROOKMANS PARK, HATFIELD, HERTFORDSHIRE, AL9 6NG		
Drawing Title PROPOSED GROUND FLOOR PLAN		
Scale 1:100 @ A3	Date October 2013	Drawn By SK
Project No. 1312	Drawing No. 09	Rev. A-
<p>ALL DIMENSIONS TO BE CHECKED ON SITE</p> <p>DRAWING STATUS</p> <p>A SCHEME - Outline/Scheme drawings for proposals, budgets, etc.</p> <p>B DESIGN DEVELOPMENT - Evolving final design drawings for approvals, tenders, billing etc.</p> <p>C CONSTRUCTION - Fully developed drawings issued under instruction for construction.</p> <p>ONLY STATUS 'C' DRAWINGS TO BE USED FOR CONSTRUCTION PURPOSES</p>		

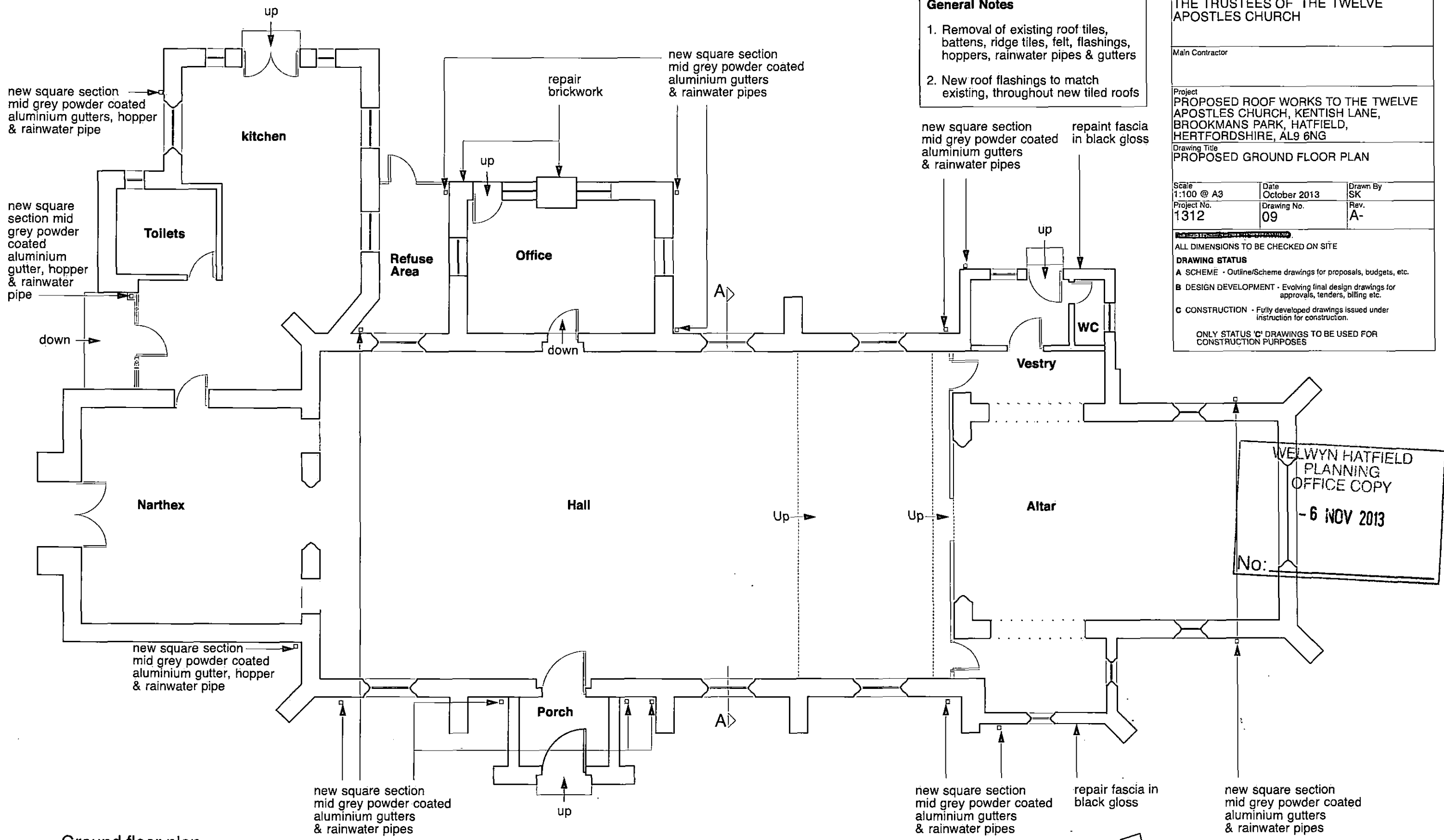

WELWYN HATFIELD
PLANNING
OFFICE COPY
- 6 NOV 2013
No:

Ground floor plan

