

7932

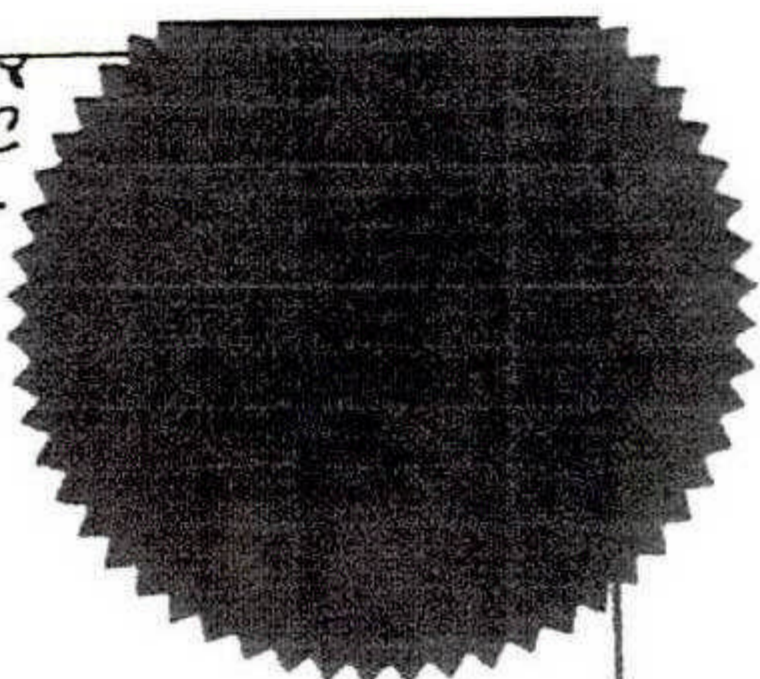

John M. Dowling
Chairman of the Council

W. J. ...
Authorized Officer



*off Council
to Council*

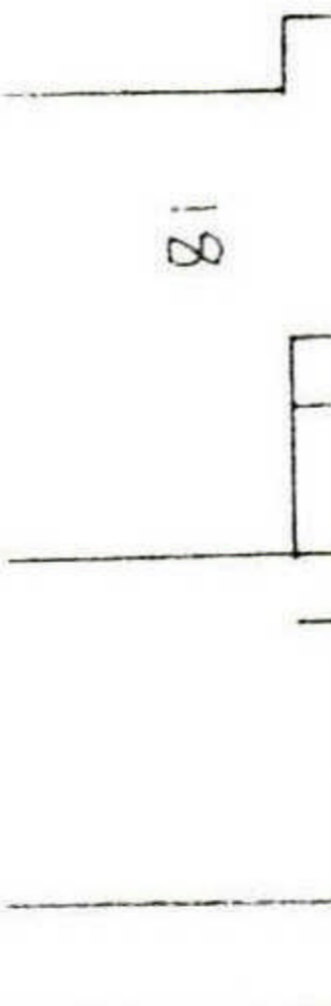
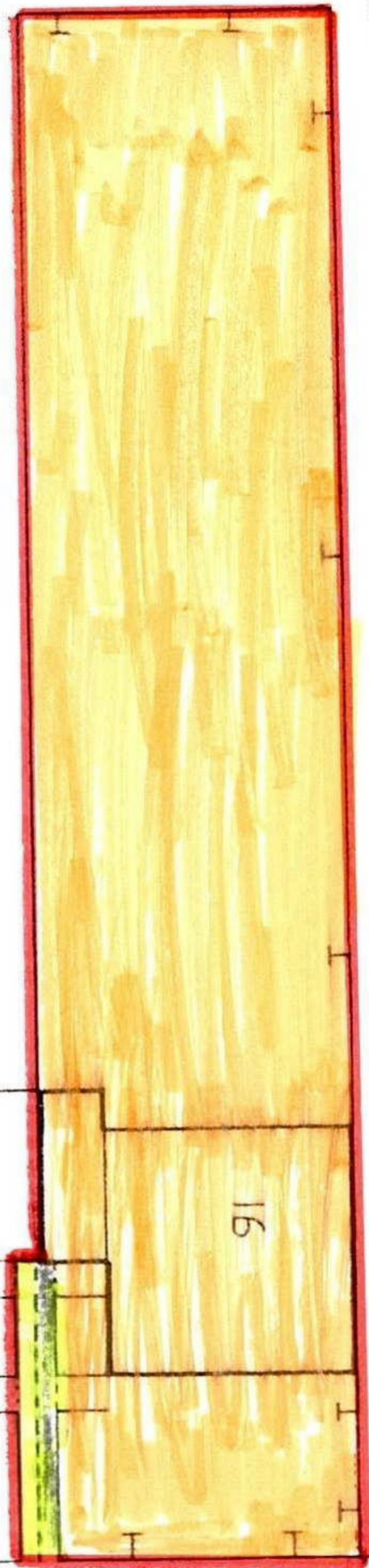

*and Site Location
plan*

A4

LOCATION PLAN

1:1250

PLANNING DEPARTMENT
OFFICE COPY

26 AUG 2010

2010/1871

Ref:

200 Date 8-8-83 Drawn KDB

WELWYN HILLS DISTRICT COUNCIL
HOUSING DEPARTMENT
Deed Plan
16 Worcester Road Hatfield

