

AS EXISTING

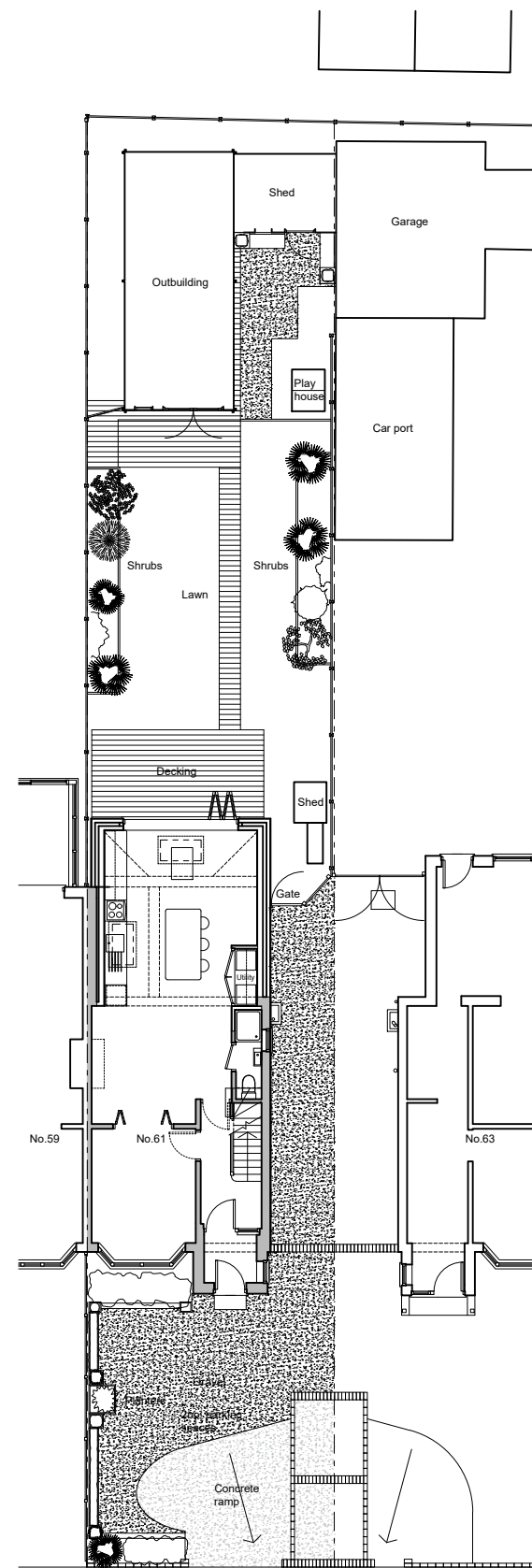

AS PROPOSED

61 HOLME ROAD HATFIELD GARDEN VILLAGE HERTS

GENERAL NOTES.

1. COPYRIGHT OF THIS DRAWING IS RESERVED BY JOHN NICOL AND IS ISSUED ON CONDITION THAT IT IS NOT COPIED OR DISCLOSED TO ANY THIRD PARTY EITHER WHOLLY OR IN PART WITHOUT THE CONSENT OF JOHN NICOL IN WRITING.

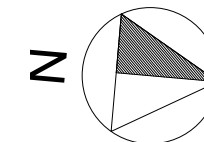

REV	DESCRIPTION	BY	DATE



john Nicol
architect + designer

1 Tankerfield Place Romeland Hill St. Albans Hertfordshire AL3 4HH
T: 01727 838664 M: 07867 787378 E: jnicolriba@gmail.com

CLIENT:
MR & MRS D BEHARRY

JOB:
**PROPOSED REAR EXTENSION TO
61 HOLME ROAD HATFIELD GARDEN
VILLAGE HERTS AL10 9LG**

TITLE:
SITE PLAN

THE PRINCIPAL CONTRACTOR SHALL CONSIDER ALL RISKS OF THE BUILDING WORKS AND AS SET OUT IN THE PRINCIPAL DESIGNERS RISK ASSESSMENT AND IMPLEMENT APPROPRIATE HEALTH AND SAFETY MEASURES IN ACCORDANCE WITH THE CONSTRUCTION (DESIGN AND MANAGEMENT) REGULATIONS 2015

APPROVED BY			
DATE			
DRAWN BY :	JN	SCALE:	1:200@A3
DATE:	OCTOBER 2021	APPROVED BY	
CHECKED BY		DATE	
DWG No.	JN147/02		Rev: -