

GENERAL NOTES:

THE CONTRACTOR SHALL CHECK AND VERIFY ALL DIMENSIONS ON SITE AND REPORT ANY DISCREPANCIES IN WRITING TO ABSOLUTE DESIGN BEFORE COMMENCING WITH THE WORK.

ALL DRAWINGS ARE THE PROPERTY OF ABSOLUTE DESIGN AND SHALL NOT BE REPRODUCED WITHOUT THE CONSENT OF THE DESIGNERS.

THIS DRAWING IS TO BE READ IN CONJUNCTION WITH THE RELEVANT SPECIFICATION OF BUILDING WORKS.

ALL DIMENSIONS ARE IN mm UNLESS OTHERWISE NOTED.

THIS DRAWING MAY INCORPORATE INFORMATION FROM OTHER PROFESSIONS. ABSOLUTE DESIGN CANNOT ACCEPT RESPONSIBILITY FOR THE INTEGRITY AND ACCURACY OF SUCH INFORMATION.

IF IN DOUBT ASK!

original drawn by	date	
A	10-07-15	NAW
B	28-07-15	NAW
C	10-08-15	NAW
D	08-09-15	NAW
E	20-10-15	NAW
F	28-10-15	NAW

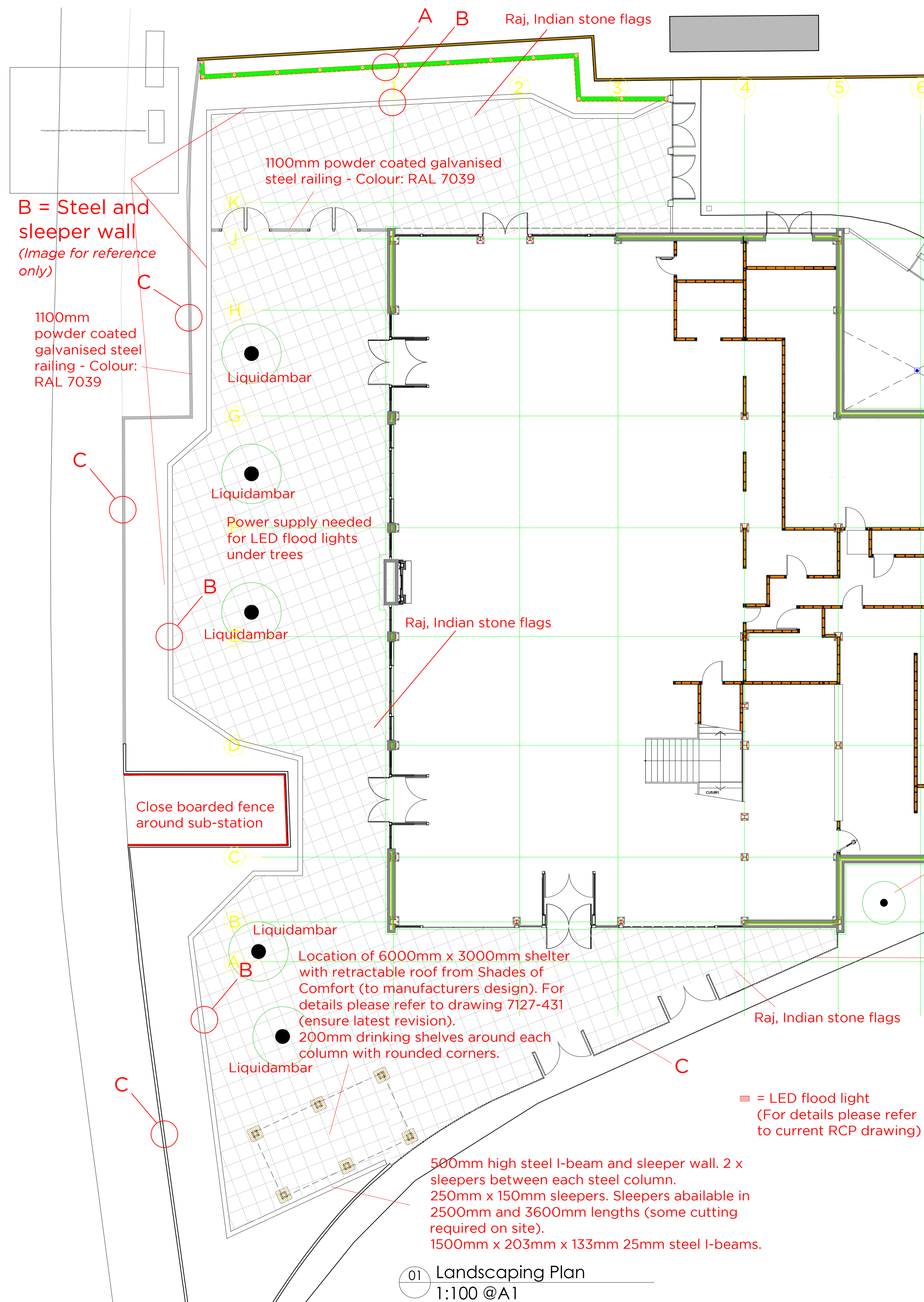

**03 Acoustic Wall Front and Plan View**  
1:10 @A1

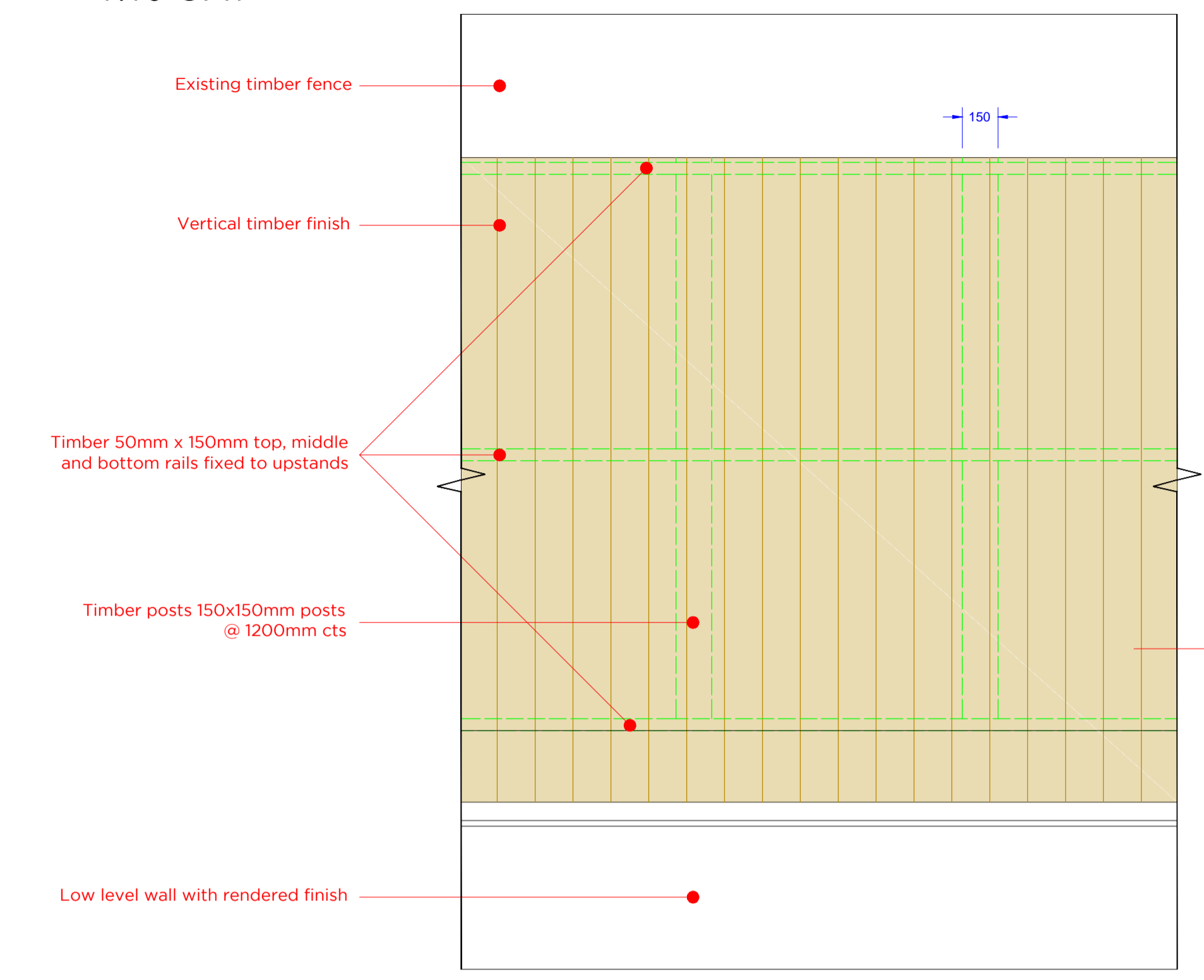

Absorptive Acoustic Fencing - The reflective face is the same construction as single sided reflective. The reverse side of this is then clad with Rockwool and this is then covered with a geotextile membrane which is held in place by Galv. perforated steel sheet. This creates an absorptive side which generally faces the noise source and deadens the sound by absorbing it. Double Sided fencing has a test rating of B3 and Noise Reduction Test Rating of DLR=33db. Data supplied by ABC Fencing.

Acoustic fence needs to be 600mm min. from existing boundary fence.

**02 Acoustic Wall Detail Section**  
1:10 @A1

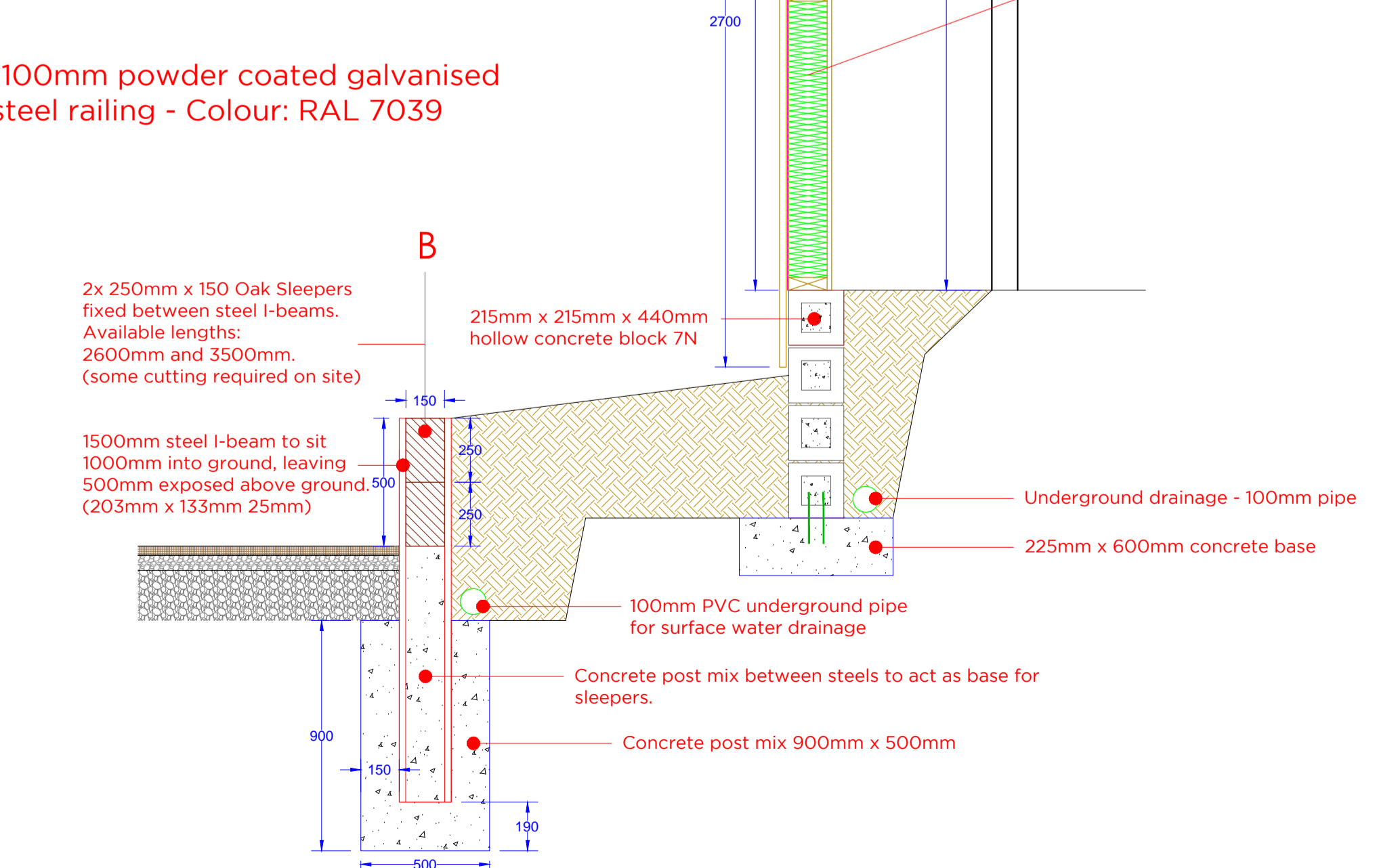

**04 Image Ref - Hollow Concrete Block**  
Not to scale

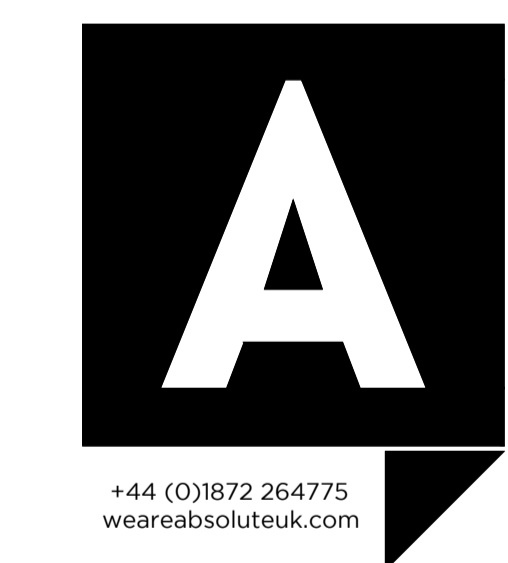

+44 (0)1872 264775  
[weareabsoluteuk.com](http://weareabsoluteuk.com)

Drawing status: **CONSTRUCTION**

Drawing Title:  
Landscaping and Acoustic Fence

Contract Name:  
Commet Way,  
Hatfield,  
AL10 0XY

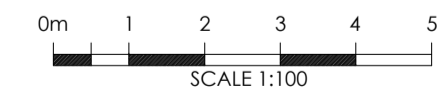

Drawing No. & Revision:  
**7127 - 430 - F**

Scale @ A1:  
1: 100

Drawn By: NAW Date: 08-06-15 Pub: 5480