

ALL MEASUREMENTS TO BE VERIFIED ON SITE

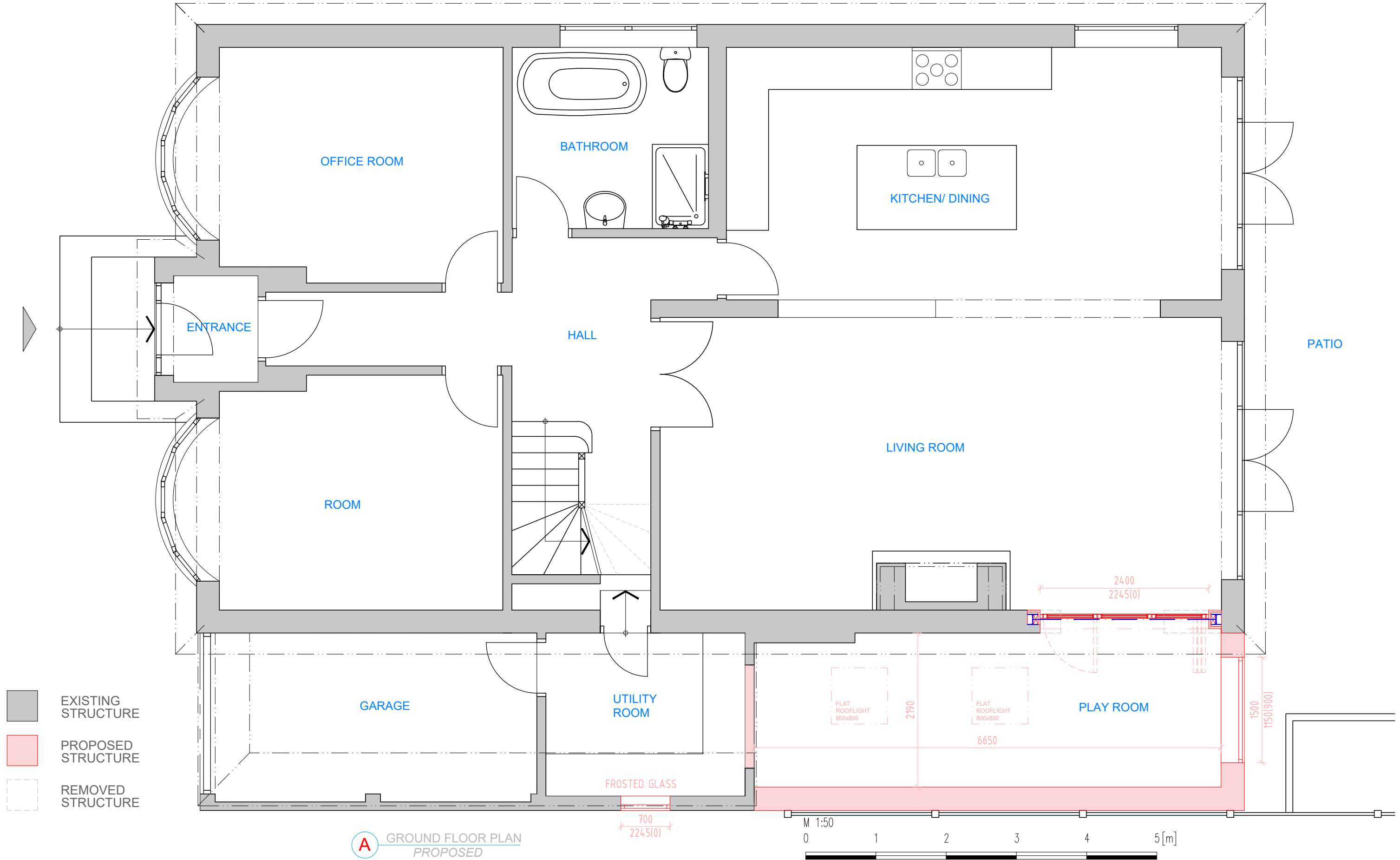

NOTES/REV.

All dimensions shown to be checked on site.
 This drawing is copyright of DVL

REV	DATE	DRWN	CHKD

DVL | architectural design | design&construct | building construct

131 Ashwood Road | Potters Bar, Hertfordshire | EN6 2QD

T: 01277 280101 | E: office@dobravilla.com | E: studio@designandarchitecture.co.uk

Web: designandarchitecture.co.uk | Facebook.com/ | Twitter: @

INFORMATION

ISSUE REASON:
APPROVAL

SCALE: 1:50 @A3

DATE: 12/22

DRAWN: MC

CHECKED: MC

CLIENT: Lorenzo Moruzzi, 23 Kingswell Ride, Cuffley, EN6 4LH

PROJECT: Single - Storey Side Extension

DRAWING TITLE: **Proposed Ground Floor**

DRAWING NUMBER: J22 10.PP-04

REVISION: /

