

DRAWING LEGEND

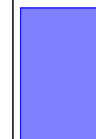

PV Modules: Trina TSM-420-DE09.08  
 Power: 420Wp  
 Dimensions: 1762x1134x30mm



Main roof  
 300 PV Panels

Proposed Solar PV Panels  
 Trina PV Panels TSM-420 DE09.08,  
 1134 x 1762 x 30 mm (total No.  
 380, 300 No. on the main roof and  
 80 No. on the small roof). Panels  
 secured to roof via K2 Speed Rail  
 mounting system giving approx  
 depth of 75 mm from existing roof  
 finish to top of PV Panel.

Small roof  
 80PV Panels

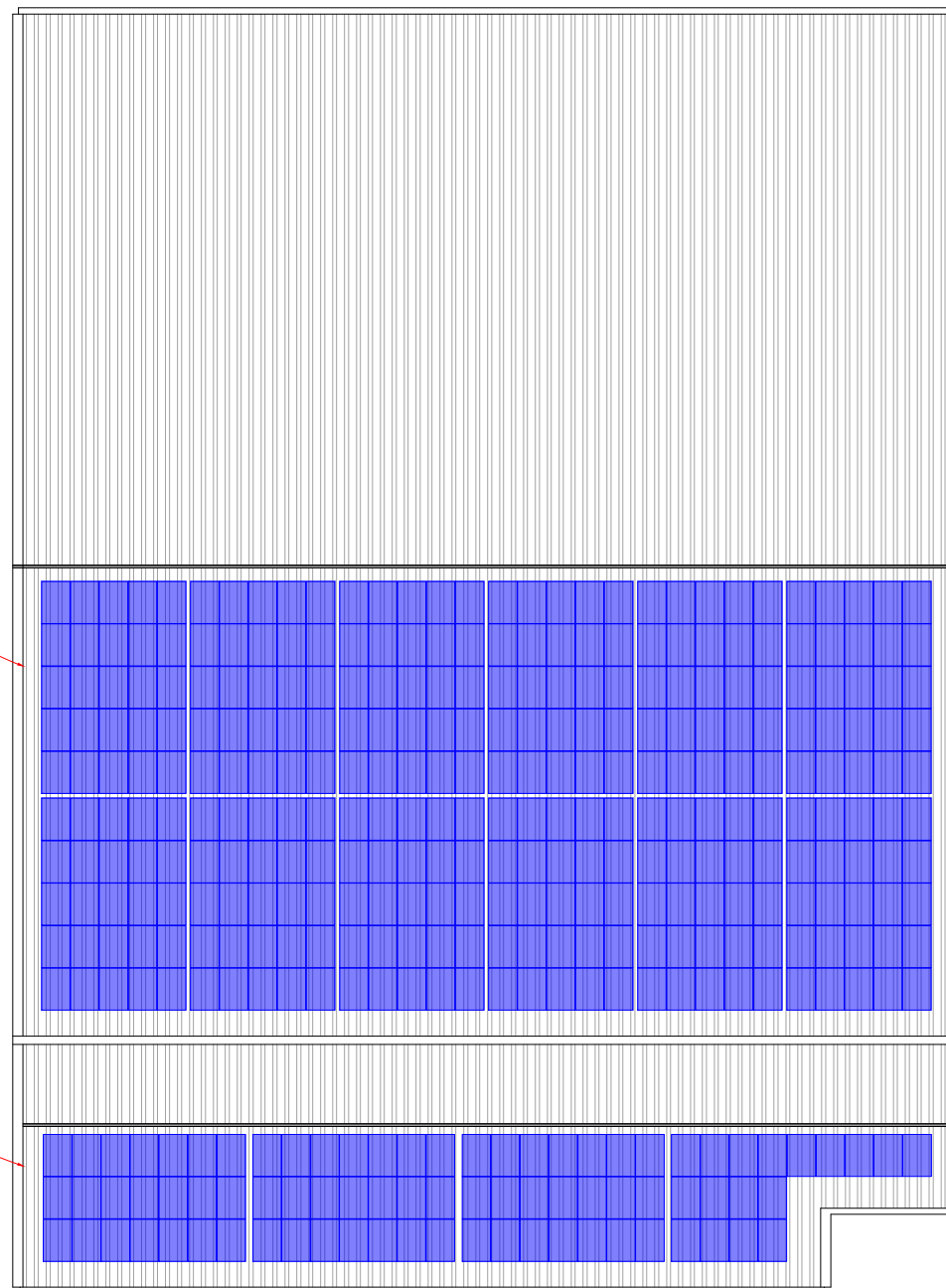

Proposed Roof Plan

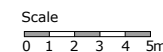

| Rev | Description | Dwn | Chck | Date |
|-----|-------------|-----|------|------|
|     |             |     |      |      |



© Photon Energy Ltd  
 8 Windsor Square  
 Silver Street  
 Reading, RG1 2TH  
 Tel +44 118 997 7470  
 info@photonenergy.co.uk  
 www.photonenergy.co.uk  
 All rights reserved

|  |                            |
|--|----------------------------|
| Project Number:<br><b>I2018</b>                        |                            |
| Project Name:<br><b>Queenswood School</b>              |                            |
| Drawing By:<br><b>Cathy Ross</b>                       | Scale:<br><b>1:300 @A1</b> |
| Checked By:<br><b>Kiran Susarla</b>                    | Date:<br><b>01/05/2023</b> |
| Drawing Name:<br><b>Proposed Sports hall roof plan</b> |                            |
| Drawing No:<br><b>I2018-100-20</b>                     | Rev:<br><b>-</b>           |