

**Proposed Single Storey Rear Extension**  
 in accordance with Householder Permitted Development rights as set out Town and Country Planning (General Permitted Development) Order 2015 Schedule 2, Part 1, Class A and conditions as set out in DCLG Permitted Development for Householders - technical guidance 2017, A.1 (a-j inclusive)

Notes :  
 This drawing is intended as an initial appraisal of the site only. Do not use for the purposes of valuation. This drawing has been produced using OS information and a full measured laser digital survey. The proposals are subject to further detailed site inspection(s) and are subject to planning.  
 All building work must comply with relevant British Standards and Building Regulations. All dimensions to be checked on site prior to the commencement of works and any discrepancies or omissions referred to the Architect / Engineer / Contractor.



The ownership of copyright of this drawing remains the property of Studio:08 architecture + planning ltd in accordance with the Copyright Design + Patents Act 1988.

Reproduction of this drawing or its content, wholly or in part by a 3rd party is prohibited without written approval. No implied licence exists.

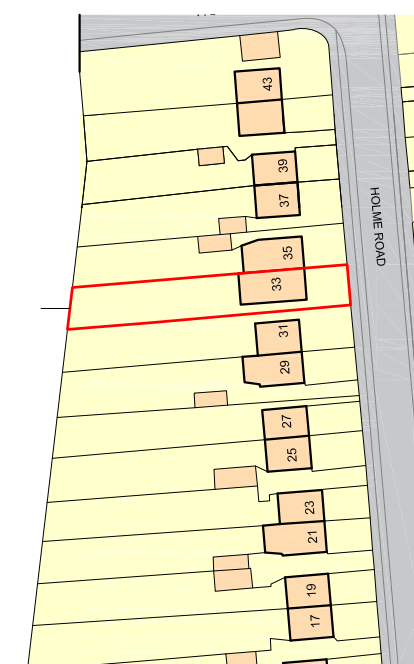
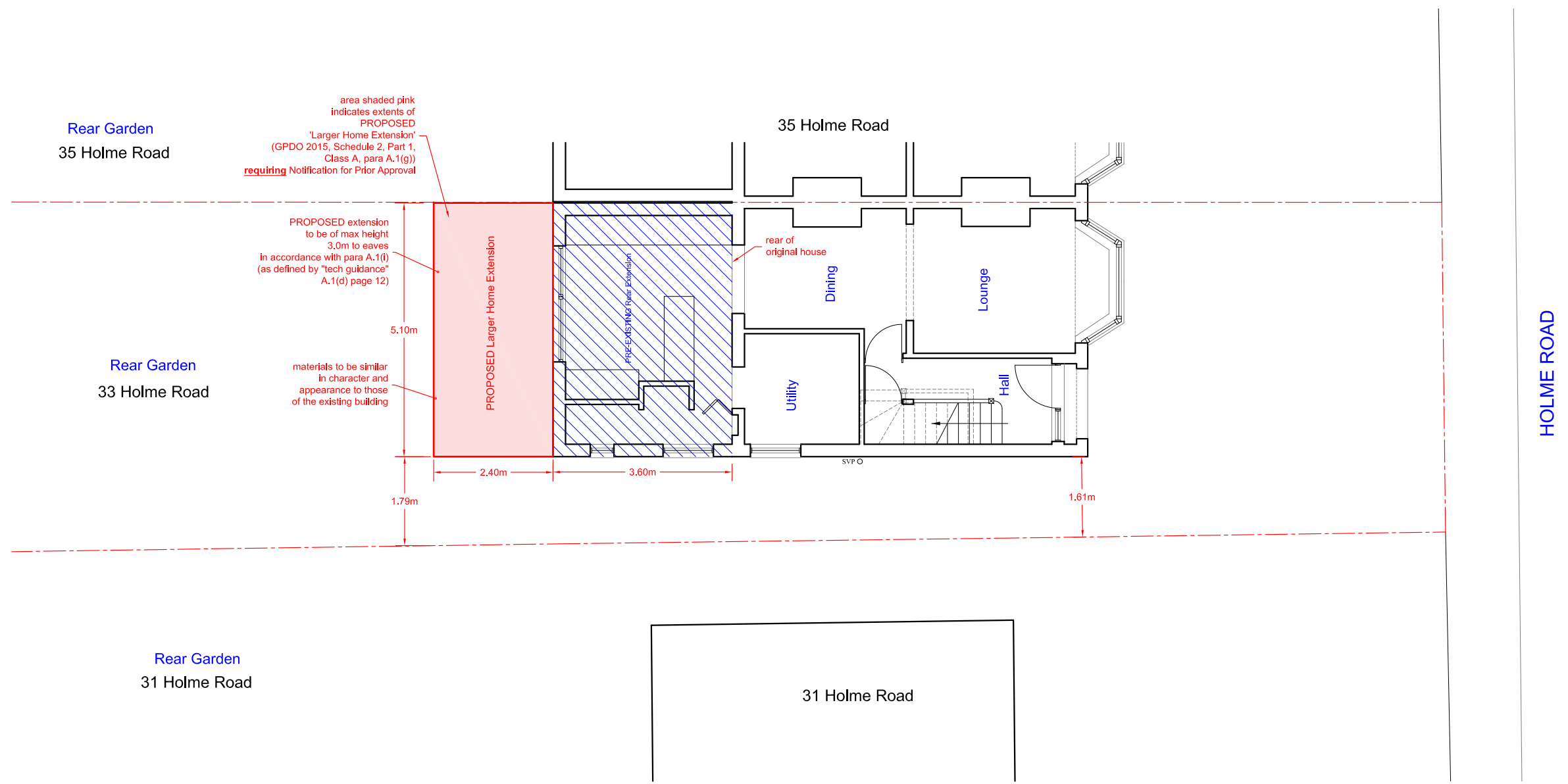
NB: If a hard copy of this drawing is to be printed or copied at a remote source by a 3rd party it could result in minor distortions in the original scale. It is advised to verify the original scale has been reproduced accurately by checking the visual scales on the drawing.



Site Location Plan  
 1:1250 @ A3

 PRE - EXISTING Rear Extension - Householders Permitted Development area of EXISTING 'Home Extension' (para A.1(a-j) NOT Requiring Notification for Prior Approval)  
 PROPOSED Rear Extension - Householders Permitted Development area of Proposed 'Larger Home Extension' (para A.1(g) REQUIRING Notification for Prior Approval)



**33 Holme Road AL10 9LH**  
 PROPOSED  
**GROUND FLOOR PLAN**

scale 1:100 @ A3  
 SCALE  

Rev	Detail	Date
Drawing No. : 2076.BP.01		Revision :
Scale : 1:100 @ A3		Date : 16.11.20

Project Title:  
**33 Holme Road  
 Hatfield  
 AL10 9LH**  
 Drawing Title :  
 PROPOSED  
 GROUND FLOOR PLAN