

Condition 9

NB For Cross-Sections refer to drawing no. AR-00146

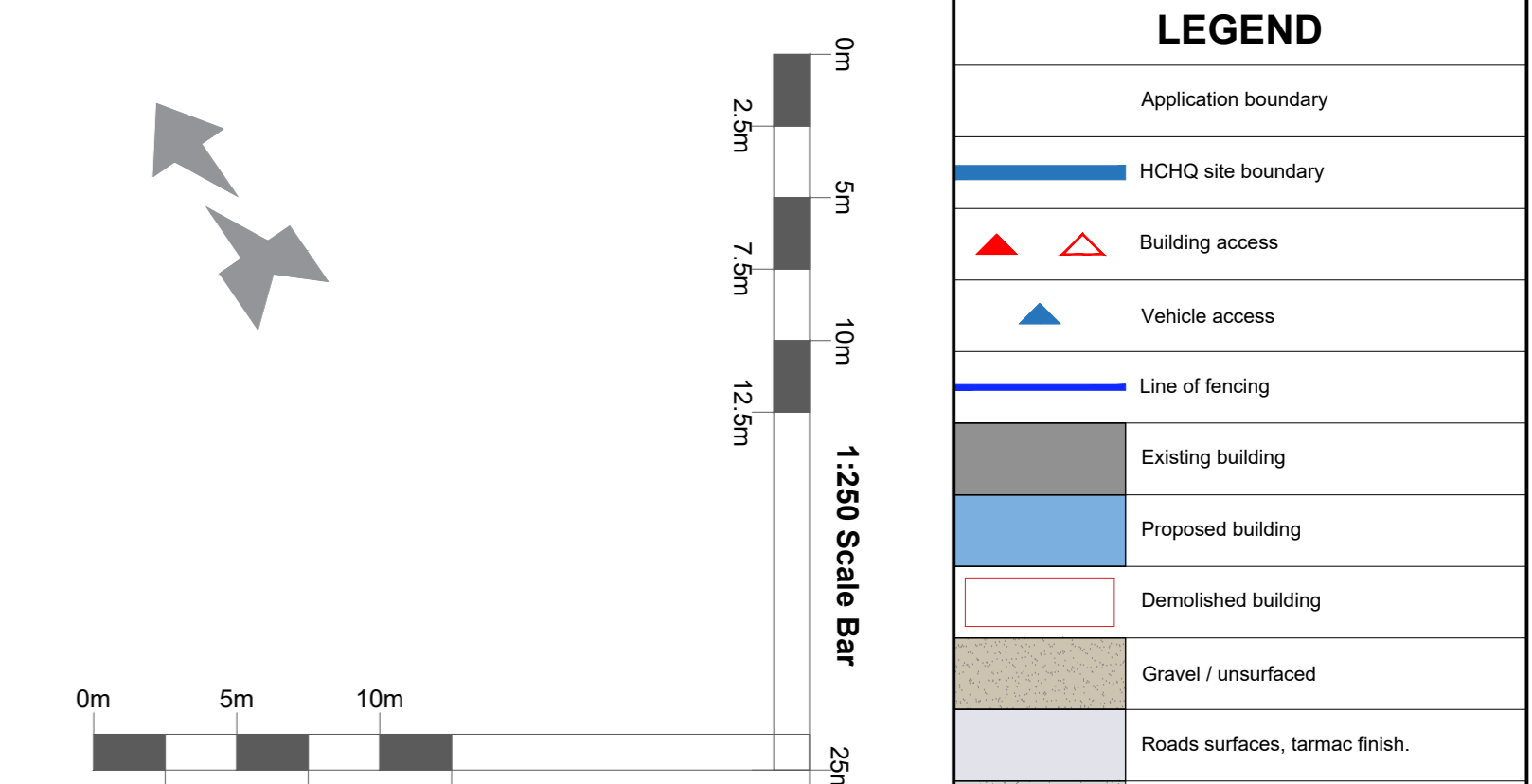
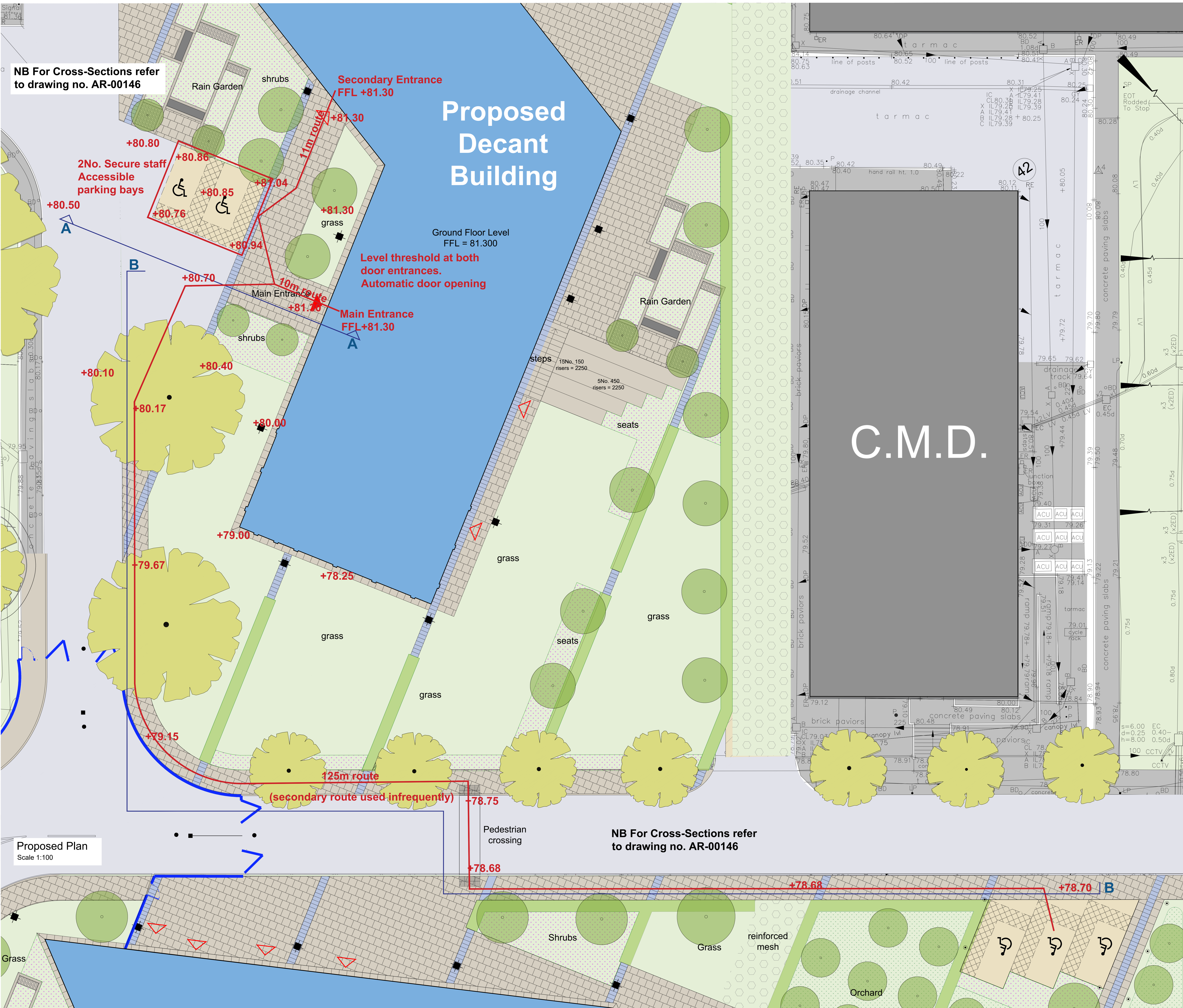

LEGEND	
[Symbol]	Application boundary
[Symbol]	HCHD site boundary
[Symbol]	Building access
[Symbol]	Vehicle access
[Symbol]	Line of fencing
[Symbol]	Existing building
[Symbol]	Proposed building
[Symbol]	Demolished building
[Symbol]	Gravel / unsurfaced
[Symbol]	Roads surfaces, tarmac finish
[Symbol]	Proposed concrete finish
[Symbol]	Marshalls permeable block paving- 200x100x50mm finish Bracken.
[Symbol]	Carpark Kerbs - Marshalls Kaykerb - finish Bracken.
[Symbol]	Carpark footpaths - Marshalls Tegula original 120x160x50mm - finish Charcoal.
[Symbol]	Treads and risers - Forest of Dean Permat sandstone sawn finish with magna resin slip for DDA compliance.
[Symbol]	Brushed stainless steel handrails (60mm diameter tubes - to access stairs.
[Symbol]	Forest of Dean Permat sandstone - sawn finish - random length 300 - 500mm.
[Symbol]	Kerbs around the HG site and Decart site finish - Forest of Dean Permat sandstone - 915mm length - height 255mm.
[Symbol]	Blaker tactile paving - Forest of Dean Permat sandstone - flamed finish - 600x300mm. In strips.
[Symbol]	Forest of Dean Permat sandstone - sawn finish - 600x600x50mm high.
[Symbol]	Precast concrete benches with hardwood timber slats.
[Symbol]	Philips Hue - Impress outdoor bollard lighting finish black 100x100x700mm high grey finish.
[Symbol]	Philips Hue lighting LED neutral (x2ED).
[Symbol]	Philips inset up lighting under feature lines.
[Symbol]	Proposed reinforced grass
[Symbol]	Reinforced gravel
[Symbol]	Rubber matting on grass
[Symbol]	Hard Road compacted hoggin finish
[Symbol]	Short / out grass
[Symbol]	Proposed wild flowers / long grass
[Symbol]	Proposed herb garden
[Symbol]	Proposed shrubs
[Symbol]	Proposed hedging
[Symbol]	Existing tree
[Symbol]	Proposed tree
[Symbol]	Proposed level
[Symbol]	Existing level

Rain Garden	
1.	Tree pit.
2.	Cooldecks.
3.	Concrete / stone benches.
4.	Rain garden planting. Refer to Notes Item 45.
5.	Block edge, Permat sandstone blocks 200x100mm.
6.	Uplighter to proposed tree.

See also drainage details for below ground construction. Standard arrangement shown here to be varied in detail to suit local circumstances.

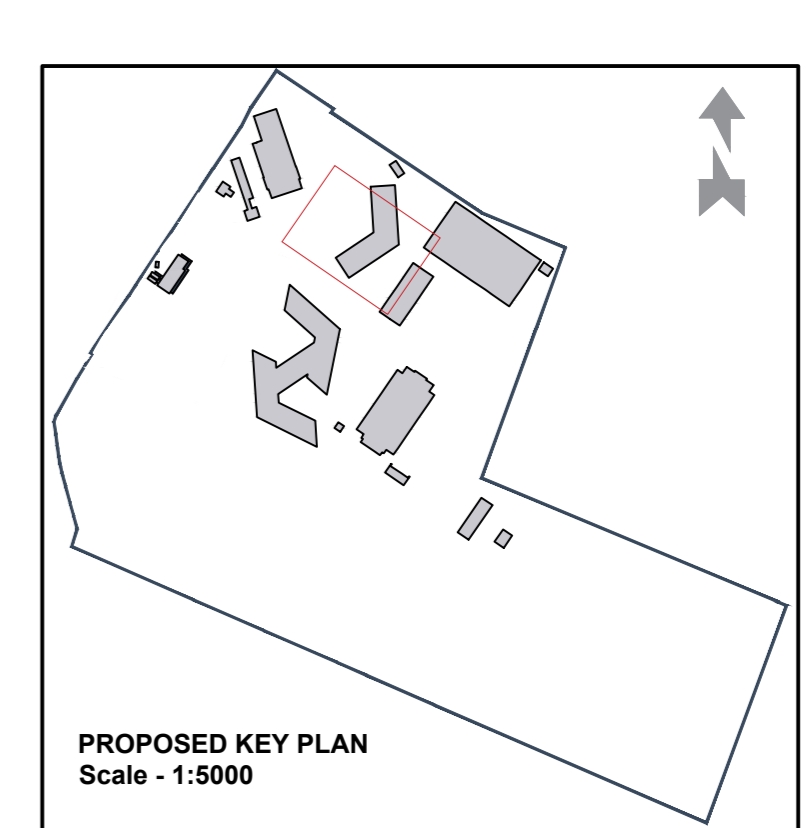

PL02	Revisions of Planning Conditions	29/11/22	CB
PL01	For Discharge of Planning Conditions	22/09/22	CB
REV		DATE	BY

HERTFORDSHIRE CONSTABULARY, HEADQUARTERS REDEVELOPMENT, STANBOROUGH

Proposed Site Plan
Decant accessible parking route to entrance Condition 9

VGA PROJECT NUMBER	LAL	
7645		
DRAWING REFERENCE	REV	
HCHQ-VGA-XX-XX-DR-AR-00142	PL02	
DRAWN / DATE	CHECKED / DATE	SCALE
CB / AUG 22	MC / AUG 22	1:100 & 1:50 at A0

PLANNING APPROVAL

Written dimensions to be taken. Do not scale off the drawings. Any discrepancies written or scaled should be brought to the attention of the architect immediately.

T: +44 (0) 1438 316 331
architect@vincent-gorling.co.uk
vincent-gorling.co.uk
Vincent and Gorling Limited, Starling Court
Noton Road, Stevenage, Hertfordshire SG1 2JY
© Copyright Vincent and Gorling Limited 2017

VG

0m 50m 100m
A0 ORIGINAL SCALE

20/12/2022 - 14:39:49