

# Condition 9

LEGEND	
	Application boundary
	HCHO site boundary
	Building access
	Vehicle access
	Line of fencing
	Existing building
	Proposed building
	Demolished building
	Gravel / unsurfaced
	Roads surfaces, tarmac finish
	Proposed permeable tarmac finish
	Marshalls permeable block paving - 200x100x60mm finish Brackens
	Carpark Kerbs - Marshalls Keykerb - finish Brackens
	Carpark footpaths - Marshalls Tegula original 120x160x50mm - finish Charcoal
	Treads and risers - Forest of Dean Pennant sandstone, sawn finish
	Treads and risers - Forest of Dean Pennant sandstone sawn finish with magna resin slip for DDA compliance
	Brushed stainless steel handrails 60mm diameter tubes - to access stairs
	Forest of Dean Pennant sandstone - sawn finish - random length 300 - 900mm - 50mm thick Kerbs, around the HQ site and Decant site Forest of Dean Pennant sandstone - 915mm length, height 255mm
	Bister tactile paving, Forest of Dean Pennant, 400x400mm
	Welsh Pennant Stone - flamed finish, 600x300mm. In stripes
	Security bollards - Forest of Dean Pennant sandstone - 600x600x900mm high
	Precast concrete benches with hardwood timber slats
	Philips Hue - Impress outdoor bollard lighting finish black 100x100x700mm high
	Philips mast lighting 6.0m high dark grey finish
	Philips flood lighting LED neutral white
	Philips inset up lighting under feature trees
	Proposed reinforced grass
	Reinforced gravel
	Rubber matting on grass
	Haul Road - compacted hoggin finish
	Short / cut grass
	Proposed wild flowers / long grass
	Proposed herb garden
	Proposed shrubs
	Proposed hedging
	Existing tree
	Proposed tree
	Proposed level
	Existing level

- Rain Garden**
1. Tree pit.
  2. Cobbles.
  3. Concrete / stone benches.
  4. Rain garden planting. Refer to Notes Item 4d.
  5. Block edge: Pennant sandstone blocks 200x100mm.
  6. Uplighter to proposed tree
- See also drainage details for below ground construction. Standard arrangement shown here to be varied in detail to suit local circumstances

PL01 For Discharge of Planning Conditions 22/08/22 CB  
REV DATE BY

## HERTFORDSHIRE CONSTABULARY, HEADQUARTERS REDEVELOPMENT, STANBOROUGH

### Proposed Site Plan Decant accessible parking route to entrance Condition 9

VGA PROJECT NUMBER	LAL
<b>7645</b>	
DRAWING REFERENCE	REV
<b>HCHQ-VGA-XX-XX-DR-AR-00142</b>	<b>PL01</b>
DRAWN / DATE	CHECKED / DATE
CB AUG 22	MC AUG 22
SCALE	SCALE
1:250 at A0	1:500 at A2

#### PLANNING APPROVAL

Written dimensions to be taken. Do not scale off the drawings. Any discrepancies written or scaled should be brought to the attention of the architect immediately.

T: +44 (0) 1438 316 331  
www.vincentgoring.co.uk  
vincentgoring.co.uk  
Vincent and Goring Limited, Starling Court  
Notton Road, Storrington, Herefordshire SG1 2JY  
© Copyright Vincent and Goring Limited 2017



01/09/2022 - 11:41:31

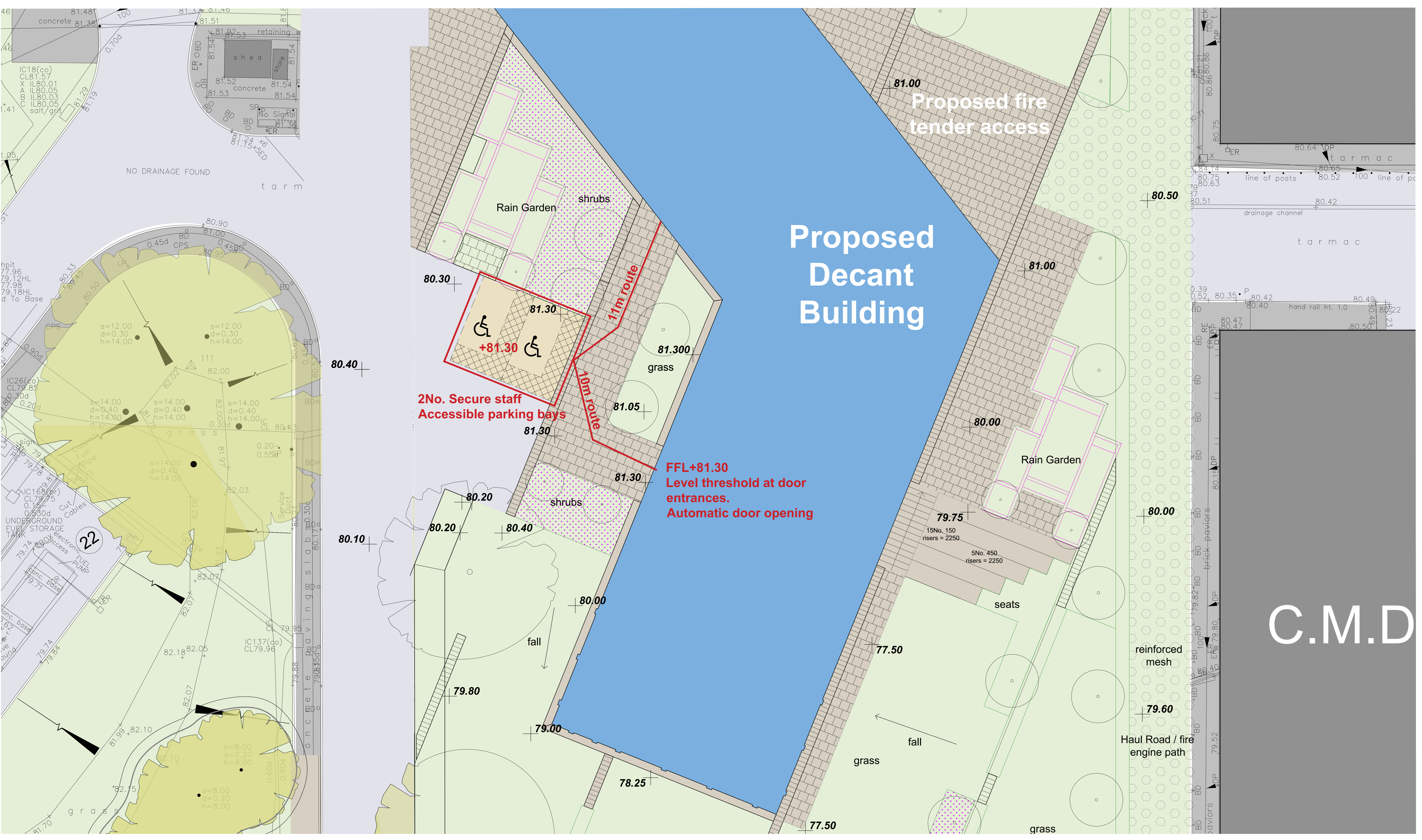

C.M.D

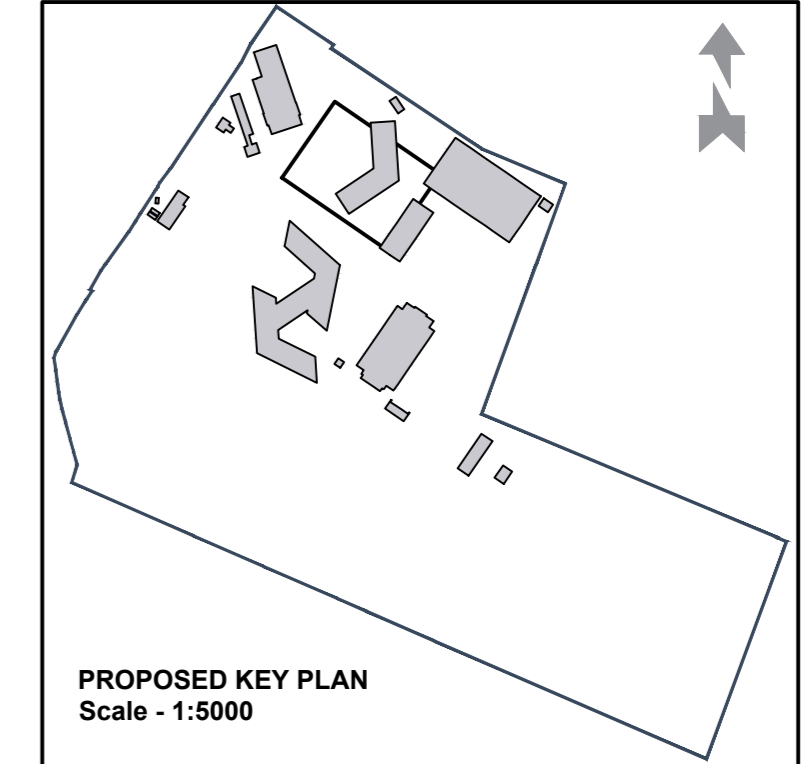
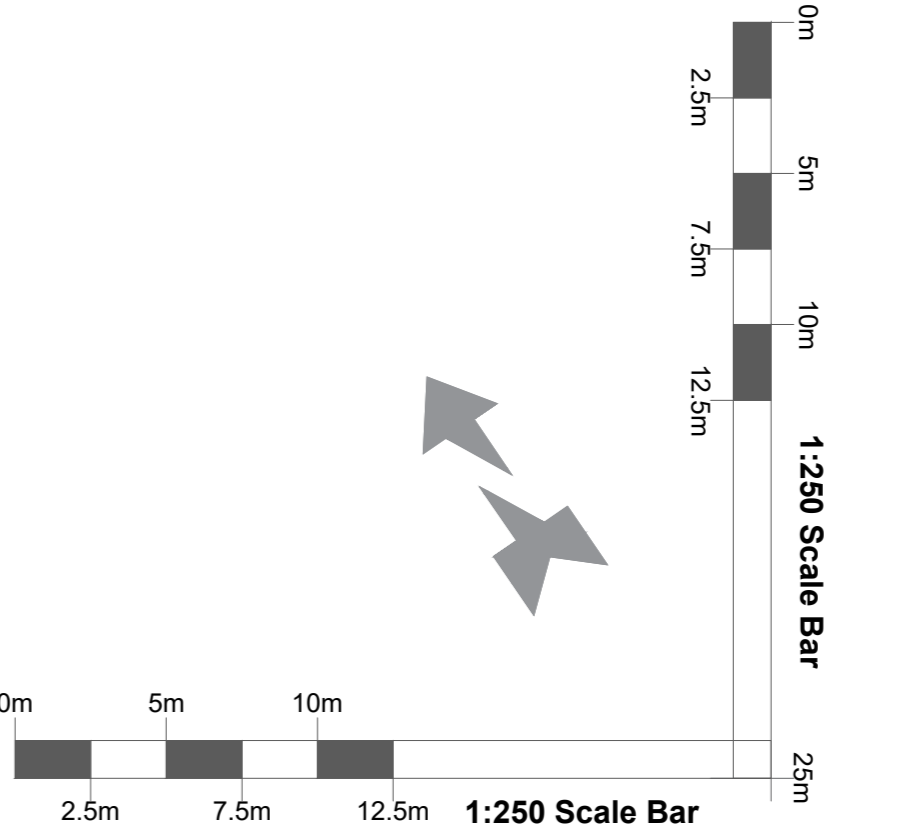

FILE PATH: N:\7645-Project-Phoenix-Headquarters-VGA-Drawing\20-Working-Drawing\Planning-conditions-amendments\ICHD-VGA-XX-XX-DR-AR-00142-Proposed-Accessible-parking-Decant.dwg 09/14