

Area Schedule (GIA)	
Level	Area
LG_FFL	960.3 m <sup>2</sup>
00_FFL	2,214.6 m <sup>2</sup>
01_FFL	2,289.2 m <sup>2</sup>
02_FFL	2,155.0 m <sup>2</sup>
03_FFL	2,079.7 m <sup>2</sup>
	9,698.7 m <sup>2</sup>

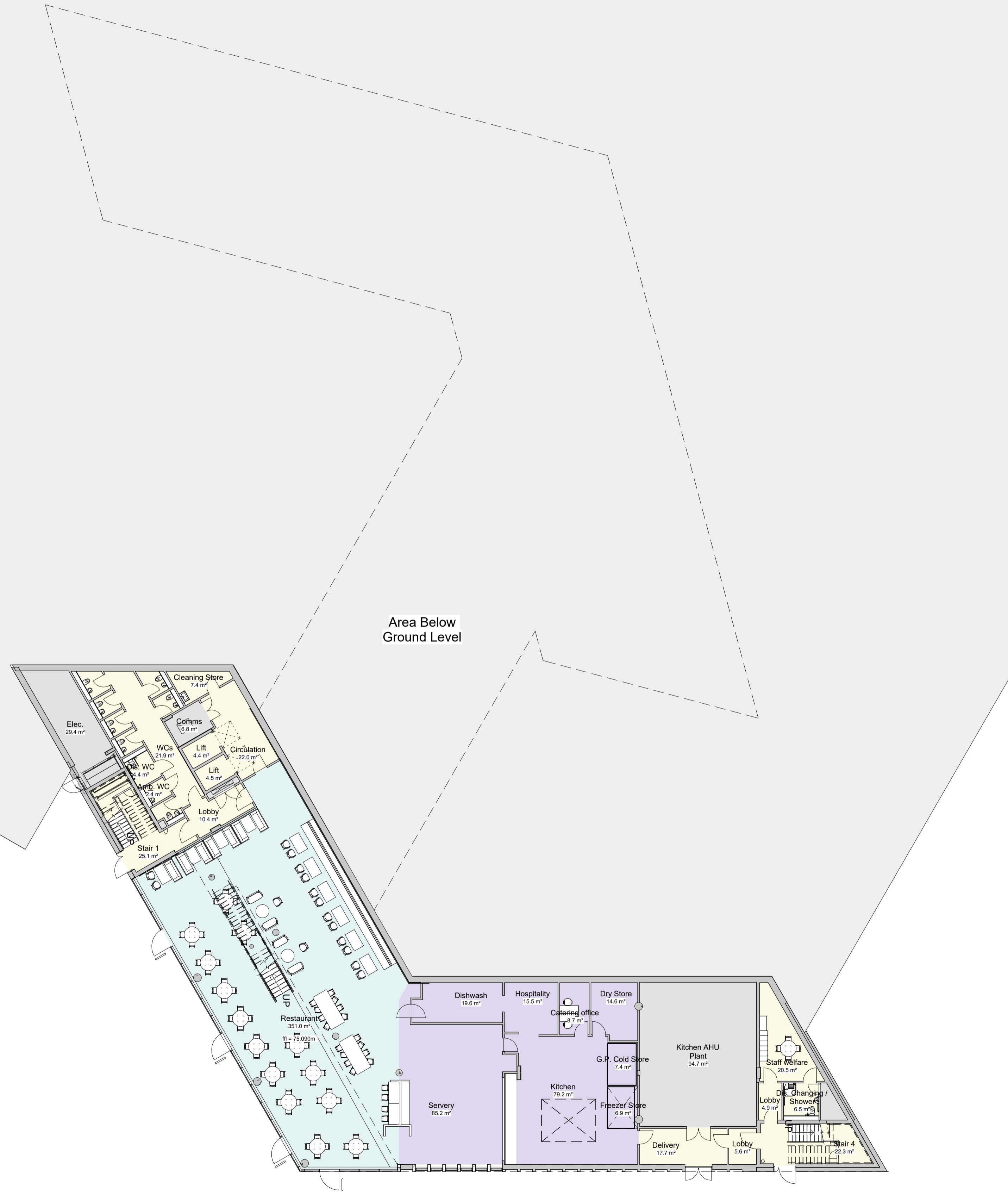

PL03	General amendments.	22/01/24	SC
PL02	Amendments to layout.	05/09/22	SC
PL01	For planning approval.	09/07/21	SC
REV		DATE	BY

**HERTFORDSHIRE CONSTABULARY,  
HEADQUARTERS REDEVELOPMENT,  
STANBOROUGH**

**Proposed Headquarters Building  
Proposed Lower Ground Floor Plan**

VGA PROJECT NUMBER		L&L
<b>7645</b>		
DRAWING REFERENCE		REV
<b>HCHQ-VGA-HQ-LG-DR-AR-00249</b>		<b>PL03</b>
DRAWN / DATE	CHECKED / DATE	SCALE
SC JAN 24	MC JAN 24	1 : 200

**PLANNING ISSUE**

Written dimensions to be taken. Do not scale off the drawings. Any discrepancies written or scaled should be brought to the attention of the architect immediately. All drawings should be read together and in conjunction with relevant related specifications, room data sheets and all other consultant's information.

T: +44 (0) 1438 316 331  
architects@vincent-gorbing.co.uk  
vincent-gorbing.co.uk

Vincent and Gorbing Limited, Sterling Court  
Norton Road, Stevenage, Hertfordshire SG1 2JY  
© Copyright Vincent and Gorbing Limited 2017.

