

Roof Plan

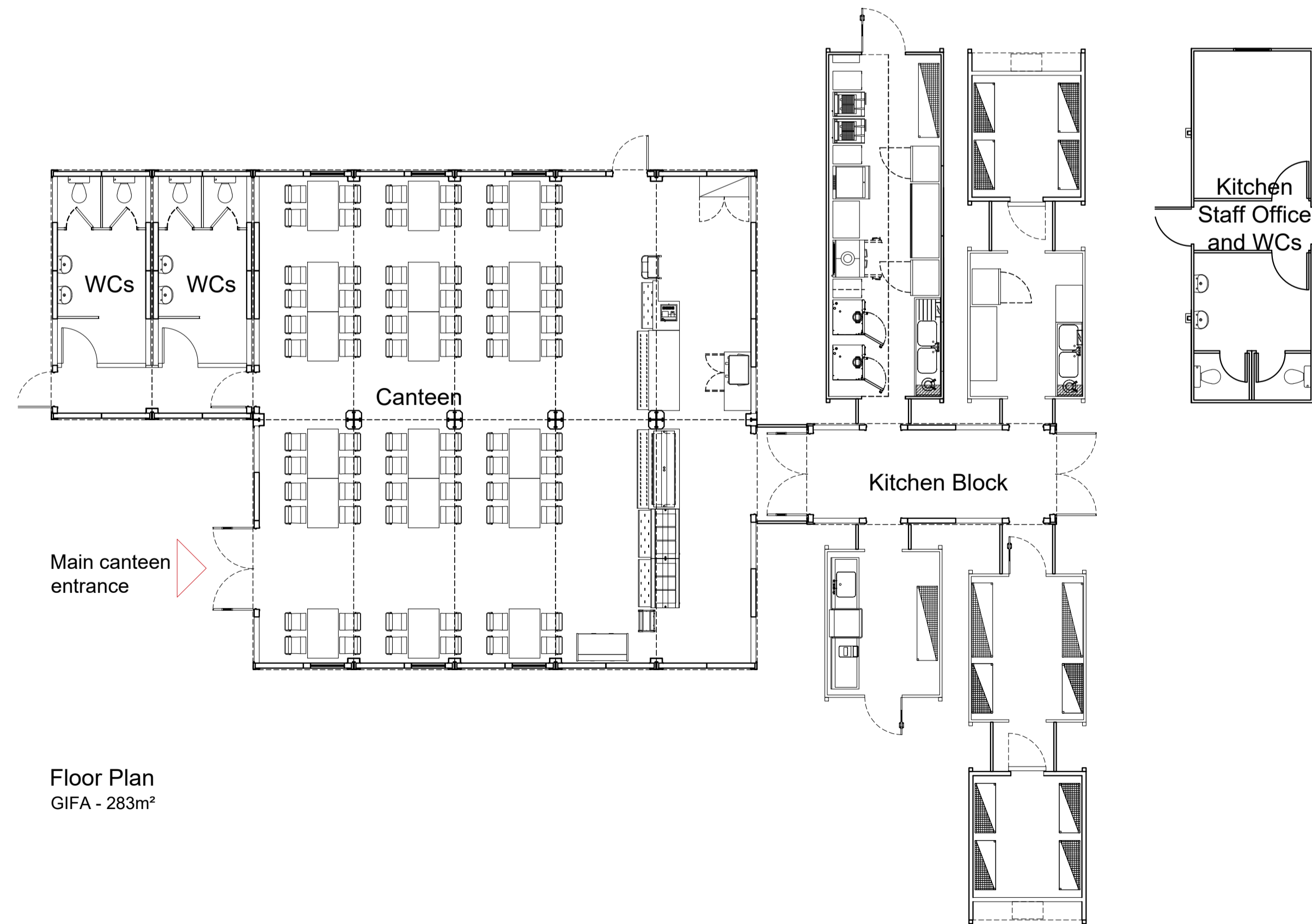

Floor Plan
GIFA - 283m²

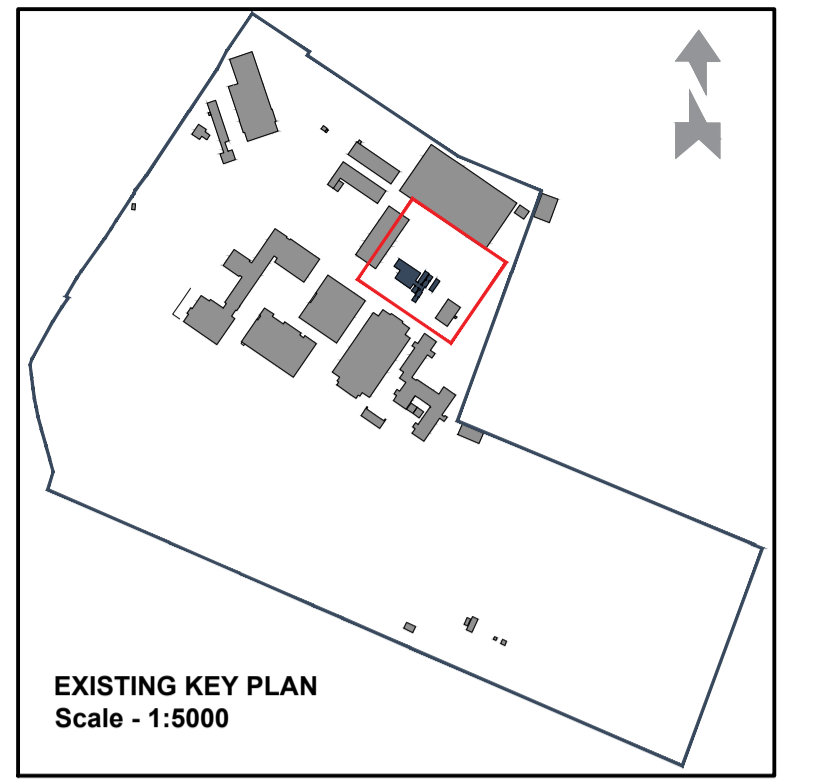

EXISTING KEY PLAN
Scale - 1:5000

PL01	For planning approval	09.07.21	NK
REV	DESCRIPTION	DATE	BY

**HERTFORDSHIRE CONSTABULARY,
HEADQUARTERS REDEVELOPMENT,
STANBOROUGH**

**Temporary Kitchen and Canteen
Proposed Floor Plan and Roof Plan**

VGA PROJECT NUMBER		L&L
7645		
DRAWING NO		REV
HCHQ-VGA-EW-ZZ-DR-AR-00541		PL01
DRAWN / DATE	CHECKED / DATE	SCALE
NK JUL 21	MC JUL 21	1:100 at A1

PLANNING ISSUE

Written dimensions to be taken. Do not scale off the drawings. Any discrepancies written or scaled should be brought to the attention of the architect immediately. All drawings should be read together and in conjunction with relevant related specifications, room data sheets and all other consultant's information.

T: +44 (0) 1438 316 331
architects@vincent-gorbing.co.uk
vincent-gorbing.co.uk
Vincent and Corbing Limited, Sterling Court
Norton Road, Stevenage, Hertfordshire SG1 2JY
© Copyright Vincent and Corbing Limited 2020

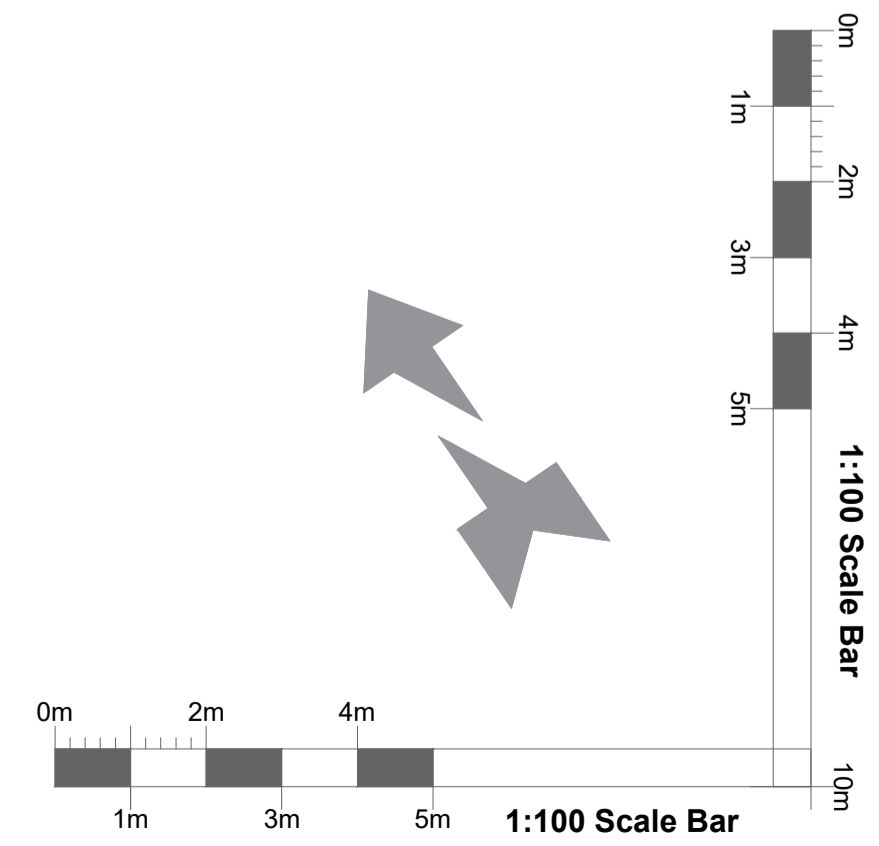

0mm A1 ORIGINAL SCALE 50mm A1 ORIGINAL SCALE 100mm

08/07/2021 - 12:13:28