



Extract of Existing Site Plan



Extract of Proposed Site Plan

LEGEND

	Application boundary
	HCHQ Site boundary
	Building entrances
	Existing buildings
	Road / tarmac
	Paths
	Grass
	Vegetation
	Existing tree

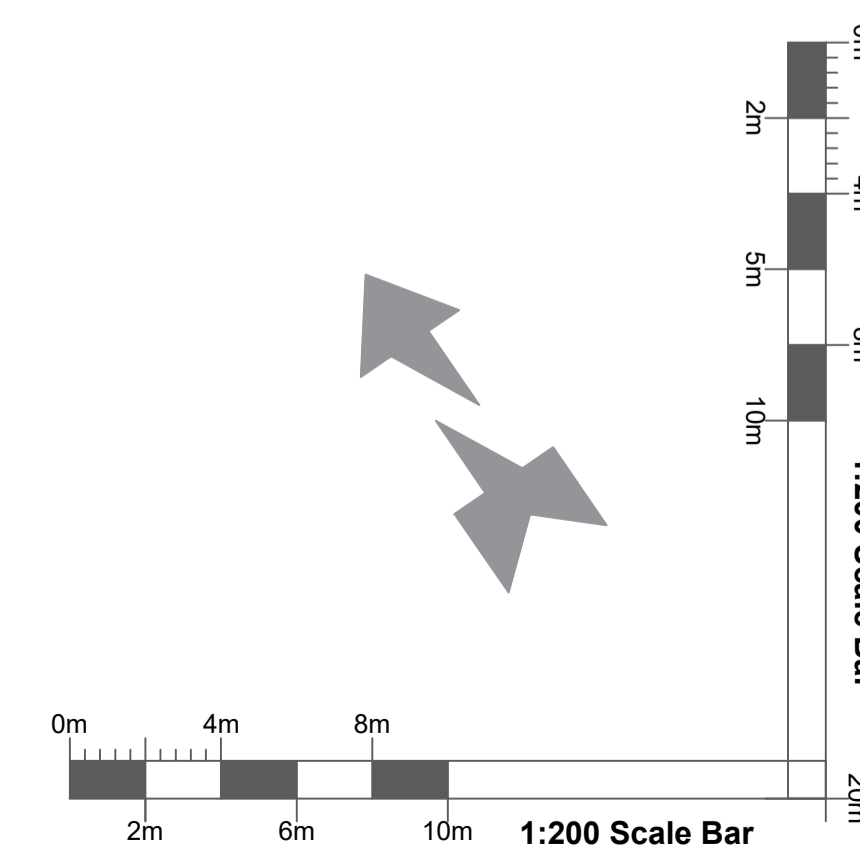
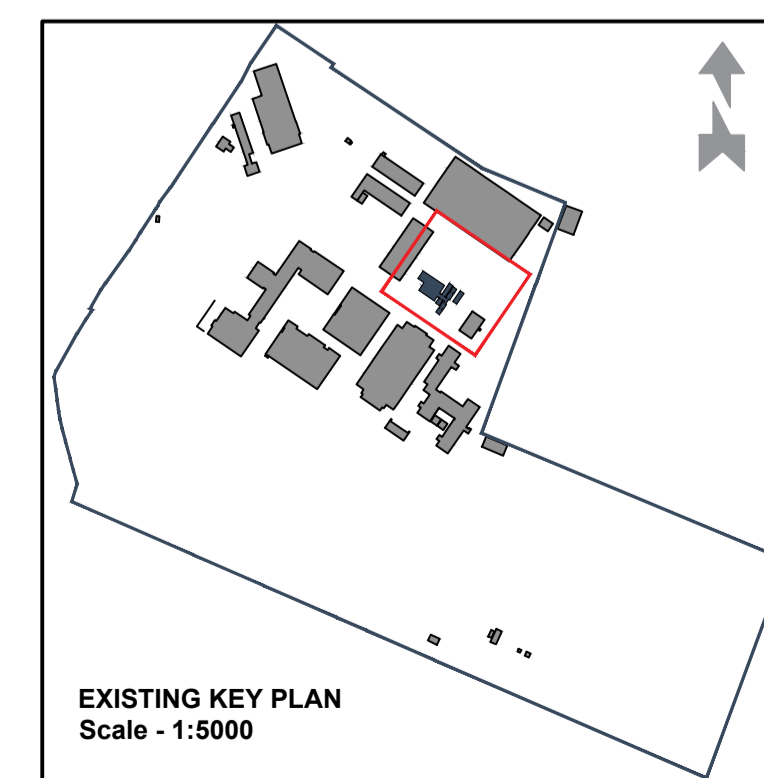

PL01	For planning approval	09.07.21	NK
REV	DESCRIPTION	DATE	BY

**HERTFORDSHIRE CONSTABULARY,
HEADQUARTERS REDEVELOPMENT,
STANBOROUGH**

**Temporary Kitchen and Canteen
Existing and Proposed Site Plan extracts**

VGA PROJECT NUMBER		L&L
7645		
DRAWING NO		REV
HCHQ-VGA-EW-XX-DR-AR-00540		PL01
DRAWN / DATE	CHECKED / DATE	SCALE
NK JUL 21	MC JUL21	1:200 at A1

PLANNING ISSUE

Written dimensions to be taken. Do not scale off the drawings. Any discrepancies written or scaled should be brought to the attention of the architect immediately. All drawings should be read together and in conjunction with relevant related specifications, room data sheets and all other consultant's information.

T: +44 (0) 1438 316 331
architects@vincent-gorbing.co.uk
vincent-gorbing.co.uk
Vincent and Corbin Limited, Sterling Court
Norton Road, Stevenage, Hertfordshire SG1 2JY
© Copyright Vincent and Corbin Limited 2020

