

COMMS TOWER & PLANT GIFA

Plant compound: 227m<sup>2</sup>  
**TOTAL: 227m<sup>2</sup>\***

\*Not included in existing built floor area

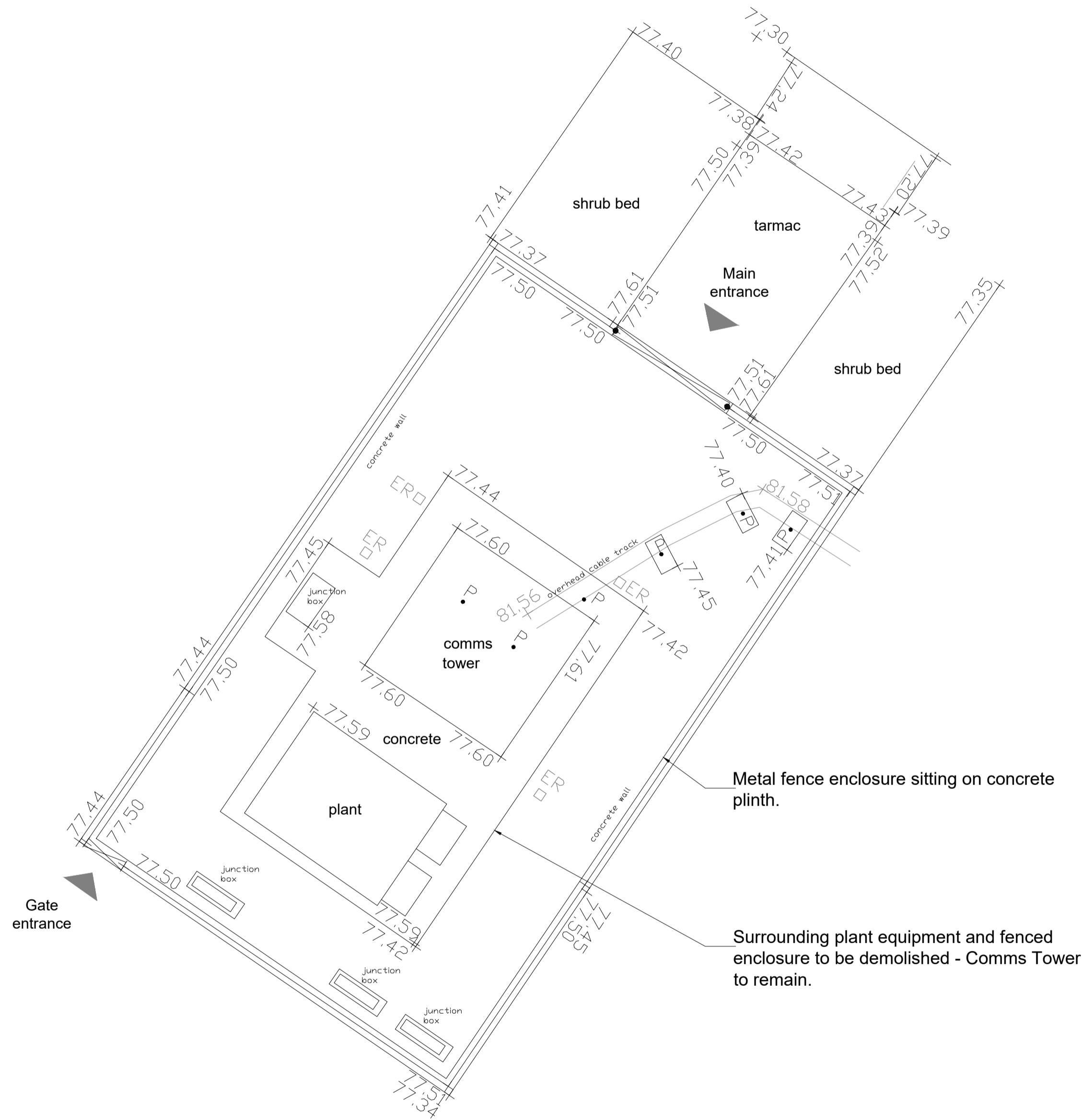

00 Ground Floor Plan

PL01	For planning approval	09.07.21	CB
REV	DESCRIPTION	DATE	BY

**HERTFORDSHIRE CONSTABULARY,  
 HEADQUARTERS REDEVELOPMENT,  
 STANBOROUGH**

**Comms Tower and Plant  
 Existing Floor Plan**

VGA PROJECT NUMBER		L&L
<b>7645</b>		
DRAWING NO		REV
<b>HCHQ-VGA- CT-00-DR-AR-00 186</b>		<b>PL01</b>
DRAWN / DATE	CHECKED / DATE	SCALE
CB JUL 21	MC JUL 21	1:100 at A1

PLANNING ISSUE

Written dimensions to be taken. Do not scale off the drawings. Any discrepancies written or scaled should be brought to the attention of the architect immediately. All drawings should be read together and in conjunction with relevant related specifications, room data sheets and all other consultant's information.

T: +44 (0) 1438 316 331  
 architects@vincent-gorling.co.uk  
 vincent-gorling.co.uk  
 Vincent and Corbing Limited, Sterling Court  
 Norton Road, Stevenage, Hertfordshire SG1 2JY  
 © Copyright Vincent and Corbing Limited 2020

