

Catchment 1 - Drains to Outfall A unrestricted
 Catchment 2 - Drains to Outfall B unrestricted
 Catchment 3 - Drains to Outfall B restricted

Discharge rates subject to further assessment.

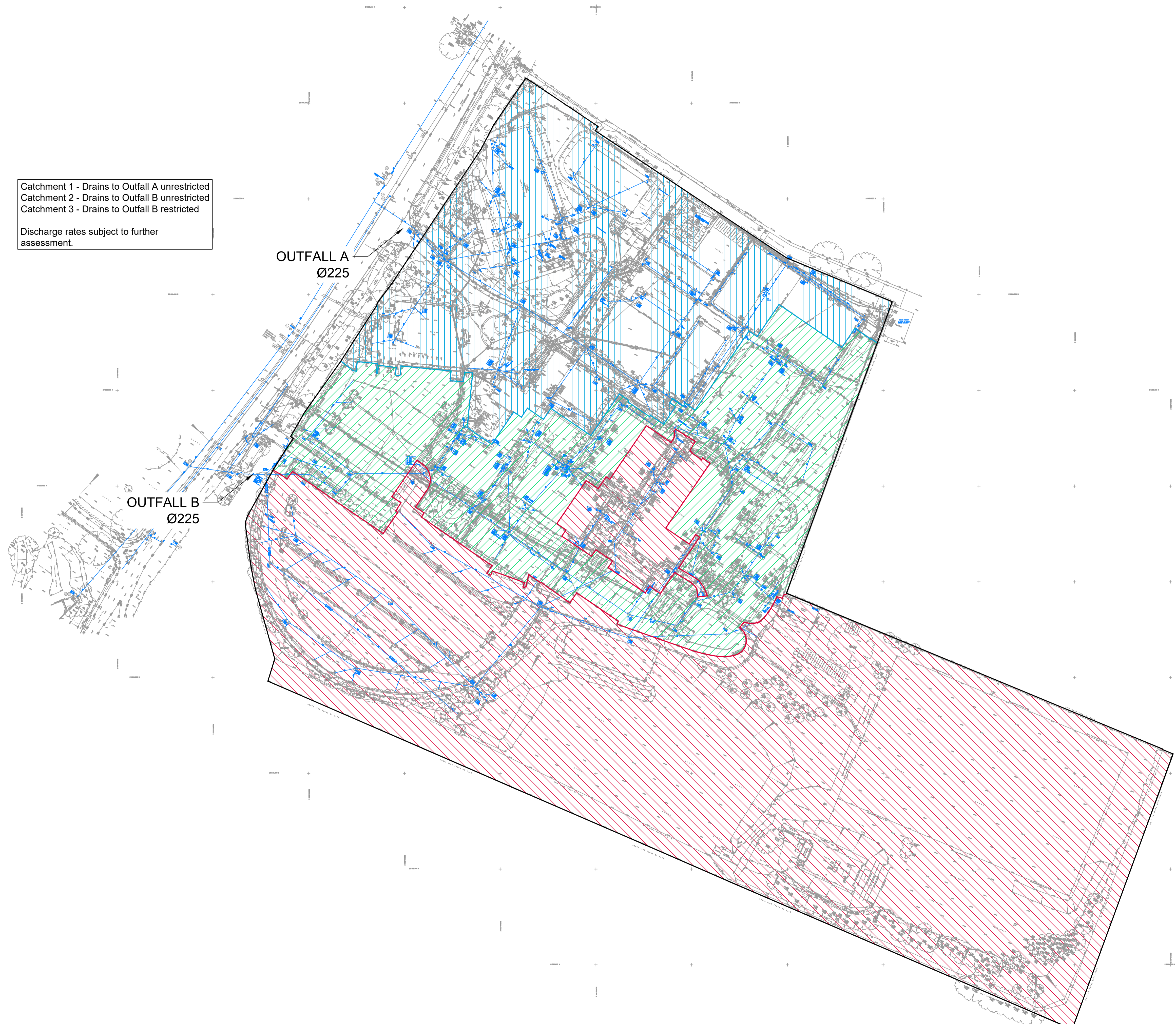

PROJECT
HCHQ REDEVELOPMENT
 HERTFORDSHIRE CONSTABULARY HQ
 Stanborough Rd
 Welwyn Garden City
 AL8 6XF

CLIENT
HERTFORDSHIRE CONSTABULARY
 Stanborough Rd
 Welwyn Garden City

CONSULTANT
 AECOM
 63-77 Victoria Street
 St Albans
 Herts, AL1 3ER
 United Kingdom

T +44 (0)1727 535000
 www.aecom.com

- NOTES**
- Do not scale from the drawing
 - All levels shown are in meters Above Ordnance Datum (AOD) unless stated otherwise

LEGEND

	Catchment 1 Total Area 2.57ha
	Catchment 1 Drained Area TBC
	Catchment 2 Total Area 2.46ha
	Catchment 2 Drained Area TBC
	Catchment 3 Total Area 6.48ha
	Catchment 3 Drained Area TBC
	Site Boundary Area 11.50ha

ISSUE/REVISION

Rev	Date	Detail	Made	Chk'd	App'd
P01	19.11.20	First Issue		TR	CP

KEY PLAN

PROJECT NUMBER
 60600329

SHEET TITLE
 Existing Catchment Plan

SHEET NUMBER
 ZZ-XX-DR-CE-0002

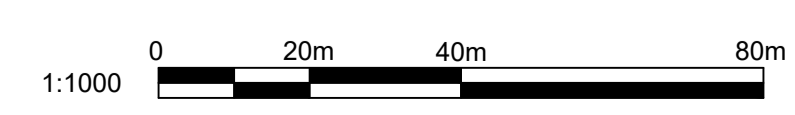

This drawing has been prepared for the use of AECOM's client. It may not be used, modified, reproduced or relied upon by third parties, except as agreed by AECOM or as required by law. AECOM accepts no responsibility, and denies any liability, whatsoever, to any party that uses or relies on this drawing without AECOM's express written consent. Do not scale this document. All measurements must be obtained from the stated dimensions.