

**Notes**  
**Planting:**  
 Imported topsoil to be to BS3882 multipurpose grade laid at 450mm depth for planting areas and 150mm for grass areas.  
 Topsoil to be lightweight mix sourced from Bourne Amenity or equivalent to be placed into planters over suitable depth of drainage layer with geotextile separation layer.  
 Planting beds to be ameliorated with organic compost and slow-release fertilizer.  
 Grass areas to be laid with 50mm depth ornamental bark.  
 Grass areas to be laid with good quality turf.  
 All tree pits to be large enough to accommodate root balls with backfill mix comprising of excavated soil mixed with organic compost and slow-release fertilizer.  
 Large trees to be secured with underground dead men anchors.  
 Smaller trees to be secured with double timber stakes and rubber belt ties.  
 Trees to be mulched at base in grass areas.  
 Spirals and canes to be installed to Fagus sylvatica hedging and Crataegus shrubs.

**Maintenance:**  
 Grass to be mown weekly between the months of March and October. Cut down to a minimum height of 50mm all arising to be collected. Additional cuts may be required out of these months depending on weather.  
 Beds to be kept weed free using both hand weeding and the application of a non-selective herbicide.  
 Plants to be pruned twice a year as appropriate for the species.  
 Watering to be undertaken on a regular basis during any dry spells.  
 Bark mulch to be topped up at the end of each growing season to a finished depth of 50mm.

**Planting Schedule:**

| Species                | Size/Form                            | Density                     |
|------------------------|--------------------------------------|-----------------------------|
| <b>Specimen Shrubs</b> |                                      |                             |
| Sp81                   | Buxus Cone                           | 90/100cm high               |
| Sp82                   | Buxus Ball                           | 50/60cm dia                 |
| Sp83                   | Shrubs                               | 80/100cm high               |
| <b>Phormium Tenax</b>  |                                      |                             |
| S1                     | Lavandula stoechas fathead           | 30/40cm SL 3m <sup>2</sup>  |
| S2                     | Rosa Kent                            | 30/40cm SL 5m <sup>2</sup>  |
| S3                     | Hebe rakaiensis                      | 30/40cm SL 3m <sup>2</sup>  |
| S4                     | Carex elata Aurea                    | 30/40cm SL 5m <sup>2</sup>  |
| S5                     | Deschampsia cespitosa Northern light | 40/60cm 10L 3m <sup>2</sup> |
| S6                     | Festuca glauca                       | 30/40cm SL 3m <sup>2</sup>  |
| S7                     | Ophiopogon nigrescens                | 30/40cm SL 3m <sup>2</sup>  |
| S8                     | Ceanothus Thyrs. repens              | 30/40cm 3L 5m <sup>2</sup>  |

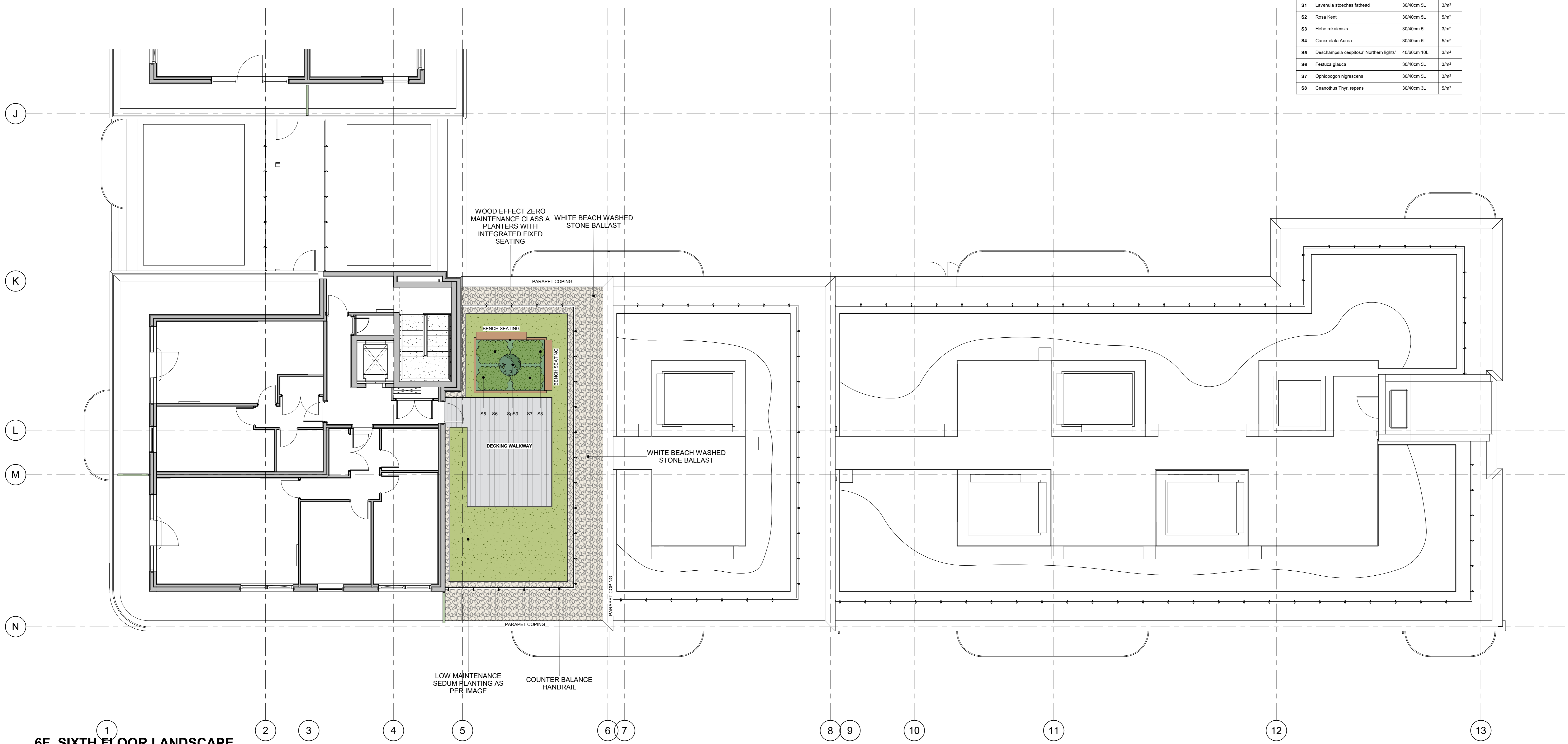

**6F. SIXTH FLOOR LANDSCAPE**  
 1 : 75

**Soft Landscaping Scheme:**



FOCAL SHRUBS AND GRASSES

EVERGREEN SHRUBS

HERBACEOUS PERENNIAL GRASS

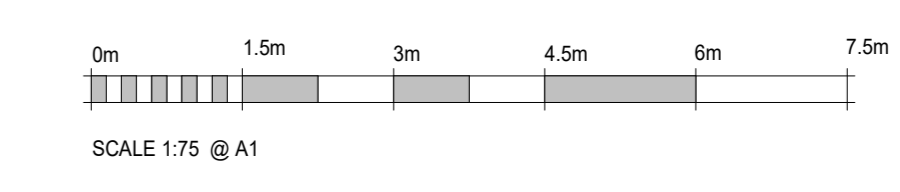

| Rev | Date     | Description        |
|-----|----------|--------------------|
| R02 | 09.08.23 | NMA Application    |
| R01 | 24.08.22 | ISSUED FOR COMMENT |

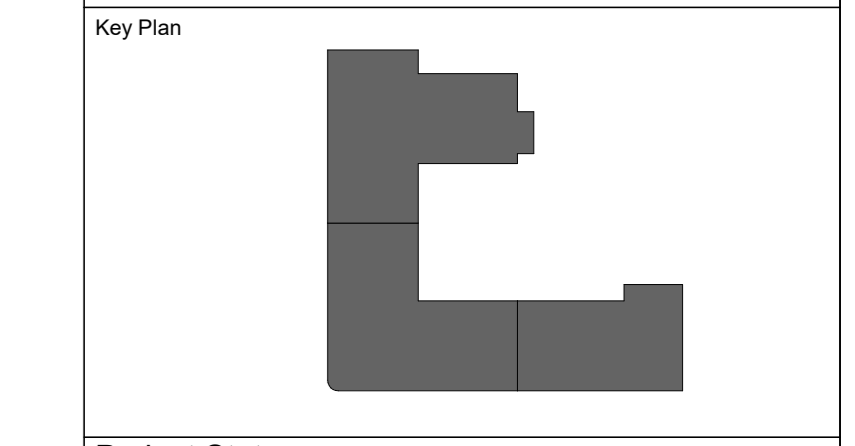

**Project Status**  
 FOR CONSTRUCTION

**Client**  

 Modern, sustainable building  
 Unit 8 Carnival Park, Carnival Close, Basildon SS14 3WN

**RVT ARCHITECT**  
 4a Old Lodge Lane, Purley, CR8 4DE.  
 T +44 203 740 2130  
 E info@rvtarchitects.com  
 W rvtarchitects.com

**Project Name & Address**  
 VOLKSWAGEN HATFIELD  
 COMET WAY, HATFIELD, AL10 9TF  
**Building Type**  
 RESIDENTIAL DEVELOPMENT

**Drawing Title**  
 AMENDED LANDSCAPE- SIXTH FLOOR

|                             |       |                  |            |
|-----------------------------|-------|------------------|------------|
| Drawn By                    | F.P   | Date             | 03.10.2022 |
| Checked By                  | F.J   | Date             | 13.10.2022 |
| Approved By                 | B.R   | Date             | 14.10.2022 |
| <b>Drawing Number</b>       |       |                  |            |
| HAT-RDB-XX-06-DR-A-LND-0206 |       |                  |            |
| Sheet No.                   | Scale | Orig. Sheet Size | Rev.       |
| 03 of 03                    | 1:75  | @ A0             | R02        |