

Notes
Planting:
 Imported topsoil to be to BS3882 multipurpose grade laid at 450mm depth for planting areas and 150mm for grass areas.
 Topsoil to be lightweight mix sourced from Bourne Amenity or equivalent to be placed into planters over suitable depth of drainage layer with geotextile separation layer.
 Planting beds to be ameliorated with organic compost and slow-release fertilizer.
 Beds to be mulched with 50mm depth ornamental bark.
 Grass areas to be laid with good quality turf.
 All tree pits to be large enough to accommodate root balls with backfill mix comprising of excavated soil mixed with organic compost and slow-release fertilizer.
 Large trees to be secured with underground dead men anchors.
 Smaller trees to be secured with double timber stakes and rubber belt ties.
 Trees to be mulched at base in grass areas.
 Spirals and canes to be installed to Fagus sylvatica hedging and Crataegus shrubs.

Maintenance:
 Grass to be box mown weekly between the months of March and October. Cut down to a minimum height of 50mm all arising to be collected. Additional cuts may be required out of these months depending on weather.
 Beds to be kept weed free using both hand weeding and the application of a non-selective herbicide.
 Plants to be pruned twice a year as appropriate for the species.
 Watering to be undertaken on a regular basis during any dry spells.
 Bark mulch to be topped up at the end of each growing season to a finished depth of 50mm.

Planting Schedule:

Species	Size/Form	Form/Density
Trees		
T1	Fagus sylvatica	18/18cm RB
T2	Gleditsia triacanthos 'Sunburst'	12/14cm RB
T3	Crataegus monogyna Striata	12/14cm RB
T4	Betula jacquemontii	2.55-3.00m MS RB
T5	Betula pendula	18/20cm RB
T6	Amygdalier canadensis	1.50-1.75m MS RB
Hedges		
H1	Fagus sylvatica	90/120cm BR 5 per LM
H2	Prunella F. Red Robin	60/80cm 3L 5 per LM
Shrubs		
S1	Pachysandra terminalis Green Carpet	20/30cm 2L 7 per m ²
S2	Lavandula angustifolia Hidcote Blue	20/30cm 2L 5 per m ²
S3	Euonymus Jap. Bravo	40/60cm 5L 3 per m ²
S4	Cornus sang. Midwinter Fire	40/60cm 3L 5 per m ²
S5	Carex elata Aurea	30/40cm 5L 5 per m ²
S6	Lonicera Maygreen	20/30cm 2L 7 per m ²

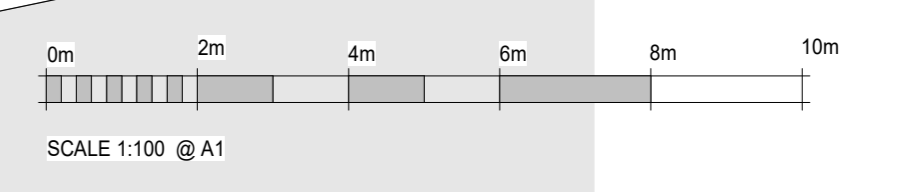

Rev	Date	Description
R02	09.08.23	NMA Application
R01	24.08.22	ISSUED FOR COMMENT

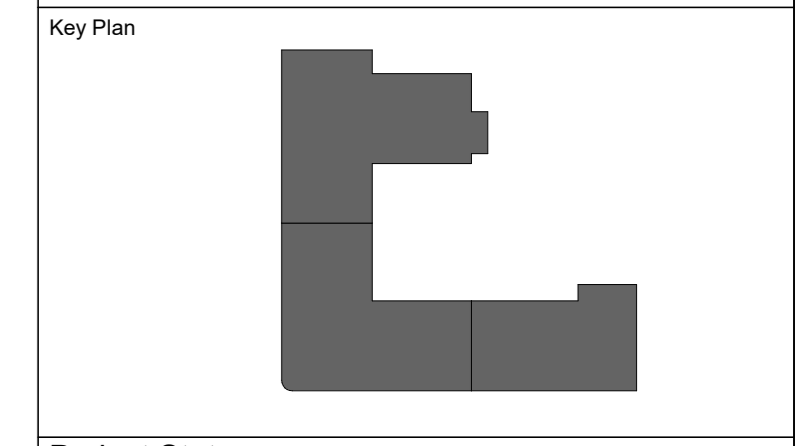

Project Status
 FOR CONSTRUCTION



RVT ARCHITECT
 4a Old Lodge Lane,
 Purley, CR8 4DE.
 T +44 203 740 2130
 E info@rvtarchitects.com
 W rvtarchitects.com

Project Name & Address
VOLKSWAGEN HATFIELD
 COMET WAY, HATFIELD, AL10 9TF
 Residential Development

Drawing Title
AMENDED LANDSCAPE-GROUND FLOOR

Drawn By	F.P	Date	03.10.2022
Checked By	F.J	Date	13.10.2022
Approved By	B.R	Date	14.10.2022
Drawing Number	HAT-RDB-XX-00-DR-A-LND-0200		
Sheet No.	Scale	Orig. Sheet Size	Rev.
01 of 01	1:100	@A0	R02