

THIS INFORMATION IS CONFIDENTIAL AND THE PROPERTY OF SIRIUS. IT IS RELEASED ON CONDITION THAT NONE OF THE INFORMATION SHALL BE DISCLOSED TO ANY THIRD PARTY OR REPRODUCED IN WHOLE OR PART WITHOUT THE PRIOR CONSENT IN WRITING OF SIRIUS.

KEY

- GAS PROPOSED UNDERGROUND GAS MAIN
- PROPOSED UNDERGROUND ELECTRICITY CABLE

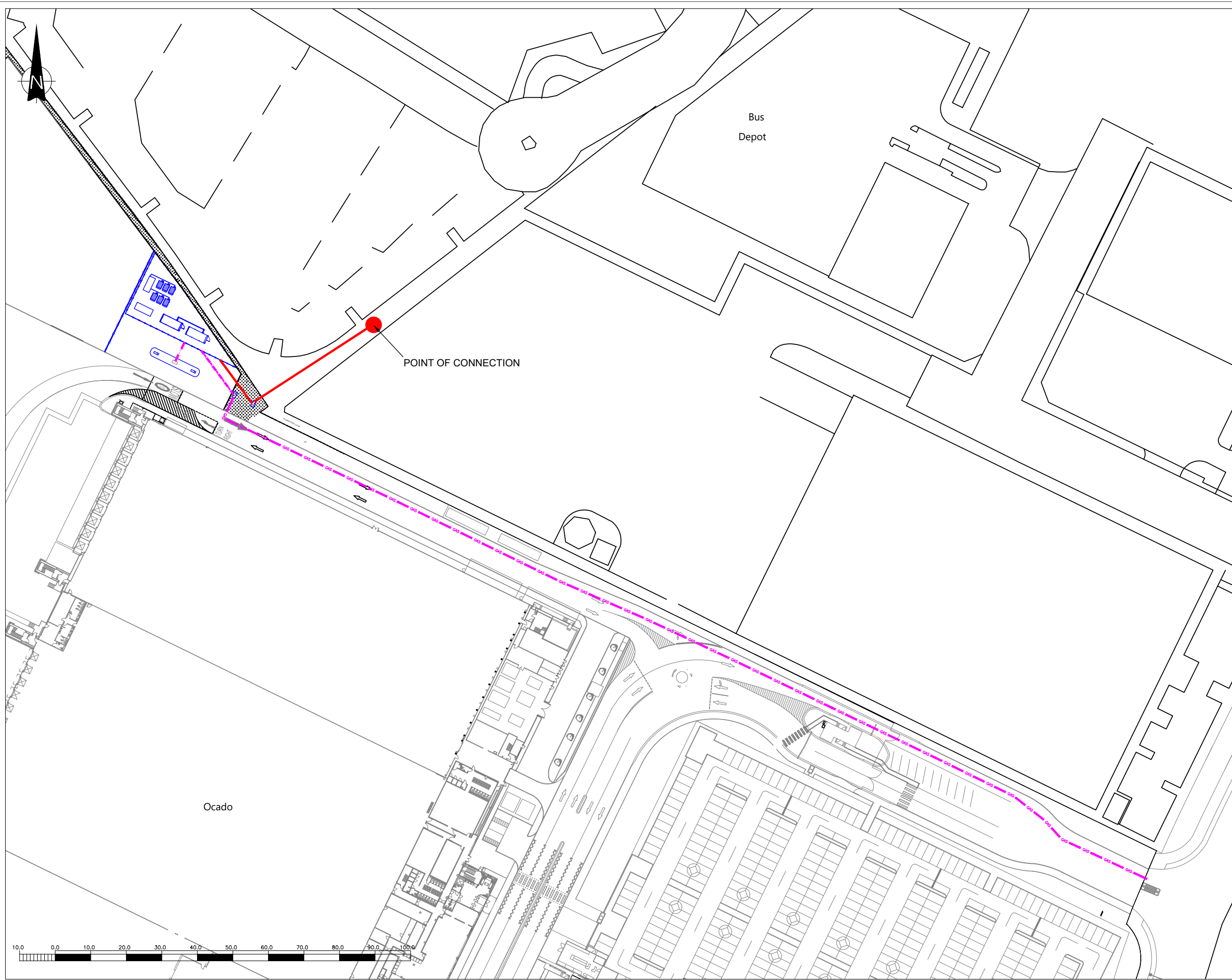

REV	DESCRIPTION	DATE	BY

CLIENT



4245 Park Approach, Thorpe Park, Leeds. LS15 8GB. 0113 264 9960

JOB TITLE
CNG REFUELLING STATION,
OCADO, HATFIELD

DRAWING TITLE
PROPOSED SERVICES

DRAWN	DATE	APPROVED	DATE
S.T	15/5/2018	D.B	15/5/2018

SCALE	SHEET	DRAWING NUMBER	REVISION
1:1000	A3L	GR1043/01/05	0