

**PROPOSED FLOOR LAYOUT**

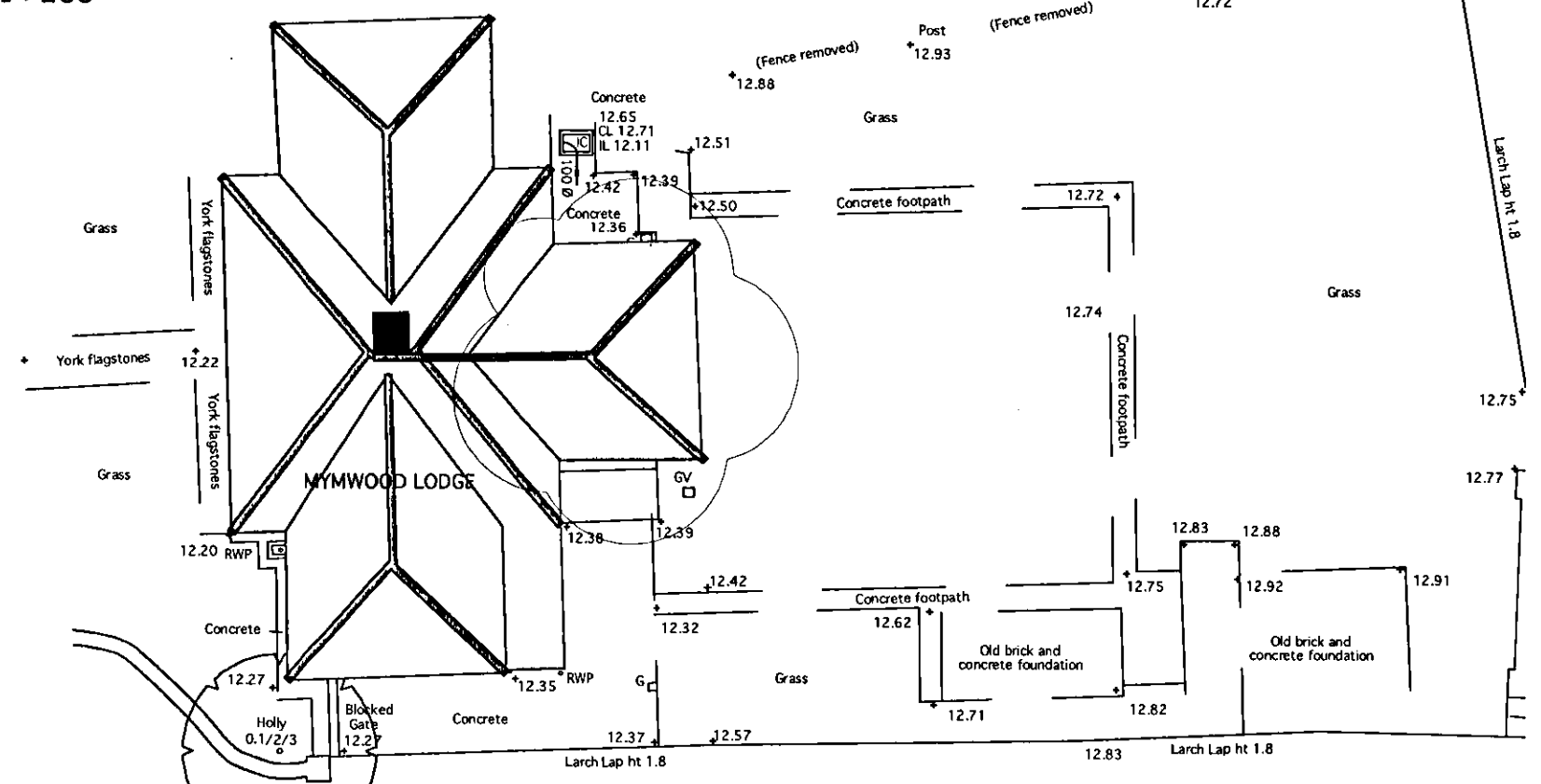
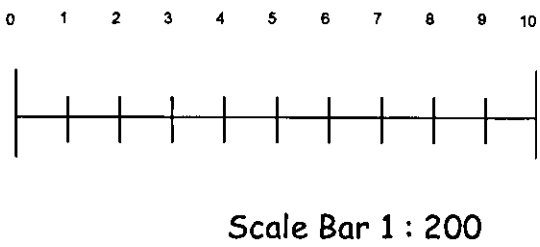
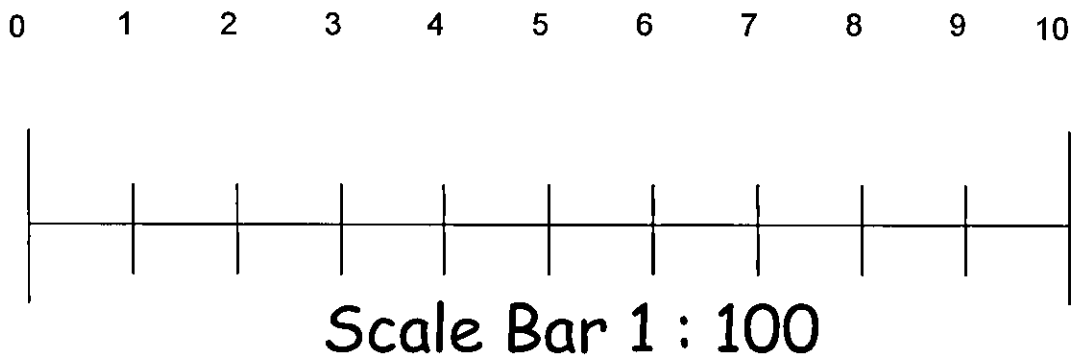

**PROPOSED SITE LAYOUT**

**Proposed Alterations and Extensions to  
The Coach House at  
Mymwood House, Shepherds Way,  
Brookmans Park, AL9 6NN**

**Drawing Title : Amended Planning Scheme Details**

**John Dickie Associates  
Manor Barn,  
Wilthorpe, Stamford,  
Lincs Pe9 4pe**

**Tel 01778 560811  
Fax 01778 561167**

**Client : Harrington Care  
Date May 2009  
Scales 1 to 100 1 to 200  
Drawing No JDA/0/9175/PL.REV/007A  
Rev A May 29th 2009 Staff meeting room  
reduced in depth to match the other two 'extensions'.**

**AMENDMENT  
29 MAY 2009  
NO: 56/2009/S65/C03**