

Sewer details shown are taken from Thames Water records and CCTV survey and are to be confirmed by Contractor prior to commencement of the works

Surface Water discharge point subject to approval by Thames Water

Location of existing services along drainage route to be confirmed by Contractor prior to any start of works

This drawing and the building works depicted are the copyright of Farrow Walsh consulting Ltd. and may not be reproduced or amended except by written permission. No liability will be accepted for amendments made by other persons.

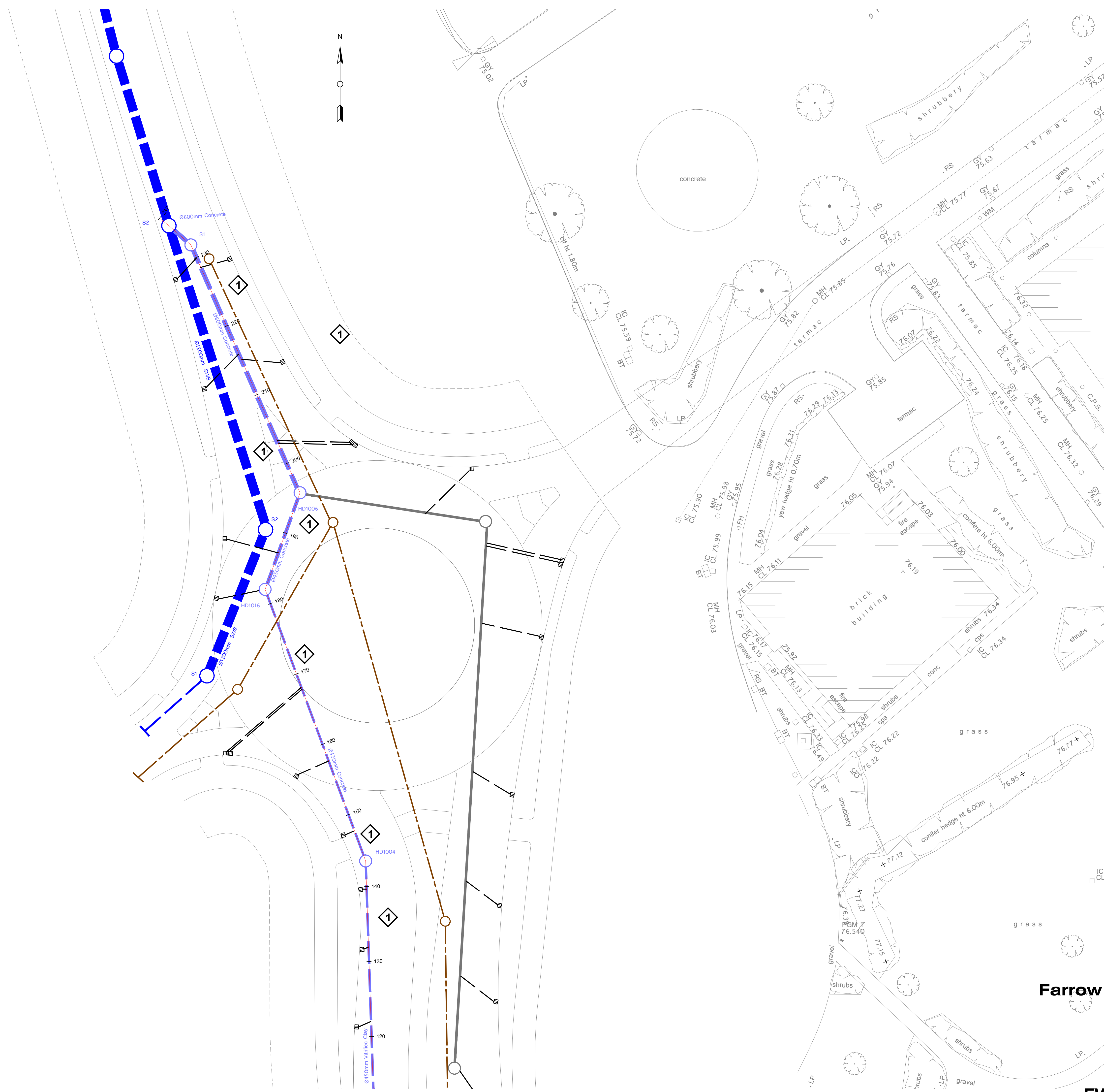

- General Notes**
- DO NOT SCALE.
 - This drawing is to be read in conjunction with all other relevant drawings and details.
 - Should there be any conflict between the details indicated on this drawing and those on other drawings the Engineer should be informed PRIOR to construction on site.
 - Until technical approval has been obtained from the relevant Authority, it should be understood that all drawings issued are Preliminary and NOT for construction. Should the contractor commence site work prior to such approval being given it is entirely at his own risk.
 - Sketch proposals are for illustrative purposes only & as such are subject to detailed site investigation including ground conditions / contaminants, drainage, design & planning/density negotiations.
 - All dimensions are in millimetres unless otherwise stated.
 - The Farrow Walsh Consulting Designers Risk Assessments for this project must be reviewed PRIOR to the commencement of any works on site.

- NOTES**
- This Drawing is to be read in conjunction with:
- FW1263 800 S102 Layout Sheet 1 of 2
 FW1263 801 S102 Layout Sheet 2 of 2
 FW1263 802 S102 Long Sections
- This drawing is to be read in conjunction with all other relevant Engineers and Architect's details.
 - All work is to be carried out in accordance with the current British Standards, codes of practice, building regulations and with Sewers for Adoption 6th Edition guidance.
 - The exact position, level, size and use of existing sewers to be confirmed on site. Any discrepancies to be reported to the engineer prior to commencement of works.
 - All uncovered and shallow pipework to be protected against construction traffic as part of the contractors temporary works requirements.
 - Cover levels shown are approximate only, subject to the Architect's external works and landscaping scheme.
 - All connections to road gullies and channels shall be 150mm nominal bore pipework.
 - All pipework to be Vitrified Clay to BS EN295 unless otherwise noted.
 - All pipes connecting to adopted manholes up to and including 300mm dia. to be Vitrified Clay.
 - All pipes connecting to adopted manholes greater than 300mm dia. to be Concrete.
 - All pipework entering and exiting manholes to be connected with pipe soffits level.

- LEGEND**
- Boundary of Site Ownership
 - S104 Foul Sewer
 - S104 Surface Water Sewer
 - Existing Highway Drain
 - Existing Highway Drain to be Adopted Under S102
 - Surface Water connection under S106
 - Section 38 SW Road Gully
 - Existing highway drain to be offered for adoption under Section 102 to Thames Water. The extent of adoption TBC by Thames Water

S106 Thames Water Technical Approval for the foul connection granted on the 07/04/18.

S106 Thames Water Technical Approval for the surface water connection granted on the 07/04/18.

A Drawing revised to accommodate TW comments dated 22/08/18. 05.09.18 op jd
 Revision

PRELIMINARY

JOB: COMET HOTEL, HATFIELD
S102 LAYOUT SHEET 2 OF 2

Farrow Walsh consulting Ltd

Second Floor
 48 Cank Street
 Leicester LE1 5GW
 t 0116 251 5558
 w www.farrowwalsh.com

DRAWN: op
SCALE: 1:250 @ A1
DATE: June 2018
CHECKED: jd

FW1263 801A