

Existing North Gates 1:200

WELWYN HATFIELD
 PLANNING
 OFFICE COPY
 19 APR 2007
 No: *56/2007/625/B*

WELWYN

GREAT NAST HYDE HOUSE EXISTING NORTH GATES
 PLAN
 Scale 1:200 Date Oct 2003
 Drawn NRH
 No. *6103/14/005*
 Rev. -

RUSSELL TAYLOR ARCHITECTS
 www.rtaarchitects.co.uk
 LONDON
 CORNWALL
 TEL: 020 7261 1984
 TEL: 01503 273 092
 © Russell Taylor Architects own the copyright of this drawing and design.

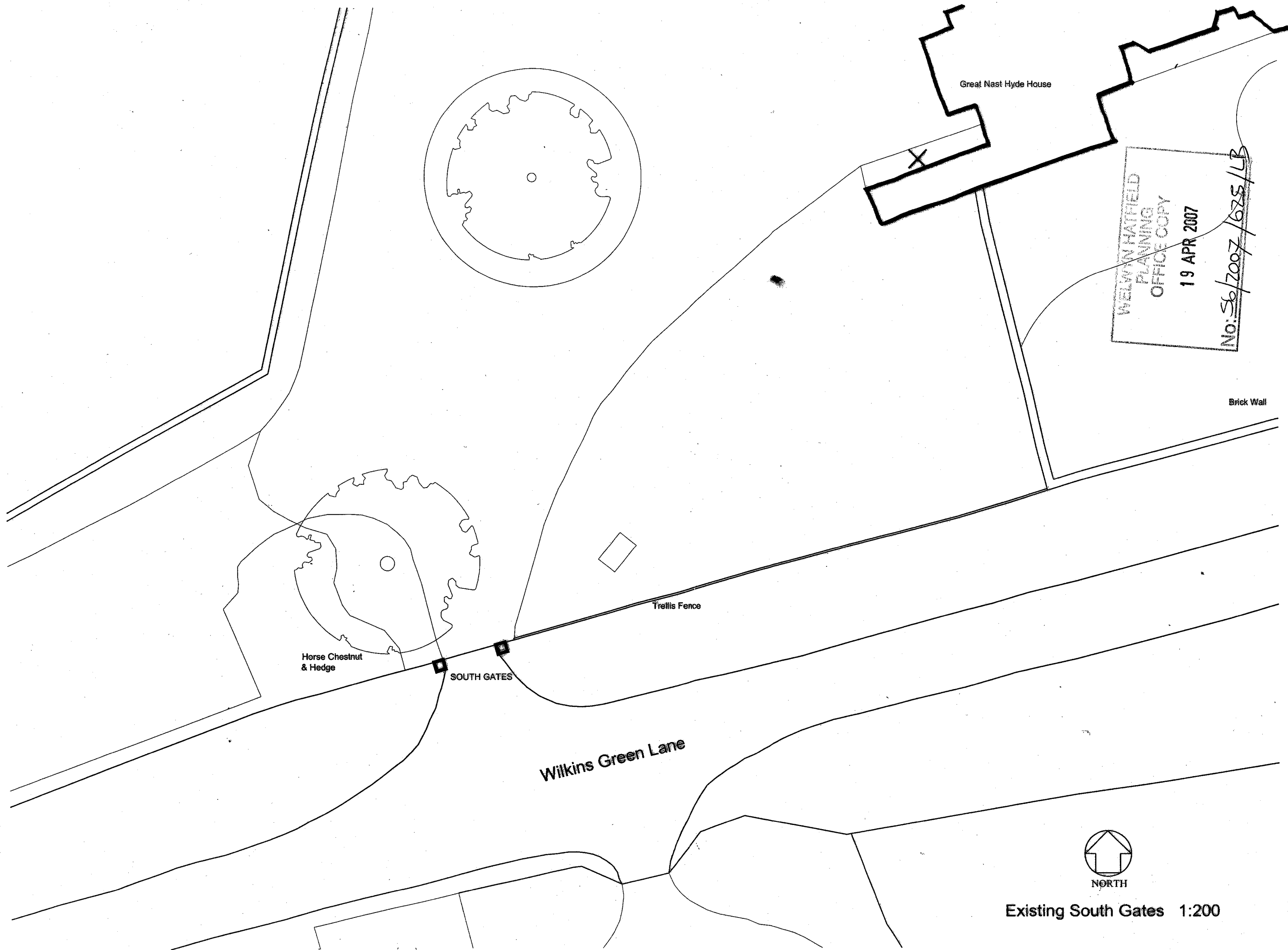

GREAT NAST HYDE HOUSE **EXISTING SOUTH GATES**
PLAN
 Scale 1:200 Date 20.10.03 Drawn NRH No. 6103/6/1007 Rev. 1

RUSSELL TAYLOR ARCHITECTS
 www.rtaarchitects.co.uk
 TEL:020 7261 1984
 TEL:01503 273 092
 mail@rtaarchitects.co.uk
 LONDON
 CORNWALL
 © Russell Taylor Architects over the copyright of this drawing and design.

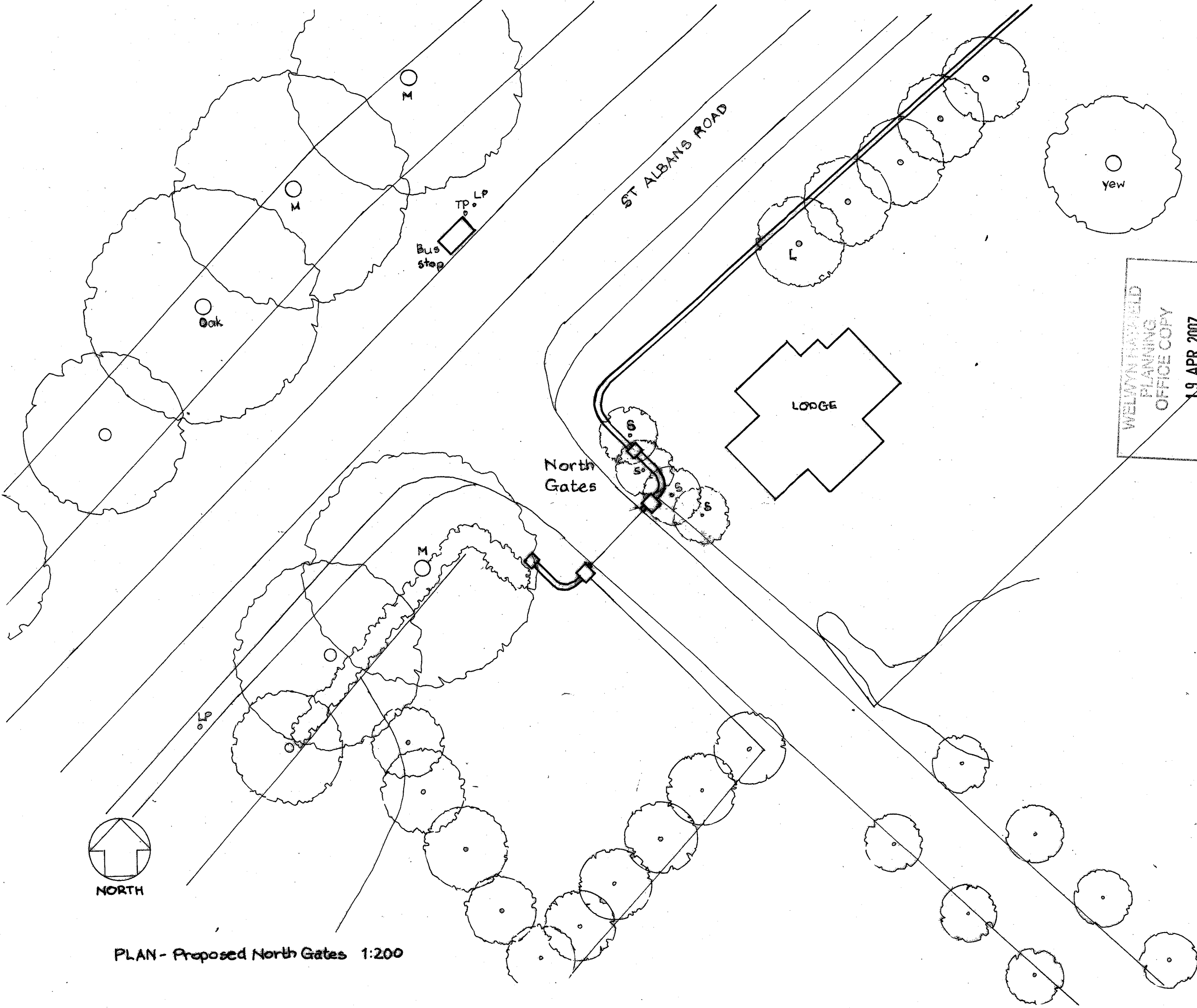

WELLYN FAYFIELD
 PLANNING
 OFFICE COPY
 19 APR 2007
 No: S6/2007/625/U3

RUSSELL TAYLOR ARCHITECTS
 www.rtaarchitects.co.uk
 mail@rtaarchitects.co.uk
 LONDON
 CORNWALL
 © Russell Taylor Architects own the copyright of this drawing and design.

GREAT NAST HYDE HOUSE
 PLAN - PROPOSED NORTH GATES
 REV: A - GENERAL REVISIONS
 1:200 MAR 19 107 KHP 6103/G/4 A

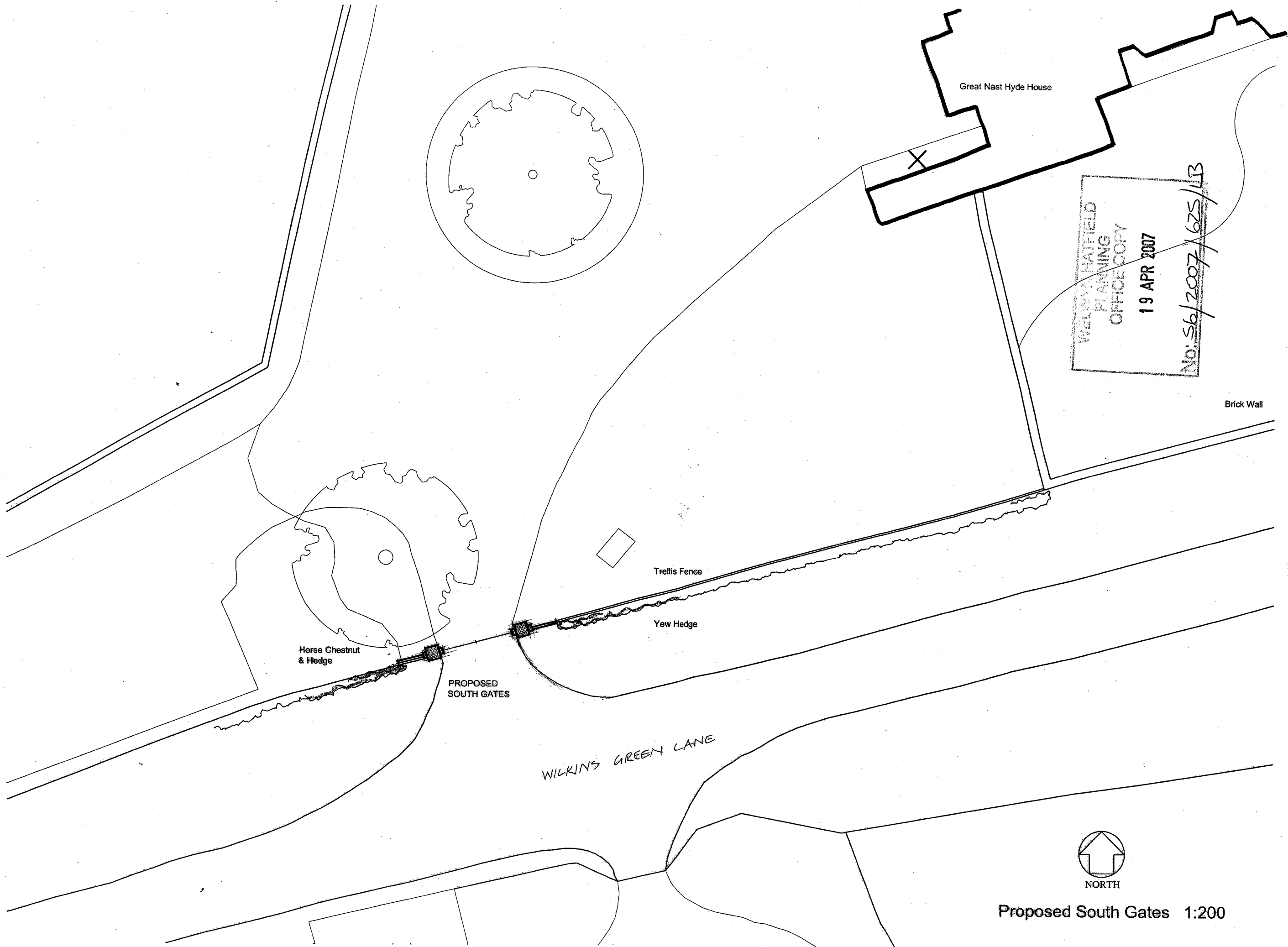

WILKINS GREEN LANE
 PLANNING
 OFFICE COPY
 19 APR 2007
 No: 56/2007/625/LB

GREAT NAST HYDE HOUSE **PROPOSED SOUTH GATES**
 PLAN
 Scale 1:200 Date 20.10.03 Drawn NRH No. 6/03/4/07 Rev. -

RUSSELL TAYLOR ARCHITECTS
 www.rtaarchitects.co.uk
 TEL: 020 7261 1984
 TEL: 01503 273 092
 mail@rtaarchitects.co.uk
 LONDON
 CORNWALL
 © Russell Taylor Architects own the copyright of this drawing and design.



Proposed South Gates 1:200