

COPYRIGHT: This drawing is copyright and may not be altered, reproduced or used other than for the Contract Works for which it is issued without the written permission of SQUIRES & BROWN LTD.
 WARNING: Verify all dimensions and structural details on site prior to commencement of manufacture. If in doubt, ask before acting.

Notes:

Rev	Description	Drawn By	Check By	Date

Rev	Description	Drawn By	Check By	Date

ARCHITECTS/SURVEYORS
squires & brown

The Courtyard
 283c Ashley Road
 Hale
 Cheshire
 WA14 3NG
 Tel: 0161 941 4476
 Fax: 0161 941 4161
 E Mail: info@squiresandbrown.co.uk
 Web: www.squiresandbrown.co.uk

Client
QUEENSWOOD SCHOOL
 Shepherd's Way, Brookmans Park
 Hatfield, Hertfordshire, AL9 6NS.

Project
 Refurbishment of Stamp House
 to form New Lower School
 Boarding Accommodation

Drawing Title
Stamp House
 Existing Site Plan

WELWYN HATFIELD
 PLANNING
 OFFICE COPY
 22 JUL 2010
 2010/1638
 No:

Drawn By	MA	Checked By	TB
Scale	1:200 @ A1	Date	April 2010
Distribution Status	PLANNING APPLICATION		
Project Number	1195		
Drawing Number	A-10-002	Revision	

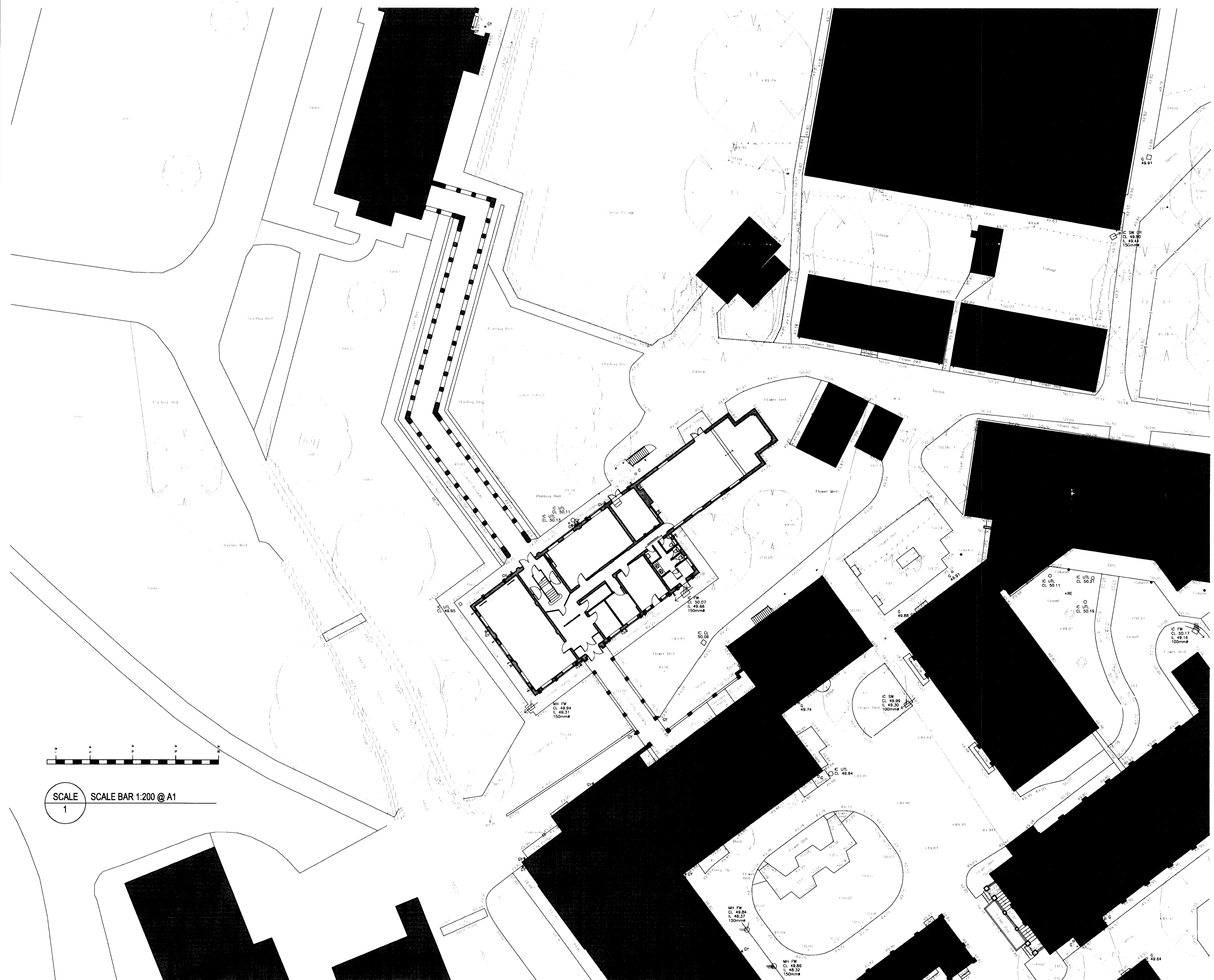

SCALE BAR 1:200 @ A1
 SCALE 1