

COPYRIGHT: This drawing is copyright and may not be altered, reproduced or used other than for the Contract Works for which it is issued without the written permission of the Designer. Do not scale the drawing. Verify all dimensions and structural details on site prior to commencement of construction. If in doubt, ask before adding. All steelwork shown is indicating including sizes, setting-out and levels. Contractor should refer to Structural Engineer's drawings for all setting-out information.

Notes:

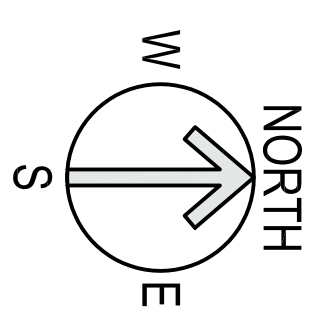

Line of thododentrons to rear of Art Block  
 Existing building to be demolished  
 Dashed line indicates extent of proposed classroom block

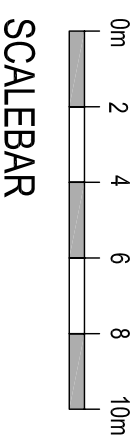
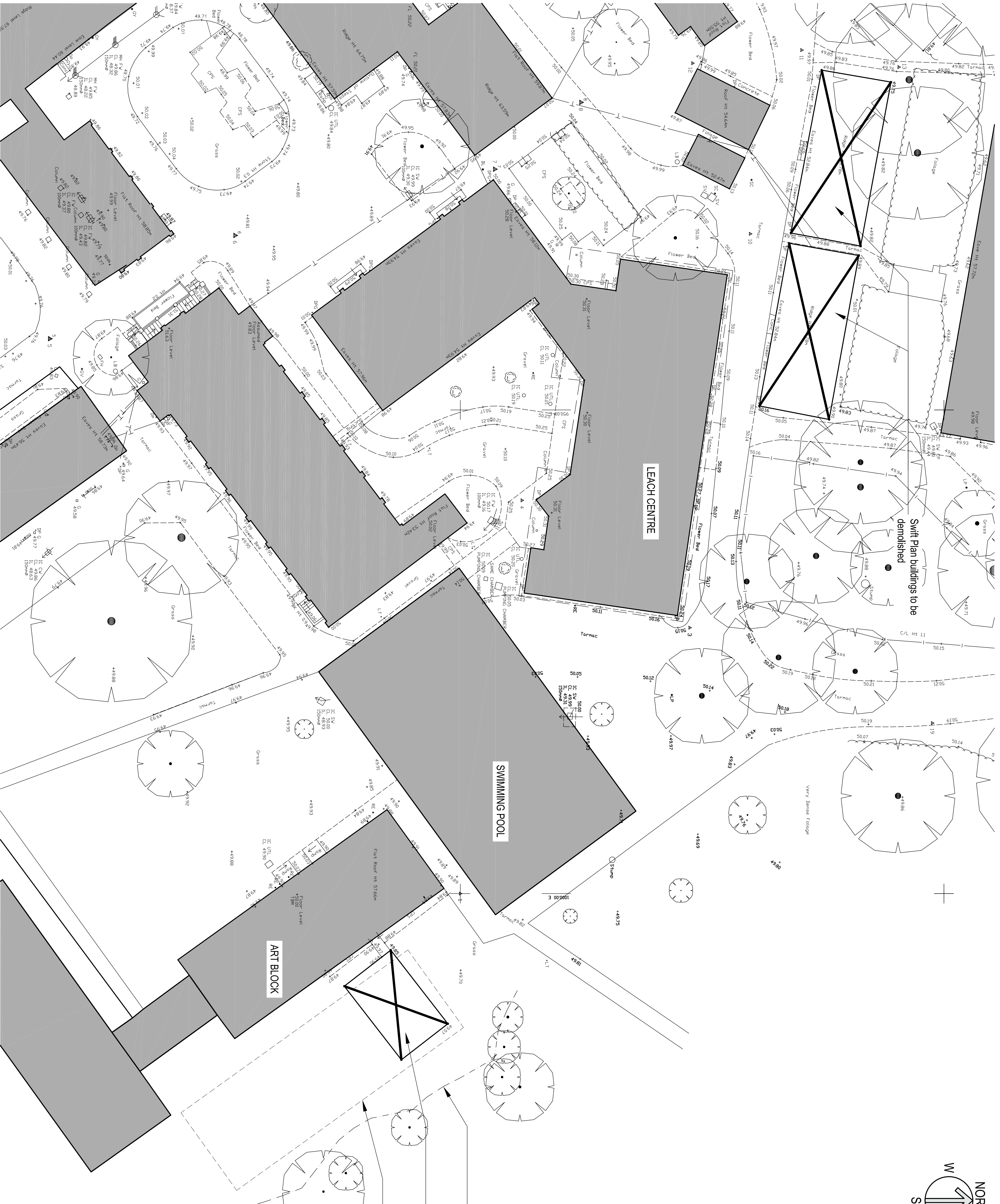

DET  
 1  
 EXISTING SITE PLAN  
 SCALE 1:200 @ A1

**ARCHITECTS/survivors**  
 The Courtyard  
 283c Ashley Road  
 Hale  
 Cheshire  
 Tel: 0161 941 4476  
 Fax: 0161 941 4161  
 E-Mail: info@survivors.co.uk  
 Web: www.survivors.co.uk

**squires & brown**

**CLIENT**  
**QUEENSWOOD SCHOOL**  
 Shepherd's Way, Brookmans Park  
 Hatfield, Hertfordshire AL9 6NS

**PROJECT**  
 Temporary Classrooms

**Drawing Title**  
 Existing Site Plan

Drawn By	NO	Checked By	DB
Scale	1:200 @ A1	Date	11/01/11
Distribution Status	PLANNING		
Project Number	1294		
Drawing Number	A-16-010	Revision	/