

SCALE 0 1 2 3 4 5 metres  
.5

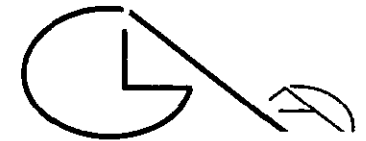

**GLA Architecture and Design**  
Suite T, 25 Horsell Road, Highbury, London N5 1XL  
T 020 7700 2916 F 020 7700 2933 E g@glaad.co.uk

Client <b>THE TRUSTEES OF THE TWELVE APOSTLES CHURCH</b>		
Main Contractor		
Project <b>PROPOSED ROOF WORKS TO THE TWELVE APOSTLES CHURCH, KENTISH LANE, BROOKMANS PARK, HATFIELD, HERTFORDSHIRE, AL9 6NG</b>		
Drawing Title <b>EXISTING GROUND FLOOR PLAN</b>		
Scale 1:100 @ A3	Date October 2013	Drawn By SK
Project No. 1312	Drawing No. 02	Rev. A-
<p><b>CONSTRUCTION</b></p> <p>ALL DIMENSIONS TO BE CHECKED ON SITE</p> <p><b>DRAWING STATUS</b></p> <p><b>A</b> SCHEME - Outline/Scheme drawings for proposals, budgets, etc.</p> <p><b>B</b> DESIGN DEVELOPMENT - Evolving final design drawings for approvals, tenders, billing etc.</p> <p><b>C</b> CONSTRUCTION - Fully developed drawings issued under instruction for construction.</p> <p>ONLY STATUS 'C' DRAWINGS TO BE USED FOR CONSTRUCTION PURPOSES</p>		

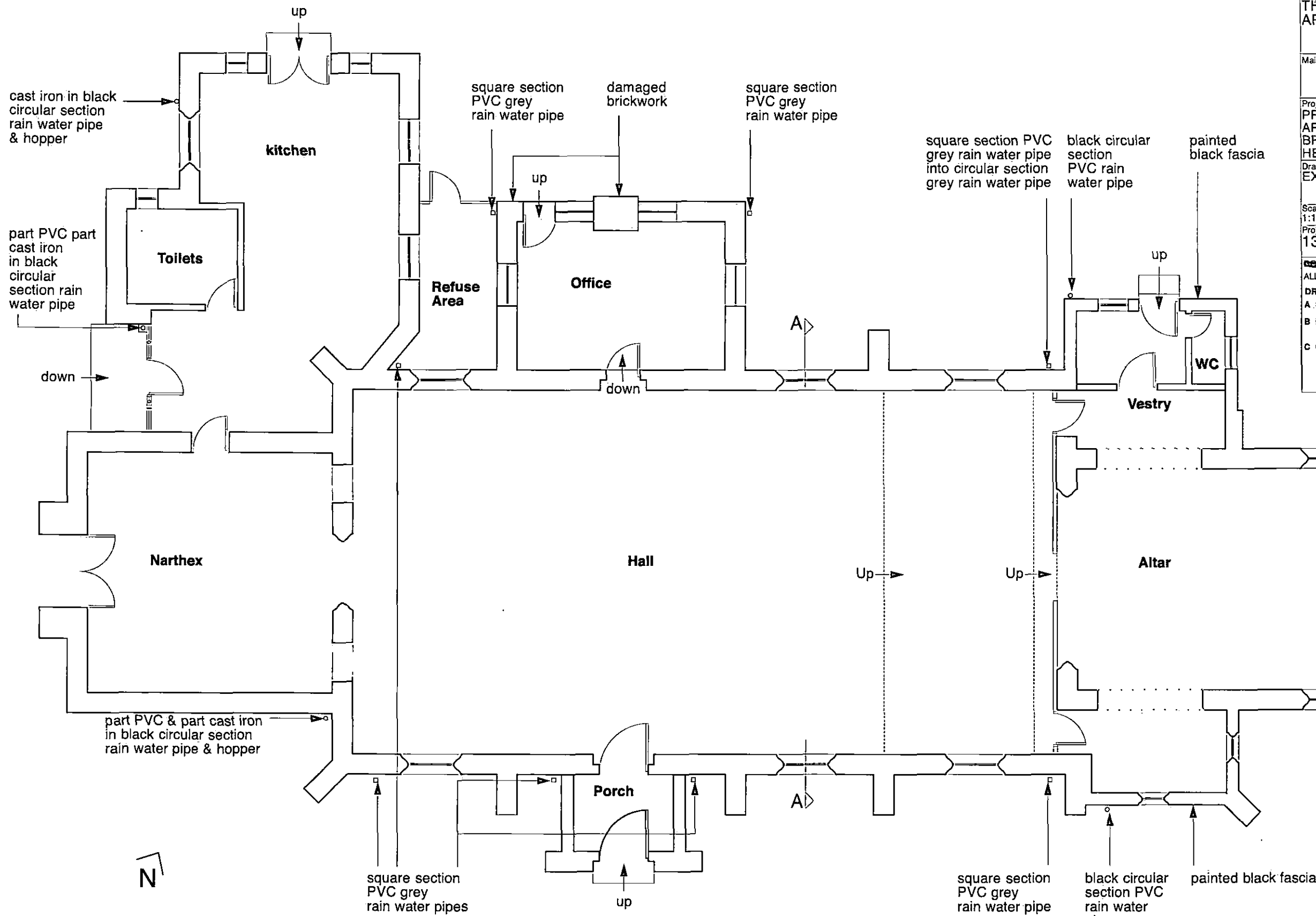

Ground floor plan

WELWORTH HATFIELD  
PLANNING  
OFFICE COPY  
- 6 NOV 2013  
No: \_\_\_\_\_