

Hertfordshire

Published 1925

Source map scale - 1:10,560

The historical maps shown were reproduced from maps predominantly held at the scale adopted for England, Wales and Scotland in the 1840's. In 1854 the 1:2,500 scale was adopted for mapping urban areas; these maps were used to update the 1:10,560 maps. The published date given therefore is often some years later than the surveyed date. Before 1938, all OS maps were based on the Cassini Projection, with independent surveys of a single county or group of counties, giving rise to significant inaccuracies in outlying areas. In the late 1940's, a Provisional Edition was produced, which updated the 1:10,560 mapping from a number of sources. The maps appear unfinished - with all military camps and other strategic sites removed. These maps were initially overprinted with the National Grid. In 1970, the first 1:10,000 maps were produced using the Transverse Mercator Projection. The revision process continued until recently, with new editions appearing every 10 years or so for urban areas.

Map Name(s) and Date(s)

035NW 1925 1:10,560	035NE 1925 1:10,560
035SW 1925 1:10,560	035SE 1925 1:10,560

Historical Map - Slice A

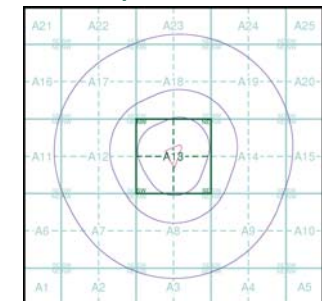

Order Details

Order Number: 71966509\_1\_1  
 Customer Ref: EB1843  
 National Grid Reference: 521260, 208250  
 Slice: A  
 Site Area (Ha): 1.55  
 Search Buffer (m): 1000

Site Details

Ramada Hotel, St. Albans Road West, HATFIELD,  
 Hertfordshire, AL10 9RH

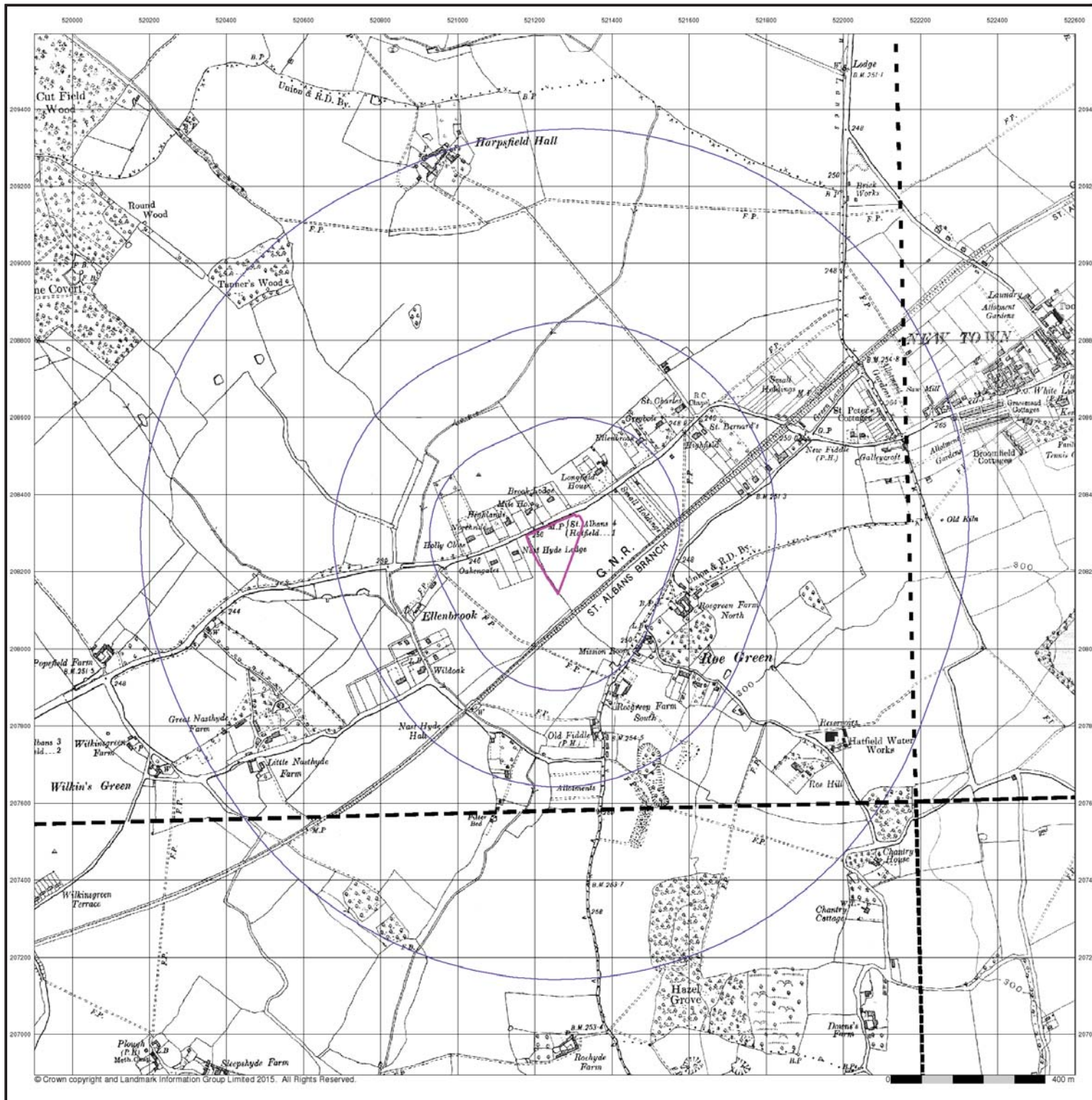

Hertfordshire

Published 1925

Source map scale - 1:10,560

The historical maps shown were reproduced from maps predominantly held at the scale adopted for England, Wales and Scotland in the 1840's. In 1854 the 1:2,500 scale was adopted for mapping urban areas; these maps were used to update the 1:10,560 maps. The published date given therefore is often some years later than the surveyed date. Before 1938, all OS maps were based on the Cassini Projection, with independent surveys of a single county or group of counties, giving rise to significant inaccuracies in outlying areas. In the late 1940's, a Provisional Edition was produced, which updated the 1:10,560 mapping from a number of sources. The maps appear unfinished - with all military camps and other strategic sites removed. These maps were initially overprinted with the National Grid. In 1970, the first 1:10,000 maps were produced using the Transverse Mercator Projection. The revision process continued until recently, with new editions appearing every 10 years or so for urban areas.

Map Name(s) and Date(s)

035NW 1925 1:10,560	035NE 1925 1:10,560
	035SE 1925 1:10,560

Historical Map - Slice A

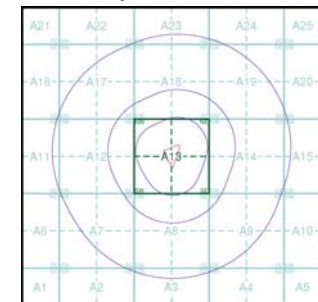

Order Details

Order Number: 71966509\_1\_1  
 Customer Ref: EB1843  
 National Grid Reference: 521260, 208250  
 Slice: A  
 Site Area (Ha): 1.55  
 Search Buffer (m): 1000

Site Details

Ramada Hotel, St. Albans Road West, HATFIELD,  
 Hertfordshire, AL10 9RH





Hertfordshire

Published 1938 - 1939

Source map scale - 1:10,560

The historical maps shown were reproduced from maps predominantly held at the scale adopted for England, Wales and Scotland in the 1840's. In 1854 the 1:2,500 scale was adopted for mapping urban areas; these maps were used to update the 1:10,560 maps. The published date given therefore is often some years later than the surveyed date. Before 1938, all OS maps were based on the Cassini Projection, with independent surveys of a single county or group of counties, giving rise to significant inaccuracies in outlying areas. In the late 1940's, a Provisional Edition was produced, which updated the 1:10,560 mapping from a number of sources. The maps appear unfinished - with all military camps and other strategic sites removed. These maps were initially overprinted with the National Grid. In 1970, the first 1:10,000 maps were produced using the Transverse Mercator Projection. The revision process continued until recently, with new editions appearing every 10 years or so for urban areas.

Map Name(s) and Date(s)

035NW 1938 1:10,560	035NE 1939 1:10,560
035SW 1938 1:10,560	

Historical Map - Slice A

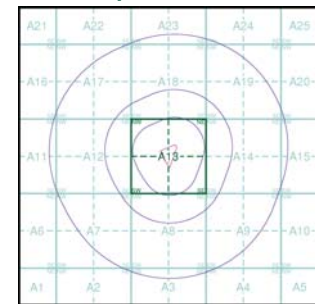

Order Details

Order Number: 71966509\_1\_1  
 Customer Ref: EB1843  
 National Grid Reference: 521260, 208250  
 Slice: A  
 Site Area (Ha): 1.55  
 Search Buffer (m): 1000

Site Details

Ramada Hotel, St. Albans Road West, HATFIELD,  
 Hertfordshire, AL10 9RH



The historical maps shown were reproduced from maps predominantly held at the scale adopted for England, Wales and Scotland in the 1840's. In 1854 the 1:2,500 scale was adopted for mapping urban areas; these maps were used to update the 1:10,560 maps. The published date given therefore is often some years later than the surveyed date. Before 1938, all OS maps were based on the Cassini Projection, with independent surveys of a single county or group of counties, giving rise to significant inaccuracies in outlying areas. In the late 1940's, a Provisional Edition was produced, which updated the 1:10,560 mapping from a number of sources. The maps appear unfinished - with all military camps and other strategic sites removed. These maps were initially overprinted with the National Grid. In 1970, the first 1:10,000 maps were produced using the Transverse Mercator Projection. The revision process continued until recently, with new editions appearing every 10 years or so for urban areas.

**Map Name(s) and Date(s)**

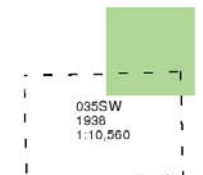

**Historical Map - Slice A**

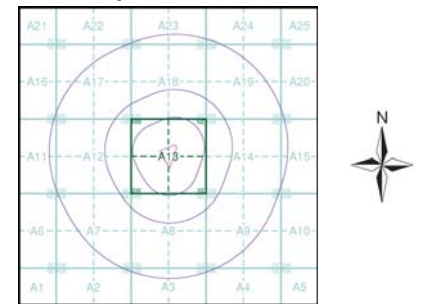

**Order Details**

Order Number: 71966509\_1\_1  
 Customer Ref: EB1843  
 National Grid Reference: 521260, 208250  
 Slice: A  
 Site Area (Ha): 1.55  
 Search Buffer (m): 1000

**Site Details**

Ramada Hotel, St. Albans Road West, HATFIELD,  
 Hertfordshire, AL10 9RH

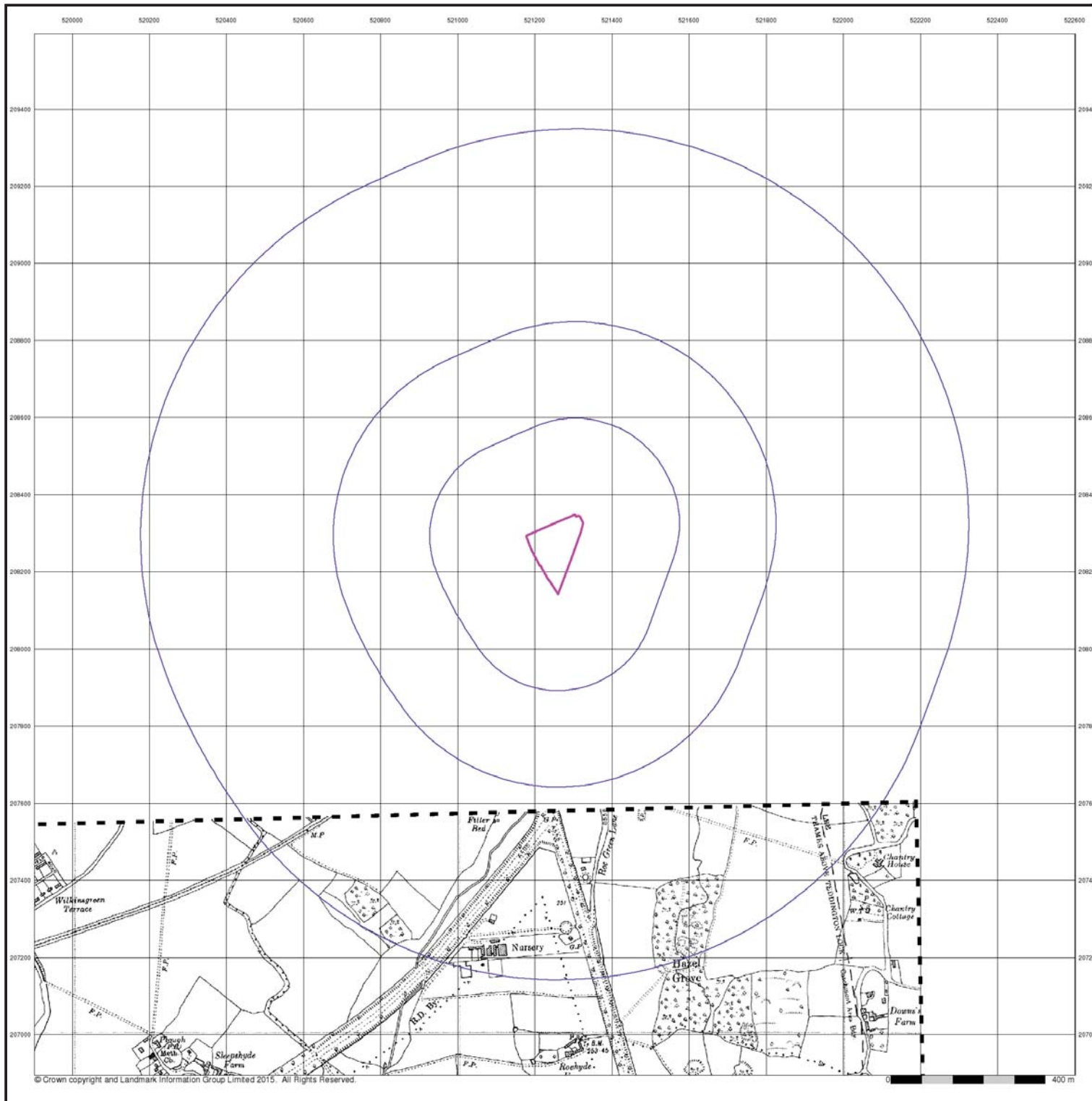

## Historical Aerial Photography Published 1947

Source map scale - 1:10,560

The Historical Aerial Photos were produced by the Ordnance Survey at a scale of 1:1,250 and 1:10,560 from Air Force photography. They were produced between 1944 and 1951 as an interim measure, pending preparation of conventional mapping, due to post war resource shortages. New security measures in the 1950's meant that every photograph was rechecked for potentially unsafe information with security sites replaced by fake fields or clouds. The original editions were withdrawn and only later made available after a period of fifty years although due to the accuracy of the editing, without viewing both revisions it is not easy to spot the edits. Where available Landmark have included both revisions.

© Landmark Information Group and/or Data Suppliers 2010.

### Map Name(s) and Date(s)

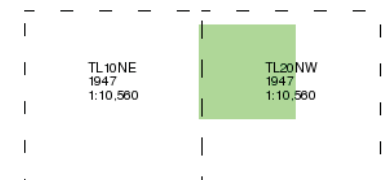

### Historical Aerial Photography - Slice A

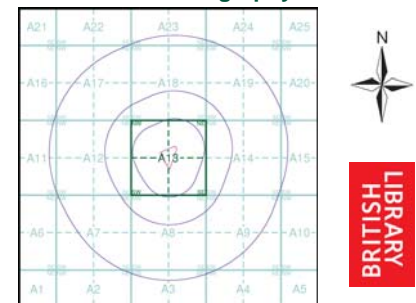

### Order Details

Order Number: 71966509\_1\_1  
Customer Ref: EB1843  
National Grid Reference: 521260, 208250  
Slice: A  
Site Area (Ha): 1.55  
Search Buffer (m): 1000

### Site Details

Ramada Hotel, St. Albans Road West, HATFIELD,  
Hertfordshire, AL10 9RH

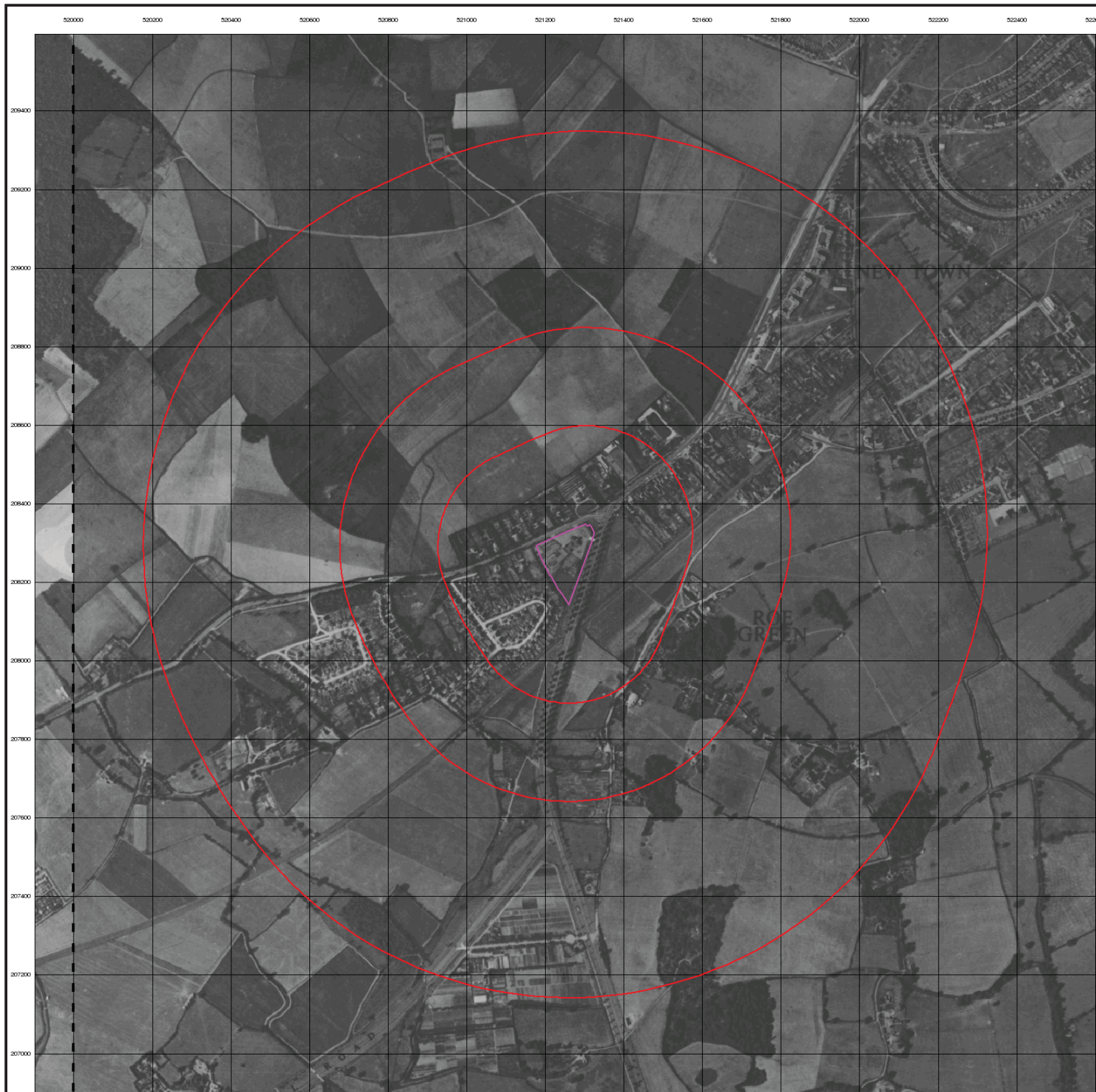

## Historical Aerial Photography Published 1947

Source map scale - 1:10,560

The Historical Aerial Photos were produced by the Ordnance Survey at a scale of 1:1,250 and 1:10,560 from Air Force photography. They were produced between 1944 and 1951 as an interim measure, pending preparation of conventional mapping, due to post war resource shortages. New security measures in the 1950's meant that every photograph was rechecked for potentially unsafe information with security sites replaced by fake fields or clouds. The original editions were withdrawn and only later made available after a period of fifty years although due to the accuracy of the editing, without viewing both revisions it is not easy to spot the edits. Where available Landmark have included both revisions.

© Landmark Information Group and/or Data Suppliers 2010.

### Map Name(s) and Date(s)

TL10NE  
1947  
1:10,560



### Historical Aerial Photography - Slice A

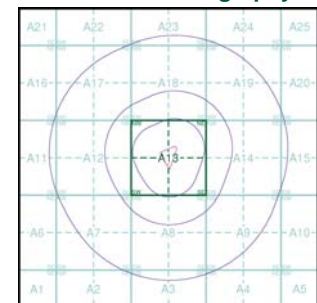

### Order Details

Order Number: 71966509\_1\_1  
Customer Ref: EB1843  
National Grid Reference: 521260, 208250  
Slice: A  
Site Area (Ha): 1.55  
Search Buffer (m): 1000

### Site Details

Ramada Hotel, St. Albans Road West, HATFIELD,  
Hertfordshire, AL10 9RH

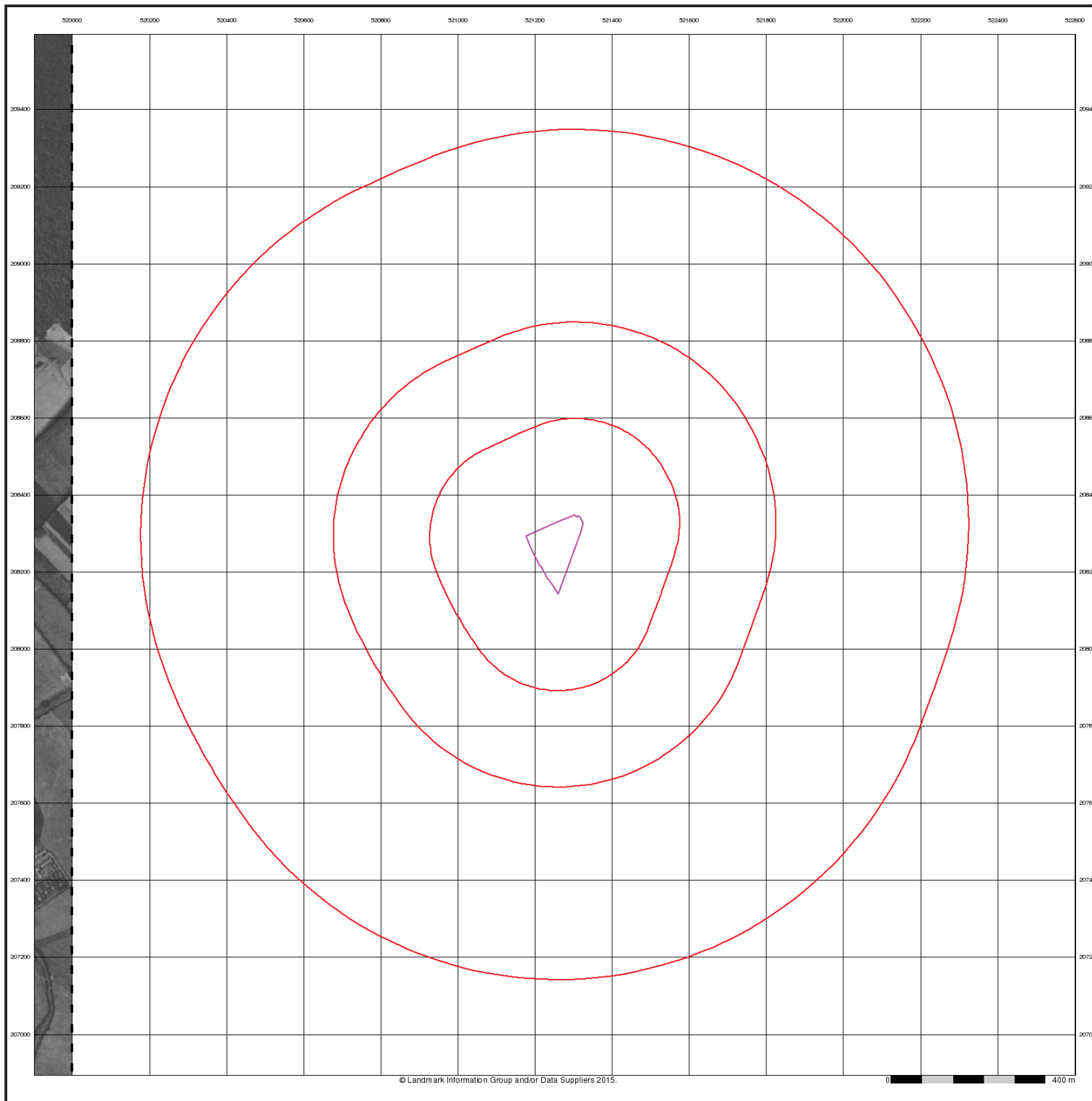

## Ordnance Survey Plan

Published 1960

Source map scale - 1:10,000

The historical maps shown were reproduced from maps predominantly held at the scale adopted for England, Wales and Scotland in the 1840's. In 1854 the 1:2,500 scale was adopted for mapping urban areas; these maps were used to update the 1:10,560 maps. The published date given therefore is often some years later than the surveyed date. Before 1938, all OS maps were based on the Cassini Projection, with independent surveys of a single county or group of counties, giving rise to significant inaccuracies in outlying areas. In the late 1940's, a Provisional Edition was produced, which updated the 1:10,560 mapping from a number of sources. The maps appear unfinished - with all military camps and other strategic sites removed. These maps were initially overprinted with the National Grid. In 1970, the first 1:10,000 maps were produced using the Transverse Mercator Projection. The revision process continued until recently, with new editions appearing every 10 years or so for urban areas.

### Map Name(s) and Date(s)

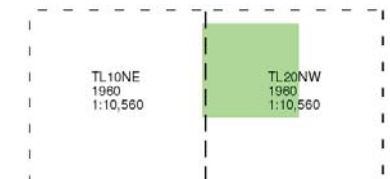

### Historical Map - Slice A

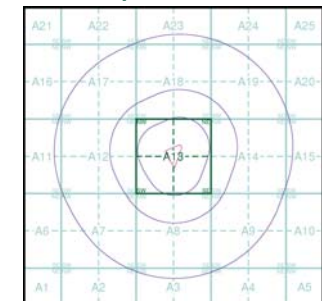

### Order Details

Order Number: 71966509\_1\_1  
 Customer Ref: EB1843  
 National Grid Reference: 521260, 208250  
 Slice: A  
 Site Area (Ha): 1.55  
 Search Buffer (m): 1000

### Site Details

Ramada Hotel, St. Albans Road West, HATFIELD, Hertfordshire, AL10 9RH





## Ordnance Survey Plan

Published 1965

Source map scale - 1:10,000

The historical maps shown were reproduced from maps predominantly held at the scale adopted for England, Wales and Scotland in the 1840's. In 1854 the 1:2,500 scale was adopted for mapping urban areas; these maps were used to update the 1:10,560 maps. The published date given therefore is often some years later than the surveyed date. Before 1938, all OS maps were based on the Cassini Projection, with independent surveys of a single county or group of counties, giving rise to significant inaccuracies in outlying areas. In the late 1940's, a Provisional Edition was produced, which updated the 1:10,560 mapping from a number of sources. The maps appear unfinished - with all military camps and other strategic sites removed. These maps were initially overprinted with the National Grid. In 1970, the first 1:10,000 maps were produced using the Transverse Mercator Projection. The revision process continued until recently, with new editions appearing every 10 years or so for urban areas.

### Map Name(s) and Date(s)

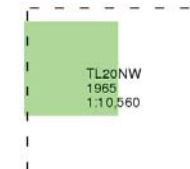

### Historical Map - Slice A

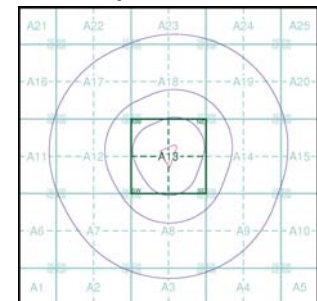

### Order Details

Order Number: 71966509\_1\_1  
 Customer Ref: EB1843  
 National Grid Reference: 521260, 208250  
 Slice: A  
 Site Area (Ha): 1.55  
 Search Buffer (m): 1000

### Site Details

Ramada Hotel, St. Albans Road West, HATFIELD,  
 Hertfordshire, AL10 9RH



## Ordnance Survey Plan

Published 1971 - 1978

Source map scale - 1:10,000

The historical maps shown were reproduced from maps predominantly held at the scale adopted for England, Wales and Scotland in the 1840's. In 1854 the 1:2,500 scale was adopted for mapping urban areas; these maps were used to update the 1:10,560 maps. The published date given therefore is often some years later than the surveyed date. Before 1938, all OS maps were based on the Cassini Projection, with independent surveys of a single county or group of counties, giving rise to significant inaccuracies in outlying areas. In the late 1940's, a Provisional Edition was produced, which updated the 1:10,560 mapping from a number of sources. The maps appear unfinished - with all military camps and other strategic sites removed. These maps were initially overprinted with the National Grid. In 1970, the first 1:10,000 maps were produced using the Transverse Mercator Projection. The revision process continued until recently, with new editions appearing every 10 years or so for urban areas.

### Map Name(s) and Date(s)

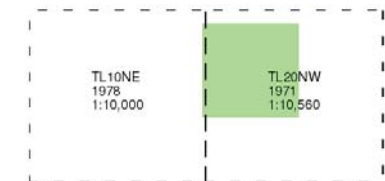

### Historical Map - Slice A

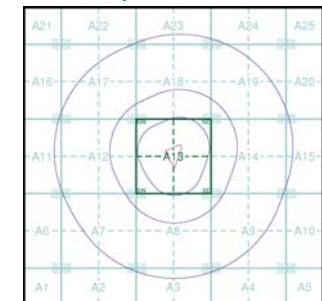

### Order Details

Order Number: 71966509\_1\_1  
 Customer Ref: EB1843  
 National Grid Reference: 521260, 208250  
 Slice: A  
 Site Area (Ha): 1.55  
 Search Buffer (m): 1000

### Site Details

Ramada Hotel, St. Albans Road West, HATFIELD,  
 Hertfordshire, AL10 9RH

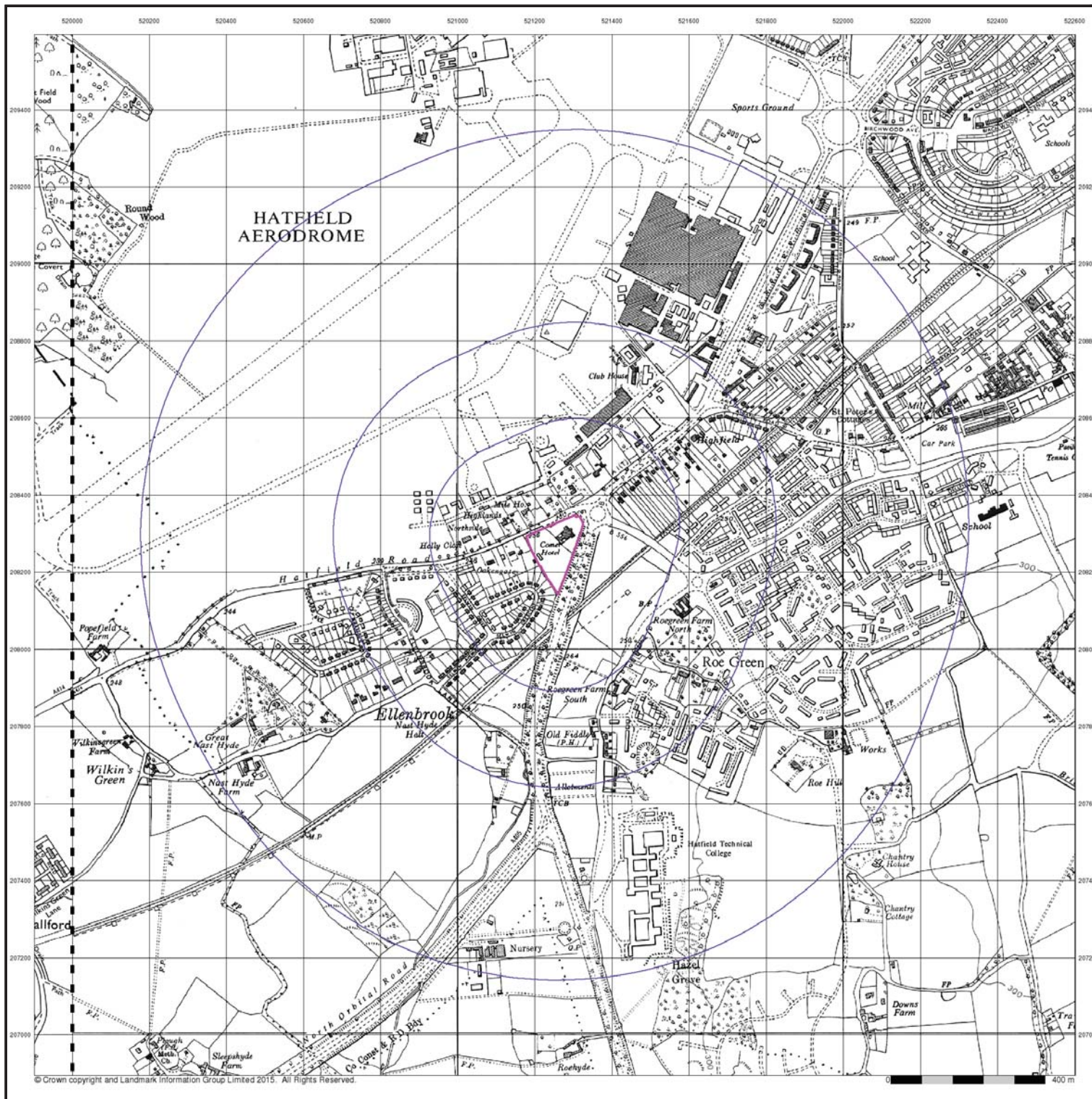

## Ordnance Survey Plan

Published 1975

Source map scale - 1:10,000

The historical maps shown were reproduced from maps predominantly held at the scale adopted for England, Wales and Scotland in the 1840's. In 1854 the 1:2,500 scale was adopted for mapping urban areas; these maps were used to update the 1:10,560 maps. The published date given therefore is often some years later than the surveyed date. Before 1938, all OS maps were based on the Cassini Projection, with independent surveys of a single county or group of counties, giving rise to significant inaccuracies in outlying areas. In the late 1940's, a Provisional Edition was produced, which updated the 1:10,560 mapping from a number of sources. The maps appear unfinished - with all military camps and other strategic sites removed. These maps were initially overprinted with the National Grid. In 1970, the first 1:10,000 maps were produced using the Transverse Mercator Projection. The revision process continued until recently, with new editions appearing every 10 years or so for urban areas.

### Map Name(s) and Date(s)

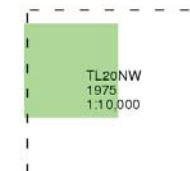

### Historical Map - Slice A

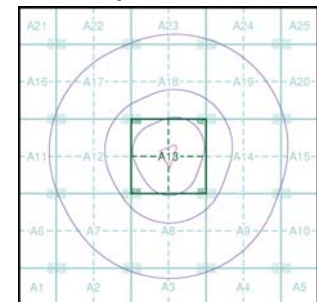

### Order Details

Order Number: 71966509\_1\_1  
 Customer Ref: EB1843  
 National Grid Reference: 521260, 208250  
 Slice: A  
 Site Area (Ha): 1.55  
 Search Buffer (m): 1000

### Site Details

Ramada Hotel, St. Albans Road West, HATFIELD,  
 Hertfordshire, AL10 9RH

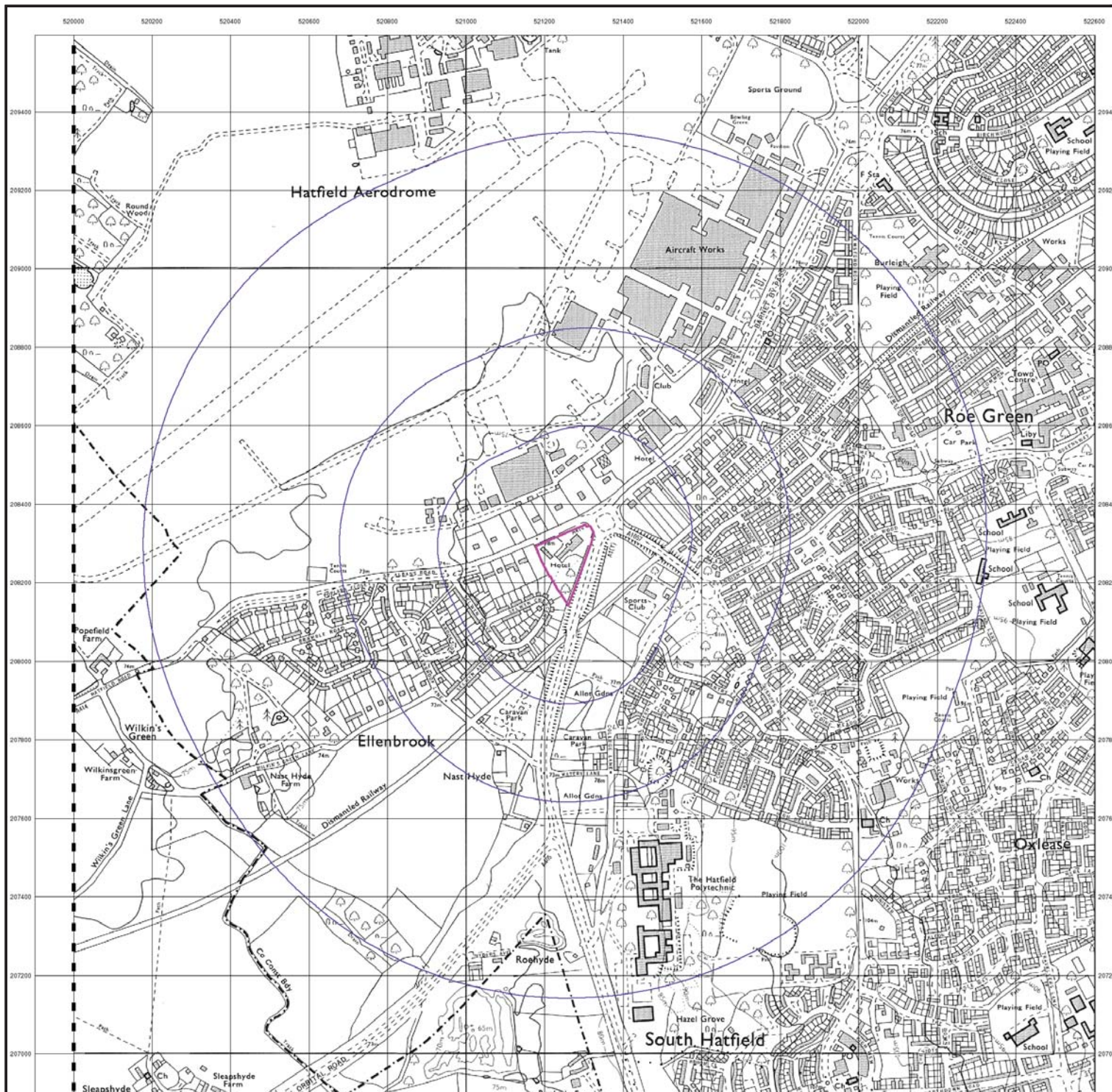

## Ordnance Survey Plan

Published 1985

Source map scale - 1:10,000

The historical maps shown were reproduced from maps predominantly held at the scale adopted for England, Wales and Scotland in the 1840's. In 1854 the 1:2,500 scale was adopted for mapping urban areas; these maps were used to update the 1:10,560 maps. The published date given therefore is often some years later than the surveyed date. Before 1938, all OS maps were based on the Cassini Projection, with independent surveys of a single county or group of counties, giving rise to significant inaccuracies in outlying areas. In the late 1940's, a Provisional Edition was produced, which updated the 1:10,560 mapping from a number of sources. The maps appear unfinished - with all military camps and other strategic sites removed. These maps were initially overprinted with the National Grid. In 1970, the first 1:10,000 maps were produced using the Transverse Mercator Projection. The revision process continued until recently, with new editions appearing every 10 years or so for urban areas.

### Map Name(s) and Date(s)

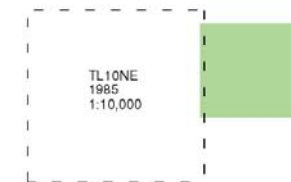

### Historical Map - Slice A

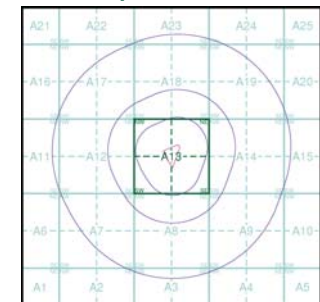

### Order Details

Order Number: 71966509\_1\_1  
 Customer Ref: EB1843  
 National Grid Reference: 521260, 208250  
 Slice: A  
 Site Area (Ha): 1.55  
 Search Buffer (m): 1000

### Site Details

Ramada Hotel, St. Albans Road West, HATFIELD,  
 Hertfordshire, AL10 9RH

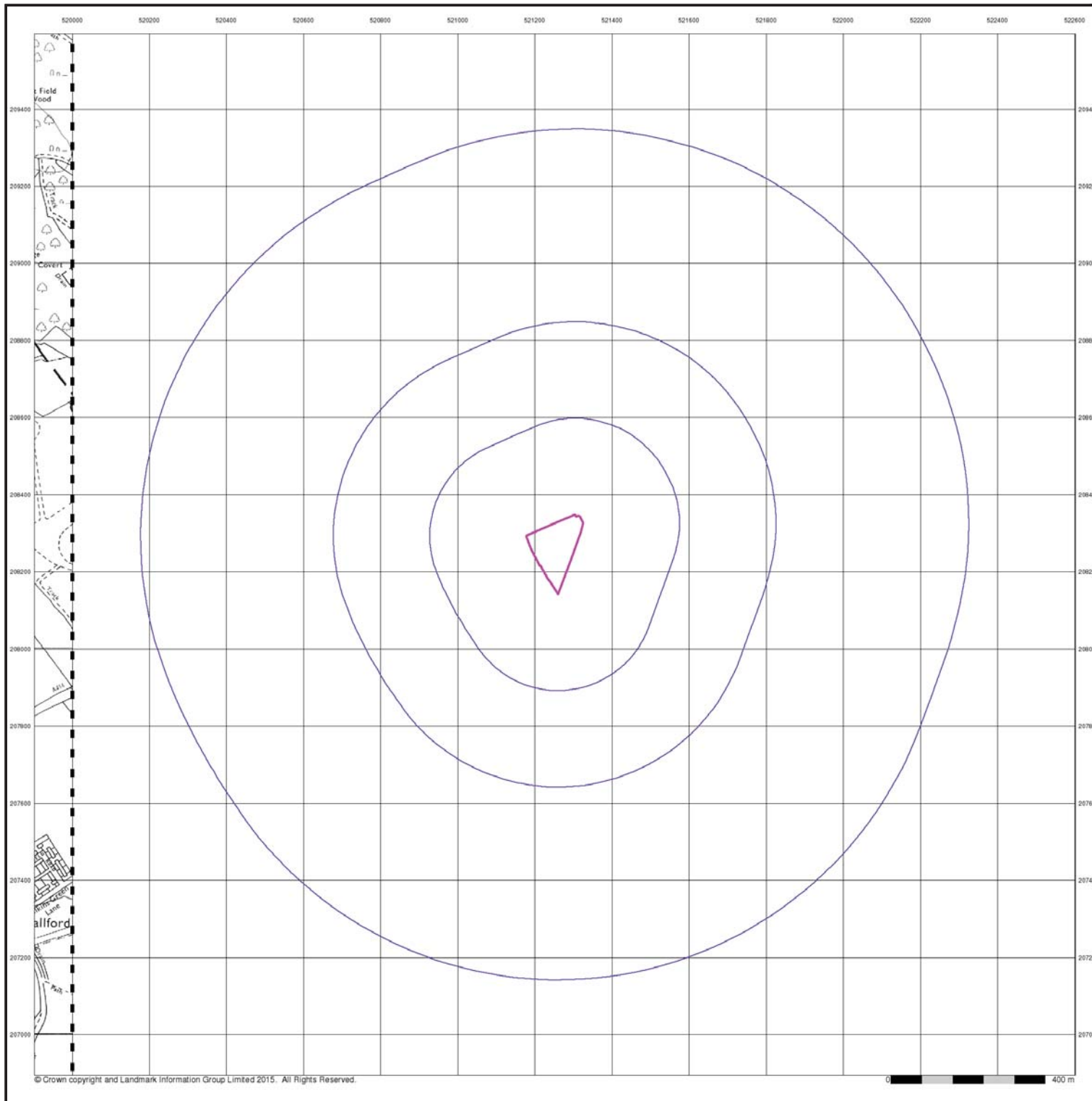

## Ordnance Survey Plan

Published 1990

Source map scale - 1:10,000

The historical maps shown were reproduced from maps predominantly held at the scale adopted for England, Wales and Scotland in the 1840's. In 1854 the 1:2,500 scale was adopted for mapping urban areas; these maps were used to update the 1:10,560 maps. The published date given therefore is often some years later than the surveyed date. Before 1938, all OS maps were based on the Cassini Projection, with independent surveys of a single county or group of counties, giving rise to significant inaccuracies in outlying areas. In the late 1940's, a Provisional Edition was produced, which updated the 1:10,560 mapping from a number of sources. The maps appear unfinished - with all military camps and other strategic sites removed. These maps were initially overprinted with the National Grid. In 1970, the first 1:10,000 maps were produced using the Transverse Mercator Projection. The revision process continued until recently, with new editions appearing every 10 years or so for urban areas.

### Map Name(s) and Date(s)

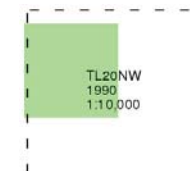

### Historical Map - Slice A

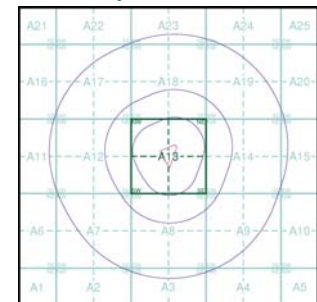

### Order Details

Order Number: 71966509\_1\_1  
 Customer Ref: EB1843  
 National Grid Reference: 521260, 208250  
 Slice: A  
 Site Area (Ha): 1.55  
 Search Buffer (m): 1000

### Site Details

Ramada Hotel, St. Albans Road West, HATFIELD,  
 Hertfordshire, AL10 9RH

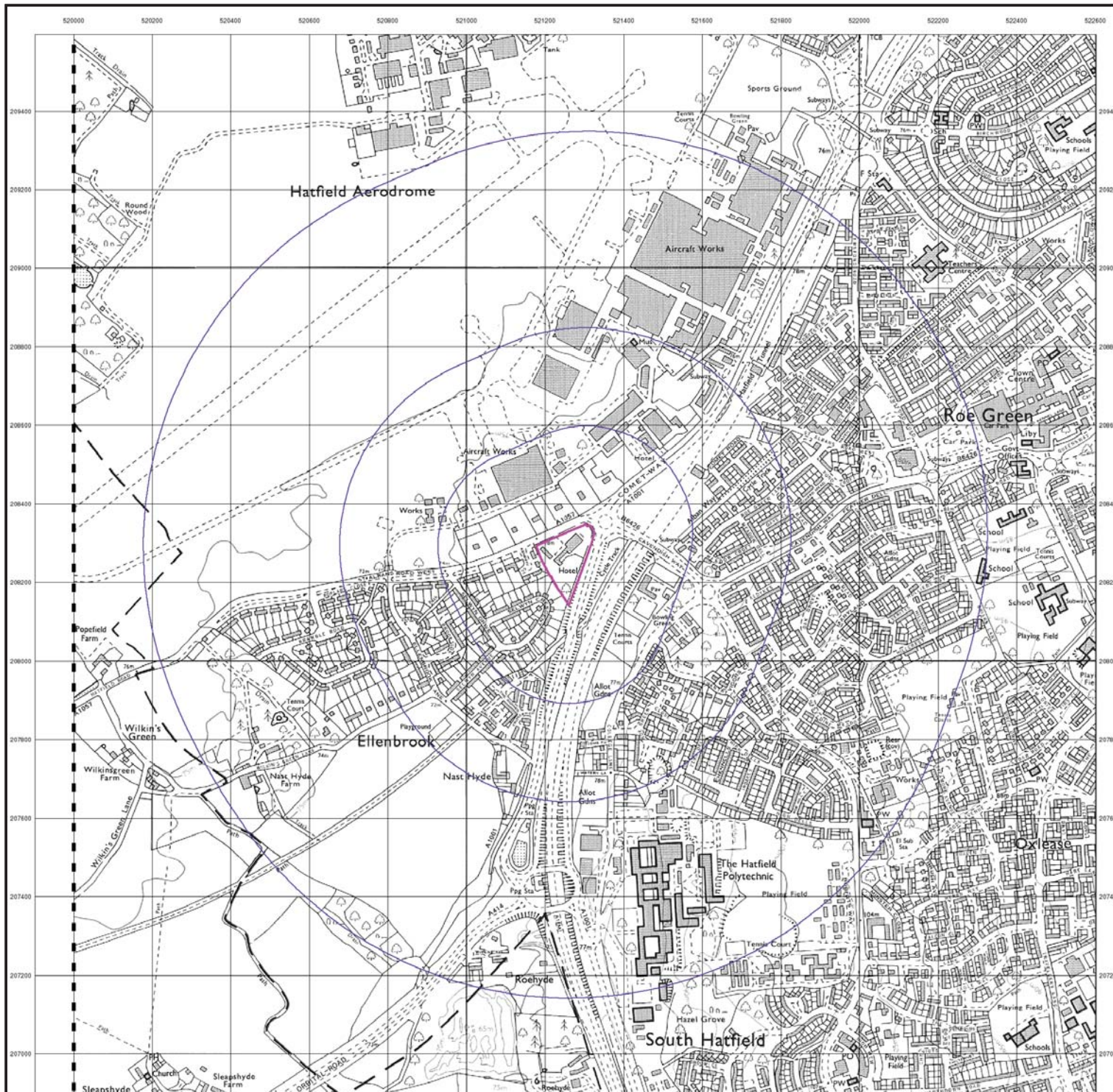

### 10k Raster Mapping

Published 1999

Source map scale - 1:10,000

The historical maps shown were produced from the Ordnance Survey's 1:10,000 colour raster mapping. These maps are derived from Landplan which replaced the old 1:10,000 maps originally published in 1970. The data is highly detailed showing buildings, fences and field boundaries as well as all roads, tracks and paths. Road names are also included together with the relevant road number and classification. Boundary information depiction includes county, unitary authority, district, civil parish and constituency.

### Map Name(s) and Date(s)

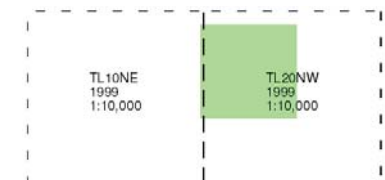

### Historical Map - Slice A

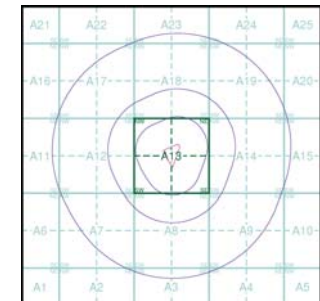

### Order Details

Order Number: 71966509\_1\_1  
 Customer Ref: EB1843  
 National Grid Reference: 521260, 208250  
 Slice: A  
 Site Area (Ha): 1.55  
 Search Buffer (m): 1000

### Site Details

Ramada Hotel, St. Albans Road West, HATFIELD,  
 Hertfordshire, AL10 9RH



### 10k Raster Mapping

Published 2006

Source map scale - 1:10,000

The historical maps shown were produced from the Ordnance Survey's 1:10,000 colour raster mapping. These maps are derived from Landplan which replaced the old 1:10,000 maps originally published in 1970. The data is highly detailed showing buildings, fences and field boundaries as well as all roads, tracks and paths. Road names are also included together with the relevant road number and classification. Boundary information depiction includes county, unitary authority, district, civil parish and constituency.

### Map Name(s) and Date(s)

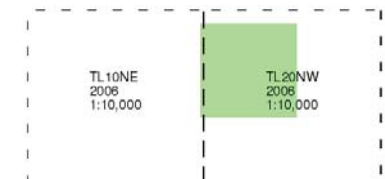

### Historical Map - Slice A

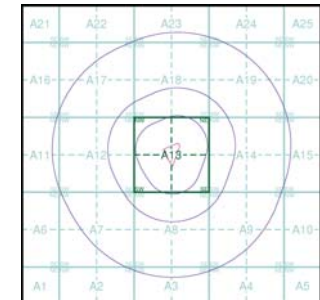

### Order Details

Order Number: 71966509\_1\_1  
 Customer Ref: EB1843  
 National Grid Reference: 521260, 208250  
 Slice: A  
 Site Area (Ha): 1.55  
 Search Buffer (m): 1000

### Site Details

Ramada Hotel, St. Albans Road West, HATFIELD,  
 Hertfordshire, AL10 9RH

