

WARNING: This drawing is for information only. Dimensions are not to be taken from this drawing.

Proposed Second Floor Plan

069/1012
Scale 1:100 @A0 Date Mar 06
Drawn rd Checked rd

Essendon Hall
Bedwell Park,
Essendon,
Herts.

P.J. Livesey (London) Ltd
Ashburton Park
Ashburton Road, West
Manchester M17 1AF
Tel: 0161 873 7878
Fax: 0161 873 8185
design@pjlivesey.co.uk

The P. J. Livesey Group Ltd
www.pjlivesey-group.co.uk

PLANNING
DEPARTMENT
OFFICE COPY
22 MAR 2006
NO 06/0365

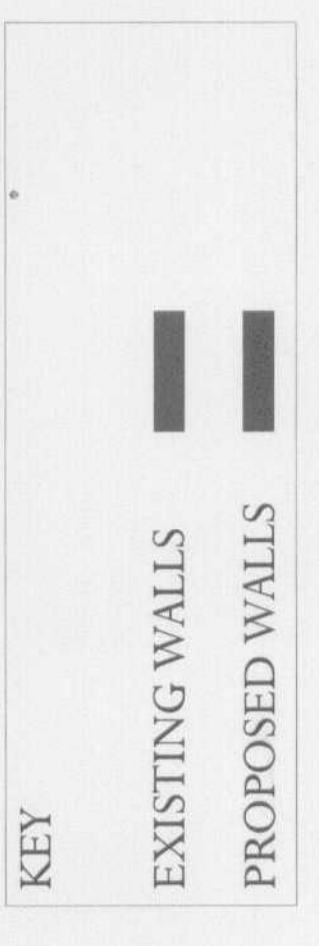

SECOND FLOOR PLAN