

PART PROPOSED FIRST FLOOR PLAN

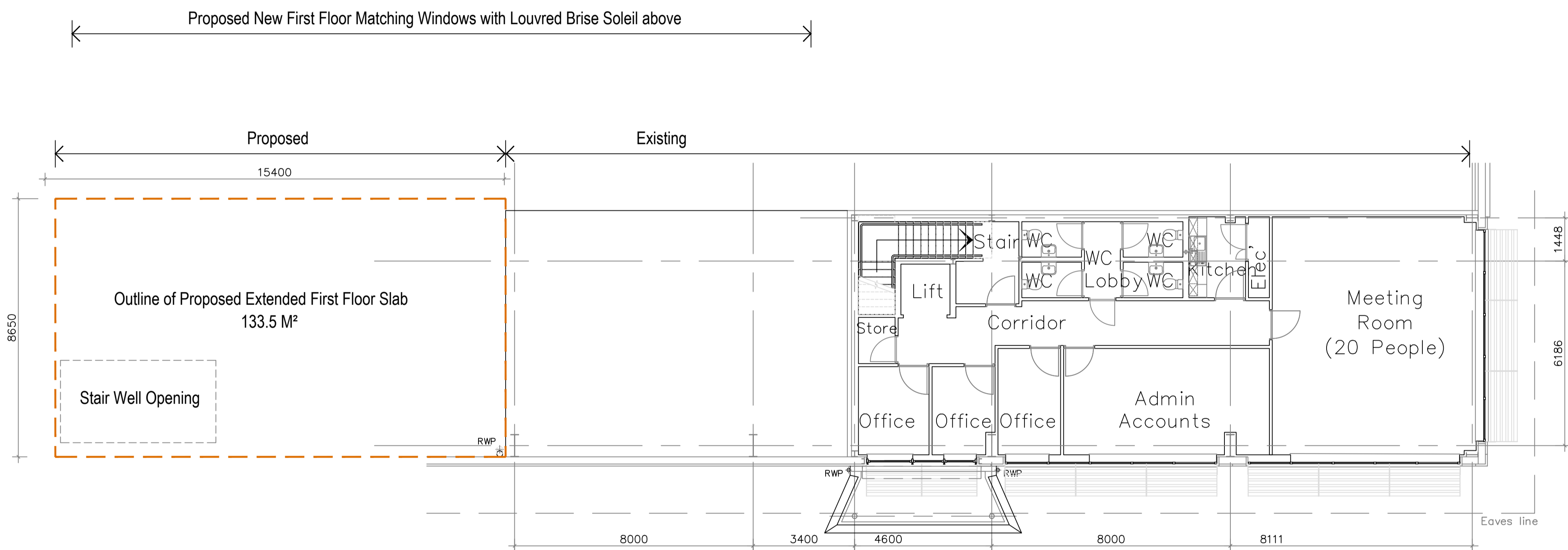

EXISTING FIRST FLOOR PLAN

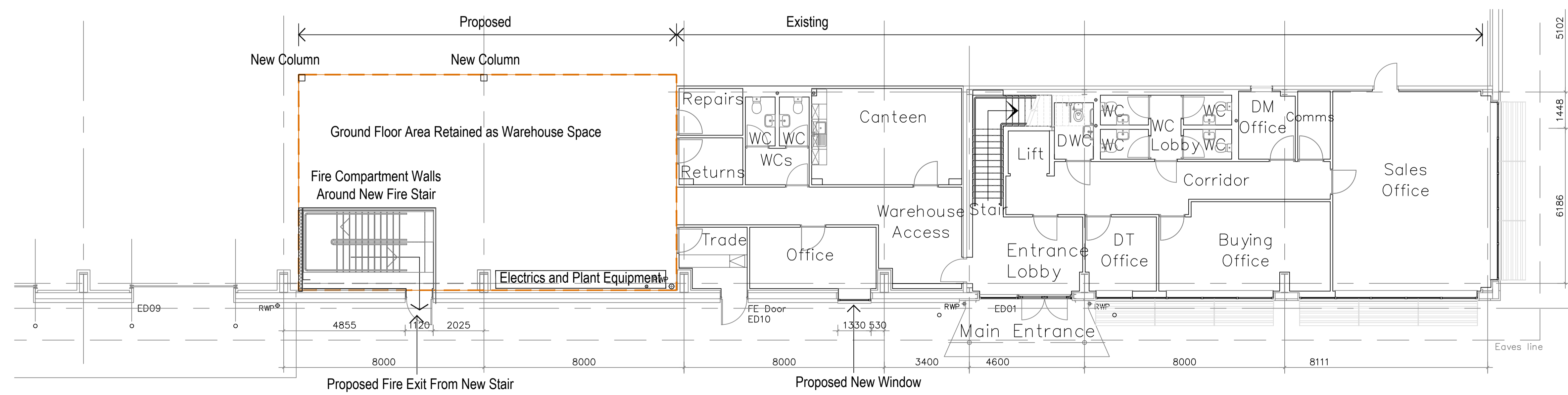

EXISTING AND PROPOSED GROUND FLOOR OFFICE PLAN



No.	DATE	REVISION
PROJECT: TOOLBANK GYPSY MOTH AVENUE HATFIELD BUSINESS PARK HATFIELD AL10 9BS		
CLIENT: DORMOLE LIMITED		
TITLE: EXISTING AND PROPOSED FLOOR PLANS		
SCALE: 1:100 @ A1		
DATE: 18 / 05 / 2021		
DRAWING No : 0 / 6314 -21 / 06		
CAD Ref : existingproposedofficeplans.dwg		
DRAWN : FSG		

Lewis Berkeley
 92 BANNER STREET
 LONDON EC1Y 8JU
 Tel: 020 7491 3198 Fax: 020 7491 4488
 email: admin@lewisberkeley.co.uk