





**DO NOT SCALE**  
 Report any errors or omissions  
 Check all dimensions on site prior to commencing the works or preparing any shop drawings.  
 This drawing is copyright.  
**NOTES:**

**PLANT SCHEDULE**

**TREES**  
 All selected standards [3-3.5m with 10-12cm girth at 1m above ground] bare rooted stock planted in min. 900 cubic mm pits

REF	SPECIES	NO.
AP	ACER PLATANOIDES 'CRIMSON SENTRY'	-
AC	ACER CAPPADOCICUM	1
CB	CARPINUS BETULUS 'FASTIGIATA'	1
FO	FRAXINUS OXYCARPA 'RAYWOOD'	5
FJ	FRAXINUS EXCELSIOR 'JASPIDEA'	-
PN	PRUNUS PDSSARDII 'NIGRA'	-
PP	PRUNUS PADUS 'PURPLE QUEEN'	4
PS	PRUNUS SUB. 'AUTUMNALIS'	6
PV	PRUNUS VIRGINIANA 'SCHUBERT'	10
QR	QUERCUS ROBUR 'FASTIGIATA'	-
QI	QUERCUS ILEX	-

All 1.2m. standards, bare rooted stock planted in min. 900 cubic mm pits

REF	SPECIES	NO.
BP	BETULA PENDULA	1

All container grown in 1.5 to 3.0 litre pot sizes and planted in 450mm soil depth.

REF	SPECIES	NO.
Ac	ACER CAMPESTRE	-
Al	AMELANCHIER LAEVIS	24
Ag	ABELIA GRANDIFLORA	27
Bt	BERBERIS THUN. 'AUREA'	18
Ba	BUDDLEIA ALTERNIFOLIA	3
Ca	COLLUTEA ARBORESCENS	-
Cc	COTINUS COGGYRIA	-
Cf	COTONEASTER FRANCHETTI	14
Cl	CORYLUS AVELLANA	50
Co	CORNUS STOLONIFERA 'FLAVIRAMEA'	50
Cr	CRATAEGUS PRUNIFOLIA	-
Cs	COTONEASTER SALICIFOLIA 'FLOCCOSUS'	-
Dg	DEUTZIA GRACILIS	34
Ea	ELEAGNUS ANGSTIFOLIA	60
Gs	GENISTA HISPANICA	47
Ha	HEBE ALBICIANIS	-
Hv	HEBE ELLIPTICA 'VARIEGATA'	-
Hm	HEBE MARJORIE	34
Hh	HYPERICUM 'HIDCOTE'	18
Ia	ILEX AQUIFOLIUM	15
Kj	KERRIA 'JAPONICA' 'PLENIFOLIA'	6
Ma	MAHONIA AQUIFOLIUM	-
Pa	POTENTILLA 'ABBOTSWOOD'	-
Pc	PRUNUS LUSITANICA	-
Pe	POTENTILLA 'TILFORD CREAM'	-
Pt	PRUNUS LUSITANICA	-
Pl	PYRACANTHA TETON	28
Rb	ROSA 'BLANC DOUBLE DE COUBERT'	28
Rn	ROSA 'NEVADA'	16
Rs	ROSA 'SARA VAN FLEET'	36
Sa	SPIREA AITCHISONII	34
Sh	SYMPHORICARPOS X CHENAULTII 'HANCOCK'	-
Vo	VIBURNUM OPULUS	40
Vt	VIBURNUM TINUS	7
Vr	VIBURNUM RHYTIDOPHYLLUM	-
Wv	WEIGELA FLORIDA 'VARIEGATA'	51

**HEDGES**  
 All 1.2m. whips, bare rooted planted in 450mm deep trench.  
 Plant in two rows 500mm apart, in staggered pattern 3 plants/m.

REF	SPECIES	NO.
Fs	FAGUS SYLVATICA	52
Ia	ILEX AQUIFOLIUM	90
Pt	PYRACANTHA ROGERSIANA	192
Ac/Cm	ACER CAMPESTRE / CRATAEGUS MONOGYNA	60

D: TREES ADDED 9/94 VF  
 C: REVISED SCHEDULE 7/94 VF  
 B: REVISIONS TO PLANTING ALONG OSBOURNE WAY AND TO THE TREE SCHEME 6/94 VF

A: ADDITIONAL PLANTING 4/94

PROJECT TITLE  
**ADMIRAL HOMES  
 LONGCROFT LANE  
 WELWYN GARDEN CITY**

DRAWING TITLE  
**PLANTING PLAN**

PROJECT No.	DRAWING No.	SCALE	DATE
10120	05 D	1:200	MAR. 94
			DRAWN V F

**COYNE ASSOCIATES**  
 LANDSCAPE ARCHITECTS  
 STERLING COURT NORTON ROAD STEVENAGE HERTS SG1 3JY  
 TELEPHONE: 0438 728326 FAX: 0438 728335

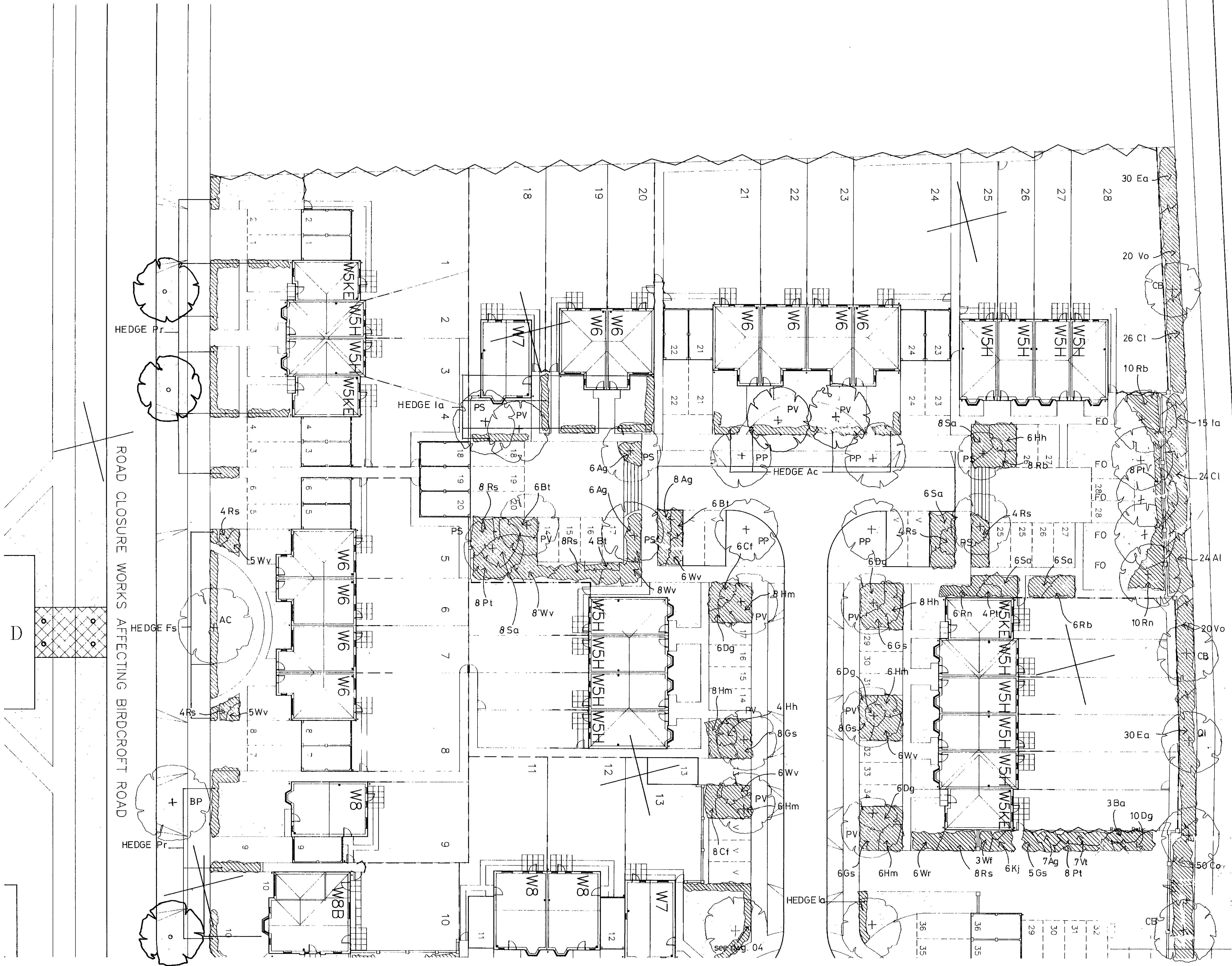



DO NOT SCALE  
Report any errors or omissions  
Check all dimensions on site prior to commencing the works or preparing any shop drawings.  
This drawing is copyright.  
NOTES:

PLANT SCHEDULE

PLANT SCHEDULE

TREES

All selected standards [3-3.5m with 10-12cm girth at 1m. above ground] bare rooted stock planted in min. 900 cubic mm pits

REF	SPECIES	NO.
AP	ACER PLATANOIDES 'CRIMSON SENTRY'	
AC	ACER CAPPADOCICUM	
CB	CARPUNUS BETULUS 'FASTIGIATA'	
FO	FRAXINUS OXYCARPA 'RAYWOOD'	
FJ	FRAXINUS EXCELSIOR 'JASPERIDEA'	
PN	PRUNUS PISSARDII 'NIGRA'	
PP	PRUNUS PADUS 'PURPLE QUEEN'	
PS	PRUNUS SUB. 'AUTUMNALIS'	
PV	PRUNUS VIRGINIANA 'SCHUBERT'	
Q	QUERCUS ROBUR 'FASTIGIATA'	

All 1.2m. standards, bare rooted stock planted in min. 900 cubic mm pits

REF	SPECIES	NO.
BP	BETULA PENDULA	

SHRUBS

All container grown in 1.5 to 3.0 litre pot sizes and planted in 450mm soil depth.

REF	SPECIES	NO.
Ab	ACER CAMPESTRE	
Al	AMELANCHIER LAEVIS	
Am	ABELIA GRANDIFLORA	
Ba	BERBERIS THUN. 'AUREA'	
Bu	BUDDLEIA ALTERNIFOLIA	
Ca	COLLUTEA ARBORESCENS	
Co	COTINUS COGUYGRIA	
Cf	COTONEASTER FRANCHETTI	
Co	CORYLLUS AVELLANA	
Cs	CORNUS STOLONIFERA 'FLAVIRAMEA'	
Cr	CRATAEGUS PRUNIFOLIA	
Cs	COTONEASTER SALICIFOLIUS 'FLOCCOSUS'	
Dg	DEUTZIA GRACILIS	
Ea	ELEAGNUS ANGSTIFOLIA	
Ge	GENISIA HISPANICA	
He	HEBE ALBICANS	
He	HEBE ELLIPTICA 'VARIEGATA'	
He	HEBE MARJORIE	
Hy	HYPERICUM 'HIDCOTE'	
Ia	ILEX AQUIFOLIUM	
Kj	KERRIA JAPONICA 'PLENIFOLIA'	
Ma	MAHONIA AQUIFOLIUM	
Pa	POTENTILLA 'ABBOTSWOOD'	
Pr	PRUNUS LUSITANICA	
Pr	POTENTILLA 'TILFORD CREAM'	
Rn	RUNUS LUSITANICA	
Rn	PYRACANTHA TETON	
Rn	ROSA 'BLANC DOUBLE DE COUBERT'	
Rn	ROSA 'NEVADA'	
Rn	ROSA 'SARA VAN FLEET'	
Sa	SPIREA ALTISSIMA	
Sh	SYMPHORICARPOS X CHENAUILLI 'HANCOCK'	
Vo	VIBURNUM OPULIS	
Vi	VIBURNUM TINUS	
Vr	VIBURNUM RHYTIDOPHYLLUM	
Wv	WEIGELA FLORIDA 'VARIEGATA'	

CLIMBERS

All container grown 2.0 litre pot size with min. 3 leading shoots fixed to canes.

REF	SPECIES	NO.
-----	---------	-----

HEDGES

All 1.2m. whips, bare rooted planted in 450mm deep trench. Plant in two rows 500mm apart, in staggered pattern 3 plants/m.

REF	SPECIES	NO.
-----	---------	-----

Fs	FAGUS SYLVATICA
Ia	ILEX AQUIFOLIUM
Pr	PRUNUS VIRGINIANA
Ac/Cm	ACER CAMPESTRE / CRATAEGUS MONOGYNA

B: REVISIONS TO PLANTING ALONG OSBOURNE WAY AND TO THE TREE SCHEME 6/94 V.F.

A: ADDITIONAL PLANTING 4/94

PROJECT TITLE

ADMIRAL HOMES  
LONGCROFT LANE  
WELWYN GARDEN CITY

DRAWING TITLE  
PLANTING PLAN

PROJECT No.	DRAWING No.	SCALE	DATE
10120	05	1:200	MAR 94

**COYNE ASSOCIATES**  
LANDSCAPE ARCHITECTS  
STERLING COURT NOTTON ROAD STEVENAGE HERTS SG1 2JT  
TELEPHONE: 0439 728326 FAX: 0439 728333

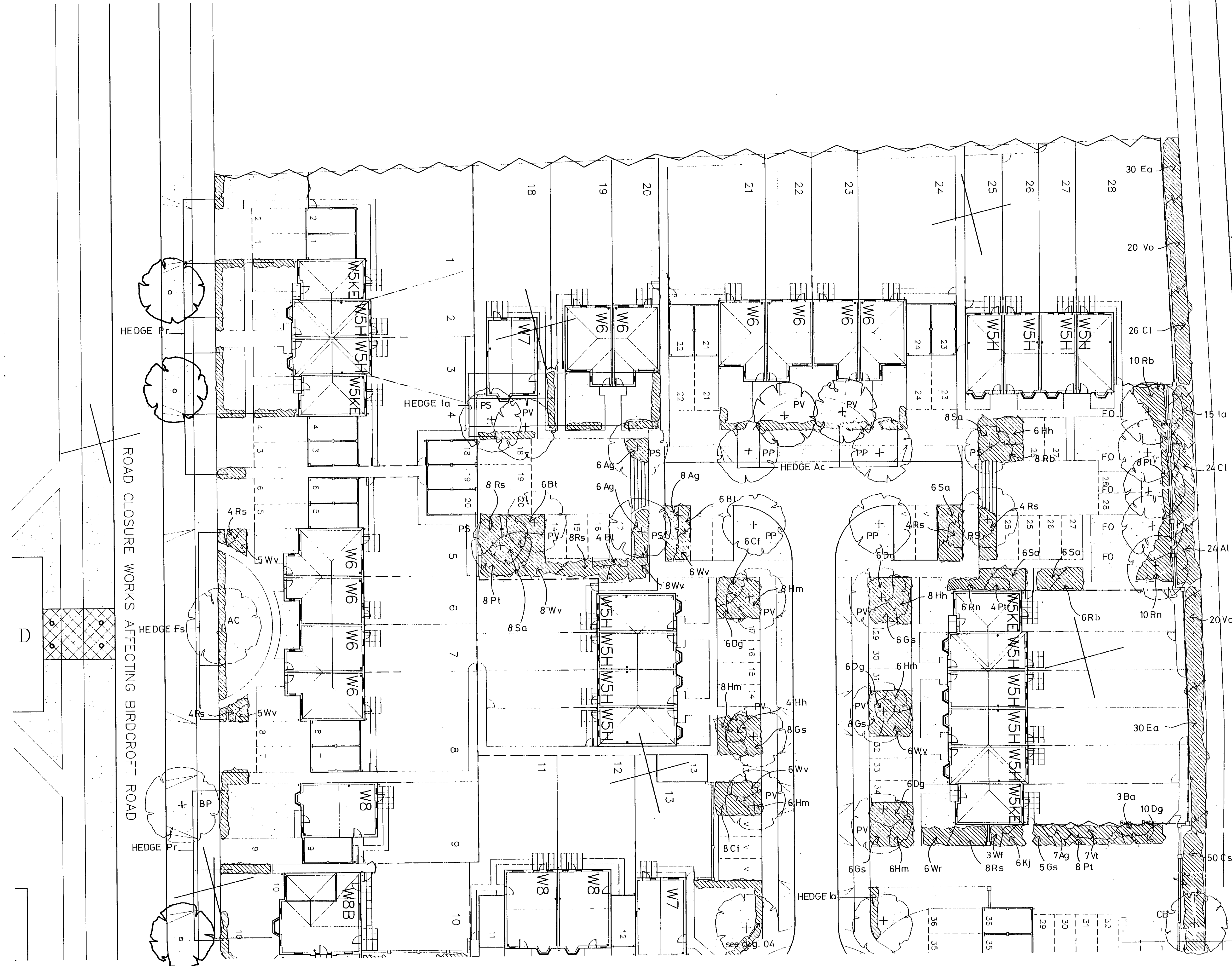

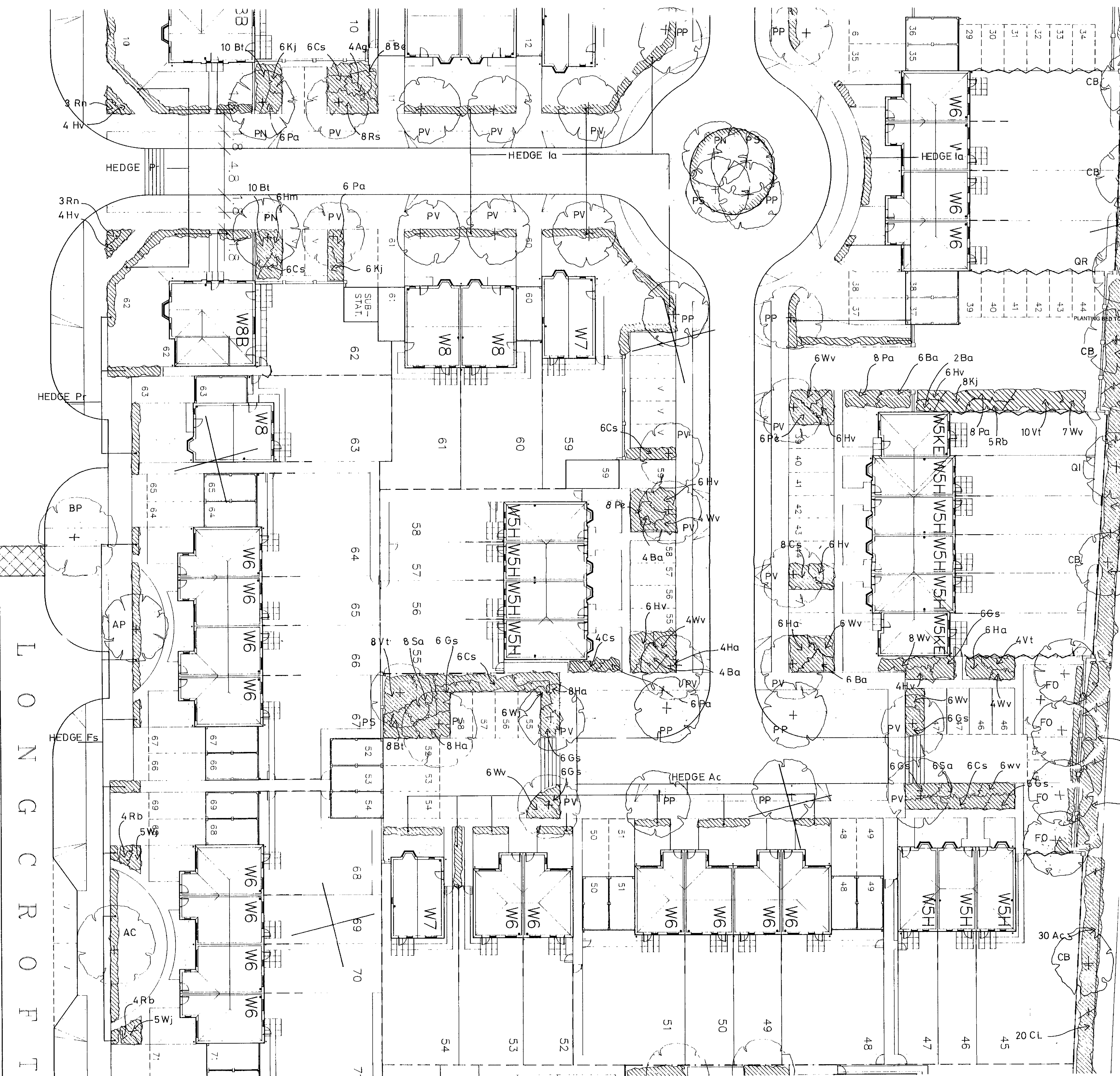

**DO NOT SCALE**  
 Report any errors or omissions  
 Check all dimensions on site prior to commencing the works or preparing any shop drawings.  
 This drawing is copyright.

NOTES:

**PLANT SCHEDULE**

**TREES**

All selected standards [3-3.5m with 10-12cm girth at 1m. above ground] bare rooted stock planted in min. 900 cubic mm pits

REF	SPECIES	NO.
AP	ACER PLATANOIDES 'CRIMSON SENTRY'	1
AC	ACER CAPPADOCICUM	1
CB	CARPUNUS BETULUS 'FASTIGIATA'	5
FO	FRAXINUS OXYCARPA 'RAYWOOD'	4
FJ	FRAXINUS EXCELSIOR 'ASPIDEA'	-
PN	PRUNUS PESSARDII 'NIGRA'	3
PP	PRUNUS PADUS 'PURPLE QUEEN'	9
PS	PRUNUS SIB. 'AUTUMNALIS'	3
PV	PRUNUS VIRGINIANA 'SCHUBERT'	19
QR	QUERCUS ROBUR 'FASTIGIATA'	1
QI	QUERCUS ILEX	1

All 1.2m. standards, bare rooted stock planted in min. 900 cubic mm pits

REF	SPECIES	NO.
BP	BETULA PENDULA	1

**SHRUBS**

All container grown in 1.5 to 3.0 litre pot sizes and planted in 450mm soil depth.

REF	SPECIES	NO.
Ac	ACER CAMPESTRE	30
Al	AMELANCHIER LAEVIS	-
Ag	ABELIA GRANDIFLORA	4
Bt	BERBERIS THUM. 'AUREA'	20
Ba	BUDDLEIA ALTERNIFOLIA	30
Ca	COLLUTEA ARBORESCENS	6
Cc	COTINUS COGGYGRIA	-
Cf	COTONEASTER FRANCHETTI	-
Cj	CORYLUS AVELLANA	65
Co	CORNUS STOLONIFERA 'FLAVIRAMEA'	40
Cp	CRATAEGUS PRUNIFOLIA	24
Cs	COTONEASTER SALICIFOLIUS 'FLOCCOSUS'	60
Dg	DEUTZIA GRACILIS	-
Ea	ELEAGNUS ANGUSTIFOLIA	33
Gs	GENISTA HISPANICA	42
Ha	HEBE ALBICANS	32
Hv	HEBE ELLIPTICA 'VARIEGATA'	42
Hm	HEBE MARJORIE	12
Hh	HYPERICUM 'HIDCOTE'	-
Ia	ILEX AQUIFOLIUM	-
Kj	KERRIA JAPONICA 'PLENIFOLIA'	34
Ma	MAHOIA A. QUIFOLIUM	10
Pa	POTENTILLA 'ABBOTSWOOD'	44
Pc	PRUNUS LUSITANICA	-
Pe	POTENTILLA 'TILFORD CREAM'	22
Pf	PRUNUS LUSITANICA	15
Pl	PYRACANTHA 'TETON'	-
Rb	ROSA 'BLANC DOUBLE DE COUBERT'	19
Rn	ROSA 'NEVADA'	12
Rs	ROSA 'SARA VAN FLEET'	18
Sa	SPIREA AITCHISONII	14
Sh	SYMPHORICARPOS X CHENAUILLI 'HANCOCK'	-
Vi	VIBURNUM OPULUS	44
Vt	VIBURNUM TINUS	22
Vr	VIBURNUM RHYNTHODOPHYLLUM	8
Wv	WEIGELA FLORIDA 'VARIEGATA'	71

**HEDGES**

All 1.2m. whips, bare rooted planted in 450mm deep trench. Plant in two rows 500mm apart, in staggered pattern 3 plants/m.

REF	SPECIES	NO.
Fs	FAGUS SYLVATICA	108
Ia	ILEX AQUIFOLIUM	312
Pr	PYRACANTHA ROGERSIANA	156
Ac/Cm	ACER CAMPESTRE / CRATAEGUS MONOGYNA	96

- D. TREES ADDED 9.94 VF
- C. REVISED SCHEDULE 7.94 VF
- B. REVISIONS TO PLANTING ALONG OSBOURNE WAY AND TO THE TREE SCHEME 6.94 VF
- A. ADDITIONAL PLANTING 4/94

PROJECT TITLE  
**ADMIRAL HOMES  
 LONGCROFT LANE  
 WELWYN GARDEN CITY**

DRAWING TITLE  
**PLANTING PLAN**

PROJECT No.	DRAWING No.	SCALE	DATE
10120	04 D	1:200	MAR 94
			DRAWN V.F.

**COYNE ASSOCIATES**  
 LANDSCAPE ARCHITECTS  
 STERLING COURT NORTON ROAD STEVENAGE HERTS SG1 2JY  
 TELEPHONE: 0438 728326 FAX: 0438 722035

LONGCROFT













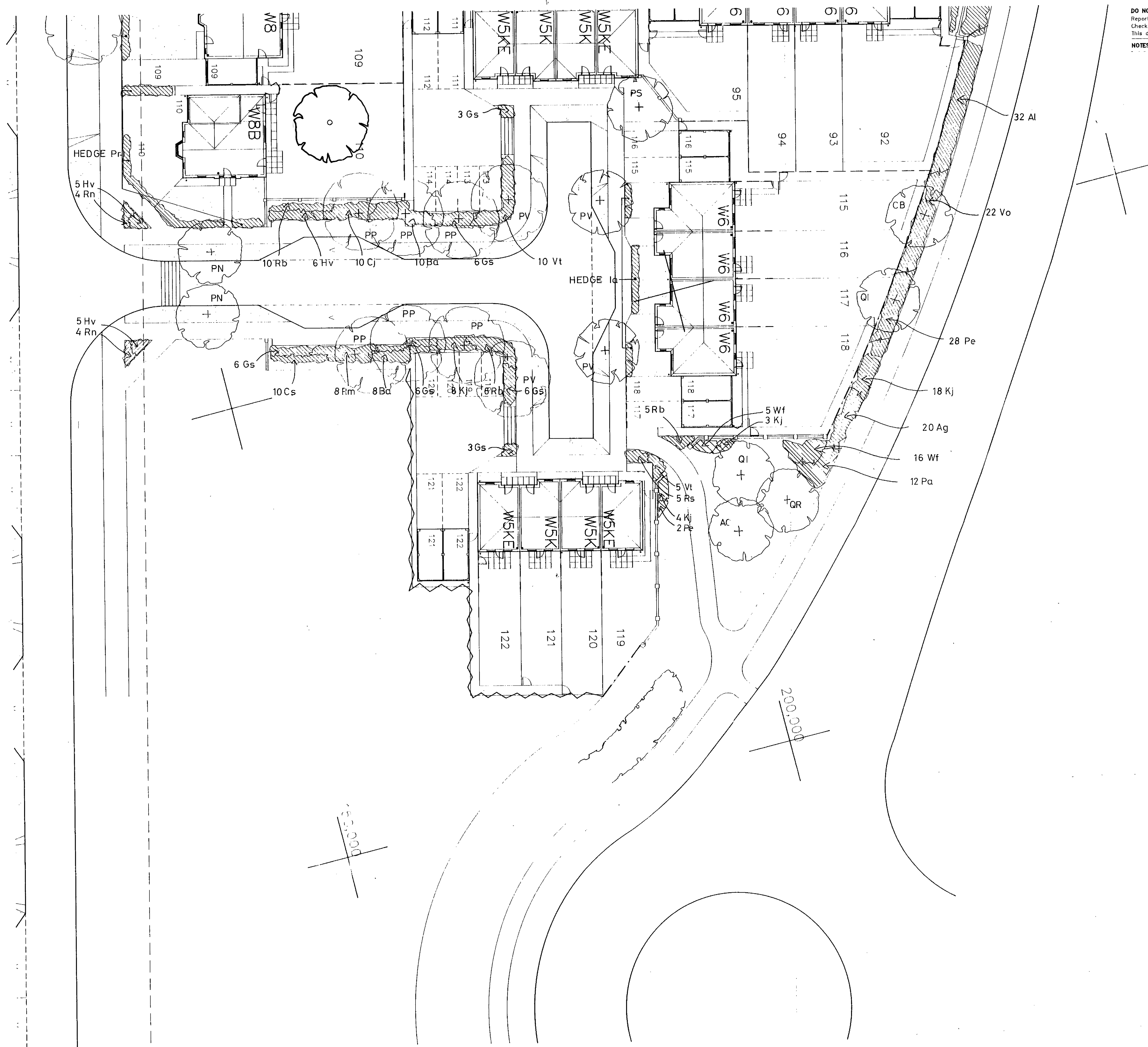

**DO NOT SCALE**  
 Report any errors or omissions  
 Check all dimensions on site prior to commencing the works or preparing any shop drawings.  
 This drawing is copyright.

**NOTES:**

**PLANT SCHEDULE**

**PLANT SCHEDULE**

**TREES**

All selected standards [3-3.5m with 10-12cm girth at 1m. above ground] bare rooted stock planted in min. 900 cubic mm pits

REF	SPECIES	NO.
AP	ACER PLATANOIDES 'CRIMSON SENTRY'	
AC	ACER CAPPADOCICUM	
CB	CARPUNUS BETULUS 'FASTIGIATA'	
FO	FRAXINUS OXYCARPA 'RAYWOOD'	
FJ	FRAXINUS EXCELSIOR 'JASPIDEA'	
PN	PRUNUS POSSARDII 'NIGRA'	
PP	PRUNUS PADUS 'PURPLE QUEEN'	
PS	PRUNUS SUB. 'AUTUMNALIS'	
PV	PRUNUS VIRGINIANA 'SCHUBERT'	
QI	QUERCUS ROBUR 'FASTIGIATA'	

All 1.2m. standards, bare rooted stock planted in min. 900 cubic mm pits

REF	SPECIES	NO.
BP	BETULA PENDULA	

**SHRUBS**

All container grown in 1.5 to 3.0 litre pot sizes and planted in 450mm soil depth.

REF	SPECIES	NO.
Ac	ACER CAMPESTRE	
Al	AMELANCHIER LAEVIS	
Ag	ABELIA GRANDIFLORA	
Bt	BERBERIS THUN. 'AUREA'	
Ba	BUDDLEIA ALTERNIFOLIA	
Ca	COLLUTEA ARBORESCENS	
Cc	COTINUS COCINGYRIA	
Cf	COTONEASTER FRANCHETTI	
Cl	CORYLUS AVELLANA	
Co	CORNUS STOLONIFERA 'FLAVIRAMEA'	
Cp	CRATAEGUS PRUNIFOLIA	
Cs	COTONEASTER SALICIFOLIUS 'FLOCCOSUS'	
Dg	DEUTZIA GRACILIS	
Ea	ELEAGNUS ANGUSTIFOLIA	
Gs	GENIST. HISPANICA	
Ha	HEBE ALBICANS	
Hv	HEBE ELLIPTICA 'VARIEGATA'	
Hm	HEBE MARJORIE	
Hh	HYPERICUM 'HIDCOTE'	
Ia	ILEX AQUIFOLIUM	
Ij	KERRIA JAPONICA 'PLENIFOLIA'	
Ma	MAHONIA AQUIFOLIUM	
Pa	POTENTILLA 'ABBOTSWOOD'	
Pc	PRUNUS LUSITANICA	
Pe	POTENTILLA 'TILFORD CREAM'	
Pi	RUNUS LUSITANICA	
Pt	PYRACANTHA TETON	
Rb	ROSA 'BLANC DOUBLE DE COUBERT'	
Rn	ROSA 'NEVADA'	
Rs	ROSA 'SARA VAN FLEET'	
Sa	SPIREA AITCHISONII	
Sh	SYMPHORICARPOS X CHENAUILLI 'HANCOCK'	
Vt	VIBURNUM OPULUS	
Vt	VIBURNUM TINUS	
Vr	VIBURNUM RHYTIDOPHYLLUM	
Wv	WEIGELA FLORIDA 'VARIEGATA'	

**CLIMBERS**

All container grown 2.0 litre pot size with min. 3 leading shoots fixed to canes.

REF	SPECIES	NO.
Fs	FAGUS SYLVATICA	
Ia	ILEX AQUIFOLIUM	
Pr	PYRACANTHA ROGERSIANA	
Ac/Cm	ACER CAMPESTRE / CRATAEGUS MONOGYNA	

B: REVISIONS TO PLANTING ALONG OSBOURNE WAY AND TO THE TREE SCHEME 6/94  
 A: ADDITIONAL PLANTING 4/94

**PROJECT TITLE**  
 ADMIRAL HOMES  
 LONGCROFT LANE  
 WELWYN GARDEN CITY

**DRAWING TITLE**  
 PLANTING PLAN

PROJECT No.	DRAWING No.	SCALE	DATE
10120	02	1:200	MAR. 94
			DRAWN V.F.

**COYNE ASSOCIATES**  
 LANDSCAPE ARCHITECTS  
 STERLING COURT, NORTON ROAD, STEVENAGE, HERTS SG1 2JY  
 TELEPHONE: 0438 728326 FAX: 0438 722035

