

DO NOT SCALE
Report any errors or omissions
Check all dimensions on site prior to commencing the works or preparing any shop drawings.
This drawing is copyright.

NOTES:

PLANT SCHEDULE

TREES

All selected standards [3-3.5m with 10-12cm girth at 1m. above ground] bare rooted stock planted in min. 900 cubic mm pits

REF	SPECIES	NO.
AP	ACER PLATANOIDES 'CRIMSON SENTRY'	1
AC	ACER CAPPADOCICUM	1
CB	CARPUNUS BETULUS 'FASTIGIATA'	1
FO	FRAXINUS OXYCARPA 'RAYWOOD'	5
FJ	FRAXINUS EXCELSIOR 'JASPIDEA'	1
PN	PRUNUS PESSARDII 'NIGRA'	1
PP	PRUNUS PADUS 'PURPLE QUEEN'	4
PS	PRUNUS SUB 'ALTIMAVALIS'	6
PV	PRUNUS VIRGINIANA 'SCHUBERT'	10
QR	QUERCUS ROBUR 'FASTIGIATA'	1
QI	QUERCUS ILEX	1

All 1.2m. standards, bare rooted stock planted in min. 900 cub/80c mm pits

REF	SPECIES	NO.
BP	BETULA PENDULA	1

SHRUBS

All container grown in 1.5 to 3.0 litre pot sizes and planted in 450mm soil depth.

REF	SPECIES	NO.
Ac	ACER CAMPESTRE	1
Al	AMELANCHIER LAEVIS	24
Ag	ABELIA GRANDIFLORA	27
Bb	BERBERIS THUM. 'AUREA'	16
Bd	BUDLEIA ALTERNIFOLIA	3
Ca	COLLUTEA ARBORESCENS	1
Cc	COTINUS COGGYGRIA	1
Cf	COTONEASTER FRANCHETTI	14
Cl	CORYLUS AVELLANA	1
Co	CORNUS STOLONIFERA 'FLAVIRAMEA'	50
Cp	CRATAEGUS PRUNIFOLIA	1
Cs	COTONEASTER SALICIFOLIUS 'FLOCCOSUS'	1
Dg	DEUTZIA GRACILIS	34
Ds	ELEAGNUS ANGUSTIFOLIA	60
Es	GENISTA HISPANICA	47
Hs	HEBE ALBICANS	1
Lv	HEBE ELLIPTICA 'VARIEGATA'	1
Hm	HEBE MARJORIE	34
Hh	HYPERICUM 'HIDCOTE'	18
la	ILEX AQUIFOLIUM	15
ia	KERRIA JAPONICA 'PLENIFOLIA'	6
Ma	MAHONIA AQUIFOLIUM	1
Pa	POTENTILLA 'ABBOTSWOOD'	1
Pc	PRUNUS LUSITANICA	1
Pe	POTENTILLA 'TILFORD CREAM'	1
Pl	PRUNUS LUSITANICA	1
Pr	PYRACANTHA TETON	28
Rb	ROSA 'BLANC DOUBLE DE COUBERT'	28
Rn	ROSA 'NEVADA'	16
Rs	ROSA 'SARA VAN FLEET'	36
Ss	SPYREA AITCHISONII	34
Sh	SYMPHORICARPOS X CHENAULTII 'HANCOCK'	7
Vo	VIBURNUM OPULUS	40
Vt	VIBURNUM TINUS	7
Vr	VIBURNUM RHYTIDOPHYLLUM	1
Wv	WEIGELA FLORIDA 'VARIEGATA'	51

HEDGES

All 1.2m. whips, bare rooted planted in 450mm deep trench. Plant in two rows 500mm apart, in staggered pattern 3 plants/m.

REF	SPECIES	NO.
Fs	FAGUS SYLVATICA	52
la	ILEX AQUIFOLIUM	90
Pr	PYRACANTHA ROGERSIANA	192
Ad/Cm	ACER CAMPESTRE / CRATAEGUS MONOGYNA	60

cc WGC LIST - Plants + Prices
cc Planted areas - Approved

C. REVISED SCHEDULE 7/94 VF
B. REVISIONS TO PLANTING ALONG OSBOURNE WAY AND TO THE TREE SCHEME 8/94 VF
A. ADDITIONAL PLANTING 4/94

PROJECT TITLE
ADMIRAL HOMES
LONGCROFT LANE
WELWYN GARDEN CITY

cc AD LOWGC
DRAWING TITLE
PLANTING PLAN

PROJECT NO.	DRAWING NO.	SCALE	DATE
10120	05	1:200	MAR 94

COYNE ASSOCIATES
LANDSCAPE ARCHITECTS
STERLING COURT NORTON ROAD STEVENAGE HERTS SG1 2JY
TELEPHONE: 0438 728326 FAX: 0438 722035

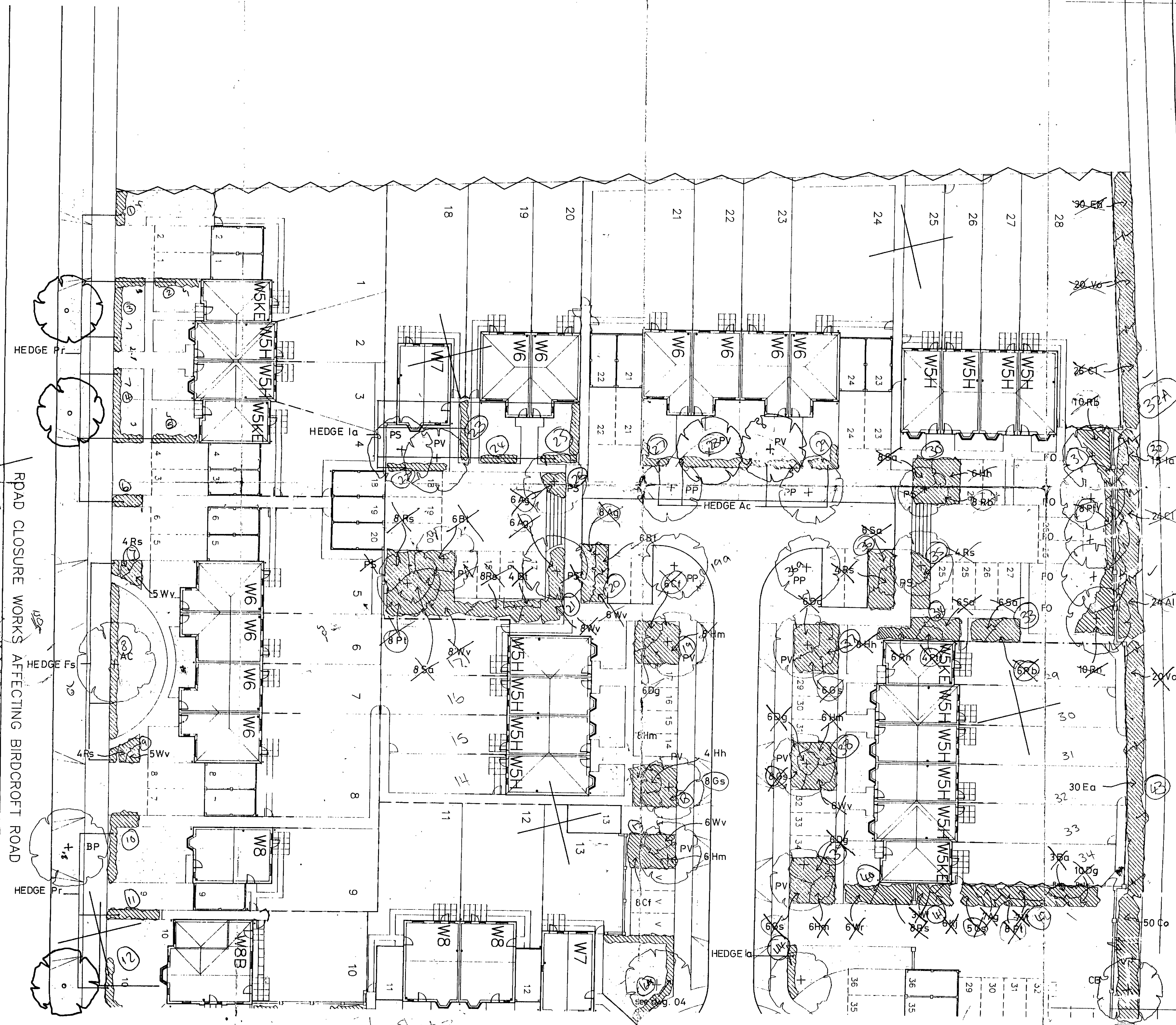

Sheet 3

DO NOT SCALE
Report any errors or omissions.
Check all dimensions on site prior
to commencing the works or preparing any shop drawings.
This drawing is copyright.

NOTES:

PLANT SCHEDULE

TREES

All selected standards [3-3.5m with 10-12cm girth at 1m. above ground] bare rooted stock planted in min. 900 cubic mm pits

REF	SPECIES	NO.
AP	ACER PLATANOIDES 'CRIMSON SENTRY'	1
AC	ACER CAPPADOCICUM	1
CB	CARPUNUS BETULUS 'FASTIGIATA'	5
FO	FRAXINUS OXYCARPA 'RAYWOOD'	4
FJ	FRAXINUS EXCELSIOR 'JASPEIDA'	-
PN	PRUNUS PESSARDII 'NIGRA'	3
PP	PRUNUS PADUS 'PURPLE QUEEN'	9
PS	PRUNUS SUB. 'ALTIUMMALIS'	3
PV	PRUNUS VIRGINIANA 'SCHUBERT'	19
QR	QUERCUS ROBUR 'FASTIGIATA'	1
QI	QUERCUS ILEX	1

All 1.2m. standards, bare rooted stock planted in min. 900 cubic mm pits

REF	SPECIES	NO.
BP	BETULA PENDULA	1

SHRUBS

All container grown in 1.5 to 3.0 litre pot sizes and planted in 450mm soil depth.

REF	SPECIES	NO.
Ac	ACER CAMPESTRE	30
Al	AMELANCHIER LAEVIS	4
Ag	ABELIA GRANDIFLORA	4
Bt	BERBERIS THUM. 'AUREA'	20
Ba	BUDDLEIA ALTERNIFOLIA	30
Ca	COLLUTEA ARBORESCENS	6
Cc	COTINUS COGYGRIA	-
Cf	COTONEASTER FRANCHETTI	-
Cl	CORYLUS AVELLANA	8
Co	CORNUS STOLONIFERA 'FLAVIRAMEA'	40
Cp	CRATAEGUS PRUNIFOLIA	24
Cs	COTONEASTER SALICIFOLIUS 'FLOCCOSUS'	60
Dg	DEUTZIA GRACILIS	-
Ea	ELEAGNUS ANGUSTIFOLIA	33
Gs	GENISTA HISPANICA	42
Ha	HEBE ALBICANS	32
Hv	HEBE ELLIPTICA 'VARIEGATA'	42
Hm	HEBE MARJORIE	12
Hh	HYPERICUM 'HIDCOTE'	-
Ia	ILEX AQUIFOLIUM	-
Ka	KERRIA JAPONICA 'BI ENJOU LA'	24
Ma	MAHONIA AQUIFOLIUM	10
Pa	POTENTILLA 'ABBOTSWOOD'	44
Pc	PRUNUS LUSITANICA	-
Pe	POTENTILLA TILFORD CREAM	22
Pl	PRUNUS LUSITANICA	15
Pt	PYRACANTHA TETON	-
Rb	ROSA 'BLANC DOUBLE DE COUBERT'	19
Rn	ROSA 'NEVADA'	12
Rs	ROSA 'SARA VAN FLEET'	18
Sa	SPIREA AITCHISONII	14
Sh	SYMPHORICARPOS X CHENAULTI 'HANCOCK'	-
Vl	VIBURNUM OPULUS	44
Vt	VIBURNUM TINUS	22
Vr	VIBURNUM RHYNTHIDOPHYLLUM	8
Wv	WEIGELA FLORIDA 'VARIEGATA'	71

HEDGES

All 1.2m. whips, bare rooted planted in 450mm deep trench. Plant in two rows 500mm apart, in staggered pattern 3 plants/m.

REF	SPECIES	NO.
Fs	FAGUS SYLVATICA	108
Ia	ILEX AQUIFOLIUM	312
Pr	PYRACANTHA ROGERSIANA	156
Ac/Cm	ACER CAMPESTRE / CRATAEGUS MONOGYNA	96

D: TREES ADDED	994 VF
C: REVISED SCHEDULE	794 VF
B: REVISIONS TO PLANTING ALONG OSBOURNE WAY AND TO THE TREE SCHEME	894 VF
A: ADDITIONAL PLANTING	4/94

PROJECT TITLE
ADMIRAL HOMES
LONGCROFT LANE
WELWYN GARDEN CITY

DRAWING TITLE
PLANTING PLAN

PROJECT No.	DRAWING No.	SCALE	DATE
10120	04 D	1:200	MAR. 94

COYNE ASSOCIATES
LANDSCAPE ARCHITECTS
STERLING COURT NORTON ROAD STEVENAGE HERTS SG1 2JY
TELEPHONE: 0438 728226 FAX: 0438 722035

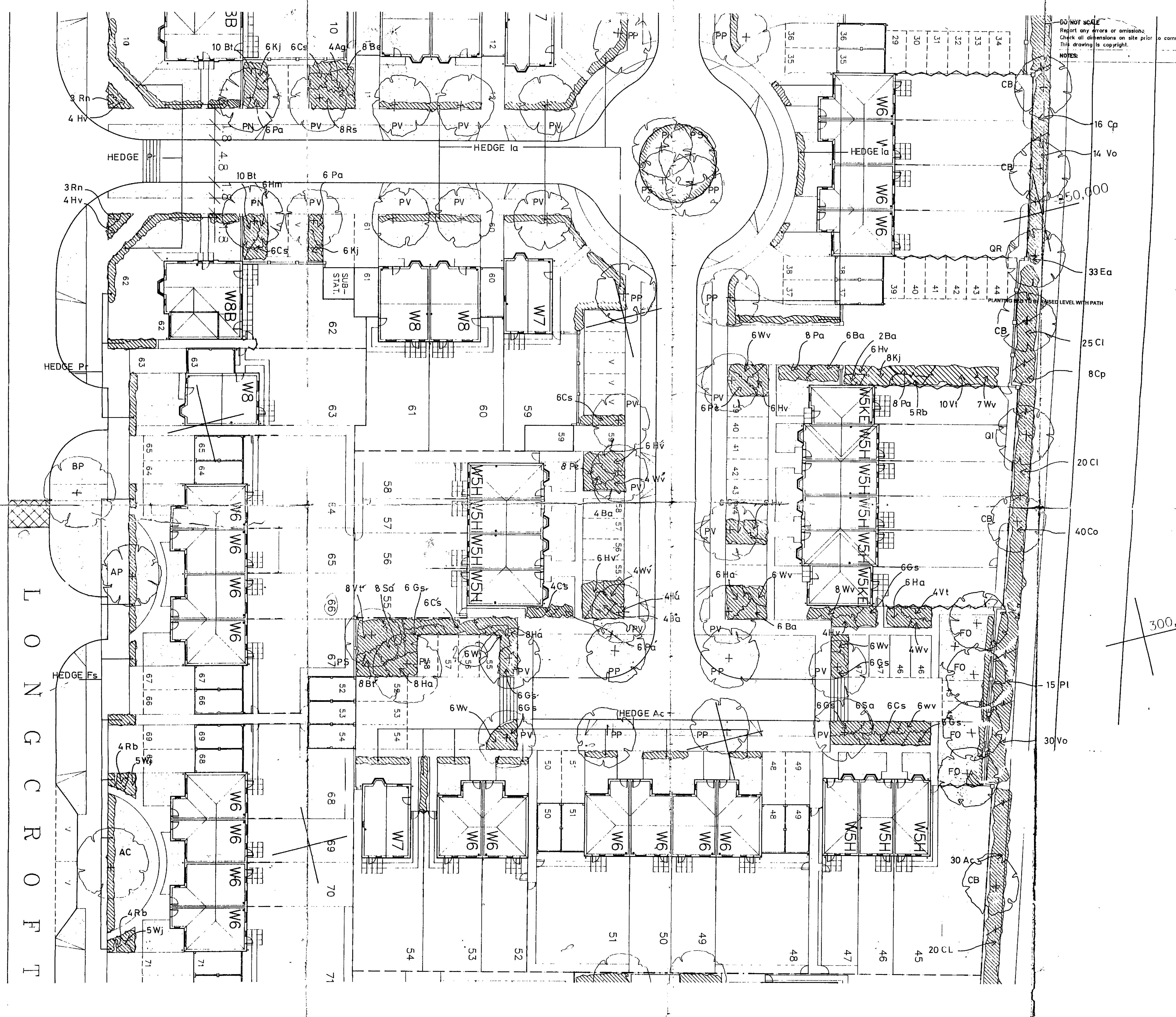

DO NOT SCALE
Report any errors or omissions
Check all dimensions on site prior to commencing the works or preparing any shop drawings.
This drawing is copyright.

NOTES

W
A
Y

PLANT SCHEDULE

TREES

All selected standards [3-3.5m with 10-12cm girth at 1m. above ground] bare rooted stock planted in min. 900 cubic mm pits

REF	SPECIES	NO.
AP	ACER PLATANOIDES 'CRIMSON SENTRY'	2
AC	ACER CAPPADOCICUM	2
CB	CARPUNUS BETULUS 'FASTIGIATA'	4
FO	FRAXINUS OXYCARPA 'RAYWOOD'	-
FJ	FRAXINUS EXCELSIOR 'ASPIDEA'	-
PN	PRUNUS PISSARDII 'NIGRA'	4
PP	PRUNUS PADUS 'PURPLE QUEEN'	-
PS	PRUNUS SUB. 'AUTUMNALIS'	-
PV	PRUNUS VIRGINIANA 'SCHUBERT'	8
QR	QUERCUS ROBUR 'FASTIGIATA'	1
QI	QUERCUS ILEX	1

All 1.2m. standards, bare rooted stock planted in min. 900 cubic mm pits

REF	SPECIES	NO.
BP	BETULA PENDULA	4

SHRUBS

All container grown in 1.5 to 3.0 litre pot sizes and planted in 450mm soil depth.

REF	SPECIES	NO.
Ac	ACER CAMPESTRE	-
Al	AMELANCHIER LAEVIS	-
Ag	ABELIA GRANDIFLORA	32
Bt	BERBERIS THUN. 'AUREA'	-
Ba	BUDDLEIA ALTERNIFOLIA	-
Ca	COLLUTEA ARBORESCENS	-
Cc	COTINUS COGOGYRIA	-
Cf	COTONEASTER FRANCHETTI	20
Cj	CORYLUS AVELLANA	-
Co	CORNUS STOLONIFERA 'FLAVIRAMEA'	-
Cp	CRATAEGUS PRUNIFOLIA	-
Cs	COTONEASTER SALICIFOLIUS 'FLOCCOSUS'	-
Dg	DEUTZIA GRACILIS	-
Ea	ELEAGNUS ANGUSTIFOLIA	-
Gs	GENISTA HISPANICA	-
Ha	HEBE ALBICANS	-
Hv	HEBE ELLIPTICA 'VARIEGATA'	-
Hm	HEBE MARJORAM	32
Hh	HYPERICUM 'HIDCOTE'	-
ia	ILEX AQUIFOLIUM	-
ia	KERRIA JAPONICA 'PLENIFOLIA'	40
Ma	MAHONIA AQUIFOLIUM	-
Pa	POTENTILLA 'ABBOTSWOOD'	-
Pc	PRUNUS LUSITANICA	-
Pe	POTENTILLA 'TILFORD CREAM'	-
Pi	PRUNUS LUSITANICA	-
Pt	PYRACANTHA TETON	-
Rb	ROSA 'BLANC DOUBLE DE COUBERT'	-
Rn	ROSA 'NEVADA'	-
Rs	ROSA 'SARA VAN FLEET'	-
Sa	SPIREA AITCHISONII	-
Sh	SYMPHORICARPOS X CHENAUETH 'HANCOCK'	-
Vo	VIBURNUM OPULIS	-
Vt	VIBURNUM TINUS	-
Vr	VIBURNUM RHYTIDOPHYLLUM	-
Ww	WEIGELA FLORIDA 'VARIEGATA'	-

HEDGES
All 1.2m. whips, bare rooted planted in 450mm deep trench. Plant in two rows 500mm apart, in staggered pattern 3 plants/m.

REF	SPECIES	NO.
Fs	FAGUS SYLVATICA	188
la	ILEX AQUIFOLIUM	42
Pr	PYRACANTHA ROGERSIANA	354
Ac/Cm	ACER CAMPESTRE / CRATAEGUS MONOGYNA	-

D: TREES ADDED 6/94 VF
C: REVISED SCHEDULE 7/94 VF
B: REVISIONS TO PLANTING ALONG OSBOURNE WAY AND TO THE TREE SCHEME 6/94 VF
A: ADDITIONAL PLANTING 4/94

PROJECT TITLE
ADMIRAL HOMES
LONGCROFT LANE
WELWYN GARDEN CITY

DRAWING TITLE
PLANTING PLAN

PROJECT No.	DRAWING No.	SCALE	DATE
10120	03D	1:200	MAR. 94

COYNE ASSOCIATES
LANDSCAPE ARCHITECTS
STERLING COURT NORTON ROAD STEVENAGE HERTS SG1 2JY
TELEPHONE: 0438 728326 FAX: 0438 722035

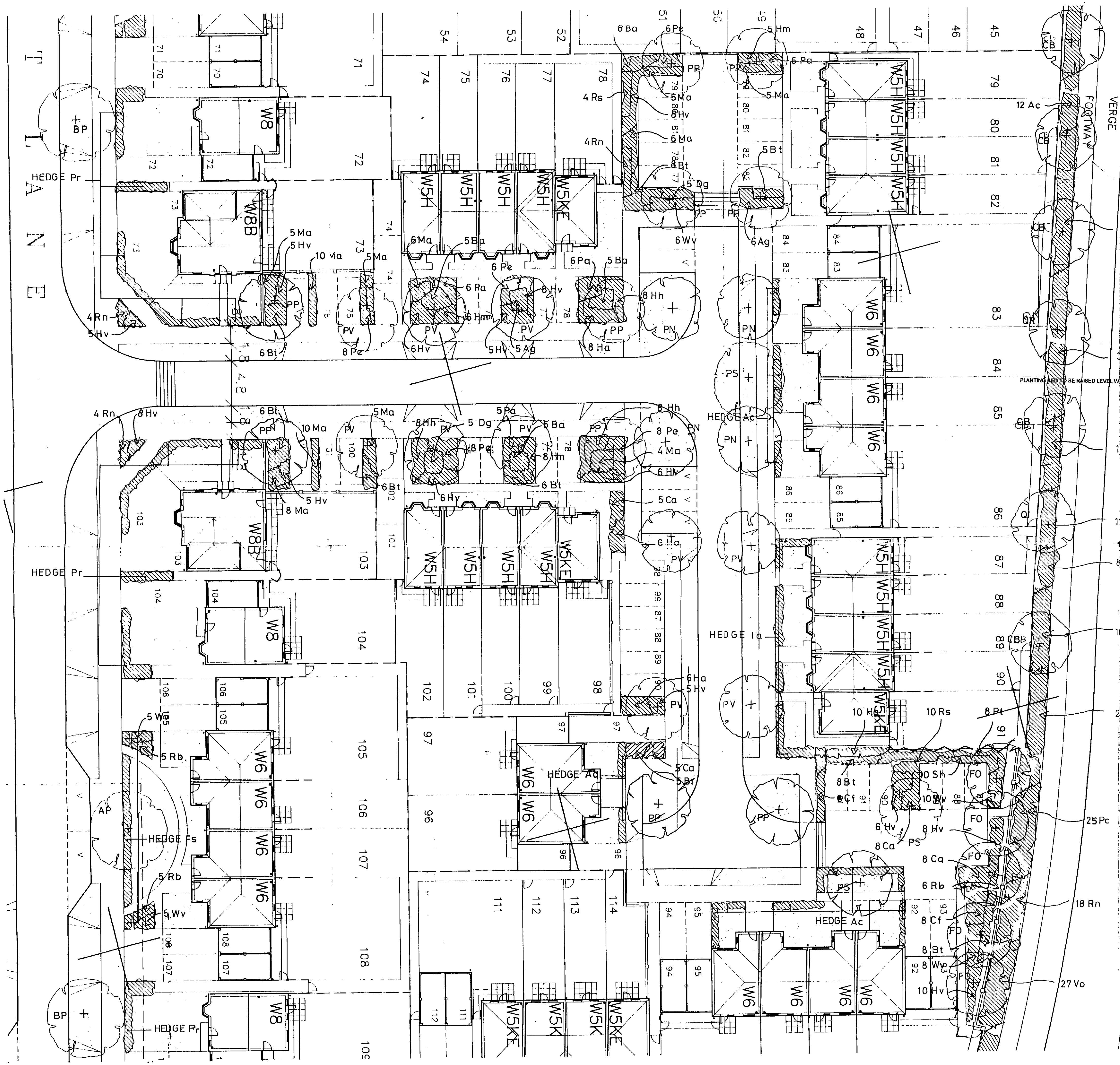

3M VERGE, 2M FOOTWAY & 2M PLANTING ZONE BETWEEN OSBORNE WAY AND NEW 2M HIGH BOUNDARY FENCE AND SCREEN WALL. SEE DRAWING 850/12

