

Bishop's Square

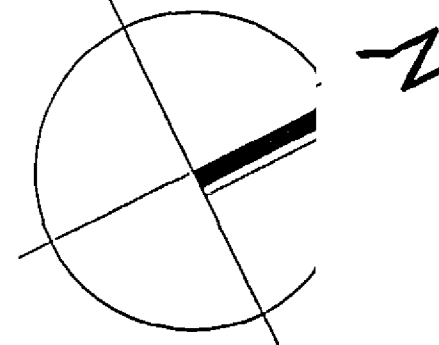

Site for Business & Innovation Centre  
(to be developed by Arlington)

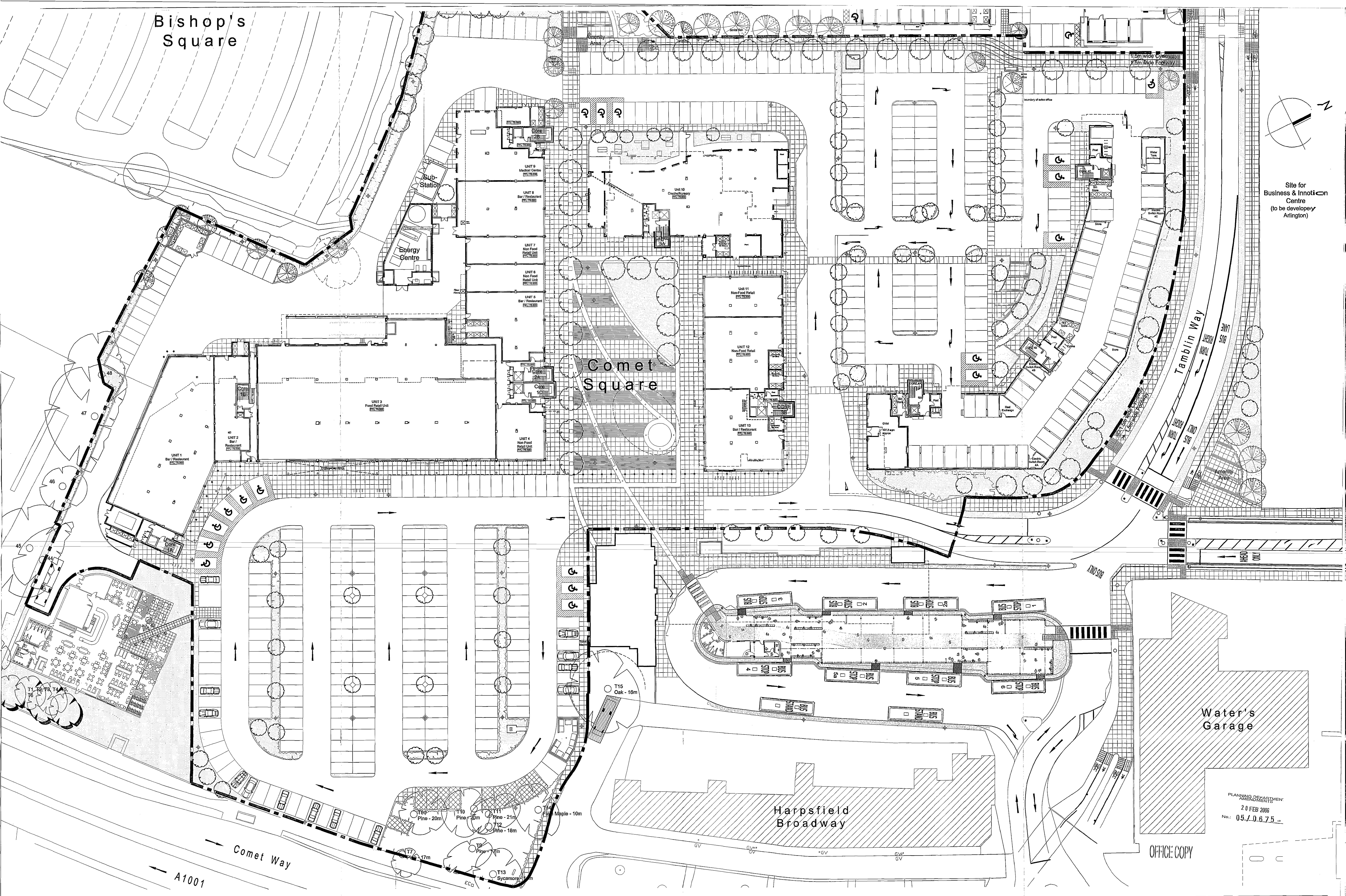

Water's Garage

Harpsfield Broadway

Comet Way

A1001

PLANNING DEPARTMENT  
20 FEB 2006  
No. 05.1.06.75

OFFICE COPY

This drawing must not be scaled.  
Figured dimensions and levels to be used.  
Any inaccuracies must be notified to the architect.  
Detail drawings and large scale drawings take precedence over smaller drawings.

Revisions:  
A 15.08.05 zj Amendments to the bus interchange, family pub and surrounding transport circulation, landscape and reserved matters. Planning Application Boundary, Sitecore to Block 1 moved.  
B 08.09.05 ms 4 No. trees added to south car park. Road approach to interchange amended. Original boundary line added.  
C 11.10.05 af Roads layout amended. Plans for Blocks 1, 2, 3 & 4 updated.  
D 16.02.06 af Blocks 1, 2, 3 & 4 updated. Energy centre detail added. Interchange layout revised.  
ISSUED TO PLANNING (see letter of 16th Feb 2006)

Key  
◆ Street Lighting Columns  
◆ Bollards

DESIGN	✓
TENDER	
CONSTRUCTION	Approved

**powell d obson**  
ARCHITECTS

Contract: Comet Square II, Hatfield  
Frontier (Key) Hatfield Ltd  
Planning : Ground Floor Master Plan

Scale: 1:250 @ A0  
Date: May 2005  
Drawn: zj  
Checked: DL



Bishop's Square

10 Car Spaces

39 Car Spaces

52 Car Spaces

32 Car Spaces

19 Car Spaces

2 Car Spaces

Comet Square

34 Car Spaces

232 Car Spaces

Harpsfield Broadway

Comet Way

A1001

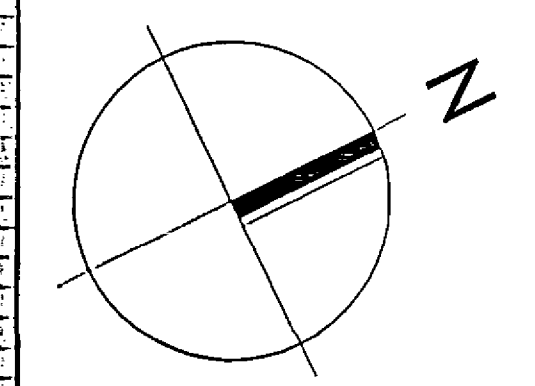

Site for Business & Innovation Centre (to be developed by Arlington)

NOTES

1. For Blocks 1, 2, 3 & 4 plans see: G2120 B1 (20) 200; G2120 B2 (20) 200; G2120 B3 (20) 200; G2120 B4 (20) 200;
2. For Pedestrian/Cycle link to rear of Next Generation, see drawing: G2120 G (60) 201
3. For Hard and Soft landscaping proposals see ACD Landscape drawings.
4. For setting out co-ordinates see drawings: G2120 G (60) 300, 301, 302 & 304
5. For boundary fencing see drawing: G2120 G (60) 202

SITE KEY:

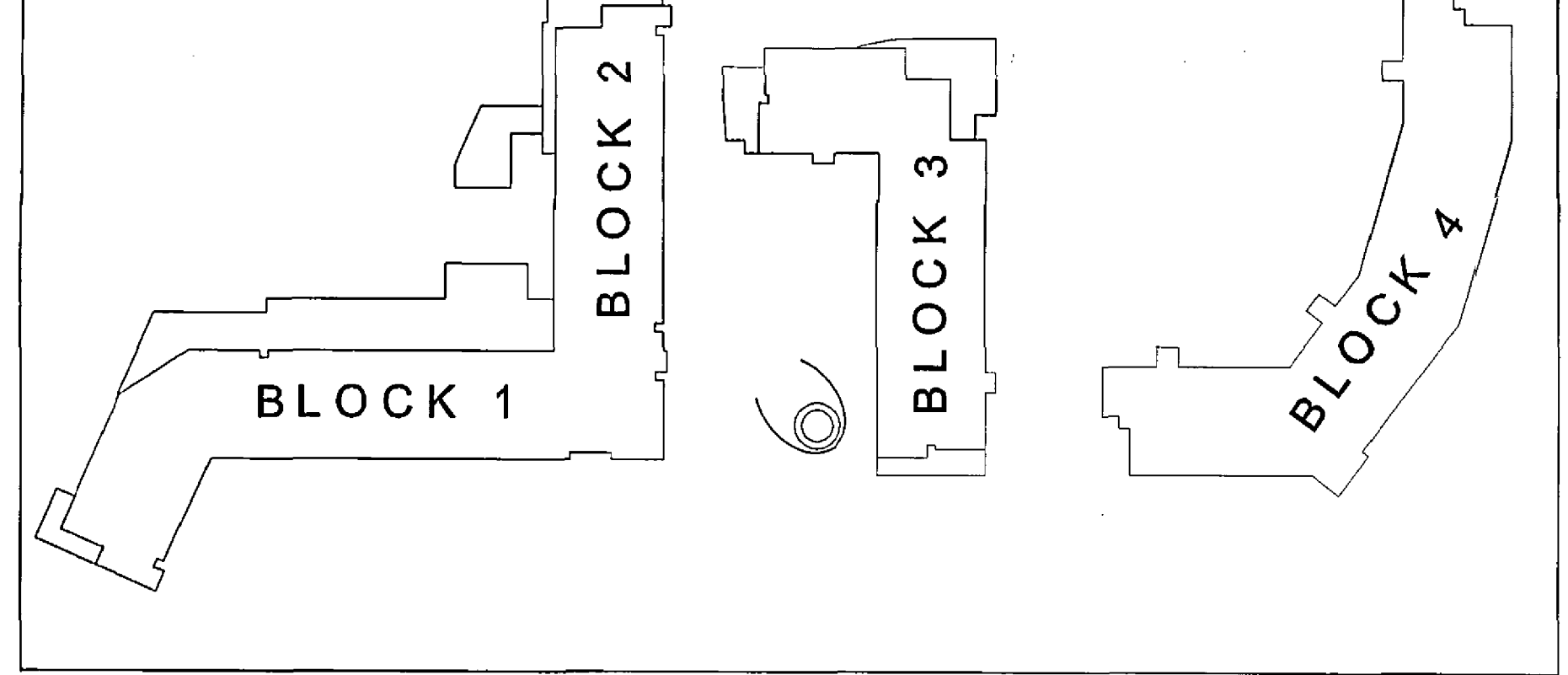

OFFICE COPY

PLANNING DEPARTMENT  
28 FEB 2005

No. 0570675

PRELIMINARY

Revisions:			
A	19.08.05	AF	Barratts boundary clarified. Proposed hotel and family pub deleted for clarity. Drawing number revised. Barrels site access added.
B	08.09.05	AF	Bin store layout adjacent Unit 1 and sub-station location revised as requested by Frontier and instructed by BNL. A101 Delivery ramp length reduced as shown on JNP drawings.
C	11.10.05	AF	Site Boundary revised to include turning head at rear of Unit One. Ticket Machine adjacent hotel entrance moved to be clearly inside BNL site. Main road (Tamblyn Way) layout revised to BWB construction drawing.
D	14.10.05	AF	Energy Centre plan added
E	16.02.06	AF	Block Plans generally updated: see respective floor plans. Notes added, North Point added. ISSUED TO PLANNING (see letter of 16th Feb 2006)

**Key**  
 Street Lighting Columns  
 Bollards  
 Landscaped areas.  
 For details refer to Landscape Architects drwgs

PRELIMINARY	<input checked="" type="checkbox"/>
DESIGN	<input type="checkbox"/>
TENDER	<input type="checkbox"/>
CONSTRUCTION	<input type="checkbox"/>

**powelldobson**  
ARCHITECTS

Contract: Barratt North London  
Comet Square Phase II, Hatfield  
Title: Ground Floor Site Plan

Drawing No. G2120 G (60) 200 Rev. E  
 Scale: 1:250 @ A0  
 Date: July 2005  
 Drawn: ZJ  
 Checked: DL