

This map is based upon Ordnance Survey material with the permission of Ordnance Survey on behalf of the Controller of Her Majesty's Stationery Office. Unauthorised reproduction infringes Crown copyright and may lead to prosecution or civil proceedings. Hertfordshire County Council, LA 076678, 2004

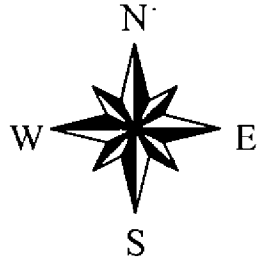

Scale before copying:
1:1250

Tolmers Avenue CUFFLEY

Public Rights of Way
The Rights of way information on this plan is based on information from the Definitive Map of Public Rights of Way in Hertfordshire ('the Definitive Map'). The accuracy of this plan cannot be guaranteed. If in doubt the Definitive Map should be consulted.

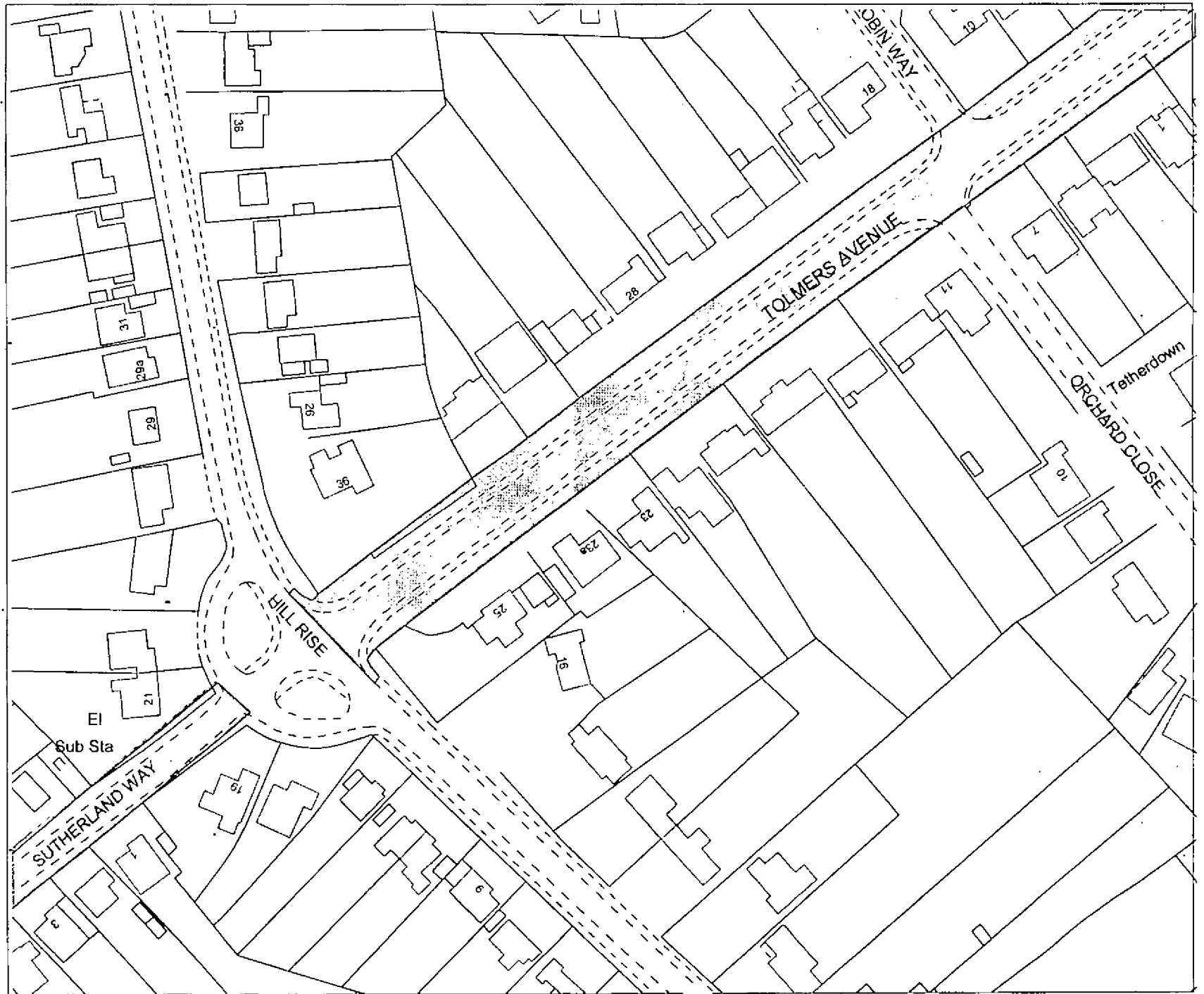

This map is based upon Ordnance Survey material with the permission of Ordnance Survey on behalf of the Controller of Her Majesty's Stationery Office. Unauthorised reproduction infringes Crown copyright and may lead to prosecution or civil proceedings Hertfordshire County Council, LA 076678, 2004

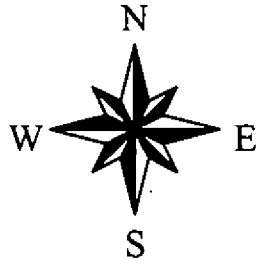

Scale before copying:
1:1500

Tolmers Avenue CUFFLEY

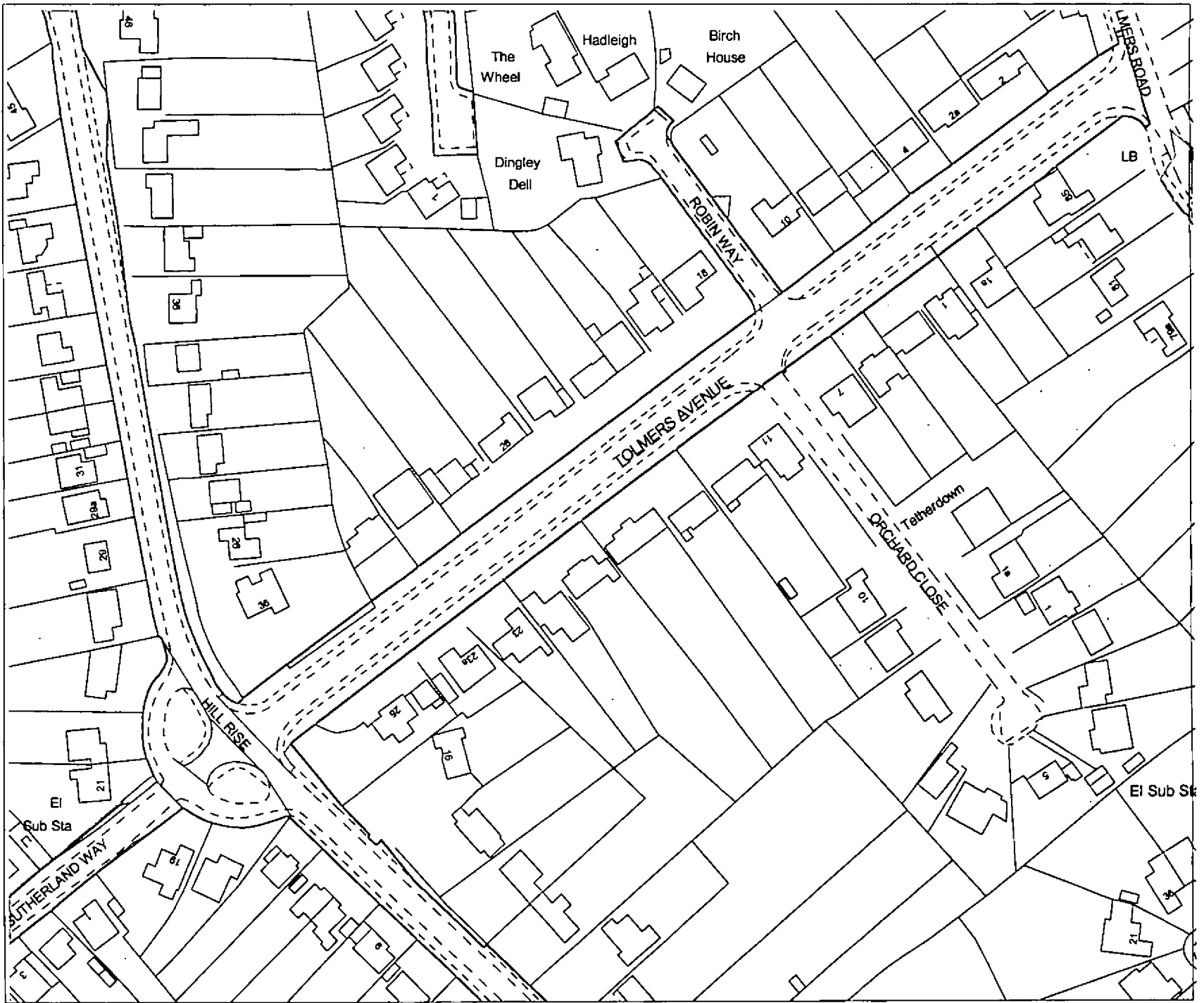

Public Rights of Way
The Rights of way information on this plan is based on information from the Definitive Map of Public Rights of Way in Hertfordshire ("the Definitive Map"). The accuracy of this plan cannot be guaranteed. If in doubt the Definitive Map should be consulted.



SITE PLAN - 1:200

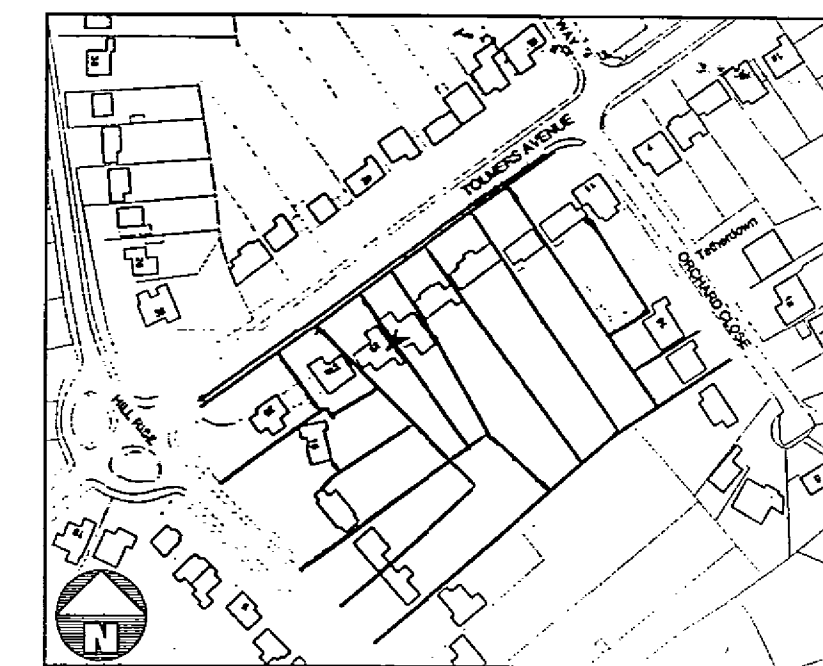

LOCATION PLAN - 1:2500

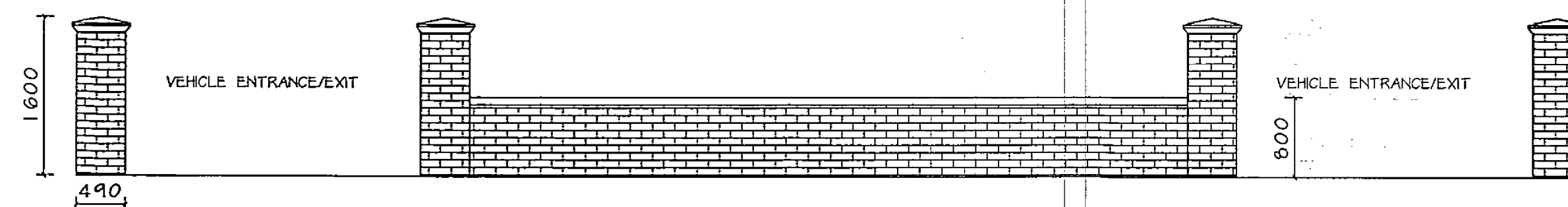

FRONT BOUNDARY WALL ELEVATION - 1:50

WELWYN HATFIELD COUNCIL
TOWN & COUNTRY PLANNING ACT 1980
PLAN REFERRED TO IN
CONSENT REFUSAL
DATED: 30 SEP 2005

COPYRIGHT: The contents of this drawing may not be reproduced in part or in whole without the written consent of Ray Ruff	
PROJECT: Erection of front perimeter dwarf wall	DRAWING NUMBER: RR0501/1
DRAWING: Layouts, Elevations, Site & Location plans for Planning Application	
CLIENT: Ray Ruff	<div style="border: 1px solid black; padding: 5px; text-align: center;"> WELWYN HATFIELD PLANNING OFFICE COPY 08 AUG 2005 No: 86/2005/992/FP </div>
SITE: 23, Tolmers Avenue Cuffley Herts., EN6 4QA	
DATE: June 2005	
SCALE: 1:50; 1:200; 1:2500	
Amendment:	
THIS WORK MAY BE AFFECTED BY THE PROVISIONS OF THE PARTY WALL ETC. ACT 1996	
THE CONTRACTOR MAY BE RESPONSIBLE FOR NOTIFYING HSE UNDER CDM REGULATIONS 1994 IF THE PROJECT IS COMMERCIAL OR INDUSTRIAL, A PLANNING SUPERVISOR SHOULD BE APPOINTED.	