

Siteplan®

1:1250 Scale

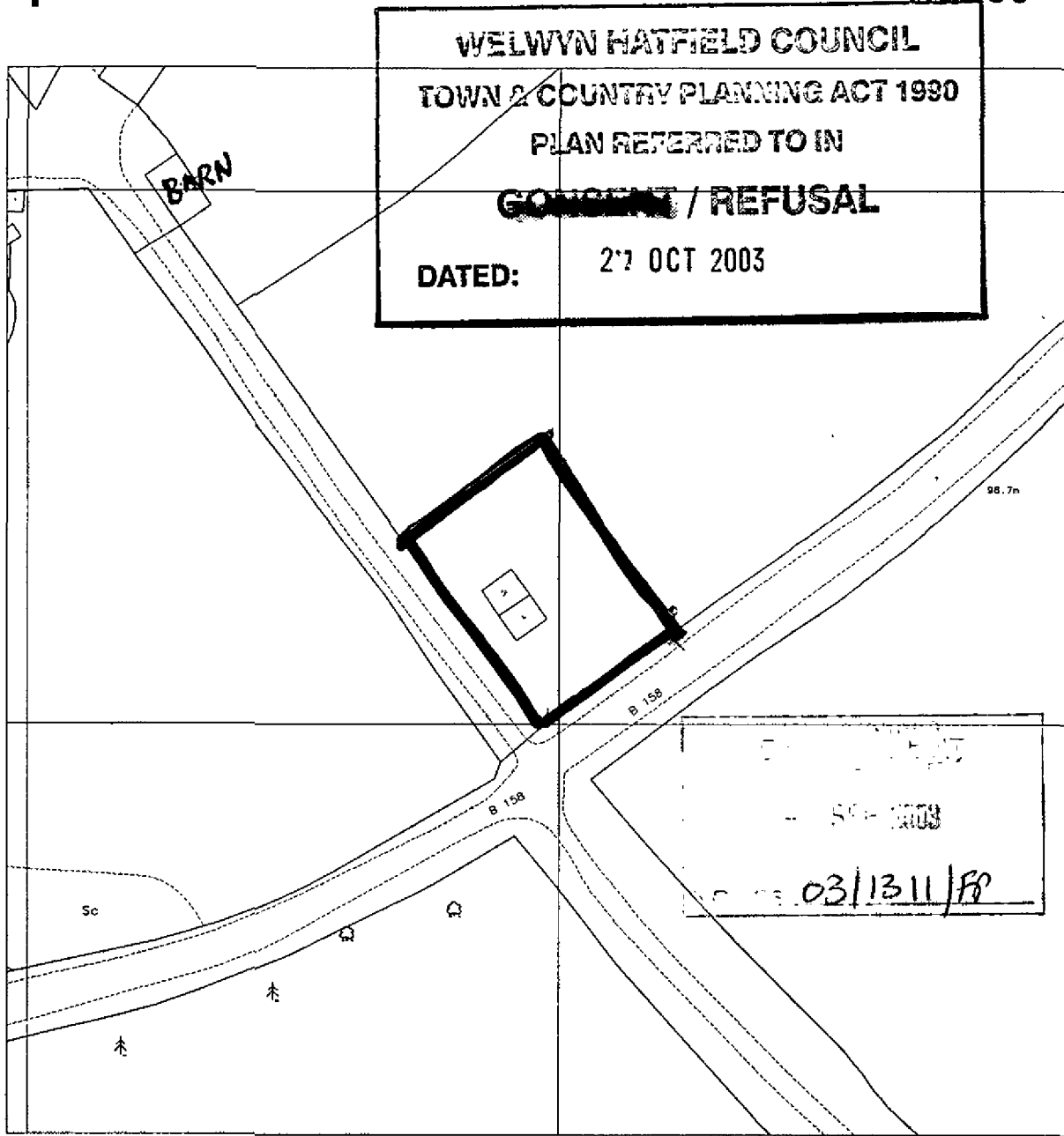

Produced 20 Aug 2003 from Ordnance Survey digital data and incorporating surveyed revision available at this date. © Crown Copyright 2003.

Reproduction in whole or in part is prohibited without the prior permission of Ordnance Survey.

Ordnance Survey and the OS symbol are registered trade marks and Siteplan a trade mark of Ordnance Survey, the national mapping agency of Great Britain.

Part or all of this Siteplan is enlarged from mapping produced at one or more of the following scales 1:1250, 1:2500, 1:10000.



Wyndham Cottage, Camfield Place
Essendon
Herts
AL9 6JE

Centre Coordinates: 526996 206823

National Grid sheet reference at centre of this Siteplan: TL2606

Supplied by: National Map Centre Hatf
Serial Number: 00002188



Siteplan

Symbols and depiction

Boundary Information

County/Region Island Boundary	---
District/London Borough Boundary	---
Parish/Community Boundary
Electoral Division/Ward Boundary	----
Parliamentary Constituency or Euro Const Boundary	----
Boundary Merging Change Symbol	○—○
Boundary Post, Boundary Stone (BP, BS)	*



Vegetation

Non-Coniferous Trees	Nc
Non-Coniferous Trees (Scattered)	Nc (scat)
Non-Coniferous Trees (Positioned)	
Coniferous Trees	C
Coniferous Trees (Scattered)	C (scat)
Coniferous Trees (Positioned)	
Orchard	Orch
Coppice/Osiers	Cop
Rough Grass	RG
Heath	Heath
Scrub	Sc
Saltings/Marsh/ Reeds	Marsh
Vegetation Limits	





Areas (Rural survey mapping only)

Areas Parcel No (published)	4224
-----------------------------	------

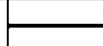
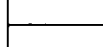
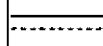
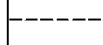
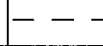
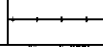
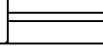

Buildings

Roofed Structure/ Glasshouse	
Upper Level of Communication	

Others

Spot Height	+
Bench Mark	←
Triangulation Station	△
Pylon/Flare Stack/ Lighting Tower	⊠
Flow Arrow	→
Mean High Water	
Mean Low Water	
General Detail	
Underground Detail	
Overhead Detail	
Tramway/ Narrow Gauge Railway	
Standard Gauge Railway	
Point Fixture (e.g. Letterbox)	*
Water Feature	
Water	Water
Archway	
Non-Roman Antiquity	

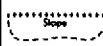
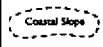
Ornament

Rock	Rock
Inland Rock (Scattered)	Rock (scat)
Shingle	Shingle
Mud	Mud
Inland Boulders	Bs
Inland Boulders (Scattered)	Bs (scat)
Coastal Boulders	Boulders
Sand	Sand
Slope	
Coastal Slope	
Cliff	
Scree	Scree

Common Abbreviations

Boundaries Information

ED Boundary	Electoral Division
Ward Boundary	Ward
Boro Const Bdy	Constituency
Euro Const Bdy	(County Borough or European)
Und	Undefined
CB	Centre of Bank
CD	Centre of Ditch
CR	Centre of Road
CS	Centre of Stream
Def	Defaced
FF	Face of Fence
FW	Face of Wall
SR	Side of River
TB	Top of Bank
TkH	Track of Hedge
RH	Root of Hedge

Other Information

Chy	Chimney
EP	Electricity Pillar or Pole
ETL	Electricity Transmission Line
FB	Foot Bridge
FS	Flagstaff
GP	Guide Post
GVC	Gas Valve Compound
LB	Letter Box
Mem	Memorial
MHW	Mean High Water
MLW	Mean Low Water
NTL	Normal Tidal Limit
P	Post or Pole
PC	Public Convenience
PH	Public House
PO	Post Office
PW	Place of Worship
TCS	Telephone Call Box
Tk	Tank or Track
(um)	Unmade
W	Well



Field SACRE
DOWN TO DUNCANS
WOOD
CAMFIELD
ESTATES

BOUNDARY FENCE

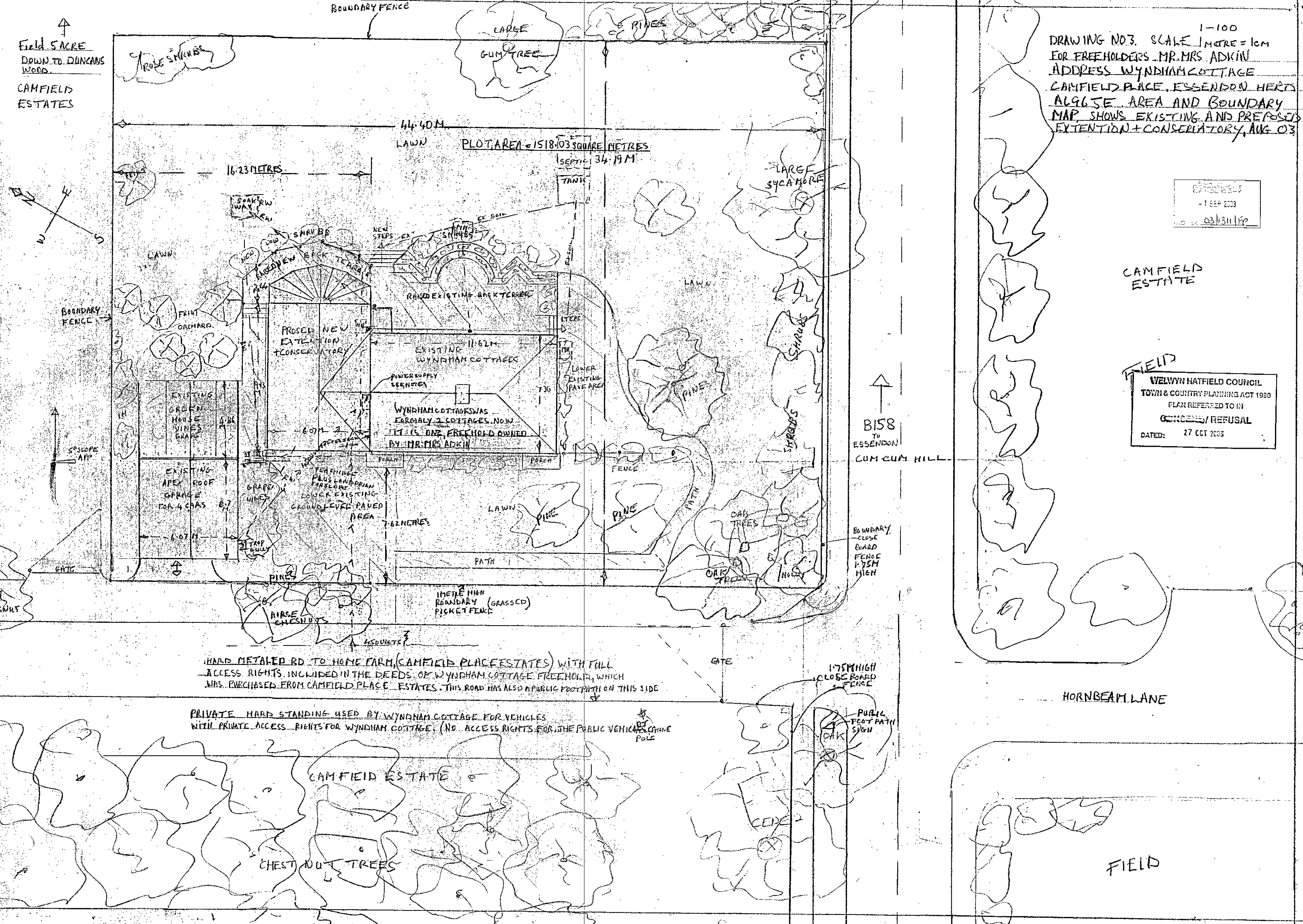

PLOT AREA = 1518.03 SQUARE METRES

SEPTIC TANK 34.19M

DRAWING NO.3. SCALE 1:100
FOR FREEHOLDERS MR. MRS. ADKIN
ADDRESS WYNDHAM COTTAGE
CAMFIELD PLACE, ESSENDON, HERTS
ALGIVE AREA AND BOUNDARY
MAP SHOWS EXISTING AND PROPOSED
EXTENSION + CONSERVATORY, AUG 03

1 SEP 2003
03/13/11/19

CAMFIELD
ESTATE

WELWYN HATFIELD COUNCIL
TOWN & COUNTRY PLANNING ACT 1990
PLAN REFERRED TO IN
CONDEMN/ REFUSAL
DATED: 27 OCT 2005

B158
TO
ESSENDON
CUM CUM HILL

BOUNDARY
CLOSE
BOARD
FENCE
1.75M
HIGH

HARD METAL RD TO HOME FARM (CAMFIELD PLACE ESTATES) WITH FULL
ACCESS RIGHTS INCLUDED IN THE DEEDS OF WYNDHAM COTTAGE FREEHOLD, WHICH
WAS PURCHASED FROM CAMFIELD PLACE ESTATES. THIS ROAD HAS ALSO A PUBLIC FOOTPATH ON THIS SIDE

PRIVATE HARD STANDING USED BY WYNDHAM COTTAGE FOR VEHICLES
WITH PRIVATE ACCESS RIGHTS FOR WYNDHAM COTTAGE. (NO ACCESS RIGHTS FOR THE PUBLIC VEHICLE)
BY SIGN
POLC

1.75M HIGH
CLOSE BOARD
FENCE

HORNBEAM LANE

CHESTNUT TREES

FIELD