

Note two storey rear extensions to Nos 2 and 4 Rooks Hill

Party wall stride the boundary subject to Party Wall Agreement

Proposed part single and part two storey rear extension

Silver Birch

Unknown

Unknown

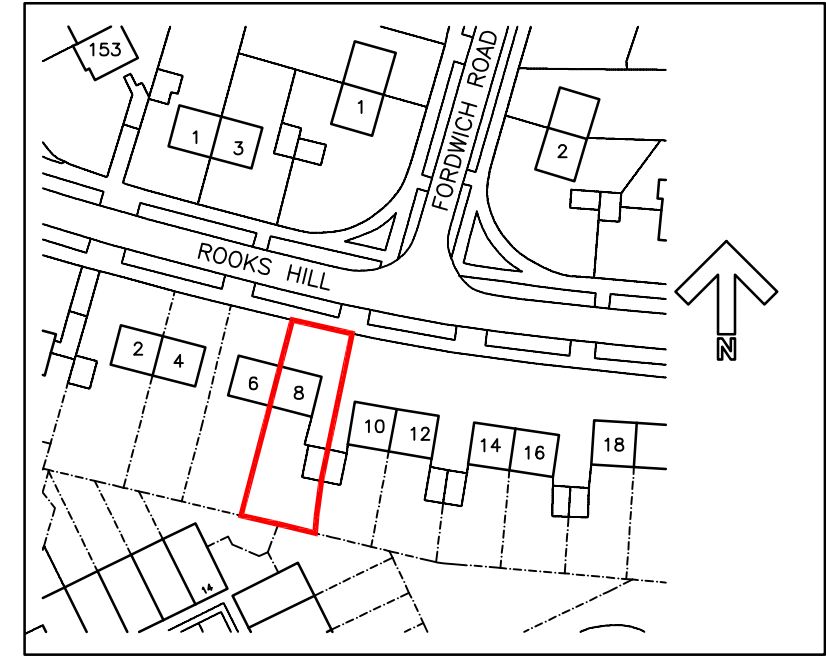

Site Location Plan 1:1250

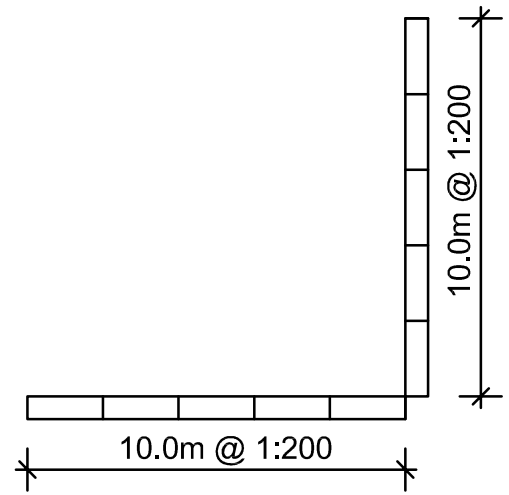

Rev.	Description.	Date.
------	--------------	-------

AT Design (Welwyn) Ltd
 Architectural Design Services
 22 School Lane, Welwyn, Herts AL6 9PH
 Tel: 07931703297 - email: adamtrigg@hotmail.com

Title;
 Proposed extension
 8 Rooks Hill
 Welwyn Garden City
 Herts AL8 6JT
Site Plan & Location Plan

Scale : 1:200 @ A3
 Date : April 2013
 Drawn by: AT

Drg.No: AT442-01