

Note 1 :
The root protection area is the area (m²) surrounding a tree which contains sufficient rooting volume to ensure the survival of the tree.
Refer :
1. Findings of Arboricultural Impact Assessment, including tree survey & arboricultural constraints report & plan. By CBA Trees Ltd.
Excavation in protected area :
- Method: By hand or approved mechanical machinery (air spade) under arboricultural supervision
- Backfill as soon as possible or temporarily line with polyethylene sheet to reduce evaporation.
- Outside protected area: Give notice of roots exceeding 25mm and do not cut without approval from Arboricultural Consultant.
Cutting:
- Make clean smooth cuts with no ragged edges.
- Pare cut surfaces smooth with a sharp knife.
- Treatment of cut roots: To Arboricultural Consultants recommendations.
Backfill: As dug material. Copious watering may alleviate further stress and reduce further root dieback due to desiccation.
(Refer : BS 3998 :Recommendations for tree work)

Note 2 :
Care must be taken to protect the existing trees to be retained (As listed in the Arboricultural survey), to a level which ensures the trees, shape, form and healthy survival.
Precautions required to be taken during the demolition and construction stage of works should be in accordance with BS 5837:2012 Trees in relation to construction, including:
- Prevention of physical damage to roots by soil compaction or severing.
- Provisions for water and oxygen to roots systems.
- Allowing for future growth to the root systems.
- Preservation of the soil structure around root system at suitable bulk density for root function.
(Refer : BS 5837 :Trees in relation to construction)

Note 3 :
Removal of trees: To standard of BS 3998
Identification: Clearly mark trees to be removed, with spray paint marker and tag on trunk.
Safety: Comply with HSE/ Arboriculture and Forestry Advisory Group Safety Guides.
Felling: As close to the ground as possible. All work to be undertaken by a qualified tree surgeon.
Stumps: Remove to a minimum depth of 450 mm below ground level or to a level set by the Structural Engineer in the specification, whatever the greater.
Work near retained trees: Take down trees carefully in small sections to avoid damage to adjacent trees that are to be retained, where tree canopies overlap and in confined spaces generally.
Removing small trees, shrubs, hedges and roots: To standard of BS 3998.
Identification: Clearly mark trees to be removed, with spray paint marker and tag on trunk.
Small trees, shrubs and hedges: Cut down.
Roots: Grub up and dispose of without undue disturbance of soil and adjacent areas.
Safety: Comply with HSE/ Arboriculture and Forestry Advisory Group Safety Guides.

Note 4 :
Should a tree be damaged or destroyed, the contractor will be liable for any Local Authority penalties and may need to replace the tree either with a healthy, semi-mature tree of an identical type /species, as defined by the National Plant Specification, or whatever age/type of tree is specified by the Local Authority, whichever is the more onerous.
(Refer: Preliminaries and General specification)

Note 5 :
Additional tree removal proposals and any replacement planting subject to written approval by Local Planning Authority.

Responsibility is not accepted for errors made by others in scaling from this drawing.
All construction information should be taken from figured dimensions only.

Legend

- Existing Trees to be retained and protected throughout construction
To BS 5837:2012
Refer to 'Tree Constraints Plan' by MKsurveys
- Existing Trees and Tree Groups to be removed or trimmed back to boundary
To BS 5837:2012
Refer to 'Tree Constraints Plan' by MKsurveys
- - - Trees Root Protection Area (RPA)
To BS 5837:2012
Refer to 'Tree Constraints Plan' by MKsurveys
- - - Trees Protective Fencing
To BS 5837:2012
(See image below Legend)
- Trees Group Root Protection Area (RPA)
To BS 5837:2012 standards
Refer to 'Tree Constraints Plan' by MKsurveys
- 12**
G7 Trees and Tree Groups number
Refer to 'Tree Constraints Plan' by MKsurveys
- Proposed Building Outlines
Including old Comet Hotel and new extension

BRITISH STANDARD BS 5837:2012

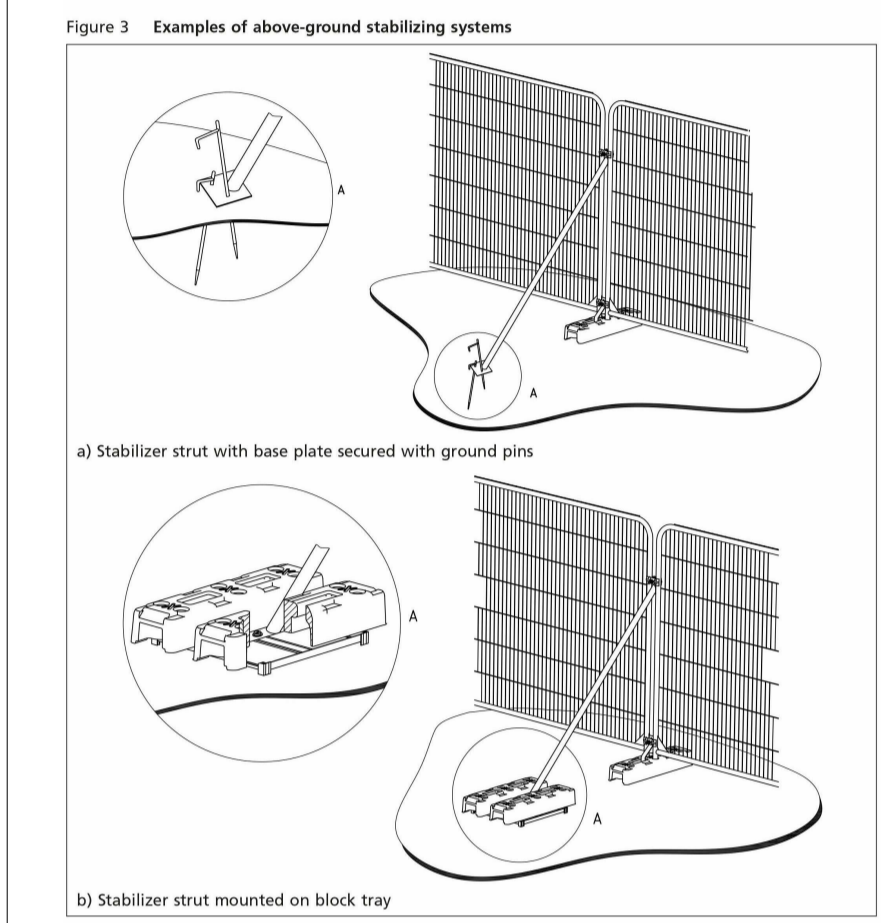

6.2.3 Ground protection during demolition and construction

6.2.3.1 Where construction working space or temporary construction access is justified within the RPA, this should be facilitated by a set-back in the alignment of the tree protection barrier. In such areas, suitable existing hard surfacing that is not proposed for re-use as part of the finished design should be retained to act as temporary ground protection during construction, rather than being removed during demolition. The suitability of such surfacing for this purpose should be evaluated by the project arboriculturist and an engineer as appropriate.

DRAWING TO BE PRINTED IN COLOUR

PL	CAD	25.01.2018	Planning Issue - Discharge of Conditions
S3	C30	06.09.2018	Trees to be removed and access added for retained substation
D3	C23	25.04.2018	Updated as per Contract Sum meeting with ISG 12.04.18
D3	C21	27.03.2018	CONSTRUCTION ISSUE
D3	P19	06.03.2018	Proposed low garden wall omitted from scheme as VE; approved by Client + Heritage officer
S3	P18	14.02.2018	Notes removed following LPA approval. BS fencing detail changed.
S3	P17	13.02.2018	Substation relocated. Kerb spec. changed.
S2	P14	22.01.2018	Tree protective fencing added
S3	P12	10.01.2017	Further trees removed as per Arboriculturists recommendations
D3	P09	14.12.2017	Additional trees removed subject to LPA approval
D2	P05	06.10.2017	TENDER ISSUE
S3	P03	15.09.2017	Planning conditions

STATUS	REV	DATE	DESCRIPTION	REVISED BY
CLIENT				GAM
				CHECKED BY
				RW
				ORIGINATOR NO
				150888

CONSULTANT
STRIDE TREGLOWN
www.stride-treglow.com © Stride Treglow Limited 2016

PROJECT
Hotel and Student Residential
Comet Hotel Site

DRAWING TITLE
Tree Protection, Retention and Retention and Removal plan

SUITABILITY STATUS
PL : PLANNING SCALE
1 : 250 @ A1

PROJECT | ORIGINATOR | ZONE | LEVEL | TYPE | ROLE | CLASSIFICATION | NUMBER | REVISION
COMET-STL-00-00-DR-L-ZZZZ-91010 C40

ASHBURY CLOSE