

STANDARD DOOR FRAME COMPONENTS (TO EXISTING WALL)
SCALE 1:2

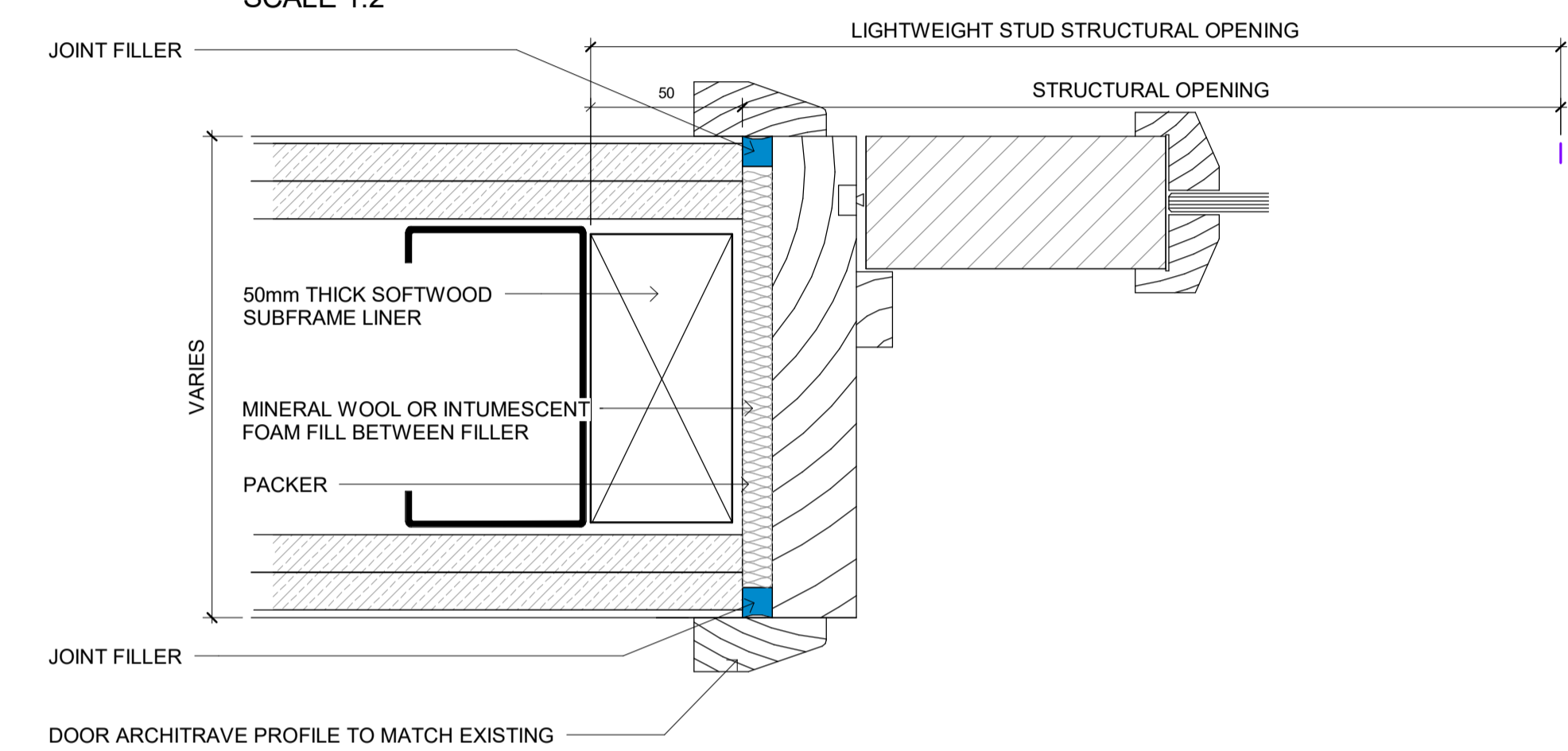

STANDARD DOOR FRAME COMPONENTS (TO LIGHTWEIGHT STUD WORK)
SCALE 1:2

NOTES

THIS DRAWING SHOWS DESIGN INTENT ONLY. REFER TO DOOR SUPPLIERS INFORMATION.

Information to be read in conjunction with the following drawings:
 • 71001 - Internal Door Schedule
 • 10040 - 10042 GA plans

Acoustic ratings to be in accordance with the Acoustic Engineers Acoustic Specification Report.

For ironmongery refer to suppliers schedule and specification. Supplier to provide sample panel - all ironmongery to be approved by client.

All final exit doors are to be provided with appropriate fire exit / panic hardware. Refer to ironmongery specification for details.

All internal door finishes subject to client approval

All overhead closers to Hotel Bedroom doors to be fitted to the bedroom face of the door.

To be coordinated with M&E Engineer access proposals.

W WIDTH OF GAP	PACKING REQUIRED	MINERAL WOOL/ FOAM	INTUMES- CENT JOINT FILLER	D DEPTH OF JOINT FILLER
0-5mm	✓			
6-12mm	✓	✓	✓	6mm
13-20mm	✓	✓	✓	10mm
21-30mm	✓	✓	✓	15mm

FIRE STOPPING TO DOOR FRAME

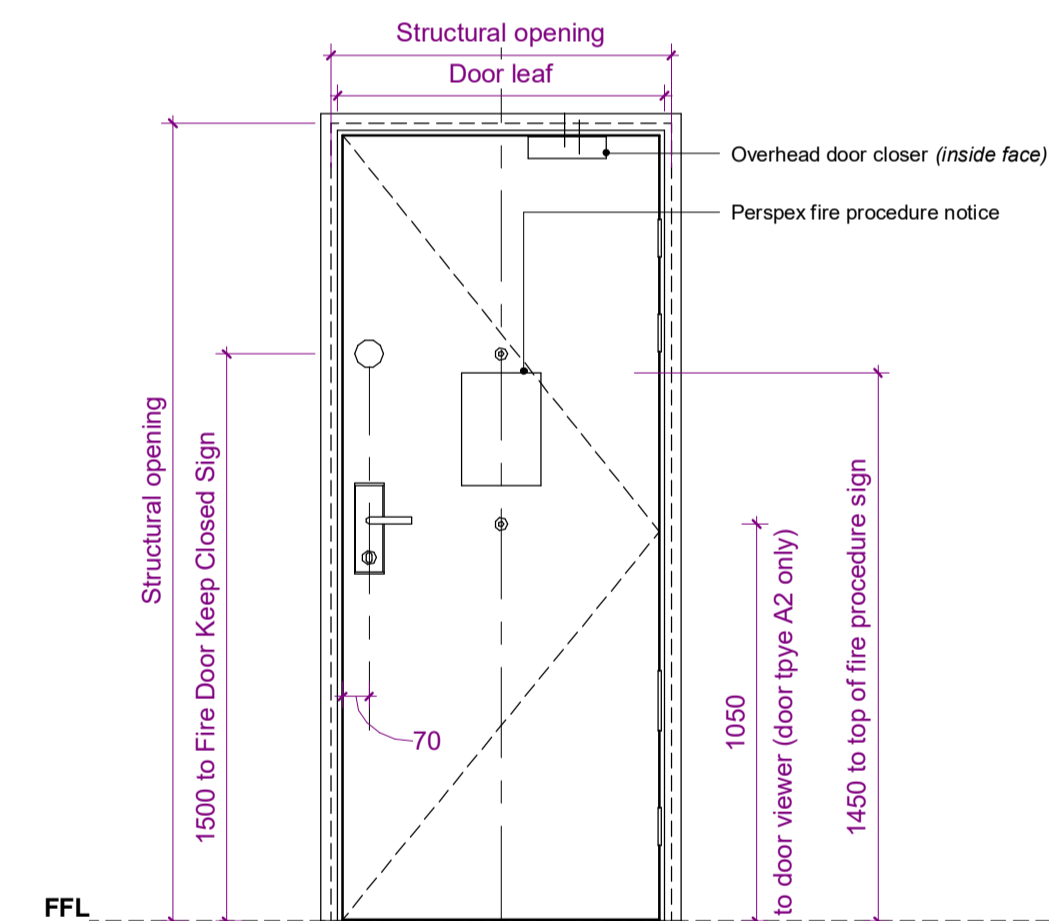

Type A1
Hotel Entrance door (from inside)
Scale 1:20

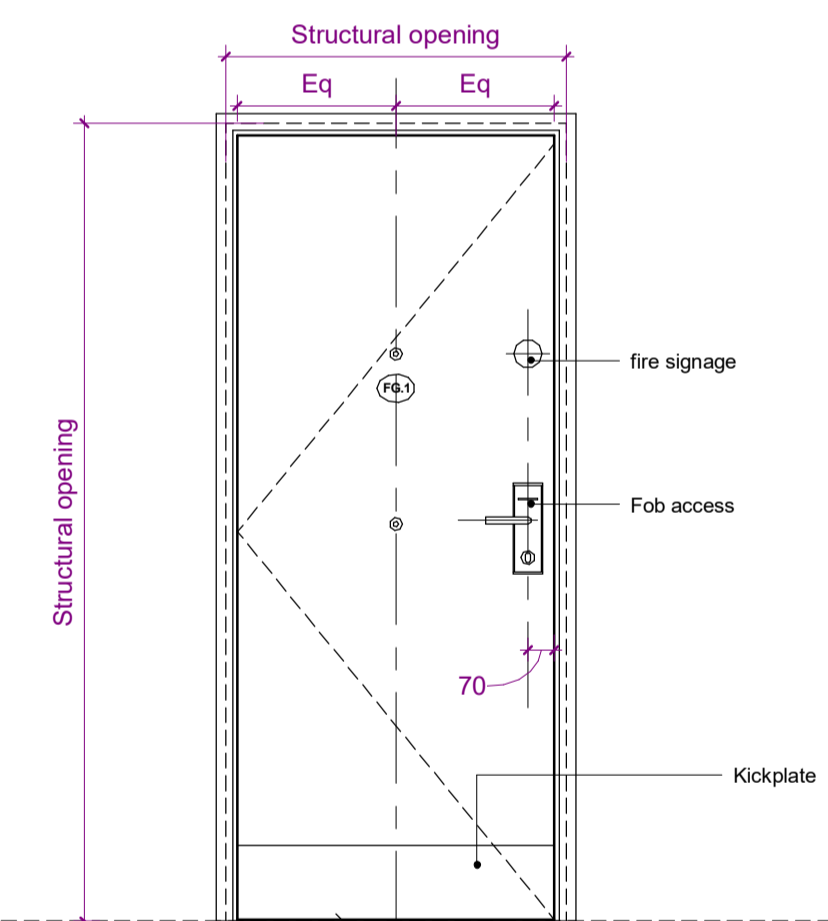

Type A1
Hotel entrance door (from outside)
Scale 1:20

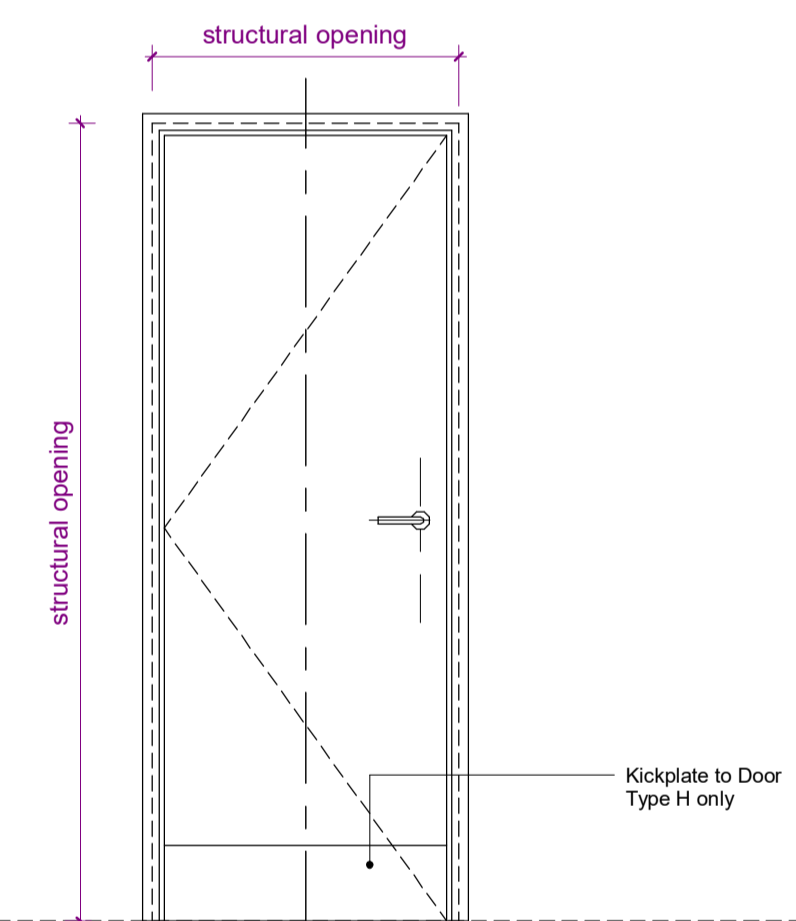

Type B / B1 / B2 / G / H
Bathroom Pod & Traditionally Built Hotel Bathrooms / Accessible Bathroom door / AWC / WC
Scale 1:20

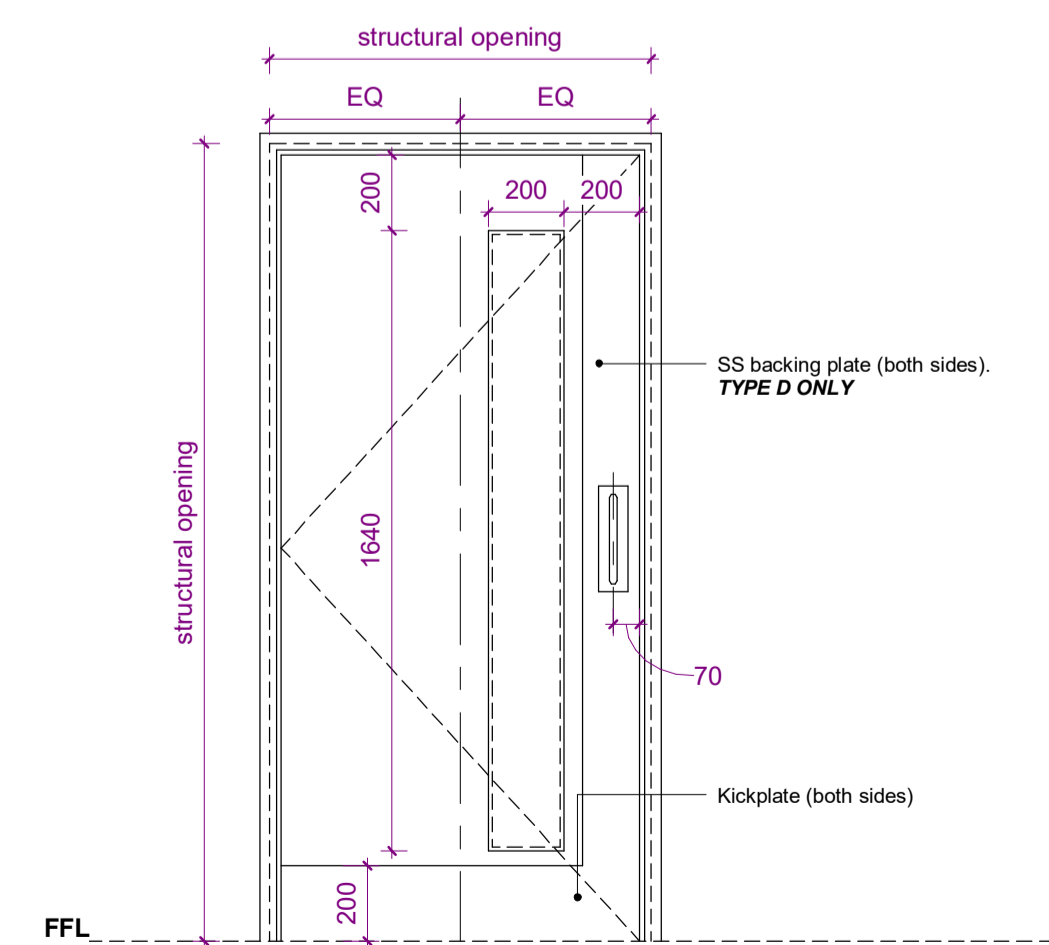

Type D1
Circulation & stair to hotel
Scale 1:20

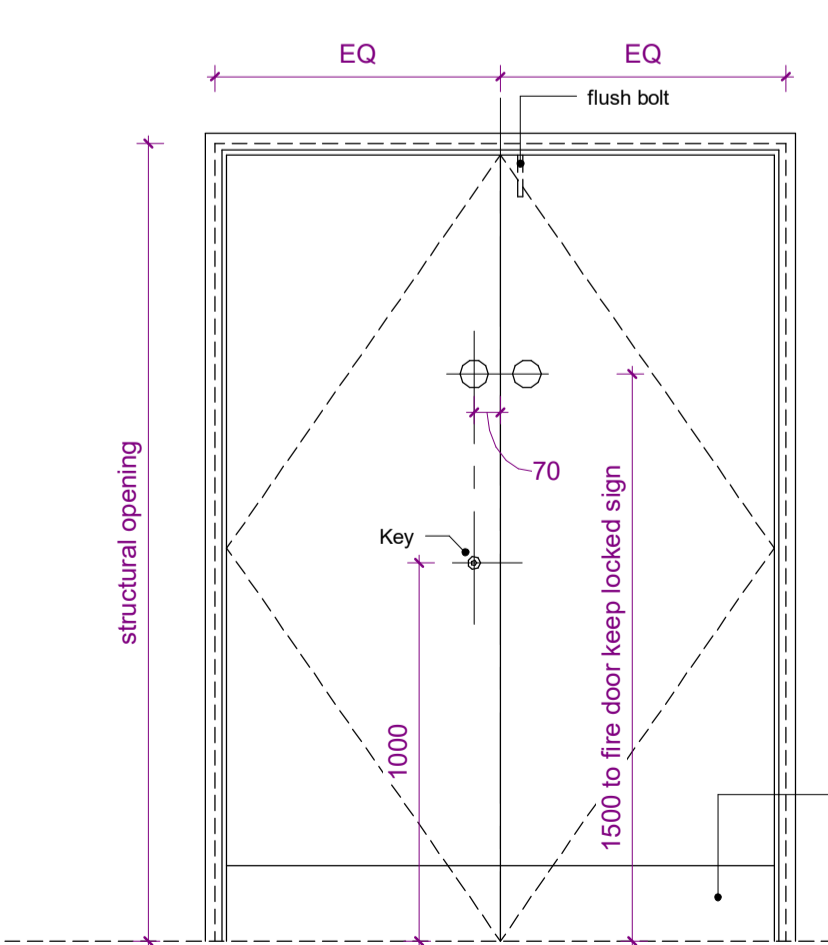

Type E1
Riser / Plant
Scale 1:20

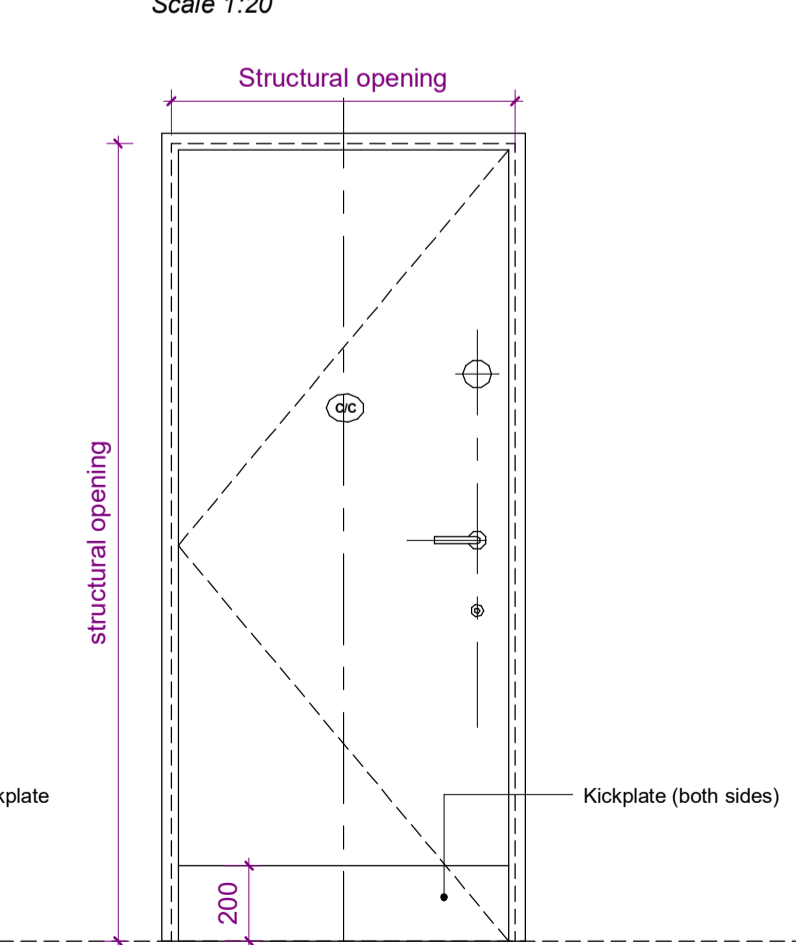

Type F1
Cleaners & store to hotel / Plant
Scale 1:20

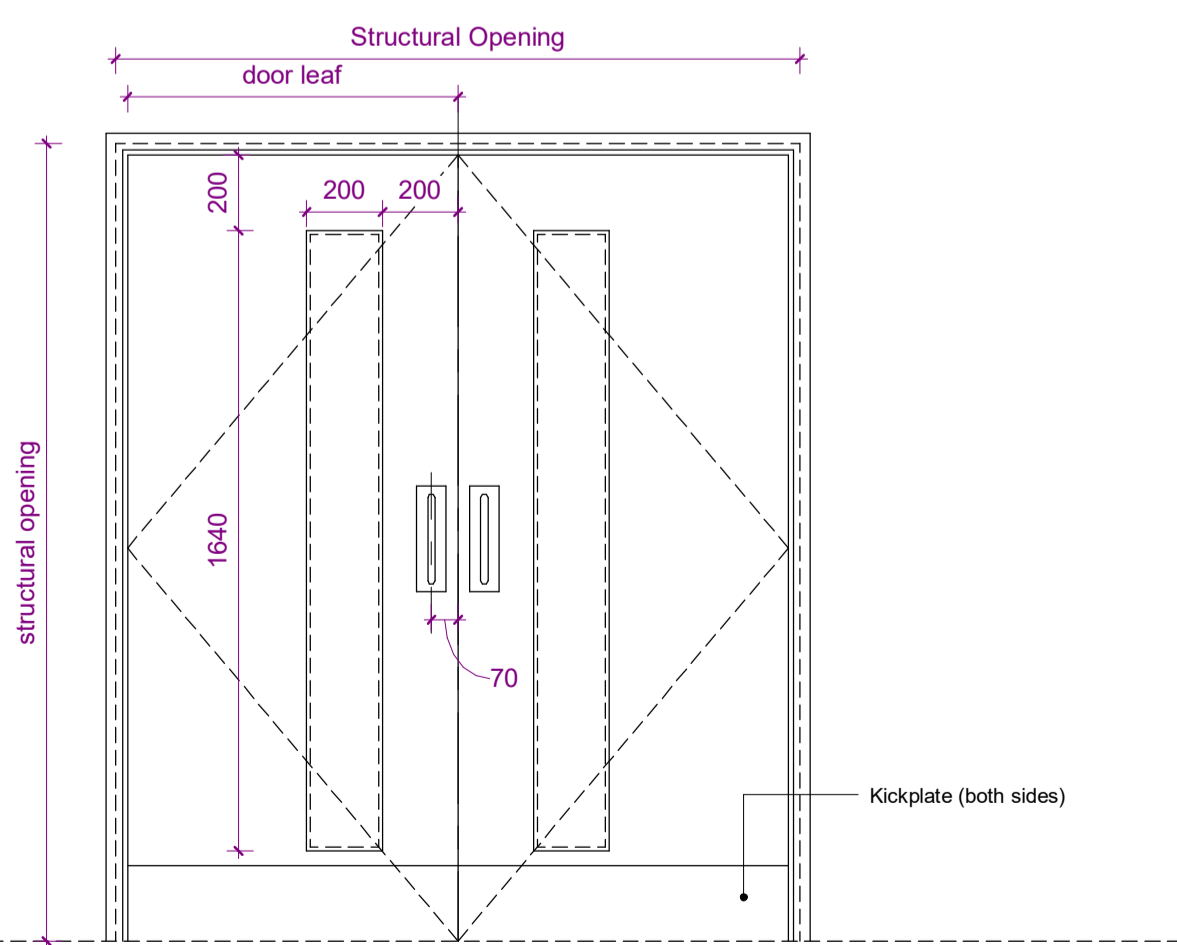

Type J1
Circulation Double to hotel
Scale 1:20

S2	C73	01.06.18	Listed Building Submission. Refer to revision clouds for amendments
----	-----	----------	---

STATUS	REV	DATE	DESCRIPTION	REVISED BY
				RW

CLIENT: Comet Hatfield Construction Limited

CHECKED BY: AMF

ORIGINATOR NO: 150888

CONSULTANT

STRIDE TREGLOWN

www.stride-treglow.com

PROJECT: Hotel and Student Residential Comet Hotel Site

DRAWING TITLE
Existing Hotel Door Types - Internal

SUITABILITY STATUS S2 : SUITABLE FOR INFORMATION	SCALE As indicated @ A1
PROJECT ORIGINATOR ZONE LEVEL TYPE ROLE CLASSIFICATION NUMBER COMET-STL-XX-ZZ-DR-A-ZZZZ-62004	REVISION C73