

Comet Hotel - Section AA - Ceiling heights
1 : 50

C190
Plenum upstand added, bar indicated and patrix above ceiling for stemware rods required

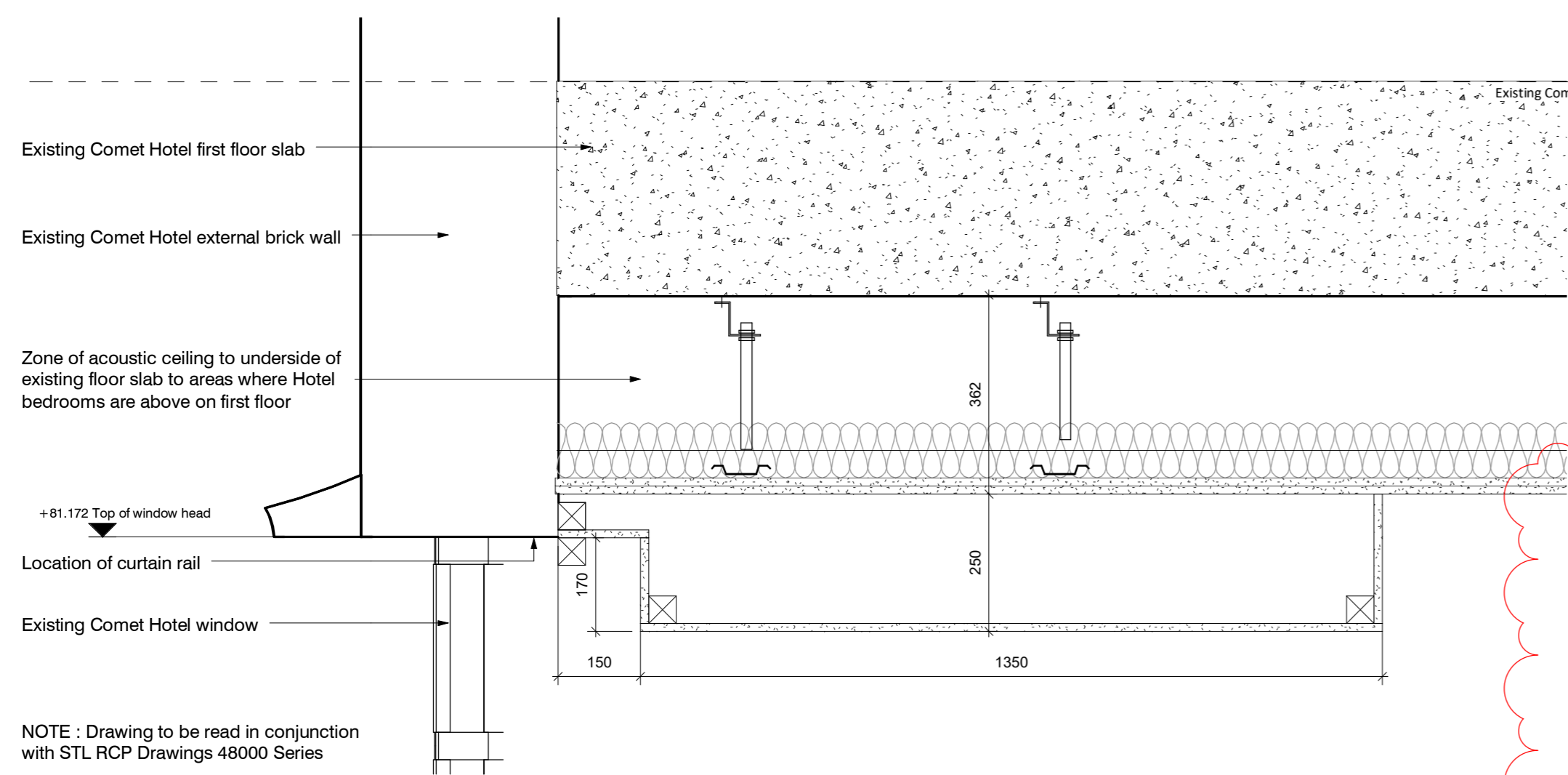
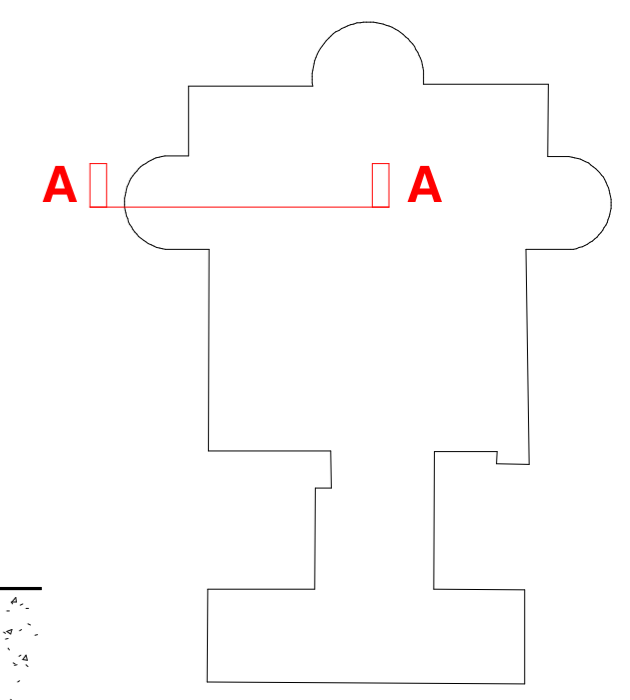

NOTE : Drawing to be read in conjunction with STL RCP Drawings 48000 Series

Comet Hotel - Section AA - Ceiling heights - Callout 1
1 : 10

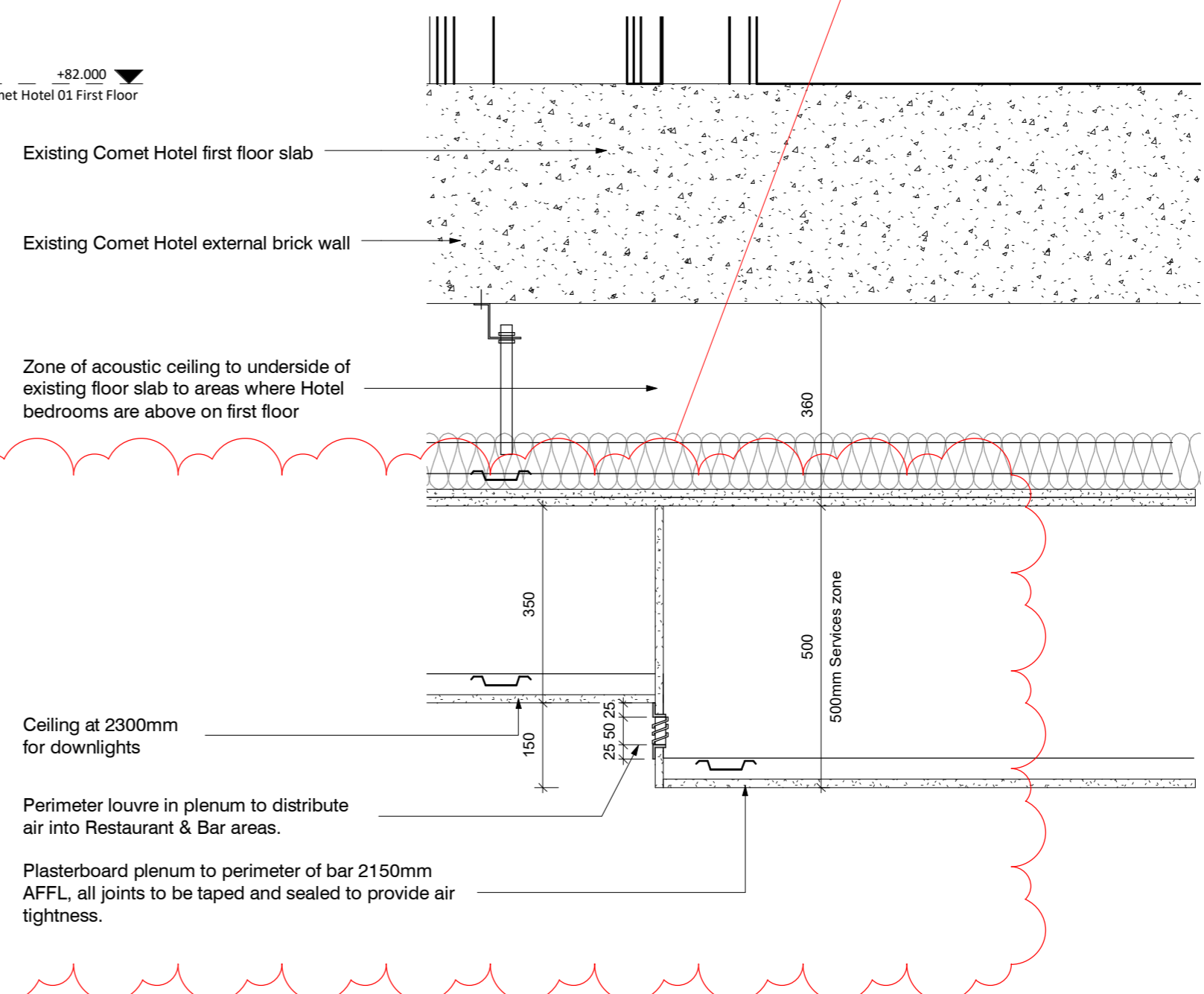

C190
Louvre to M&E details added to air tight plenum

Ceiling at 2300mm for downlights

Perimeter louvre in plenum to distribute air into Restaurant & Bar areas.

Plasterboard plenum to perimeter of bar 2150mm AFFL. all joints to be taped and sealed to provide air tightness.

Comet Hotel - Section AA - Ceiling heights Callout 2
1 : 10

STATUS	REV	DATE	DESCRIPTION	REVISION
D3	C190	12.04.19	Refer to revision clouds for details	RW
D3	C143	13.12.18	Refer to revision clouds for updates	AMF
D3	C128	02.11.18	First Issue	150888

CLIENT: Comet Hatfield Construction Limited
CONSULTANT: STRIDE TREGLOWN
PROJECT: Hotel and Student Residential Comet Hotel Site

DRAWING TITLE
Comet Hotel - Ceiling section

SUITABILITY STATUS	SCALE
D3 : SUITABLE FOR CONTRACTOR DESIGN	As indicated @ A2
PROJECT ORIGINATOR ZONE LEVEL TYPE ROLE CLASSIFICATION NUMBER	REVISION
COMET-STL-00-ZZ-DR-A-ZZZZ-33002	C190