

50, Plough Hill, Cuffley, Potters Bar, Hertfordshire, EN6 4DS

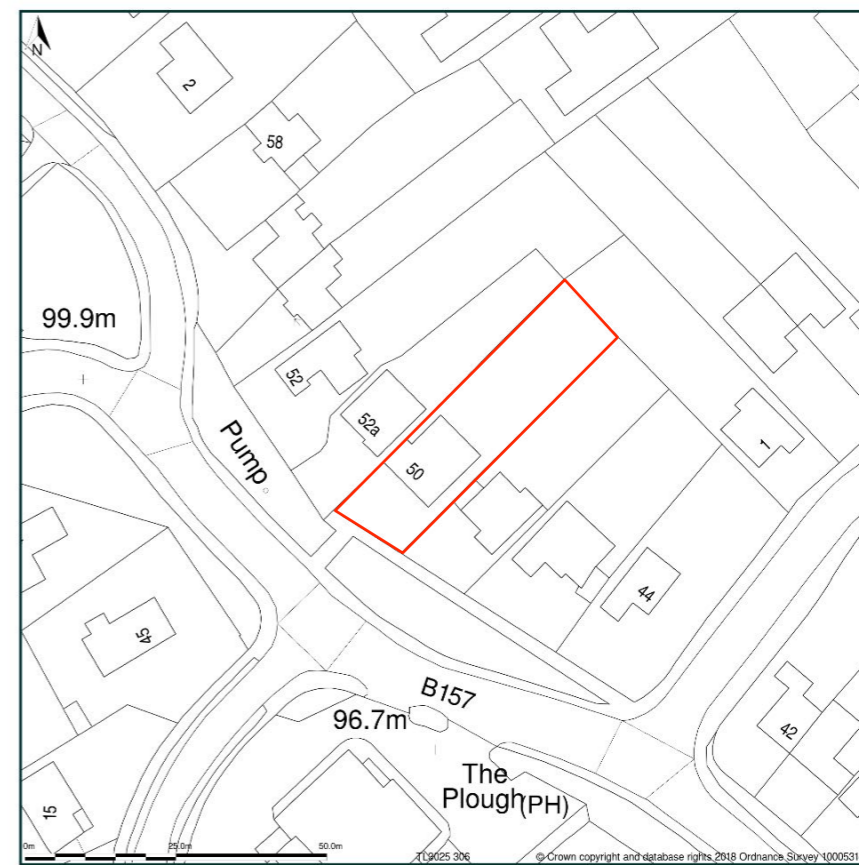
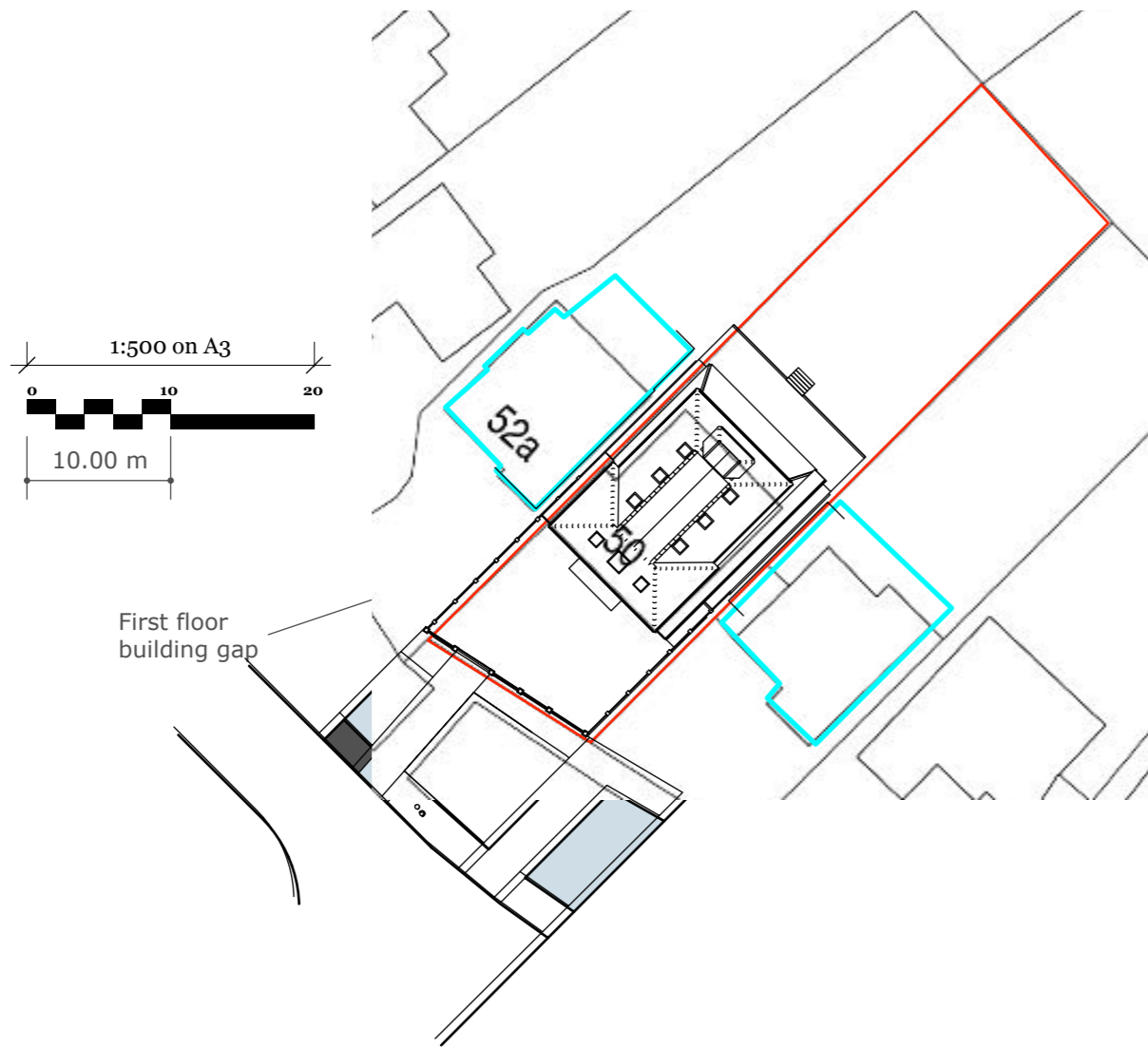

Site Plan shows area bounded by: 530182.24, 202995.26 530323.66, 203136.68 (at a scale of 1:1250), OSGridRef: TL3025 306. The representation of a road, track or path is no evidence of a right of way. The representation of features as lines is no evidence of a property boundary.

Produced on 19th Dec 2018 from the Ordnance Survey National Geographic Database and incorporating surveyed revision available at this date. Reproduction in whole or part is prohibited without the prior permission of Ordnance Survey. © Crown copyright 2018. Supplied by www.buyaplan.co.uk a licensed Ordnance Survey partner (100053143). Unique plan reference: #00379271-E45F3A

Ordnance Survey and the OS Symbol are registered trademarks of Ordnance Survey, the national mapping agency of Great Britain. Buy A Plan logo, pdf design and the www.buyaplan.co.uk website are Copyright © Pass Inc Ltd 2018

NOTE:-

**This PROPOSAL is for Variation of condition 2 (change drawings 760-r(rev1)- 2,3 and 4) (replace with drawings 760-s- 2,3 and 4)**

This follows the approved plans:-

- 6/2019/2591/HOUSE
- 6/2021/1144/VAR (approved 10th June 2021)
- Variation to condition 3

Development: Erection of a ground floor side/rear and first floor extension, including the construction of a rear dormer and installation of roof lights to facilitate the creation of habitable space within the loft and erection of front boundary wall and gates