

SEE HARD LANDSCAPING MATERIALS DRAWING 664 / L(O)31
 SEE PROPOSED LANDSCAPING DRAWINGS 554-01A < 02 FOR SOFT LANDSCAPING DETAILS
SITE AREA WITHIN THIS SITE BOUNDARY = 6.50 ACRES (2.6305 HECTARES)

WELWYN HATFIELD PLANNING OFFICE COPY
 - 3 JAN 2007
 No: ~~56/2007/0006/Fp~~

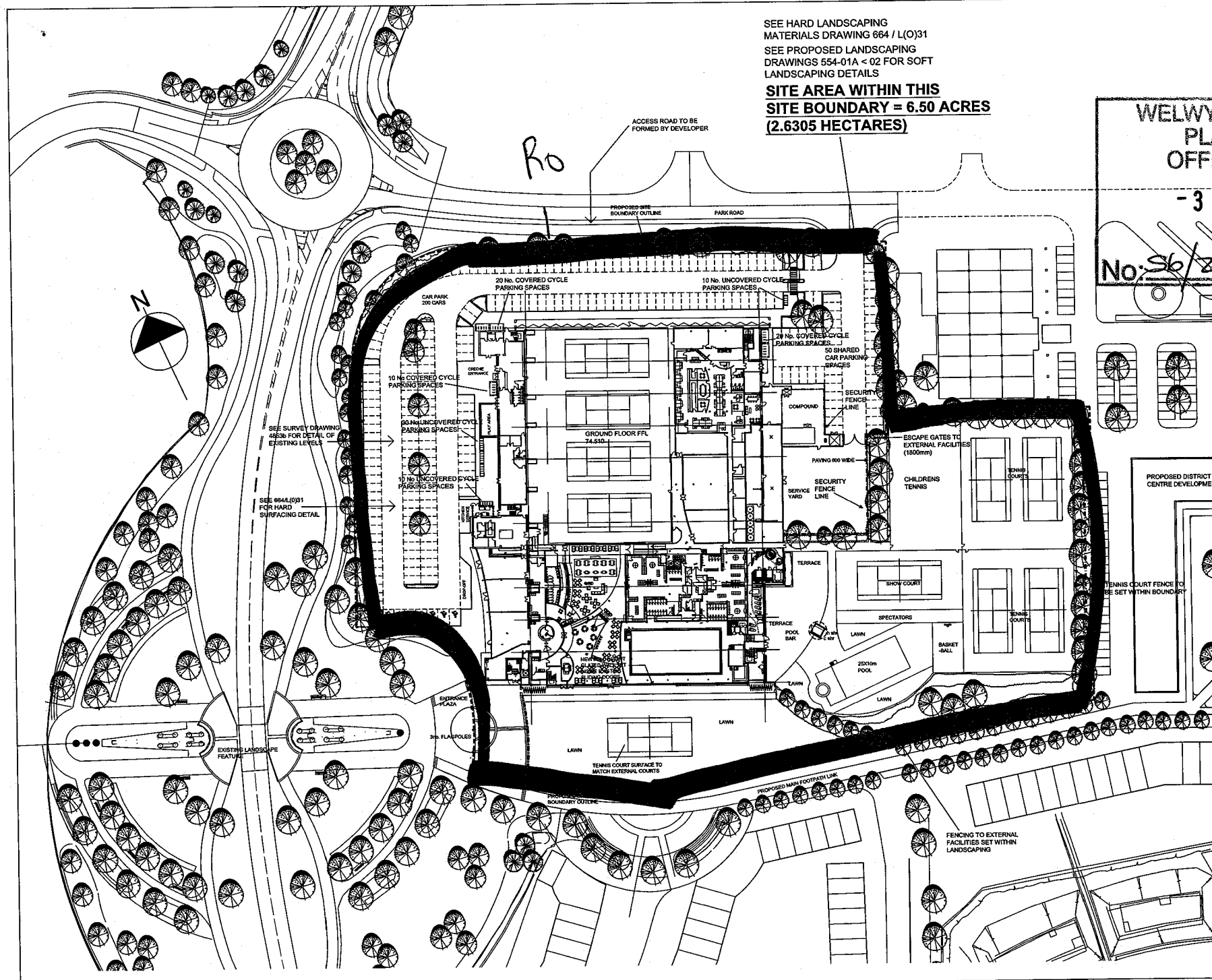

Rev	Details	Author	Checked	Date
L	AS BUILT	SR		11.11.04
K	BASE PLAN UPDATES, FENCE LINES UPDATED	DNA		08.11.04
J	SERVICE YARD COMPOUND AMENDED AS BUILT CYCLE PARKING/ ESCAPE GATES AMENDED	SR		10.09.04
I	SERVICE YARD COMPOUND AMENDED AS BUILT CYCLE PARKING AMENDED	SR		06.08.04
H	BIKEWAY SIGNAGE AMENDED, PATH ADDED TO SHOWY ARMY AREA PARKING AMENDED TO SET PLAY AREA REDUCED, ONE PARK ENTRANCE BARRIERS AMENDED TO SUIT DETAILS, SERVICE YARD GATES OPEN OUT YARDWAY AMENDED TO SUIT LEVIES PAVED AREA ADDED TO SOUTH SHOW COURT	DNA		15-07-04
G	FENCING LINE TO SOUTHERN SIDE OF INWATER AMENDED, ESCAPE GATES AMENDED, TENNIS FENCE AMENDED	SR		20.02.04
F	ACCESS GATES ADDED TO EXTERNAL FACILITIES AND GROUND PLAY AREAS	WOS		02.02.04
E	COURTS / NOTES AMENDED	SR		10.12.03
D	CYCLE PARKING LOCATIONS AMENDED UNLANSKING ADDED TO SUIT	WOS		20.11.03
C	SECURITY FENCING LINE AMENDED TRIP RAIL OMITTED ADJACENT FOOTPATH	WOS		06.08.03
B	NOTE AMENDED TO SHOW COURT SHOWERS ADDED TO OUTDOOR POOL	WOS		06.04.03
A	BEACH VALLEY BALL AREA OMITTED BASKETBALL PROPOSED, FENCE EXTENDED	WOS		29.10.02

A Revisions

© The drawing is copyright and shall not be reproduced without the written consent of the author.
 If any further alterations should be required on this site, do not scale from this drawing.
 Limbrick Limited is a member of the Institution of Structural Engineers (IStructE) and is registered with the Engineering Council as a Chartered Engineering Institution (CEI) on 1 May 2003.

NEXT GENERATION CLUBS TENNIS AND RACQUET CENTRE HATFIELD

SITE PLAN LAYOUT

AS BUILT

Scale	1:500	Proj. No.	664	Rev.	L
Date	26.09.02	Dwg. No.	L(0)004		
Drawn	MDS	Checked			



LIMBRICK LIMITED
 CHEDWORTH HOUSE - FALCON CLOSE - BRISTOL ROAD
 QUEENSBURY - GLOUCESTER - GL2 4LY
 TEL: 01452 880200 - FAX: 01452 880201

Mosquito way



Next Generation Clubs
Hatfield Business Park
Hatfield
Herts
AL10 9AX

Tel: +44 (0)1707 283500
Fax: +44 (0)1707 283501
Email: enquiries@ngclubs.co.uk

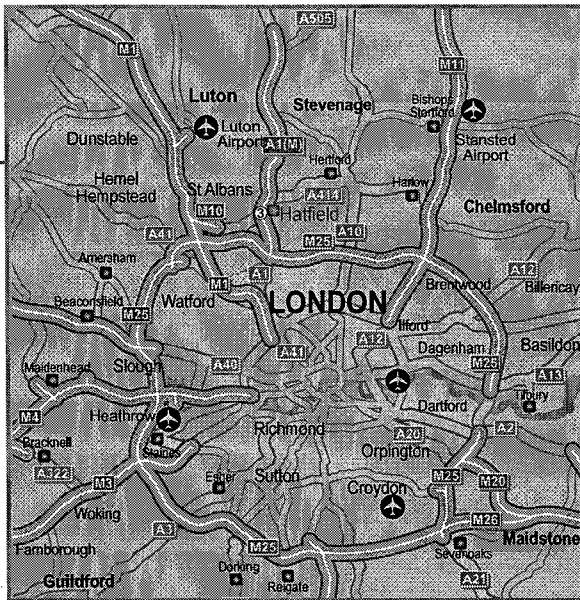

Transport Information



From the North:

Follow the A1 and A1(M) Southbound and exit at junction 4. At the roundabout, take the third exit onto the A1001 (Comet Way). At the first roundabout take the fourth exit onto Hatfield Avenue. At the next roundabout take the first exit into Hatfield Business Park.



From the South:

Follow the A1 and A1(M) Northbound and exit at junction 3. At the roundabout take the second exit onto the A1001 (Comet Way). At the first roundabout take the first exit onto the A1057. At the next roundabout take the third exit into Hatfield Business Park.



By Train:

Hatfield Station is approximately 1 mile away.



By Air:

Luton Airport is approximately 10 miles away.

