

IMPORTANT NOTES
 Do not scale from this drawing.
 Verify all dimensions, levels and details on site.
 If in doubt, ask before action.

COPYRIGHT ©
 This drawing is copyright and may not be altered, reproduced or used other than for the contract for which it is issued without the written permission of Hickton Madeley Architects Ltd.

STATUS OF DRAWING
 This drawing can only be used for its intended purpose as per indicated status.

RELATED DOCUMENTS
 Read this drawing in conjunction with the appropriate specification(s) and other consultants drawings and specifications.

ELECTRONIC ISSUE
 When this drawing is issued via e-mail or disc, it must be considered to be for information only. Hickton Madeley Architects Ltd accepts no responsibility for the use of this file. The files issued by Hickton Madeley Architects Ltd are subject to copyright ©.

MECHANICAL AND ELECTRICAL
 Mechanical and Electrical items are indicative only. For detailed layouts, please refer to Engineers Drawings.

- Fence key**
- Knee rail fence
 - 1.8m high larch lap fencing
 - 1.8m high close board fencing
 - 1.8m high screen wall
 - 900mm high railings
- Planting key**
- ⊕ Proposed trees
 - Proposed planting

Rev	Description	Date	By	Chk

Ashley House
 Euston Way
 Telford
 TF3 4LT

T: 01952 200002
 F: 01952 209700
 studio@hmarchitects.co.uk
 www.hmarchitects.co.uk

Client
Bovis Homes Central Region

Project Title
Salisbury Village Hatfield

Drawing Title
Site Layout (Fence key Plan)

Scale	Date	Drawn	Checked
1/500 @ A1	MARCH 2007	DW	
Drawing Number	Revision		
HAT 4 / 001			

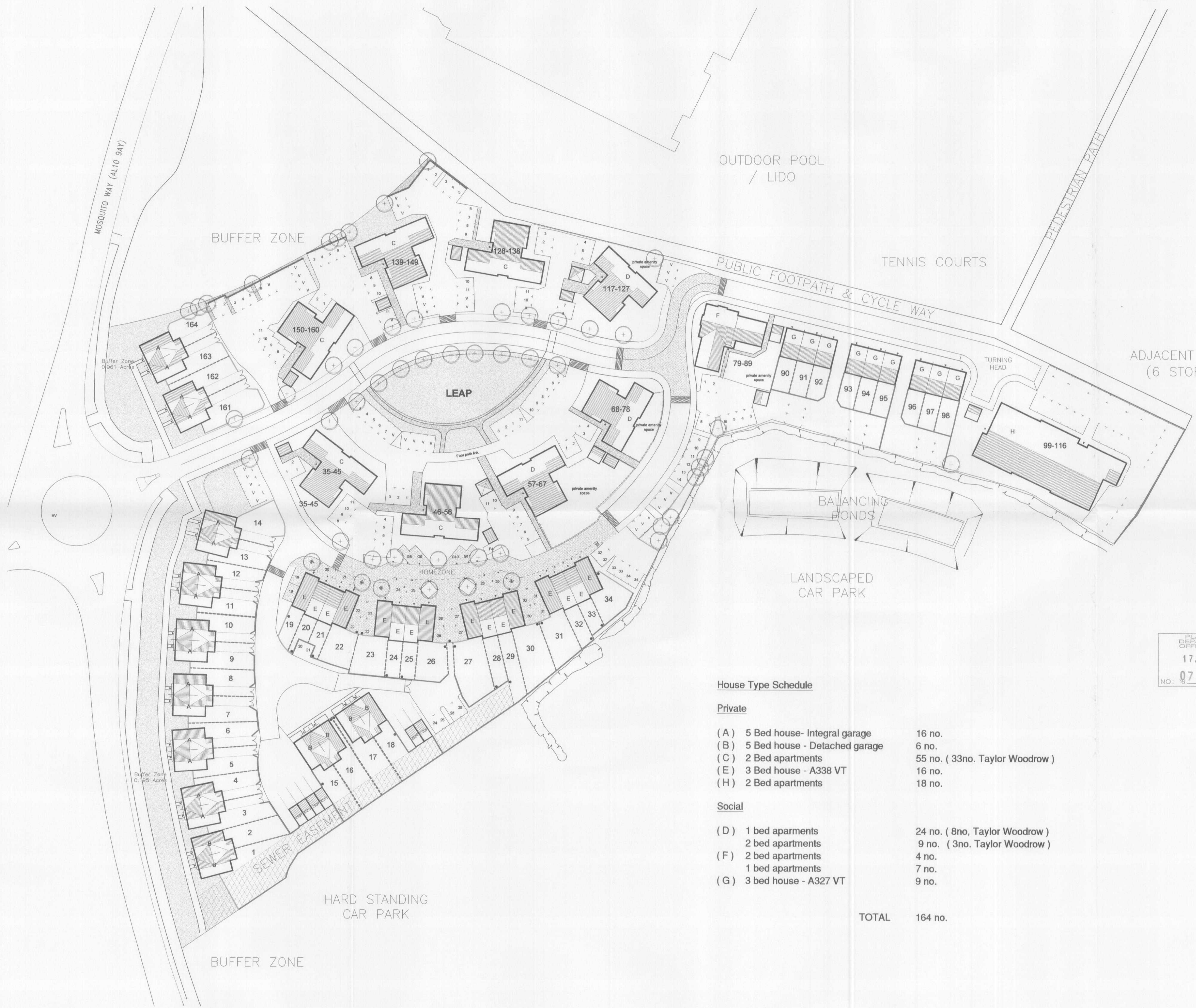

House Type Schedule

Private

(A) 5 Bed house- Integral garage	16 no.
(B) 5 Bed house - Detached garage	6 no.
(C) 2 Bed apartments	55 no. (33no. Taylor Woodrow)
(E) 3 Bed house - A338 VT	16 no.
(H) 2 Bed apartments	18 no.

Social

(D) 1 bed aparments	24 no. (8no, Taylor Woodrow)
2 bed apartments	9 no. (3no. Taylor Woodrow)
(F) 2 bed apartments	4 no.
1 bed apartments	7 no.
(G) 3 bed house - A327 VT	9 no.

TOTAL 164 no.

PLANNING DEPARTMENT OFFICE COPY
 17 APR 2007
 NO: 07/0611-