

Bishop's Square

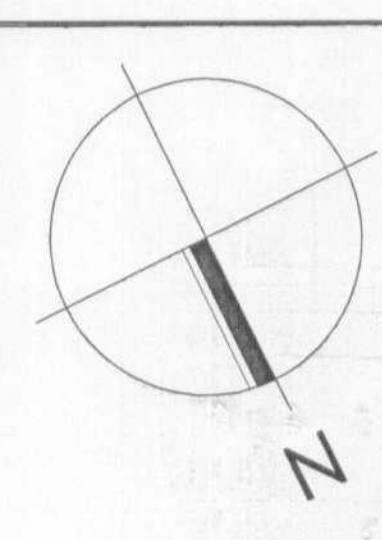
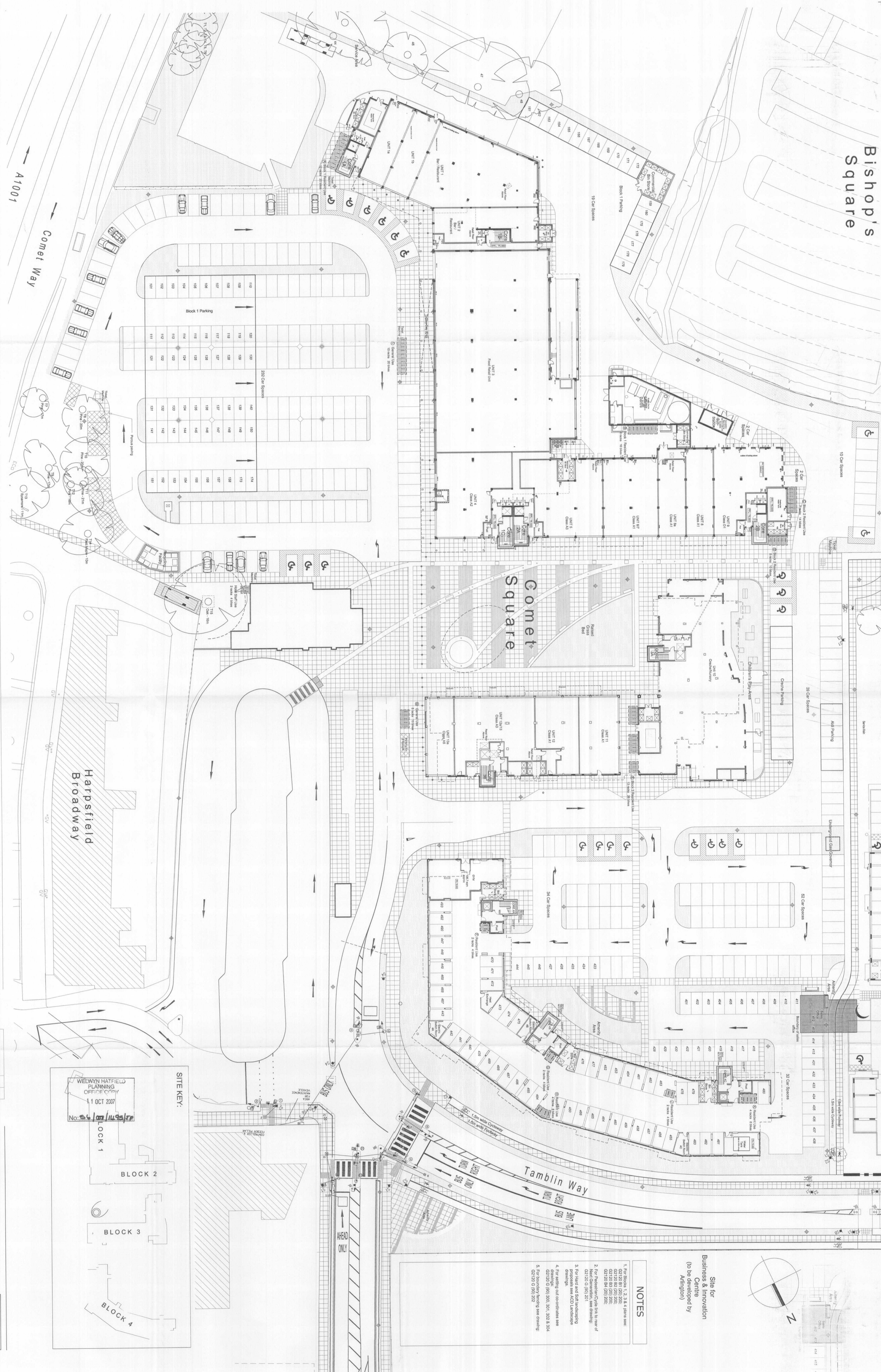

Site for
Business & Innovation
Centre
(to be developed by
Arlington)

NOTES

1. For Blocks 1, 2, 3 & 4 please see:
G2120 G (05) 200;
G2120 G (05) 201;
G2120 G (05) 202;
G2120 G (05) 203;
G2120 G (05) 204;
G2120 G (05) 205;
2. For Furniture/Ordering see to rear of drawing.
3. For Hard and Soft Landscaping proposals see ACD Landscaping drawings.
4. For setting out co-ordinates see G2120 G (05) 200, 201, 202 & 204.
5. For boundary setting see drawings G2120 G (05) 202.

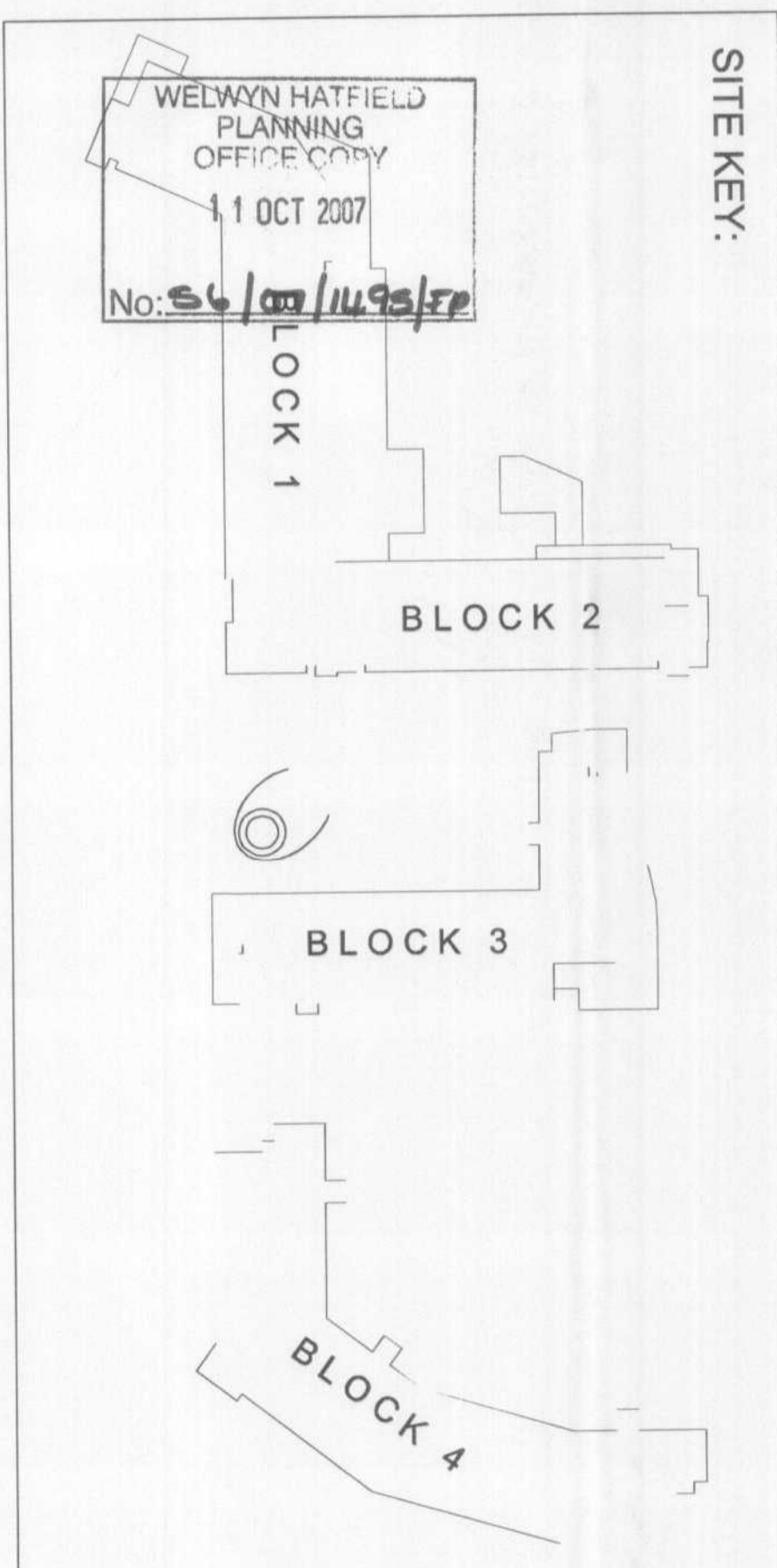

WELMAY HATFIELD
PLANNING
OFFICE
1 OCT 2007
No. 10/07/07

Key	Description
⊕	Street Lighting Columns
⊕	Bollards
⊕	Landscaped areas. For details refer to Landscape Architects drawings

Rev.	Description
1	PRELIMINARY DESIGN
2	TENDER
3	CONSTRUCTION

powelljobson
ARCHITECTS

Contract: Barnett North London
Cornel Square Phase II, Hatfield
Commercial Unit Class Uses

Drawing No. G2120 G (05) 200
Scale: 1:250 @ A0
Date: June 07
Drawn: [Signature]
Checked: DL