



TITLE NUMBER  
**HD434493**



**HERTFORDSHIRE : WELWYN HATFIELD**

ORDNANCE SURVEY MAP REFERENCE:

TL2110SE

SCALE 1:1250 Enlarged from 1/2500

©CROWN COPYRIGHT. Produced by HMLR. Further reproduction in whole or in part is prohibited without the prior written permission of Ordnance Survey. Licence Number GD 272728.

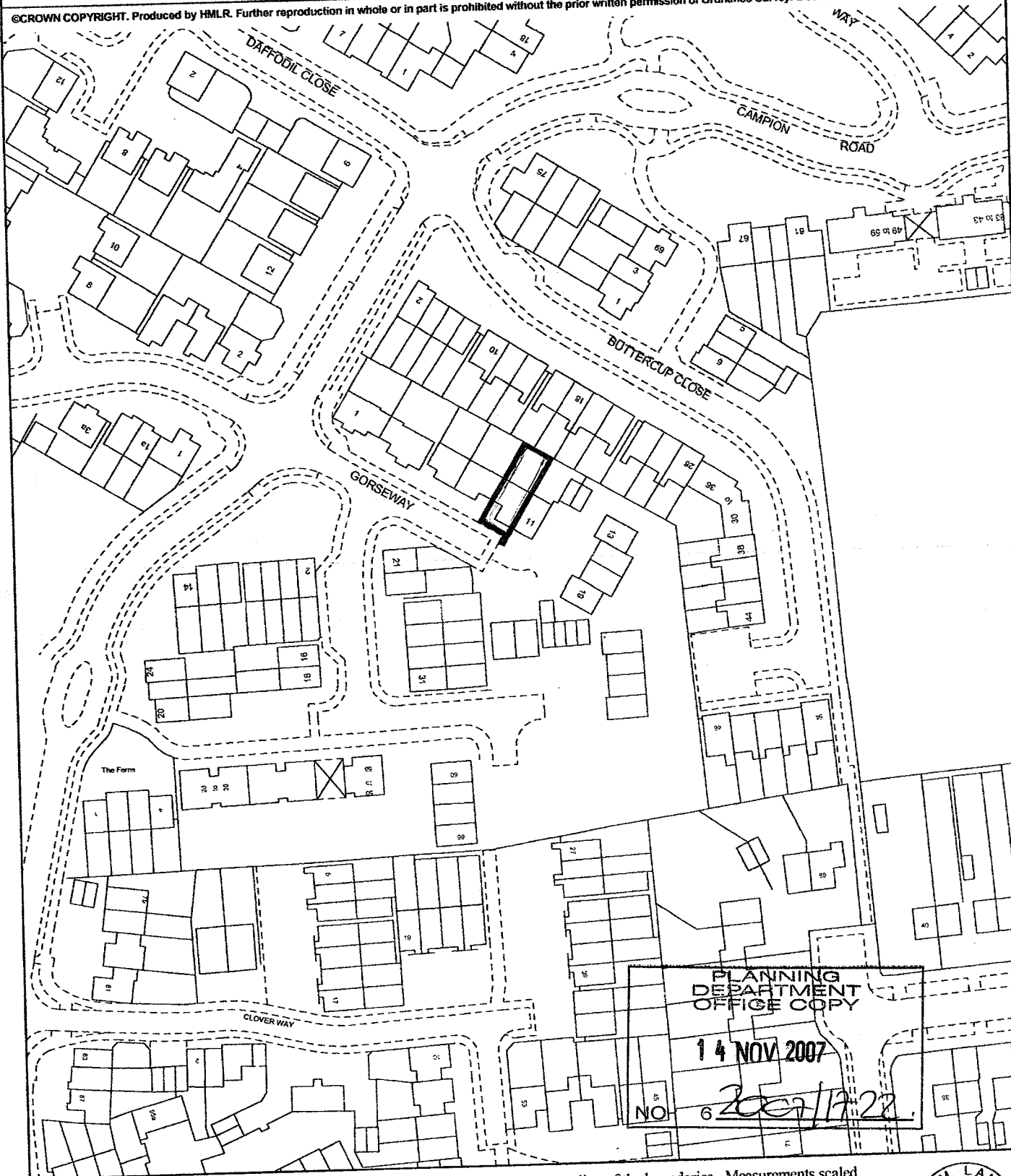

This title plan shows the general position of the boundaries: it does not show the exact line of the boundaries. Measurements scaled from this plan may not match measurements between the same points on the ground. For more information see Land Registry Public Guide 7 - Title Plans.

This official copy shows the state of the title plan on 27 October 2004 at 14:26:22. It may be subject to distortions in scale. Under s.67 of the Land Registration Act 2002, this copy is admissible in evidence to the same extent as the original. Issued on 27 October 2004.

This title is dealt with by the Stevenage District Land Registry.



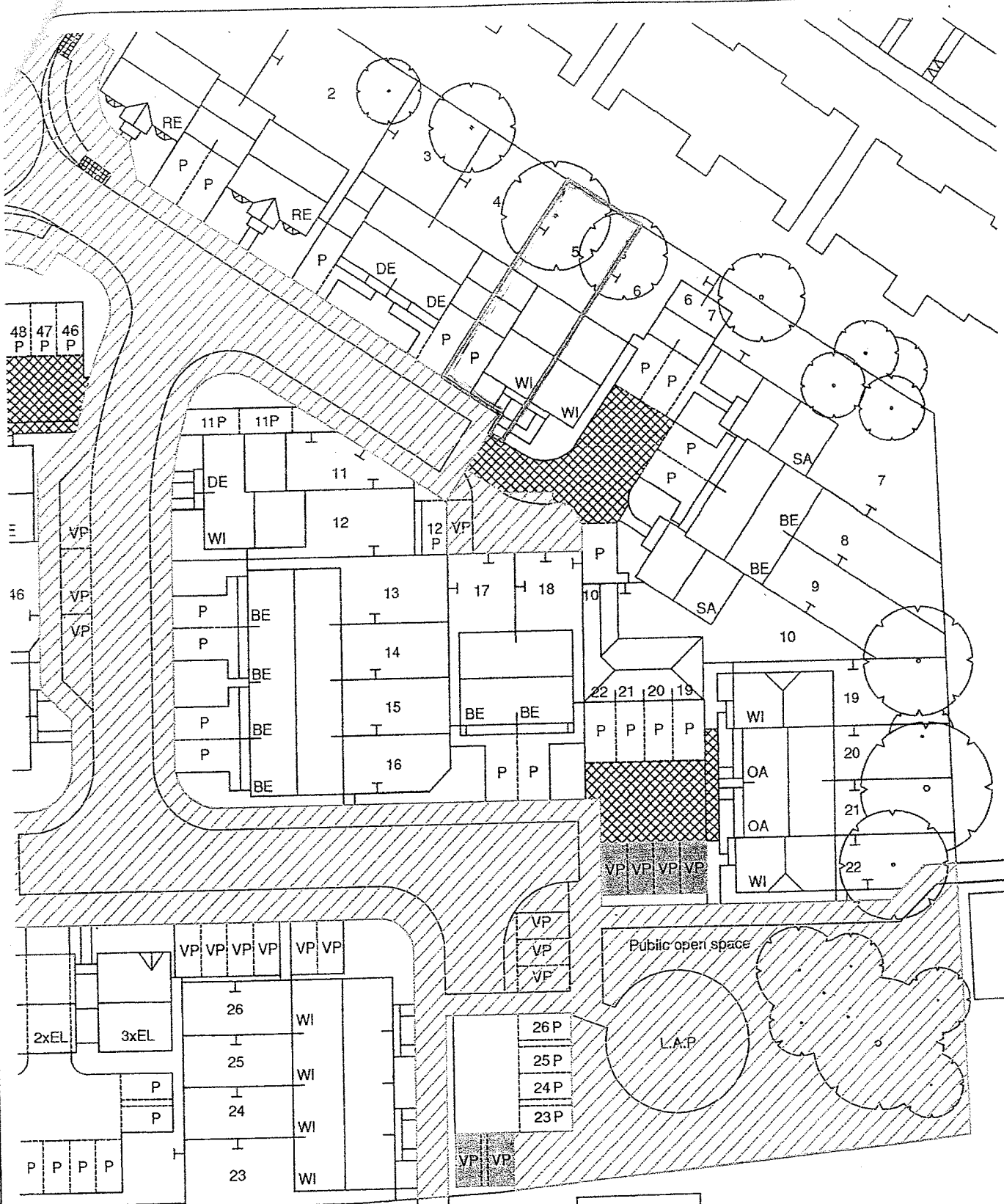





**THE PAVILLIONS  
HATFIELD**

PLANT  
DEPART  
OFFICE

14 NOV 1977

NO: 6 200A/1722

**Plot Transfer Plan**

-  L.A.P. Local Area of Play
-  SHARED ACCESS
-  SOCIAL HOUSING
-  BOUNDARY OWNERSHIP
-  VISITOR PARKING

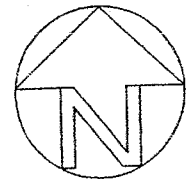

1:500

or the authority so  
y the Secretary of

1:1250

© T1

TPO 249

T8

PLANNING  
DEPARTMENT  
OFFICE COPY

14 NOV 2001

Name LIZA WREN

NO: 6 200A/1722

Title  
LAND AT GREAT BRAITCH LANE



WELWYN  
HATFIELD  
COUNCIL

Date 29th January 2002

Department

Produced from the  
© Crown Copyright