

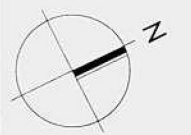



Dispos Square



Site for Business & Innovation Centre (to be developed by Arlington)

NOTES

1. For Blocks 1, 2, 3 & 4 plans see: G2120 B1 (20) 200; G2120 B2 (20) 200; G2120 B3 (20) 200; G2120 B4 (20) 200.
2. For Pedestrian/Cycle links to rear of Heat Generation, see drawing: G2120 G (90) 201.
3. For Hard and Soft landscaping proposals see ACD Landscape drawings.
4. For setting out co-ordinates see drawings: G2120 G (90) 300, 301, 302 & 304.
5. For boundary fencing see drawing: G2120 G (90) 202.

Comet Square

MELWYN HATEFIELD PLANNING OFFICE COPY

12 DEC 2007

No: 06/2004/1906/AD

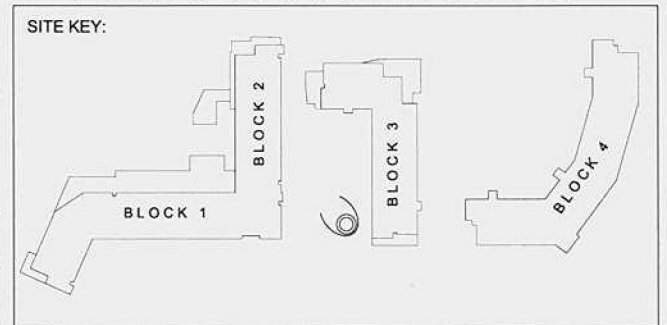

PRELIMINARY

powell d obson ARCHITECTS

Drawing No. Rev. G2120 G (90) 200 K

Contract: Barratt North London Comet Square Phase II, Hatfield Ground Floor Site Plan

PRELIMINARY	
DESIGN	
TENDER	
CONSTRUCTION	Approved

- Key
- Street Lighting Columns
  - Bollards
  - Landscaped areas. For details refer to Landscape Architects drawings

This drawing must not be scaled. Figured dimensions and levels to be used. Any inaccuracies must be notified to the architect. Detail drawings and large scale drawings take precedence over smaller drawings.		<p>Revisions:</p> <p>A 19.08.05 AF Barratta boundary clarified. Proposed hotel and family pits deleted for clarity. Drawing number revised. Barratta site access added.</p> <p>B 06.09.05 AF Bin store layout adjacent Unit 1 and sub-station location revised as requested by Barratta and instructed by BNL. All Delivery ramp length reduced as shown on JWP drawings.</p> <p>C 11.10.05 AF Site Boundary revised to include turning head at rear of Unit One. Ticket Machine adjacent hotel entrance moved to be clearly inside BNL site. Main road (Tamblin Way) layout revised to BSW construction drawings.</p>		<p>D 14.10.05 AF Energy Centre plan added.</p> <p>E 16.02.06 AF Block Plans generally updated: see respective floor plans. Notes added: North Point added. ISSUED TO PLANNING (see letter of 10th Feb 2006).</p> <p>F 31.01.06 CHT Private car parking numbers as agreed with Barratta added, cycle racks added (8ft to be agreed). Locations of disabled bays revised. Car parking still to be agreed with planner.</p> <p>G 03.04.06 CHT Cycle parking revised to show previous scheme.</p> <p>H 16.04.06 CHT Cycle parking added, see e-mail from planner 18.04.06. Car parking numbers amended.</p> <p>J 24.04.06 AF Car park ticket machine added outside adjacent cycle parking outside. Add store - as contract drawings.</p>		<p>K 11.07.06 CHT Amenity area adjacent to Core 2B amended as agreed with planner.</p>	
--	--	--	--	--	--	--	--

THIS DRAWING IS COPYRIGHT