

LONGCROFT LANE
FOUR SITE
REVISED PARKING 2 7 74

STANBOROUGH ROAD

ROOKS HILL

LONGCROFT LANE



Site boundary

Existing trees

Amenity Space

12 spaces - 2 lanes (wider than approved plan)

130m²
8-24

155m²
13-18



35-38
187m²
120m

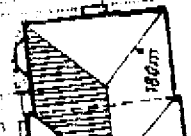

29-34
150m²
180m



25-28
180m²
120m

site boundary

new visitor spaces

Approved Plan

120m

180m

120m

180m

120m

180m

120m

180m

120m

180m

120m

180m

120m

180m

120m

180m

120m

180m

120m

180m

120m

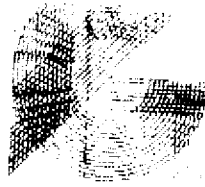

**VINCENT AND GORBING
ASSOCIATES**

CHARTERED ARCHITECTS AND TOWN PLANNERS

FACSIMILE TRANSMISSION

**IF YOU DO NOT RECEIVE ALL THE PAGES, OR IF ANYTHING
IS UNCLEAR, PLEASE TELEPHONE IMMEDIATELY**

TO : CHRIS WOOD, PLANNING DEPT.
WELDON TRAFFIC DISTRICT COUNCIL

FAX NO : 0707 391537

FROM : ~~SEPP~~ WOOD
LONGPORT LANE
W.C.C. PROJECT NO 8065

PAGES : 2

DATE : 2.3.94 14-40

MESSAGE

Further to today's telephone conversation we have prepared a third modified layout relating the chevron layout reworking to 90° format, gaining additional space by utilizing land on the flank of plots 25-28.

We look forward to receiving your comments on the enclosed layout.

Sepp Wood