

All dimensions must be verified before any work is put in hand and any discrepancies must be reported to Ladbrokes H.O. Property Development immediately. Where any variations occur between small scale and detailed drawings the detailed drawing should take precedence. Copyright of this drawing is reserved by Ladbrokes Plc and issued on condition that it is not copied or disclosed to any third party either wholly or in part without the consent of Ladbrokes Plc in writing.

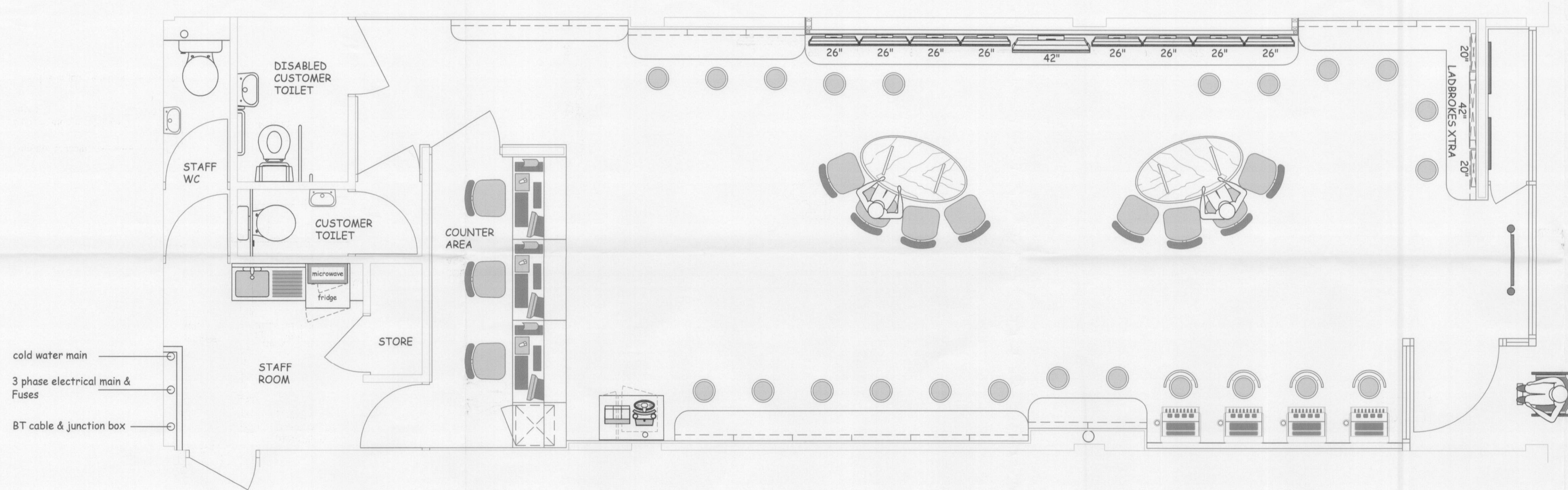
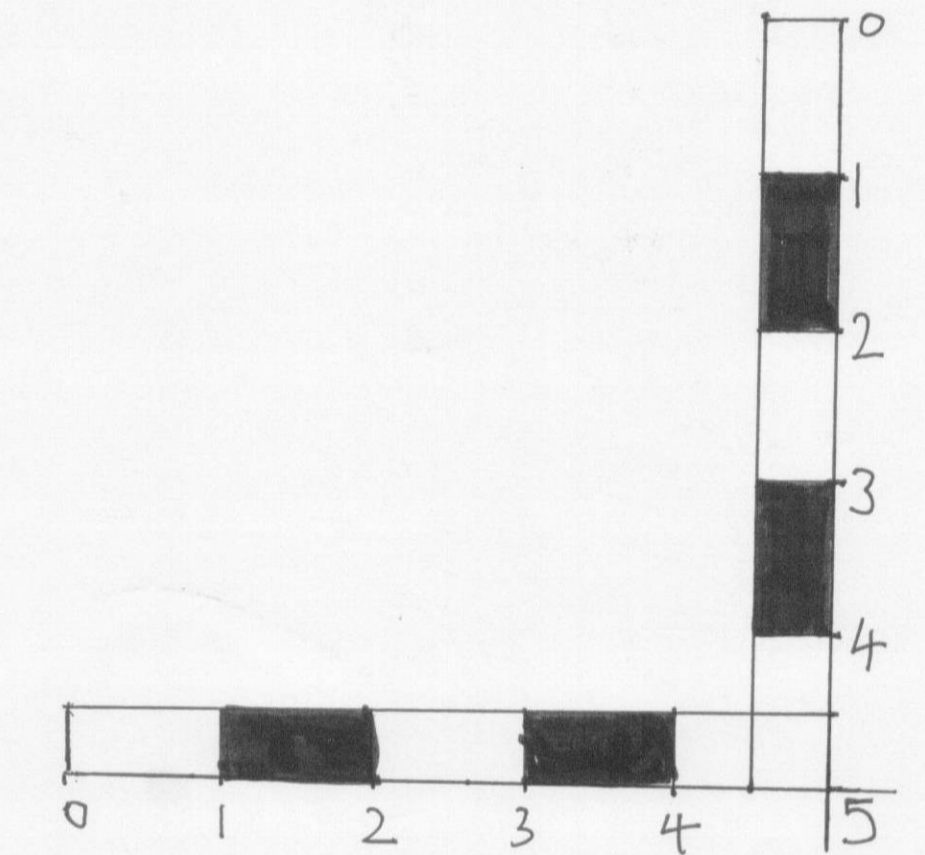

**GROUND FLOOR PLAN**

CUSTOMER AREA  
 786 SQ FT GROSS  
 73 SQ M GROSS  
 678 SQ FT NET  
 63 SQ M NET

WELWYN HATFIELD  
 PLANNING  
 OFFICE COPY  
 22 JUL 2008  
 No. SC/2008/020/FP

Rev	Date	Description



Address  
 Unit 6, Park House Court  
 Hatfield. AL10 9RQ

Title  
 PROPOSED LAYOUT

Drawn J.Bannatyne	Date 05/02/07	Scale 1.50@A1
Rad 211	Location ----	Customer Area 786 sq ft Gross 678 sq ft net
Drawing Number HAT/02	Revision -	

Licensing & Development