

## Highways



Olga Prisacaru  
2<sup>nd</sup> Floor, 48 Cank Street  
Leicester  
LE1 5GW

**Highways**  
**Hertfordshire County Council**  
**County Hall, Pegs Lane**  
**Hertford, Herts SG13 8DF**

**Tel:** 0345 123 4047  
**Email:** HighwaysAssetOperations@hertfordshire.gov.uk  
**My ref:**  
**Your ref:** Mosquito Way  
**Date:** 04/10/2018

Dear Olga Prisacaru

### **Reference: Existing drain within Mosquito Way**

As per your correspondences with Steve Crawford in regards to the request that Thames Water wish to adopt a section of our highways drainage under s102 of the Water Industry Act 1991, I can confirm that we as the highway authority are happy for the adoption of the sections highlighted on the attached drawings (referenced below) supplied by yourself on 30/07/2018 under the legend "Existing highway drains to be adopted under S102".

FW1263 800 S102 Layout Sheet 1 of 2  
FW1263 801 S102 Layout Sheet 2 of 2

Please take this letter as confirmation of adoption under s102.

Yours sincerely

Chris Allen-Smith  
**Group Manager, Eastern Herts; Highway Operations and Strategy,**  
**Head of Profession, Asset Management & Maintenance**

Sewer details shown are taken from Thames Water records and CCTV survey and are to be confirmed by Contractor prior to commencement of the works

Surface Water discharge point subject to approval by Thames Water

Location of existing services along drainage route to be confirmed by Contractor prior to any start of works

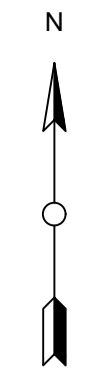

- General Notes**
- DO NOT SCALE.
  - This drawing is to be read in conjunction with all other relevant drawings and details.
  - Should there be any conflict between the details indicated on this drawing and those on other drawings the Engineer should be informed PRIOR to construction on site.
  - Until technical approval has been obtained from the relevant Authority, it should be understood that all drawings issued are Preliminary and NOT for construction. Should the contractor commence site work prior to such approval being given it is entirely at his own risk.
  - Sketch proposals are for illustrative purposes only & as such are subject to detailed site investigation including ground conditions / contaminants, drainage, design & planning/density negotiations.
  - All dimensions are in millimetres unless otherwise stated.
  - The Farrow Walsh Consulting Designers Risk Assessments for this project must be reviewed PRIOR to the commencement of any works on site.

- NOTES**
- This Drawing is to be read in conjunction with:
- FW1263 800 S102 Layout Sheet 1 of 2  
FW1263 801 S102 Layout Sheet 2 of 2
- This drawing to be read in conjunction with all other relevant Engineers and Architect's details.
  - All work is to be carried out in accordance with the current British Standards, codes of practice, building regulations and with Sewers for Adoption 6th Edition guidance.
  - The exact position, level, size and use of existing sewers to be confirmed on site. Any discrepancies to be reported to the engineer prior to commencement of works.
  - All uncovered and shallow pipework to be protected against construction traffic as part of the contractors temporary works requirements.
  - Cover levels shown are approximate only, subject to the Architect's external works and landscaping scheme.
  - All connections to road gullies and channels shall be 150mm nominal bore pipework.
  - All pipework to be Vitrified Clay to BS EN295 unless otherwise noted.
  - All pipes connecting to adopted manholes up to and including 300mm dia. to be Vitrified Clay.
  - All pipes connecting to adopted manholes greater than 300mm dia. to be Concrete.
  - All pipework entering and exiting manholes to be connected with pipe soffits level.

- LEGEND**
- Boundary of Site Ownership
  - S104 Foul Sewer
  - S104 Surface Water Sewer
  - Existing Highway Drain
  - Existing Highway Drain to be Adopted Under S102
  - Surface Water connection under S106
  - Section 38 SW Road Gully
  - Existing highway drain to be offered for adoption under Section 102 to Thames Water. The extent of adoption TBC by Thames Water
  - Invert level / cover level of the existing highway drain shown indicative only and TBC by the CCTV survey / Contractor prior any construction works

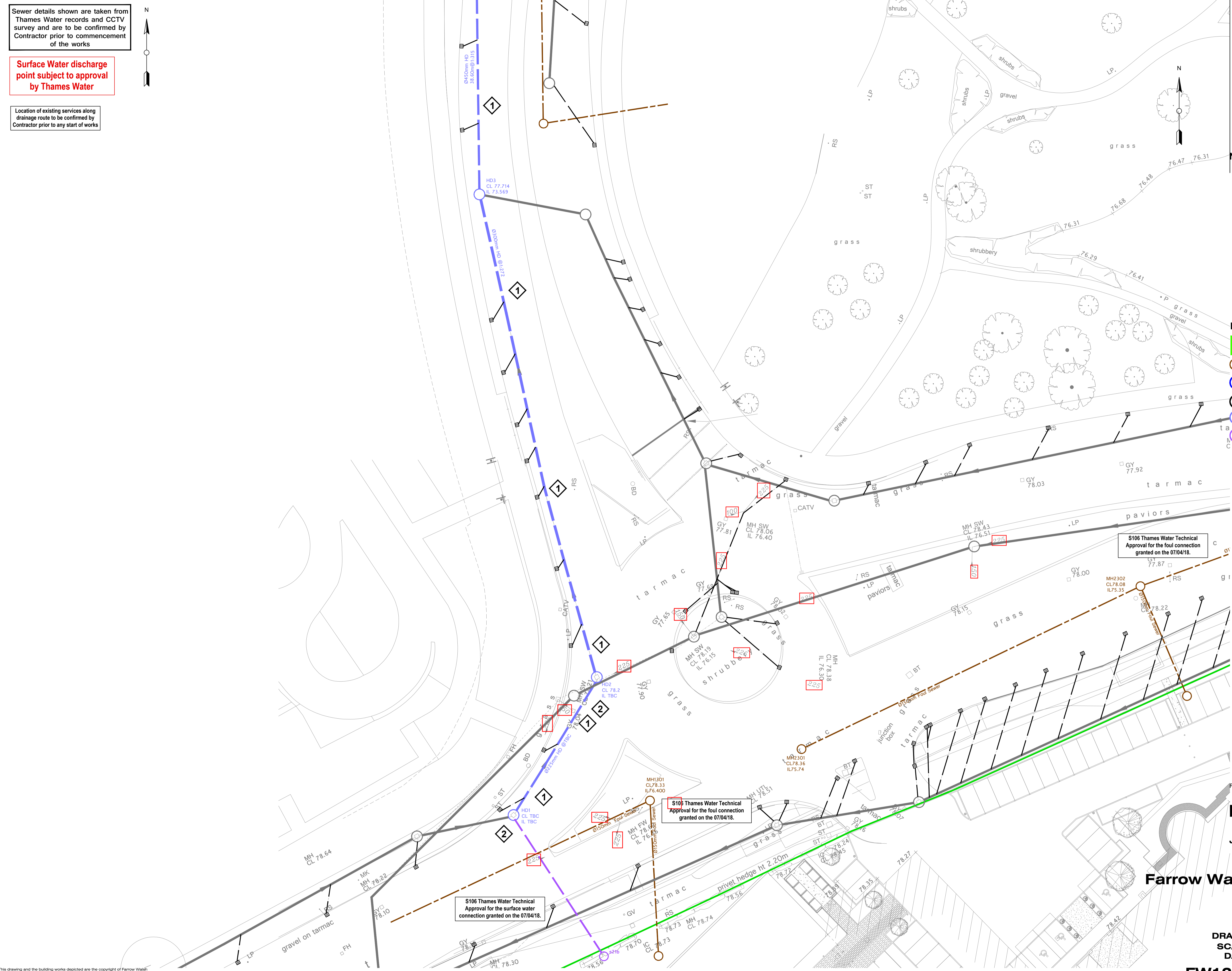

Revision

**PRELIMINARY**

**JOB:** COMET HOTEL, HATFIELD

**S102 LAYOUT SHEET 1 OF 2**

**Farrow Walsh consulting ltd**

Second Floor  
48 Cank Street  
Leicester LE1 5GW  
t 0116 251 5558  
w www.farrowwalsh.com

**DRAWN:** op **CHECKED:** jd

**SCALE:** 1:250 @ A1

**DATE:** June 2018

**FW1263 800**

This drawing and the building works depicted are the copyright of Farrow Walsh consulting Ltd, and may not be reproduced or amended except by written permission. No liability will be accepted for amendments made by other persons.

Sewer details shown are taken from Thames Water records and CCTV survey and are to be confirmed by Contractor prior to commencement of the works

Surface Water discharge point subject to approval by Thames Water

Location of existing services along drainage route to be confirmed by Contractor prior to any start of works

This drawing and the building works depicted are the copyright of Farrow Walsh consulting Ltd. and may not be reproduced or amended except by written permission. No liability will be accepted for amendments made by other persons.

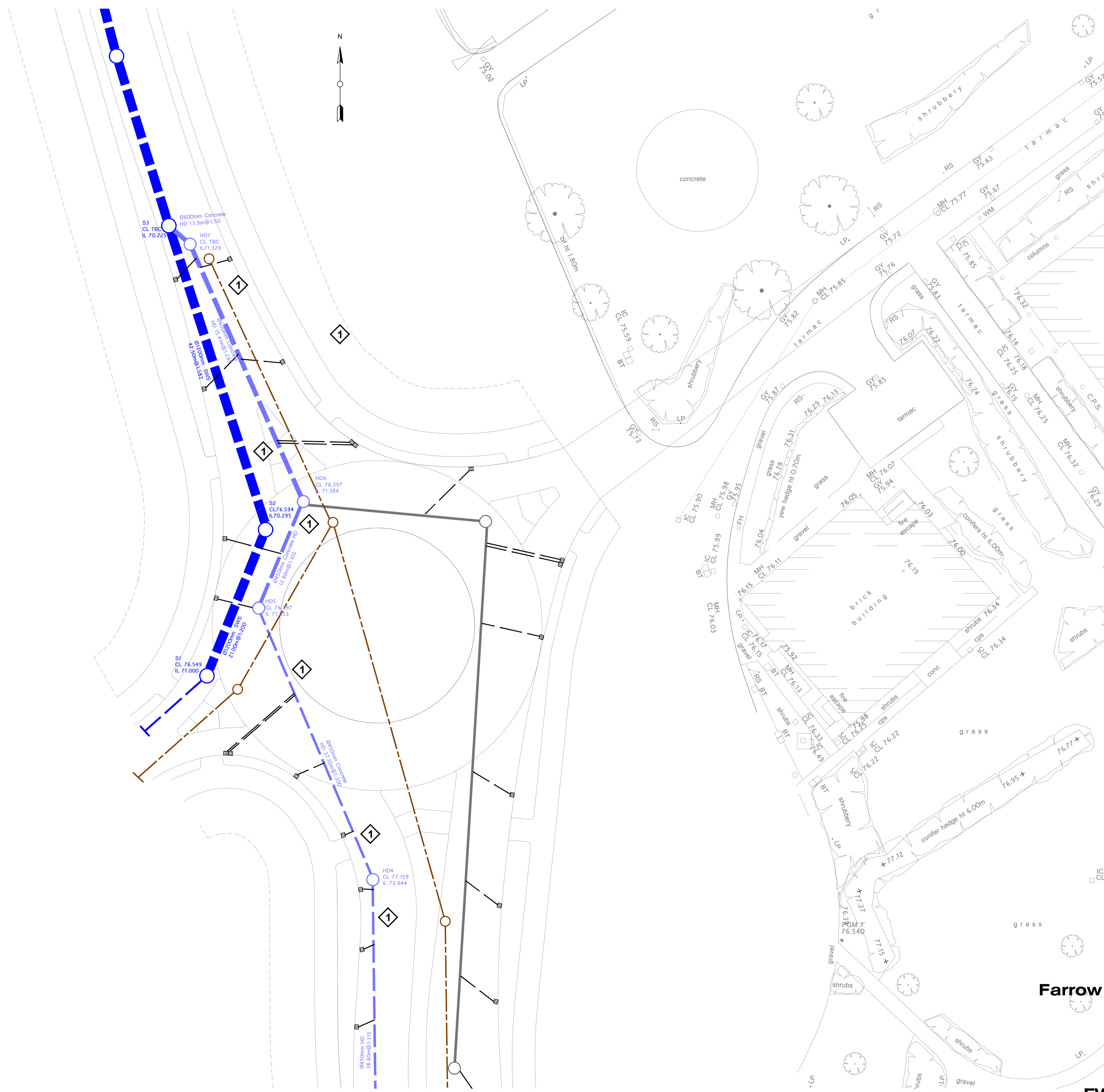

- General Notes**
- DO NOT SCALE.
  - This drawing is to be read in conjunction with all other relevant drawings and details.
  - Should there be any conflict between the details indicated on this drawing and those on other drawings the Engineer should be informed PRIOR to construction on site.
  - Until technical approval has been obtained from the relevant Authority, it should be understood that all drawings issued are Preliminary and NOT for construction. Should the contractor commence site work prior to such approval being given it is entirely at his own risk.
  - Sketch proposals are for illustrative purposes only & as such are subject to detailed site investigation including ground conditions / contaminants, drainage, design & planning/density negotiations.
  - All dimensions are in millimetres unless otherwise stated.
  - The Farrow Walsh Consulting Designers Risk Assessments for this project must be reviewed PRIOR to the commencement of any works on site.

- NOTES**
- This Drawing is to be read in conjunction with:
- FW1263 800 S102 Layout Sheet 1 of 2  
FW1263 801 S102 Layout Sheet 2 of 2
- This drawing to be read in conjunction with all other relevant Engineers and Architect's details.
  - All work is to be carried out in accordance with the current British Standards, codes of practice, building regulations and with Sewers for Adoption 6th Edition guidance.
  - The exact position, level, size and use of existing sewers to be confirmed on site. Any discrepancies to be reported to the engineer prior to commencement of works.
  - All uncovered and shallow pipework to be protected against construction traffic as part of the contractors temporary works requirements.
  - Cover levels shown are approximate only, subject to the Architect's external works and landscaping scheme.
  - All connections to road gullies and channels shall be 150mm nominal bore pipework.
  - All pipework to be Vitrified Clay to BS EN295 unless otherwise noted.
  - All pipes connecting to adopted manholes up to and including 300mm dia. to be Vitrified Clay.
  - All pipes connecting to adopted manholes greater than 300mm dia. to be Concrete.
  - All pipework entering and exiting manholes to be connected with pipe soffits level.

- LEGEND**
- Boundary of Site Ownership
  - S104 Foul Sewer
  - S104 Surface Water Sewer
  - Existing Highway Drain
  - Existing Highway Drain to be Adopted Under S102
  - Surface Water connection under S106
  - Section 38 SW Road Gully
  - Existing highway drain to be offered for adoption under Section 102 to Thames Water. The extent of adoption TBC by Thames Water

S106 Thames Water Technical Approval for the foul connection granted on the 07/04/18.

S106 Thames Water Technical Approval for the surface water connection granted on the 07/04/18.

Revision

**PRELIMINARY**

**JOB:** COMET HOTEL, HATFIELD

**S102 LAYOUT SHEET 2 OF 2**

**Farrow Walsh consulting Ltd**

Second Floor  
48 Cank Street  
Leicester LE1 5GW  
t 0116 251 5558  
www.farrowwalsh.com

**DRAWN:** op **CHECKED:** jd  
**SCALE:** 1:250 @ A1  
**DATE:** June 2018

**FW1263 801**