

This drawing is copyright.

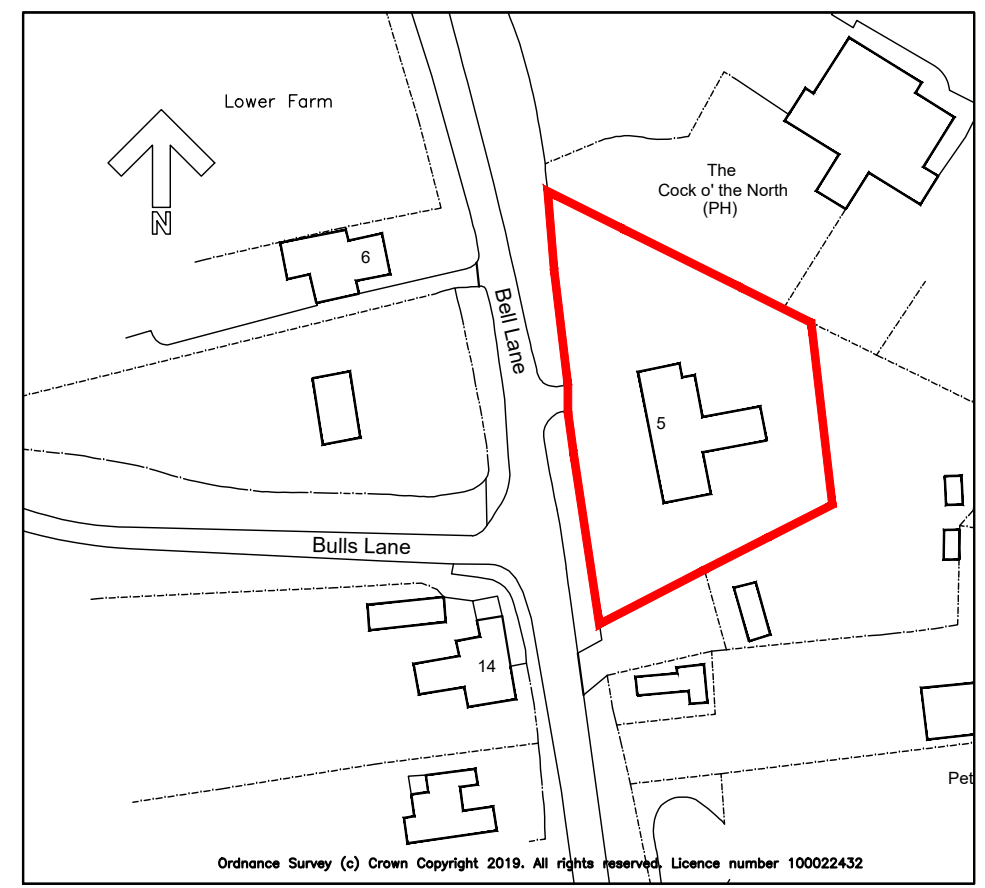
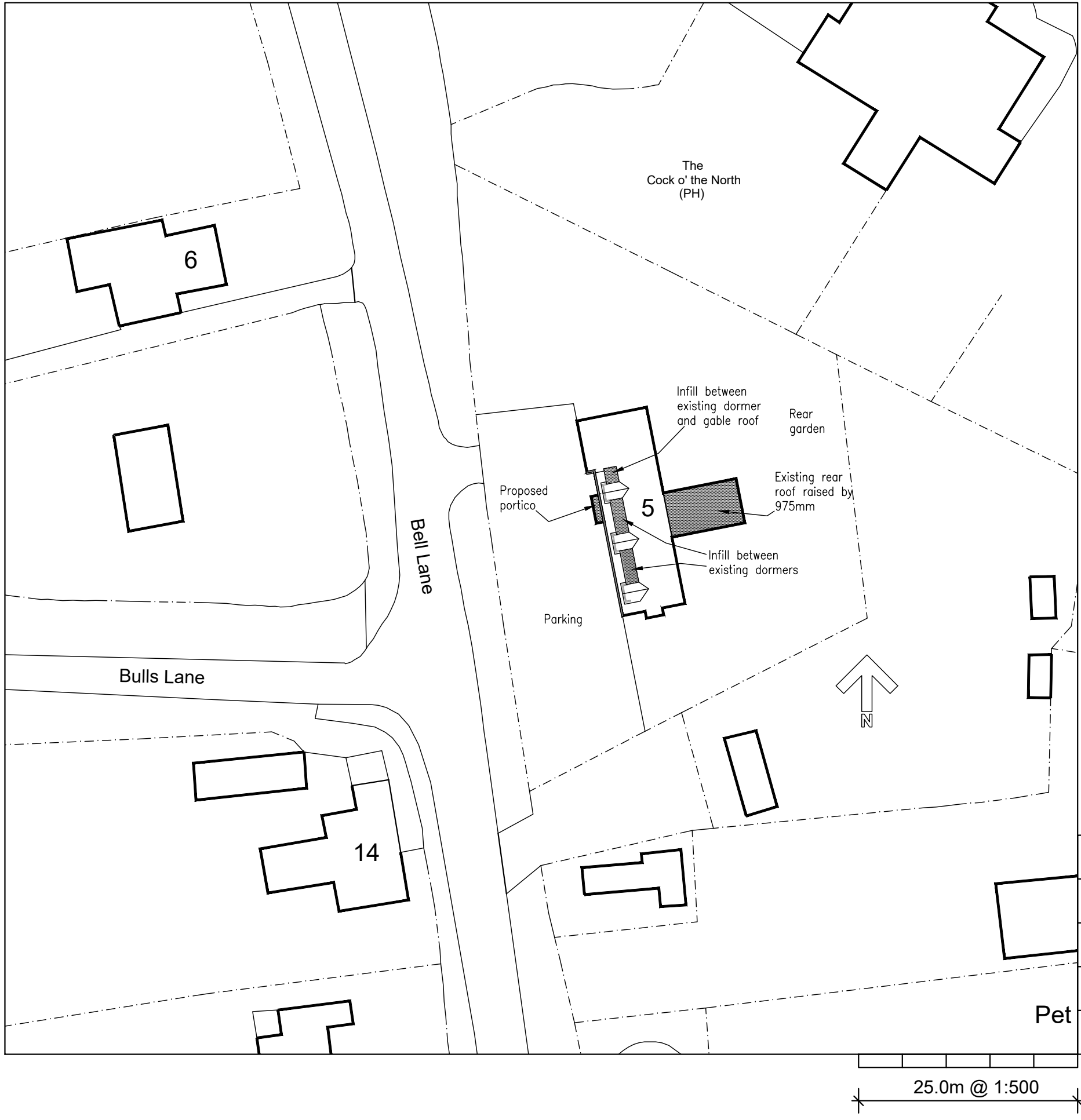

Site Location Plan 1:1250

A Additional notes and information added to site plan. 05.11.19

Rev.	Description.	Date.
------	--------------	-------

AT Design (Welwyn) Ltd
 Architectural Design Services
 22 School Lane, Welwyn, Herts AL6 9PH
 Tel: 07931703297 - email: adamtrigg@hotmail.com

Title:
 Proposed alterations
 5 Bell Lane
 Brookmans Park
 Herts AL9 7AY
 Site Plan & Location Plan

Scale : 1:500 at A3
 Date : June 2019
 Drawn by: AT

Drq.No: AT821-01A

