

Existing ground floor plan

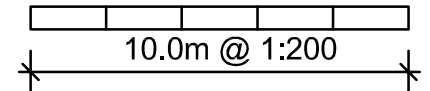

AT Design (Welwyn) Ltd
 Architectural Design Services
 22 School Lane, Welwyn, Herts AL6 9PH
 Tel: 07931703297 - email: adamtrigg@hotmail.com

Proposed Alterations
 Titchfield Group Ltd
 Media House, Sopers Road
 Cuffley, Herts, EN6 4RY
 Existing ground floor plan

Scale : 1:200 @ A3
 Date : Jan 2016 Drawn by: AT
 Drg.No: AT420-04