

This drawing is copyright.

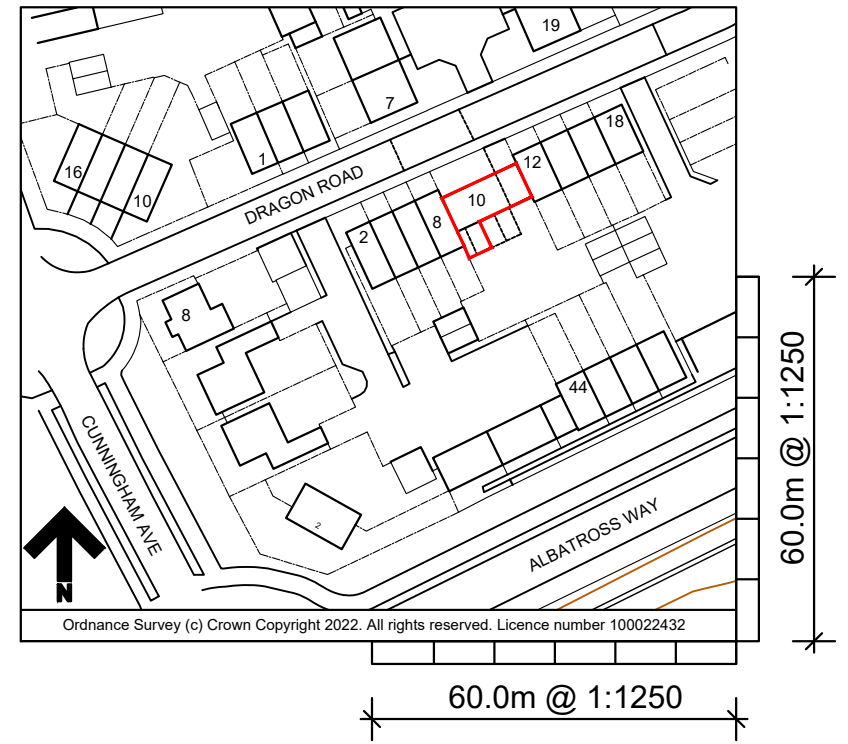
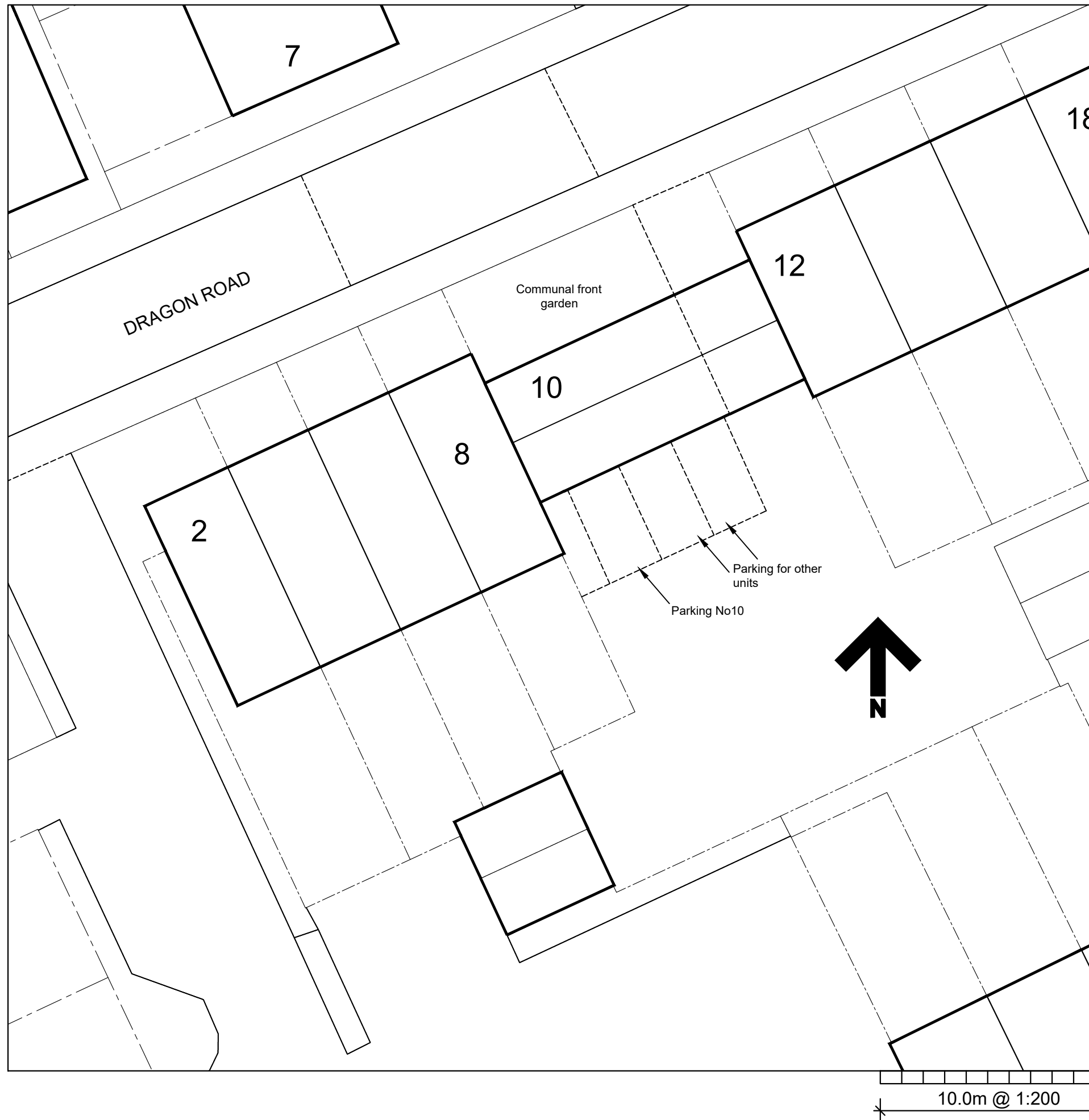

Site location plan 1:1250

| Rev.   | Description. | Date.        |
|--|--------------|--------------|
| AT Design (Welwyn) Ltd<br>Architectural Design Services<br>30c High Street, Welwyn, Herts AL6 9EQ<br>Tel: 07931703297 - email: adamtrigg@hotmail.com |              |              |
| Title;<br>Proposed loft conversion<br>10 Dragon Road<br>Hatfield<br>Herts AL10 9LX<br>Site plan & location plan                                      |              |              |
| Scale : 1:200 @ A3   |              | Drawn by: AT |
| Date : June 2022   |              |              |
| Drg.No: AT1072-01  |              |              |