

SITE PLAN

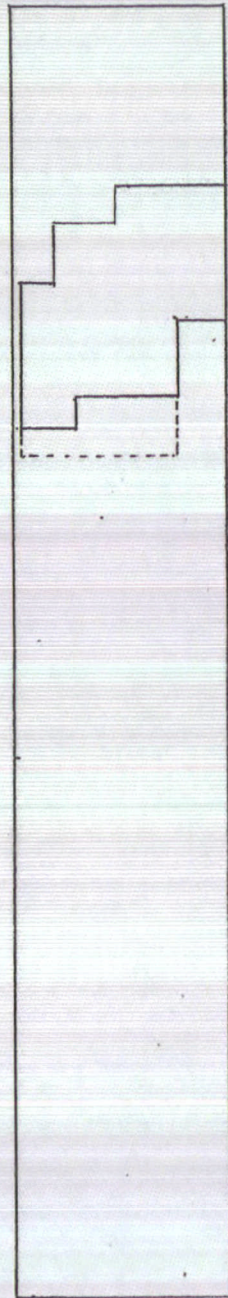

EXISTING

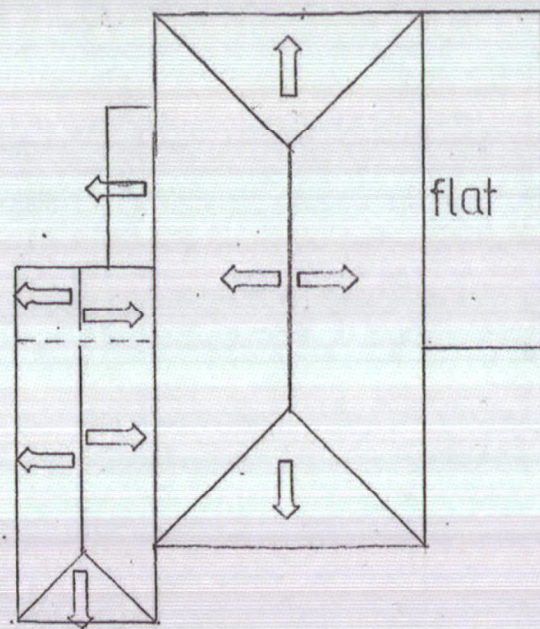

PROPOSED

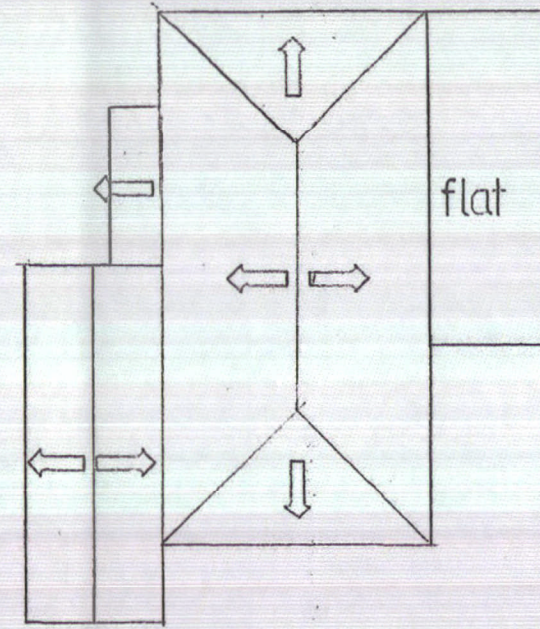

NOTES

These drawings have been prepared to assist an application for Planning Approval. Do not scale from these drawings. Copyright reserved. It is the owner's responsibility to check whether any easements or other rights are affected by these proposals.

Design Statement

The proposal is to remove the existing conservatory and utility room roof and install a new pitched roof with a higher ridge line giving a min 35° pitch and fitting the correct tiles for this pitch.

Provide and fit new tri-fold doors to rear.

The room will be upgraded to comply with current Building Regulations in terms of insulation which will be installed to the floor, walls and roof structures.

Once upgraded the room will be used as a kitchen and the existing kitchen will be used as a utility room.

SCALE BAR



Site and Roof Plans at :

77, The Ridgeway,
Northaw,
Herts.,
EN6 4BD

Project: Upgrade Conservatory

Client: Mr. & Mrs. M. Warburton

Consultant: S. Wotton Tel. No. 01992 624514

Scale 1 : 500/200 @ A3 Dwg. No. 77TR/15/5

Date: January 2015

PLANNING
DEPARTMENT
05 FEB 2015
RECEIVED