

USE FIGURES SHOWN ON ONLY. DO NOT SCALE FROM THIS DRAWING. ALL DIMENSIONS MUST BE VERIFIED ON SITE AND RECORDED AS SUCH. THE CONTRACTOR SHALL BE RESPONSIBLE FOR OBTAINING ALL NECESSARY PERMITS AND APPROVALS FROM THE LOCAL AUTHORITY. ALL WORKS ARE SUBJECT TO THE APPROVAL OF THE LOCAL AUTHORITY. PLANNING STAGE DRAWINGS SHOULD NOT BE USED FOR CONSTRUCTION.

REV	AMENDMENT	BY	DATE
A	Changing position of the granite set in Arms and Sword Lane	VN	23.11.21
B	Surfaces key added and bicycle storage amended	VN	24.11.21
C	Minor amendments	SR	29.11.21

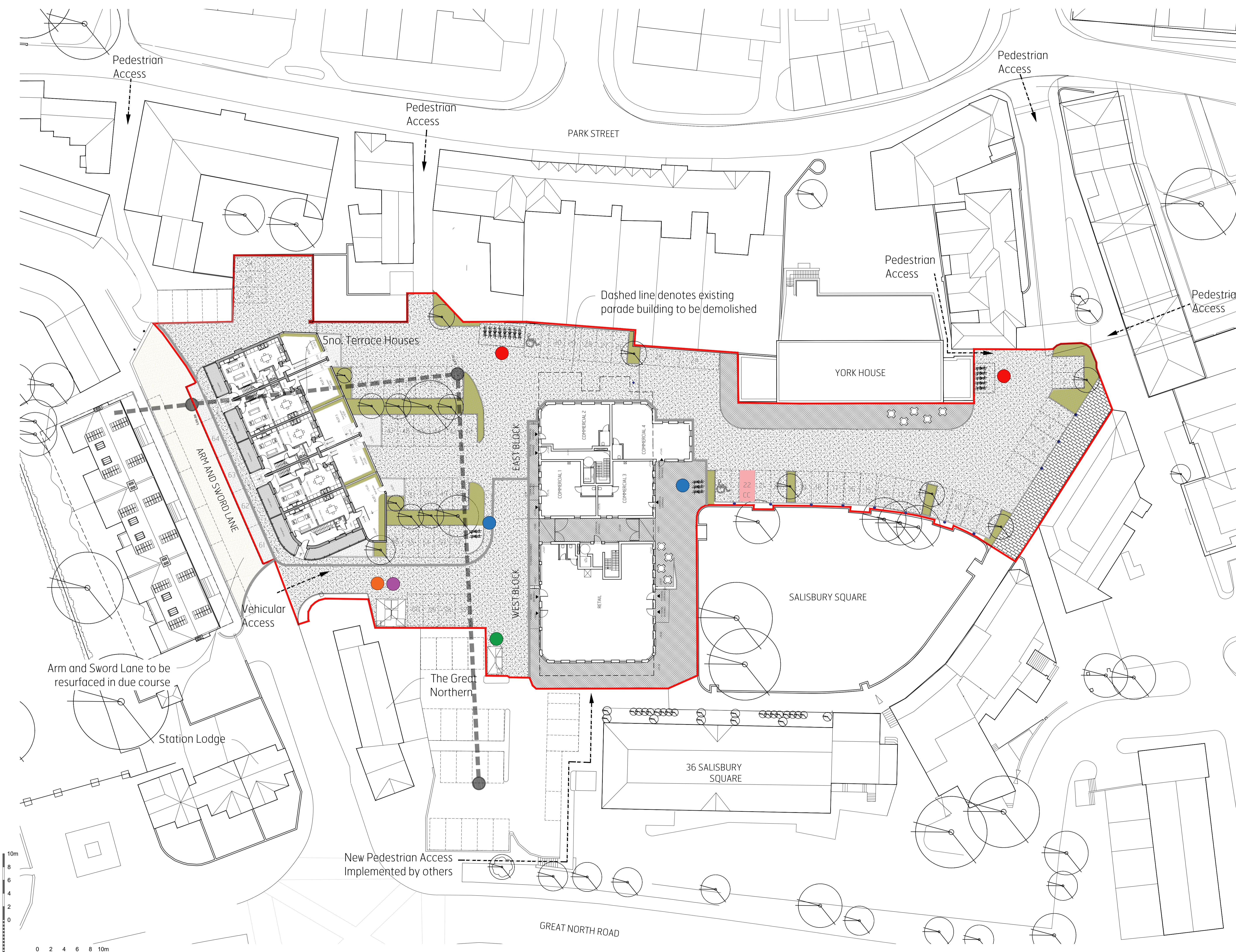

**SURFACES KEY**

- Conservation Granite Paving
- Conservation Granite Setts
- Conservation Kerb
- Gravel
- Tarmac
- Grass

- NOTES:**
- Proposed Site Area: 0.485 h
  - Existing number of car parking spaces: 65 no.
  - Proposed number of car parking spaces: 65 no.
  - Car Club Spaces: CC
  - Electric Charging Point:
  - Bollards:
  - Proposed Cycle Parking Spaces:
    - Covered (LT): 26 no.
    - Uncovered (ST): 10 no.
  - Proposed Refuse/Recycling:
    - Residential Houses:
    - Residential Flats:
    - Commercial:

Brooks Murray Architects  
 The Arts Building, Morris Place, N4 3JG  
 +44 (0)207399955 admin@brooksmurray.com



CLIENT: GASCZYNE ESTATES  
 JOB: SALISBURY SQUARE HATFIELD AL9 5AD  
 DRAWING TITLE: PROPOSED SITE PLAN GROUND FLOOR LEVEL  
 SCALE: 1:250 @ A1 / 1:500 @ A3  
 DATE: NOV 2021  
 STATUS: PLANNING  
 DRAWING NUMBER: 789 - PL - 109 C  
 REV: C  
 ISSUED BY: SR